

TRACT	LESSOR	PARCEL NUMBER
1	RIDDLE O. S. & MARGARET Y	422008487
2	MICK ROBERT D & USBETH A	422008521
3	NESTOR NATHANIEL BURT JR & ANNA-ELIZABETH	422008645
4	NESTOR NATHANIEL BURT JR & ANNA-ELIZABETH	422008519
5	NESTOR NATHANIEL BURT JR & ANNA-ELIZABETH	422008644
6	AKERS GARY G & JOYCE K	422008514
7	SHELDON TIMOTHY & JANET	422008515
8	PITZER GEORGE D. LIFE EST	422008631
9	UNGER FRANK E JR	422008512
10	UNGER FRANK E JR	422008510
11	BOYCE LAWRENCE JR	422008643
12	HARKER ROSALEA	422008489
13	BOYCE LAWRENCE JR	422008637
14	BOYCE LAWRENCE JR	422008640
15	BOYCE LAWRENCE JR	422008515
16	HARKER ROSALEA	422008481
17	MOWEN BEN & BERGOORF, ZACKARY	422008477
18	HARKER ROSALEA	422008479
19	HARSHBERGER SCOT L & DENISE E	422008492
20	KEPNER DAVID A & MARY CRAIG	422008459
21	SMITH ROY C JR & MARY	422007480
22	WOLFE CATHARINE	422008444
23	WOLFE JOHN MOORE & MARGARET J	422008411
24	PITZER JAMES	422008391
25	MACKAY MARGARET LIFE EST & JOHN M WOLFE	422008402
26	WOLFE JOHN M & VICKIE C	422008506
27	WOLFE HAZEL N	422008474
28	MACKAY MARGARET J LIFE EST	422008375
29	MACKAY MARGARET LIFE EST & JOHN M WOLFE	422008410

GENERAL NOTES:

1. THE BOUNDARY LINES SHOWN HEREON ARE BASED ON RECORD DEED, PLATS, AND TAX MAPS BEST FIT TO FOUND FIELD EVIDENCE AND AERIAL PHOTOS.
2. THIS PLAT DOES NOT REPRESENT AN ACTUAL BOUNDARY SURVEY OF THE INDIVIDUAL PARCELS.

DETAIL N.T.S

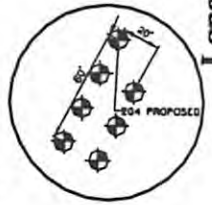

LINE	BEARING	LENGTH
L1	S74°05'13"W	518'
L2	N37°26'41"E	154'
L3	S61°01'07"W	859'
L4	N57°13'55"E	382'

LEGEND

- PROPOSED GAS WELL
- PROPOSED BOTTOM HOLE
- PROPOSED BORE
- PROPERTY CORNER TIE LINE
- OIL & GAS LEASE BOUNDARY
- STREAM
- WATER WELL

GRID NORTH
NAD 83

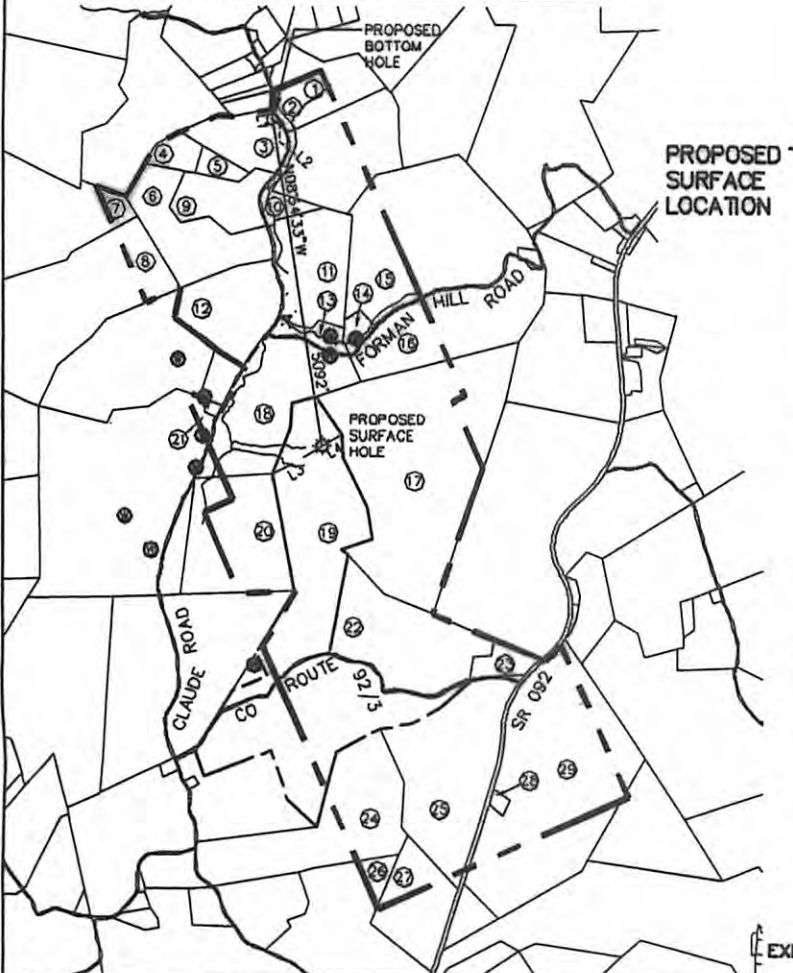

SURFACE POINT	BOTTOM HOLE
LAT: 39.270879° (NAD 83) LONG: 79.898818° (NAD 83) N: 281026.05 (NAD 83) E: 1855591.30 (NAD 83)	LAT: 39.284882° (NAD 83) LONG: 79.901684° (NAD 83) N: 286056.88 (NAD 83) E: 1854802.67 (NAD 83)
LAT: 39.270781 (NAD 27) LONG: 79.899022 (NAD 27) N: 280985.13 (NAD 27) E: 1887030.58 (NAD 27)	LAT: 39.284585 (NAD 27) LONG: 79.90188 (NAD 27) N: 286016.18 (NAD 27) E: 1886241.82 (NAD 27)
N: 4347414.85m (UTM NAD 83) E: 594989.73m (UTM NAD 83)	N: 4348943.71m (UTM NAD 83) E: 594723.98m (UTM NAD 83)

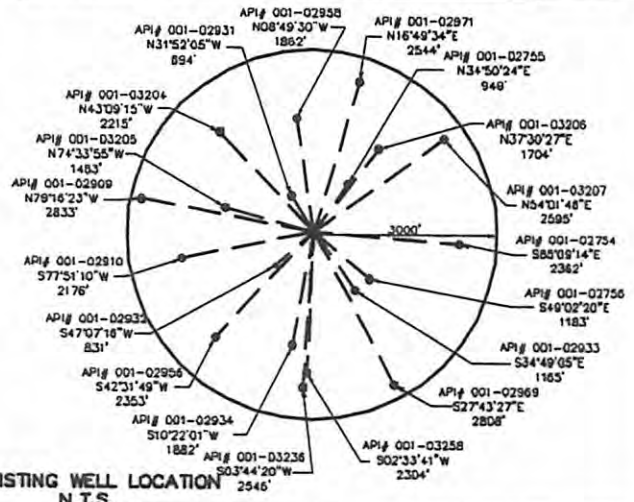

FILE #: 092942000

DRAWING #: 092942000_PBBase_WellPlat

SCALE: 1" = 3,000'

MINIMUM DEGREE OF ACCURACY: 1/200

PROVEN SOURCE OF ELEVATION: SUBMETER MAPPING SURVEY GPS

I, THE UNDERSIGNED, HEREBY CERTIFY THAT THIS PLAT IS CORRECT TO THE BEST OF MY KNOWLEDGE AND BELIEF AND SHOWS ALL THE INFORMATION REQUIRED BY LAW AND THE REGULATIONS ISSUED AND PRESCRIBED BY THE DEPARTMENT OF ENVIRONMENTAL PROTECTION.

SIGNED: Scott M. Faulkner

R.P.E.: _____ L.L.S.: 2190



(+) DENOTES LOCATION OF WELL ON UNITED STATES TOPOGRAPHIC MAPS WVDEP

OFFICE OF OIL & GAS
601 57TH STREET
CHARLESTON, WV 25304



DATE: NOVEMBER 14, 2012

OPERATOR'S WELL #: HARSHBERGER 204

API WELL #: 47 001 03279

STATE COUNTY PERMIT

WELL TYPE: OIL WASTE DISPOSAL GAS LIQUID INJECTION

PRODUCTION DEEP SHALLOW

STORAGE SHALLOW

WATERSHED: TYGART VALLEY

COUNTY/DISTRICT: BARBOUR / COVE

SURFACE OWNER: SCOT L. & DENISE E. HARSHBERGER

OIL & GAS ROYALTY OWNER: _____

ELEVATION: 1,708'

QUADRANGLE: THORNTON

ACREAGE: 203±(DEED)

ACREAGE: _____

DRILL CONVERT DRILL DHEPER REDRILL FRACTURE OR STIMULATE

PLUG OFF OLD FORMATION PERFORATE NEW FORMATION PLUG & ABANDON

CLEAN OUT & REPLUG OTHER CHANGE (SPECIFY): _____

TARGET FORMATION: MARCELLUS ESTIMATED DEPTH: TMD: 13479' TVD: 7969'

WELL OPERATOR: MOUNTAINEER KEYSTONE, LLC DESIGNATED AGENT: NATHAN SKEEN

ADDRESS: 1111 VAN VOORHIS DRIVE SUITE G ADDRESS: 1111 VAN VOORHIS DRIVE SUITE G

CITY: MORGANTOWN STATE: WV ZIP CODE: 26505 CITY: MORGANTOWN STATE: WV ZIP CODE: 26505

11/21/2014