

33° 05

LATITUDE 38° 02' 30"

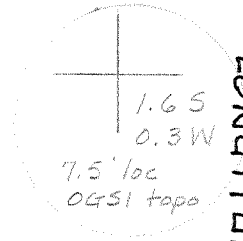
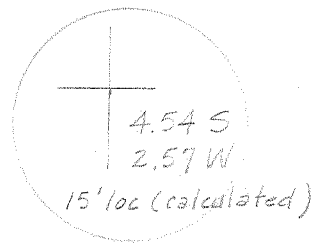

LONGITUDE 81° 37' 30"

81° 35'

Company Pure Oil

Farm Fed Coal Co 36

Quad Williams Mt. 7.5' / Peytona 15' SC

County Boone

District Sherman

Well location

WELL LOCATION MAP

File No. 005 - 22

500 22

m

FEDERAL COAL COMPANY NO. 36 WELL. (606) No. 53 O.F.

Sherman District, Boone County, W. Va.
Godfrey L. Cabot, Inc., Charleston, W. Va.
On 18338 acres, ridge between Hopkins Fork and Lavinia Fork;
surface and mineral rights owned by Federal Coal Co.,
Charleston, W. Va.

Drilled under permit issued Aug. 12, 1929.
Elevation, 1597' B.

13 1/2" conductor, 14" 4"; 10" casing, 953'. (13 1/2", 16' 6"?)
10" steel casing shoe on bottom of 10" casing.

Coal was encountered at 55-60, 140-143, 270-274, 325-328, 720-725,
and 844-847'.

Preliminary report only filed with Dept. of Mines Dec. 26, 1929.
Record to depth of 994' only.

Drilling commenced Nov. 21, 1929.

Rig contractor, Everett Ferrell.

10" casing seated in 22' of white clay (fire clay).

	Top.	Bottom.
Surface	0	16
Sand	16	55
✓ Coal (water at 60'; 5 bailers per hour)	55	60
Slate	60	70
Sand	70	140
✓ Coal	140	143
Slate	143	170
Sand	170	260
Slate	260	270
✓ Coal	270	274
Sand	274	325
✓ Coal (water at 328'; 8 bailers per hour)	325	328
Slate	328	360
Sand	360	535
Lime	535	555
Sand	555	590
Lime	590	615
Sand	615	651
Lime	651	672
Sand	672	720
✓ Coal	720	725
Sand	725	731
Lime	731	844
✓ Coal	844	847
Sand (water, 867'; hole full)	847	887
Lime	887	900
Sand	900	915
Lime	915	920
Slate	920	922
Lime	922	940
Sand	940	994

(RECORD INCOMPLETE)

200