

WW-7  
8-30-06



West Virginia Department of Environmental Protection  
Office of Oil and Gas  
**WELL LOCATION FORM: GPS**

API: 47-005-00144 WELL NO.: 458671

FARM NAME: W.H. Mitchell 7504

RESPONSIBLE PARTY NAME: Alliance Petroleum Co. LLC

COUNTY: Boone DISTRICT: Washington

QUADRANGLE: Madison 7.5

SURFACE OWNER: Ronald and Damsel Stollings

ROYALTY OWNER: Robert Mitchell, Et al

UTM GPS NORTHING: 4210063

UTM GPS EASTING: 423453 GPS ELEVATION: 296 m (972)

The Responsible Party named above has chosen to submit GPS coordinates in lieu of preparing a new well location plat for a plugging permit or assigned API number on the above well. The Office of Oil and Gas will not accept GPS coordinates that do not meet the following requirements:

1. Datum: NAD 1983, Zone: 17 North, Coordinate Units: meters, Altitude: height above mean sea level (MSL) – meters.
2. Accuracy to Datum – 3.05 meters
3. Data Collection Method:

Survey grade GPS : Post Processed Differential

Real-Time Differential

Mapping Grade GPS : Post Processed Differential

Real-Time Differential

4. **Letter size copy of the topography map showing the well location.**

I the undersigned, hereby certify this data is correct to the best of my knowledge and belief and shows all the information required by law and the regulations issued and prescribed by the Office of Oil and Gas.

Signature [Handwritten Signature]

Engineer III  
Title

8-6-19  
Date

RECEIVED  
Office of Oil and Gas  
AUG 12 2019  
WV Department of  
Environmental Protection

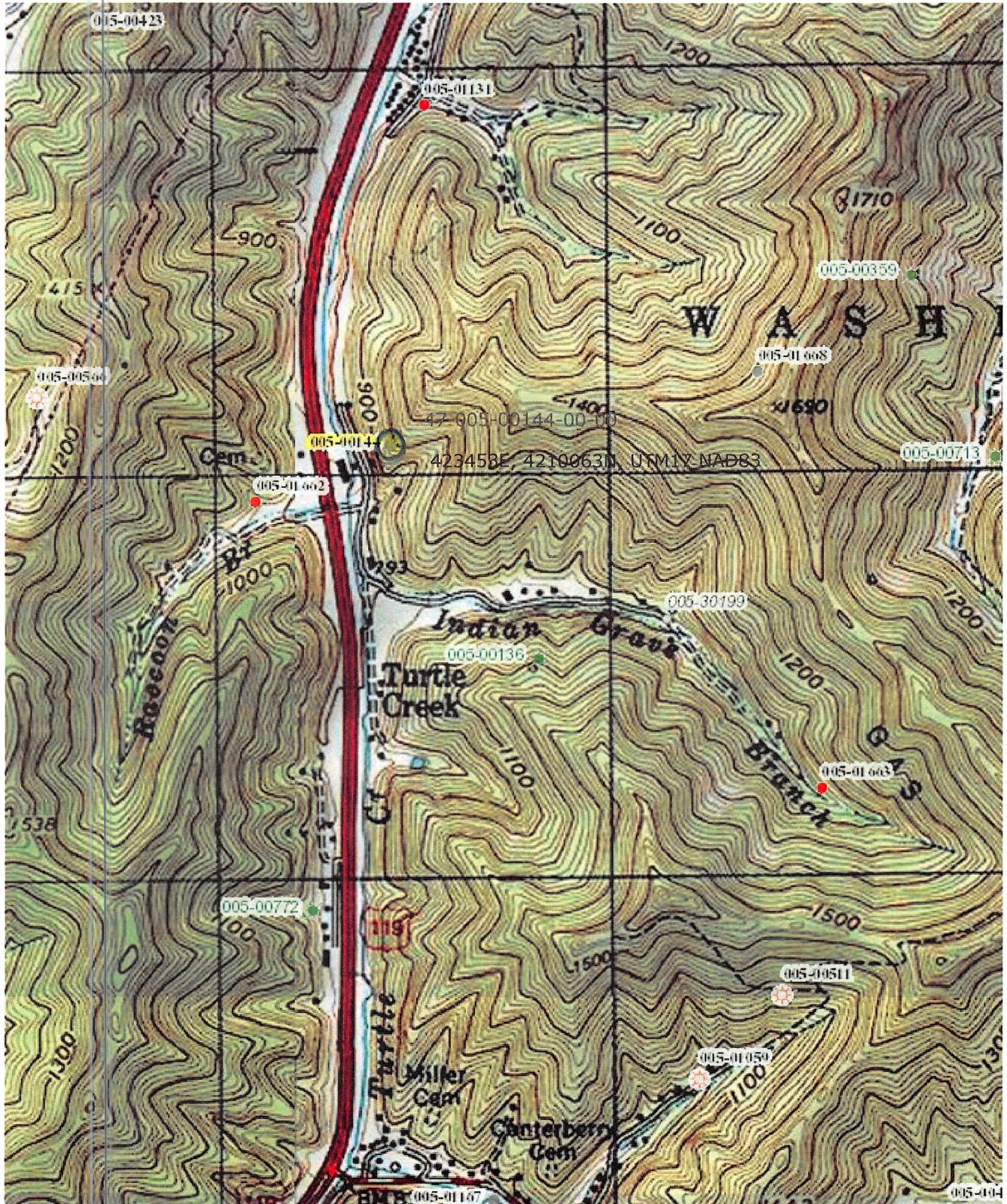



Well No: 458671  
 UTM83-17, Meters  
 North: 423456.1  
 East: 4210063.68  
 Elev: 303.38

Secondary Pit  
 Primary Pit

Sources: Esri, DigitalGlobe, GeoEye, Earthstar Geographics, CNES/Airbus DS, USDA, USGS, AeroGRID, IGN, and the GIS User Community



Diversified Gas & Oil Corporation  
 100 Diversified Way  
 Pikeville KY, 41051

458671

Plugging Map

**Legend**

- Well
- Sediment Control
- Access Road
- Pits
- Pad

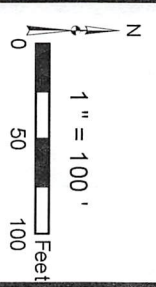
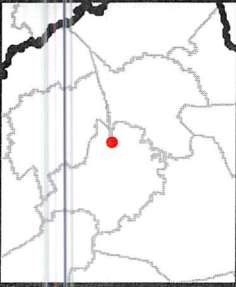

47-005-00144P

Three Creek

RECEIVED  
Office of Oil and Gas  
AUG 12 2019  
WV Department of  
Environmental Protection

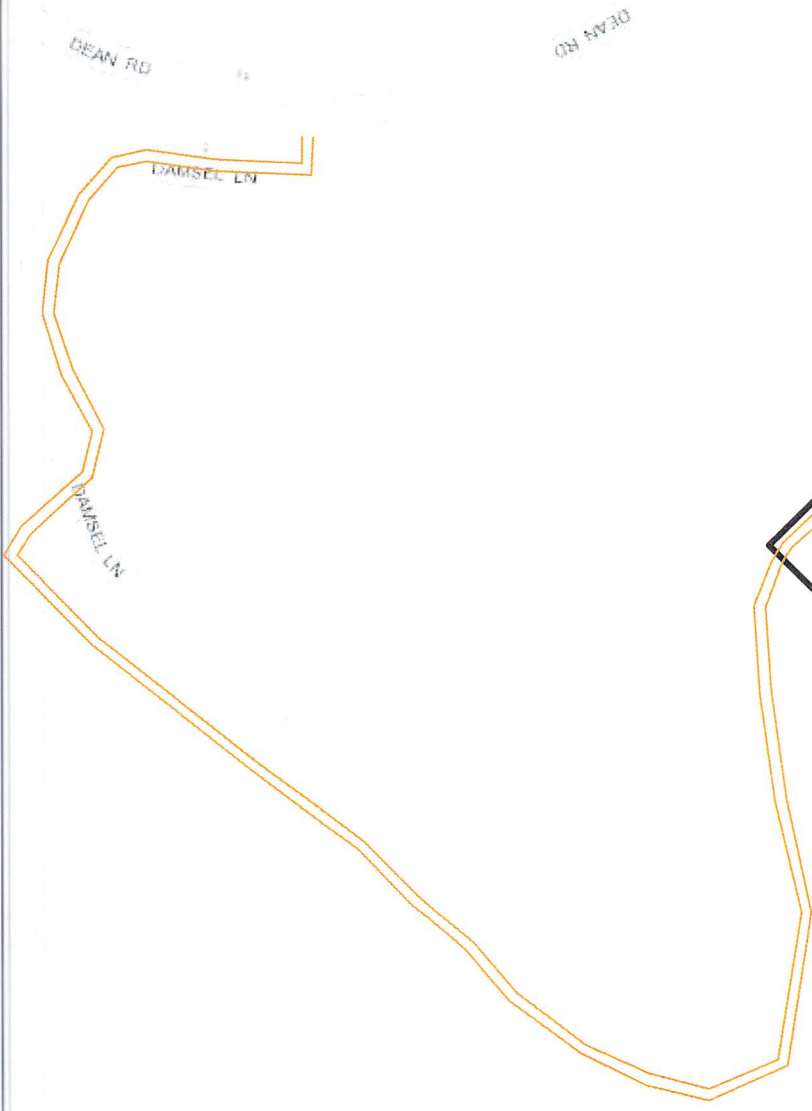

Well No.: 458671  
UTM83-17 Meters  
North: 423456.1  
East: 4210063.68  
Elev.: 303.38

Secondary Pit  
Primary Pit

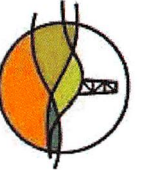

Diversified Gas & Oil  
Corporation  
100 Diversified Way  
Pikeville KY, 41051

458671

Plugging Map

### Legend

- Well
- ⊗ Sediment Control
- Access Road
- ▨ Pits
- Pad

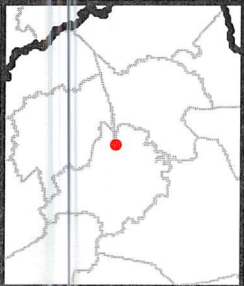

Sources: Esri, HERE, Garmin, Intermap, increment P Corp., GEBCO, USGS, FAO, NPS, NRCAN, Geobase, IGN, Kadaster NL, Ordnance Survey, Esri Japan, METI, Esri China (Hong Kong), (c) OpenStreetMap contributors, and the GIS User Community

47-005-00144P

RECEIVED  
Office of Oil and Gas  
19  
WV Department of Environmental Protection  
to the Director  
6/20/2019

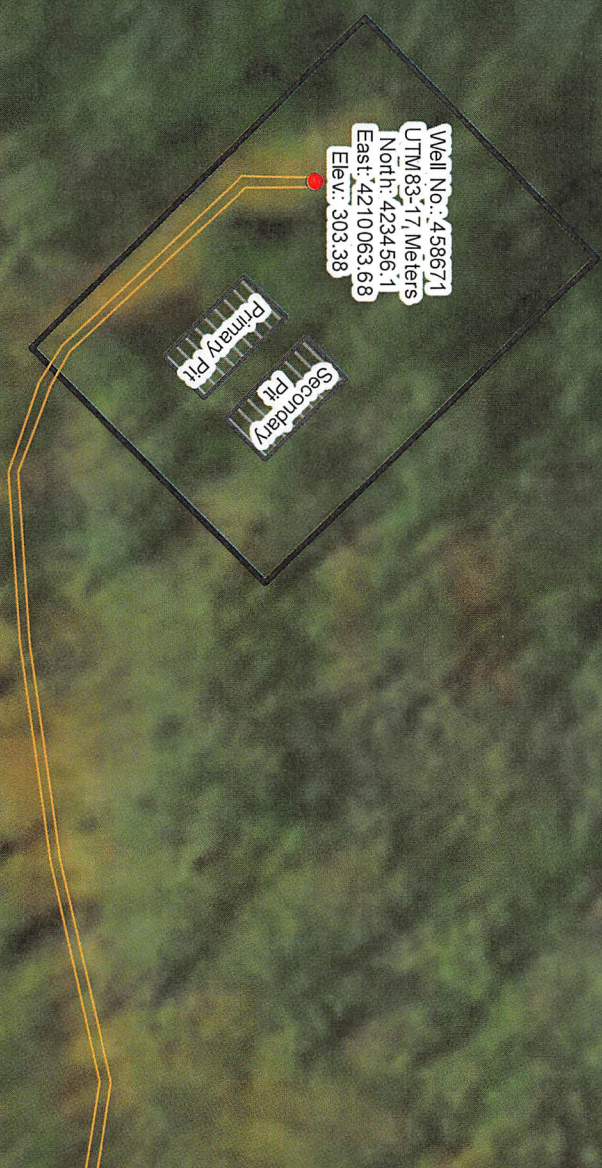

Sources: Esri, DigitalGlobe, GeoEye, Earthstar Geographics, CNES/Airbus DS, USDA, USGS, AeroGRID, IGN, and the GIS User Community

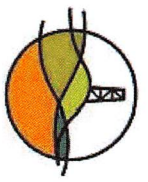

Diversified Gas & Oil  
 Corporation  
 100 Diversified Way  
 Pikeville KY, 41051

458671

Plugging Map

**Legend**

- Well
- Sediment Control
- Access Road
- Pits
- Pad

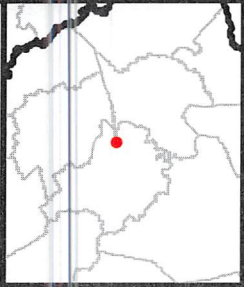

RECEIVED  
Office of Oil and Gas  
AUG 12 2019  
WV Department of  
Environmental Protection

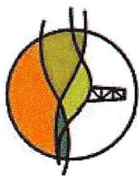
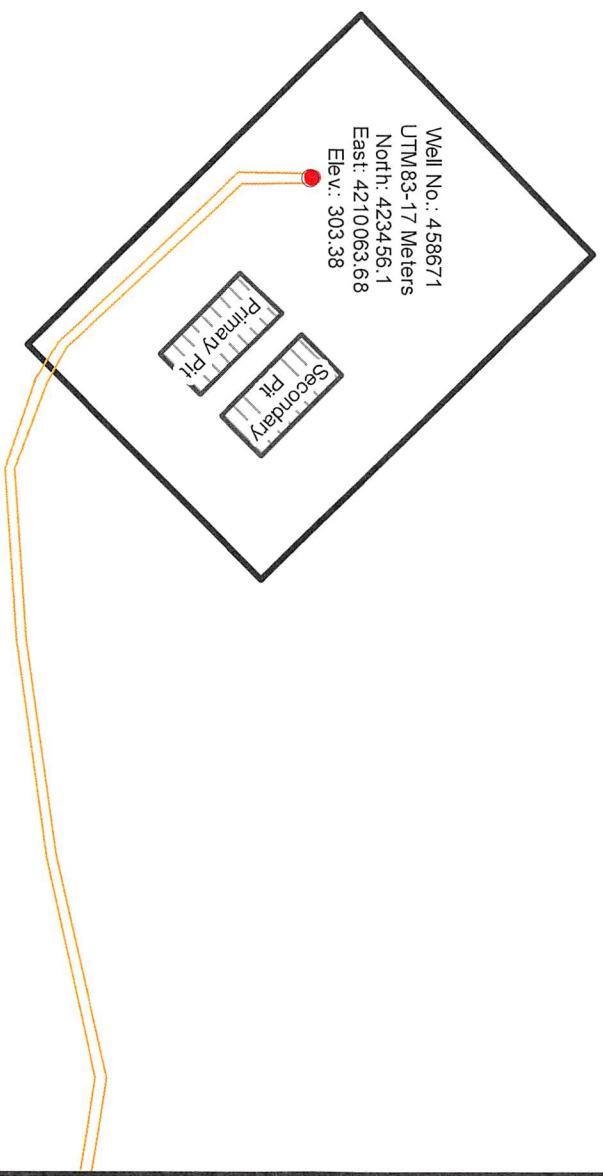





Diversified Gas & Oil  
Corporation  
100 Diversified Way  
Pikeville KY, 41051

458671

Plugging Map

**Legend**

-  Well
-  Sediment Control
-  Access Road
-  Pits
-  Pad

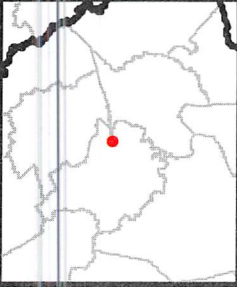

N

1" = 50'

0 12.5 25 50 Feet