

11/18/87

10,460'

LATITUDE 37°52'30"

WELL REFERENCES:
N30°W, 97' TO 14" C. OAK
N61°30'W, 143.50' TO 6" C. OAK

LONGITUDE 81°35'00" 3670'

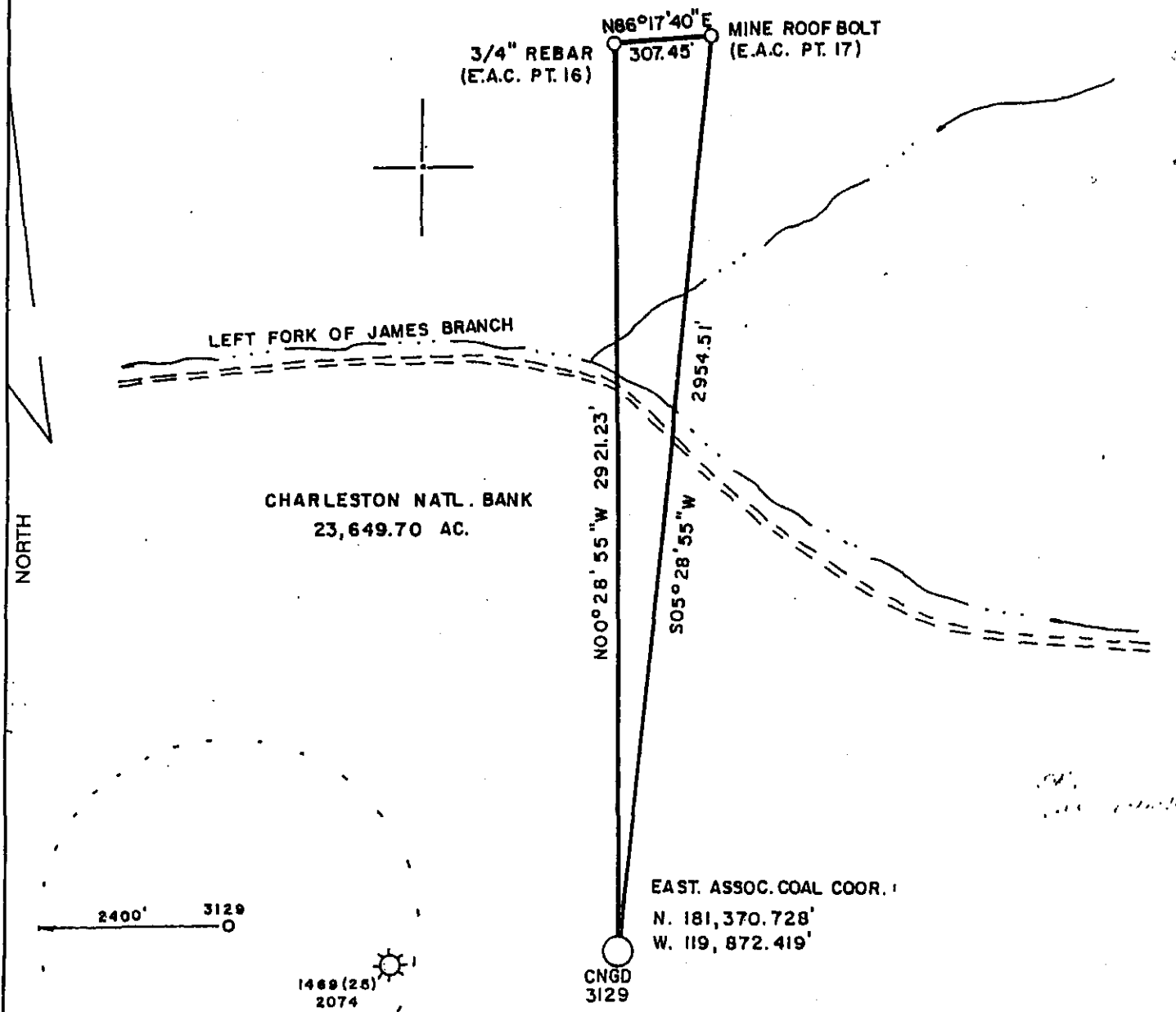

EAST. ASSOC. COAL COOR. I
N. 181,370.728'
W. 119,872.419'

LAND SURVEYING SERVICES
21 CEDAR LANE
BRIDGEPORT, WV 26330
PHONE: 304-842-2018

(+) DENOTES LOCATION OF WELL ON UNITED STATES TOPOGRAPHIC MAPS

FILE NO. _____
DRAWING NO. _____
SCALE 1" = 500'
MINIMUM DEGREE OF ACCURACY 1 in 2500
PROVEN SOURCE OF ELEVATION E.A.C. PT. 17
ELEV. - 1733.70'

I THE UNDERSIGNED, HEREBY CERTIFY THAT THIS PLAT IS CORRECT TO THE BEST OF MY KNOWLEDGE AND BELIEF AND SHOWS ALL THE INFORMATION REQUIRED BY LAW AND THE REGULATIONS ISSUED AND PRESCRIBED BY THE DEPARTMENT OF ENERGY.

(SIGNED) *Stephen D. Losh*
R.P.E. _____ L.L.S. 674
STEPHEN D. LOSH

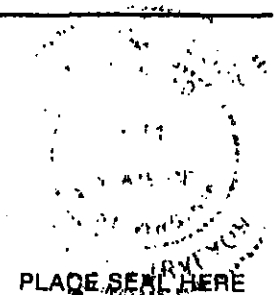

STATE OF WEST VIRGINIA
DEPARTMENT OF ENERGY
OIL AND GAS DIVISION



DATE SEPTEMBER 24, 19 87
OPERATOR'S WELL NO. 3129
API WELL NO. _____

47 - 005 - 1475P
STATE COUNTY PERMIT

WELL TYPE: OIL ___ GAS LIQUID INJECTION ___ WASTE DISPOSAL ___
(IF "GAS,") PRODUCTION STORAGE ___ DEEP ___ SHALLOW
LOCATION: ELEVATION 2060' WATERSHED JAMES BRANCH OF POND FORK
DISTRICT CROOK COUNTY BOONE
QUADRANGLE PILOT KNOB 7.5 min

SURFACE OWNER CHARLESTON NATIONAL BANK ACREAGE 18,804.55
OIL & GAS ROYALTY OWNER CHARLESTON NATIONAL BANK LEASE ACREAGE 23,649.70
LEASE NO. 80210

PROPOSED WORK: DRILL CONVERT ___ DRILL DEEPER ___ REDRILL ___ FRACTURE OR STIMULATE ___ PLUG OFF OLD FORMATION ___ PERFORATE NEW FORMATION ___ OTHER PHYSICAL CHANGE IN WELL (SPECIFY) _____
NOV 17 2006

PLUG AND ABANDON ___ CLEAN OUT AND REPLUG ___
TARGET FORMATION WEIR ESTIMATED DEPTH 3970'
WELL OPERATOR ~~CNO DEVELOPMENT COMPANY~~ DESIGNATED AGENT GARY A. NICHOLAS
ADDRESS ~~ONE PARK RIDGE CENTER~~ ADDRESS RT. 2, BOX 698
~~PITTSBURGH, PA 15244~~ EASTERN ASSOCIATED COAL BRIDGEPORT, WV 26330

FORM 300W-6

COUNTY NAME BOONE PERMIT 1475P

4-11-1904

JS 11/18/87

10,460'

3755

LATITUDE 37°52'30"

WELL REFERENCES:
N30°W, 97' TO 14" C. OAK
N61°30'W, 143.50' TO 6" C. OAK

3/4" REBAR
(E.A.C. PT. 16)

N86°17'40"E
307.45'

MINE ROOF BOLT
(E.A.C. PT. 17)

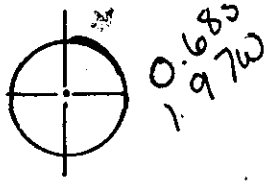

LEFT FORK OF JAMES BRANCH

CHARLESTON NATL. BANK
23,649.70 AC.

N00°28'55"W 2921.23'

S05°28'55"W 2954.51'

3.56
1.97

NORTH

LONGITUDE 81°35'00" 3670

2400' 3129

1469 (25)
2074

CNGD
3129

EAST. ASSOC. COAL COOR. :

N. 181,370.728'
W. 119,872.419'

OK,
GTR 10/20/87

LAND SURVEYING SERVICES
21 CEDAR LANE
BRIDGEPORT, WV 26330
PHONE : 304-842-2018

(+) DENOTES LOCATION OF WELL ON UNITED STATES TOPOGRAPHIC MAPS

FILE NO. _____
DRAWING NO. _____
SCALE 1" = 300'
MINIMUM DEGREE OF
ACCURACY 1 in 2500
PROVEN SOURCE OF
ELEVATION E.A.C. PT. 17
ELEV. - 1733.70'

I THE UNDERSIGNED, HEREBY CERTIFY THAT
THIS PLAT IS CORRECT TO THE BEST OF MY
KNOWLEDGE AND BELIEF AND SHOWS ALL THE
INFORMATION REQUIRED BY LAW AND THE REGU-
LATIONS ISSUED AND PRESCRIBED BY THE DEPART-
MENT OF ENERGY.

(SIGNED) *Stephen D. Losh*

R.P.E. _____ I.L.S. 674
STEPHEN D. LOSH

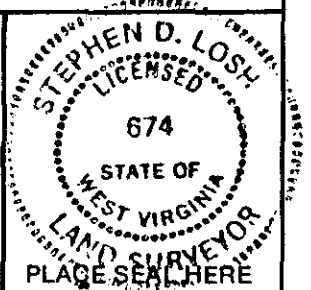

STATE OF WEST VIRGINIA
DEPARTMENT OF ENERGY
OIL AND GAS DIVISION



DATE SEPTEMBER 24, 19 87
OPERATOR'S WELL NO. 3129
API WELL NO.

47 - 005 - 1475
STATE COUNTY PERMIT

WELL TYPE: OIL ___ GAS ___ LIQUID INJECTION ___ WASTE DISPOSAL ___
(IF "GAS,") PRODUCTION ___ STORAGE ___ DEEP ___ SHALLOW ___

LOCATION: ELEVATION 2080' WATER SHED JAMES BRANCH OF POND FORK
DISTRICT CROOK 1 COUNTY BOONE

QUADRANGLE PILOT KNOB 7.5 min 547 006 CS Bald Knob
SURFACE OWNER CHARLESTON NATIONAL BANK ACREAGE 18,804.55

OIL & GAS ROYALTY OWNER CHARLESTON NATIONAL BANK LEASE ACREAGE 23,649.70
LEASE NO. 80210

PROPOSED WORK: DRILL ___ CONVERT ___ DRILL DEEPER ___ REDRILL ___ FRACTURE OR
STIMULATE ___ PLUG OFF OLD FORMATION ___ PERFORATE NEW
FORMATION ___ OTHER PHYSICAL CHANGE IN WELL (SPECIFY) _____

PLUG AND ABANDON ___ CLEAN OUT AND REPLUG ___

NOV 23 1987

TARGET FORMATION WEIR ESTIMATED DEPTH 3970'

WELL OPERATOR CNG DEVELOPMENT COMPANY DESIGNATED AGENT GARY A. NICHOLAS

ADDRESS ONE PARK RIDGE CENTER ADDRESS RT. 2, BOX 698

PITTSBURGH, PA 15244 142 BRIDGEPORT, WV 26330

6-6 Mann-Oceana (266)

FORM WW-6

COUNTY NAME PERMIT



IV-35
(Rev 8-81)

Date August 11, 1988
Operator's
Well No. CNGD WN 3129
Farm Charleston Nat'l Bank
API No. 47-005-1475

RECEIVED State of West Virginia
AUG 17 1988 Department of Mines
Oil and Gas Division

DIVISION OF OIL & GAS DEPARTMENT OF ENERGY WELL OPERATOR'S REPORT
OF
DRILLING, FRACTURING AND/OR STIMULATING, OR PHYSICAL CHANGE

WELL TYPE: Oil ___ / Gas x / Liquid Injection ___ / Waste Disposal ___ /
(If "Gas," Production x / Underground Storage ___ / Deep ___ / Shallow x /)

LOCATION: Elevation: 2080 Watershed James Branch of Pond Fork
District: Crook County Boone Quadrangle Pilot Knob

COMPANY CNG Development Company

ADDRESS P. O. Box 15746
Pittsburgh, PA 15244

DESIGNATED AGENT Gary A. Nicholas

ADDRESS Rt. 2 Box 698
Bridgetown, WV 26330

SURFACE OWNER Charleston Nat'l Bank

ADDRESS P. O. Box 1113
Charleston, WV 25324

MINERAL RIGHTS OWNER Charleston Nat'l Bank

ADDRESS P. O. Box 1113
Charleston, WV 25324

OIL AND GAS INSPECTOR FOR THIS WORK

Jerry Holcomb ADDRESS Rt. 2, Box 159-Hwy #34
Hamlin, WV 25523

PERMIT ISSUED Nov. 19, 1988

DRILLING COMMENCED July 15, 1988

DRILLING COMPLETED July 21, 1988

IF APPLICABLE: PLUGGING OF DRY HOLE ON
CONTINUOUS PROGRESSION FROM DRILLING OR
REWORKING. VERBAL PERMISSION OBTAINED
ON _____

Casing Tubing	Used in Drilling	Left in Well	Cement fill up Cu. ft.
Size 20-16 Cond.			
13-10"			
9 5/8			
8 5/8	1284	1284	To Surf.
7			
5 1/2			
4 1/2	4113	4113	150 sks +
3			
2			
Liners used			

GEOLOGICAL TARGET FORMATION Weir Depth 3970 feet

Depth of completed well 4153 feet Rotary x / Cable Tools _____

Water strata depth: Fresh _____ feet; Salt _____ feet

Coal seam depths: 125 - 128
257 - 260 Is coal being mined in the area? NO

OPEN FLOW DATA

Producing formation Berea Weir Pay zone depth 4023-4027
3817-3832 feet

Gas: Initial open flow _____ Mcf/d Oil: Initial open flow _____ Bbl/d

Final open flow 3.916 Mcf/d Final open flow _____ Bbl/d

Time of open flow between initial and final tests 4 hours

Static rock pressure 700 psig (surface measurement) after 24 hours shut in

(If applicable due to multiple completion--)

Second producing formation _____ Pay zone depth _____ feet

Gas: Initial open flow _____ Mcf/d Oil: Initial open flow _____ Bbl/d

Final open flow _____ Mcf/d Oil: Final open flow _____ Bbl/d

Time of open flow between initial and final tests _____ hours

Static rock pressure _____ psig (surface measurement) after _____ hours shut in

(Continue on reverse side)

AUG 22 1988

DETAILS OF PERFORATED INTERVALS, FRACTURING OR STIMULATING, PHYSICAL CHANGE, ETC.

Perf. Berea 4023 - 4027, 20 holes, .39; Weir 3817 - 3832, 22 holes, .39.
Foam Frac 1st stage - Breakdown 1100#, 344,600 SCF N₂, Ave Rate 6.2 BPM, Ave Pr 1470#, 60,000# 20/40 Sand, Ave HHP 1200#, BHTP 1900#, flushed with 500 gal Acid, ran 10 mc, sc 46 + 25 mc IR 192. 2nd stage - Breakdown 1500#, 389,900 SCF N₂, Ave Rate 6.3 BPM, Ave Pr. 1480#, 52,000# 20/40 Sand, 18,000# 16/30 Sand, BHTP 1900#, Ave HHP 1200#, 500 gal acid, ran sc46, 10 mc, IR192, 30 mc

WELL LOG

FORMATION	COLOR	HARD OR SOFT	TOP FEET	BOTTOM FEET	REMARKS Including indication of all free and salt water, coal, oil and c
Sand			0	125	
Coal			125	128	Coal 125 - 128
Sand			128	257	257 - 260
Coal			257	260	
Sand			260	562	
Open Mine			562	566	
Sand & Shale			566	2581	
Avis			2581	2615	
Shale			2615	2646	
U.Maxton			2646	2702	
Shale			2702	2777	
Maxton			2777	2933	
Shale			2933	3070	
L.Maxton			3070	3153	
Shale			3153	3162	
L.Lime			3162	3225	
B.Lime			3225	3545	
Shale			3545	3820	
Weir			3820	3835	
Shale			3835	4022	
Berea			4022	4030	
Shale			4030	4150	
LOG TOPS ✓					
Avis Ls			2583(-493)	2616(-526)	
Upper Maxton			2781(-691)	2881(-791)	
Maxton			2881(-791)	2917(-827)	
Lower Maxton			3074(-984)	3080(-990)	
Little Lime			3128(-1038)	3187(-1097)	
Big Lime			3260(-1170)	3534(-1444)	
Weir			3816(-1726)	3832(-1742)	
Berea			4024(-1934)	4027(-1937)	

RECEIVED
AUG 17 1988

DIVISION OF OIL & GAS
DEPARTMENT OF ENERGY

(Attach separate sheets as necessary)

CNG DEVELOPMENT COMPANY

Well Operator

By:

Paul Biggs

Date:

August 11, 1988

Note: Regulation 2.02(i) provides as follows:

"The term 'log' or 'well log' shall mean a systematic detailed geological record of all formations, including coal, encountered in the drilling of a well."

005-1475 Expires 11/19/89 19 005 1475

**STATE OF WEST VIRGINIA
DEPARTMENT OF ENERGY, DIVISION OF OIL AND GAS
WELL WORK PERMIT APPLICATION**

- 1) Well Operator: CNG Development Company 10/10 1421 546
- 2) Operator's Well Number: CNGD 3129 3) Elevation: 2080
- 4) Well type: (a) Oil ___ / or Gas X /
 (b) If Gas: Production X / Underground Storage ___ /
 Deep ___ / Shallow X /
- 5) Proposed Target Formation(s): Weir 387
- 6) Proposed Total Depth: 3970 feet
- 7) Approximate fresh water strata depths: -
- 8) Approximate salt water depths: - 1325?
open mine at 250-260
- 9) Approximate coal seam depths: 24, 104, 812, 1007, 1032 210-224, 221-260
- 10) Does land contain coal seams tributary to active mine? Yes ___ / No - /
From Beome 1025, 1466, 1469
- 11) Proposed Well Work:
- 12)

RECEIVED
NOV 03 1987

DIVISION OF OIL & GAS
DEPARTMENT OF ENERGY

CASING AND TUBING PROGRAM

TYPE	SPECIFICATIONS		FOOTAGE INTERVALS			CEMENT Fill-up (cu. ft.)
	Size	Grade	Weight per ft.	For drilling	Left in well	
Conductor						
Fresh Water	11-3/4	H-40	42	40	40	C/S
Coal						38CSR18-11.3
Intermediate	8-5/8	X-42	23	1300	1300	38CSR18-11.22 to surface
Production	4-1/2	J-55	10.5	3970	3970	38CSR18-11.1 200 - 400
Tubing	1-1/2	CN-55	2.75			
Liners						

PACKERS : Kind _____
 Sizes By rule 15.05 _____
 Depths set By rule 15.01 _____

For Division of Oil and Gas Use Only

236
20192
Fee(s) paid: Well Work Permit Reclamation Fund WPCP
 Plat WW-9 WW-2B Bond 50. Blanket Agent
 (Type)

RECEIVED
NOV 03 1987

DIVISION OF OIL & GAS
DEPARTMENT OF ENERGY

- 1) Date: October 27, 1987
- 2) Operator's well number
CNGD 3129
- 3) API Well No: 47 - 005 - 1475
State - County - Permit

STATE OF WEST VIRGINIA
DEPARTMENT OF ENERGY, DIVISION OF OIL AND GAS

NOTICE AND APPLICATION FOR A WELL WORK PERMIT

- 4) Surface Owner(s) to be served:
 - (a) Name CNB, Trustee of the
Address Donald D. Shepard Trust
P.O. Box 1113, Charleston, WV
 - (b) Name _____
Address _____
 - (c) Name _____
Address _____
- 5) (a) Coal Operator:
 - Name _____
Address 25324
 - (b) Coal Owner(s) with Declaration
Name Same as Surface Owner
Address _____
 - Name _____
Address _____
 - (c) Coal Lessee with Declaration
Name Eastern Associated Coal Corp.
Address P.O. Box 1233
Charleston, WV 25324
- 6) Inspector Jerry Holcomb
Address Rt. 2, Box 159-Hwy #34
Hamlin, WV 25523
Telephone (304)- 924 5963

TO THE PERSON(S) NAMED ABOVE TAKE NOTICE THAT:

_____ Included is the lease or leases or other continuing contract or contracts by which I hold the right to extract oil and gas OR

X Included is the information required by Chapter 22B, Article 1, Section 8(d) of the Code of West Virginia (see page 2)

I certify that as required under Chapter 22B of the West Virginia Code I have served copies of this notice and application, a location plat, and accompanying documents pages 1 through _____ on the above named parties, by:

- _____ Personal Service (Affidavit attached)
- X Certified Mail (Postmarked postal receipt attached)
- _____ Publication (Notice of Publication attached)

I have read and understand Chapter 22B and 38 CSR 11-18, and I agree to the terms and conditions of any permit issued under this application.

I certify under penalty of law that I have personally examined and am familiar with the information submitted on this application form and all attachments, and that based on my inquiry of those individuals immediately responsible for obtaining the information, I believe that the information is true, accurate, and complete.

I am aware that there are significant penalties for submitting false information, including the possibility of fine and imprisonment.

Well Operator CNG Development Company
 By: [Signature]
 Its: Supervisor, Well Programs
 Address One Park Ridge Center, P.O. Box 15746
Pittsburgh, PA 15244
 Telephone (412) 787-4117

Subscribed and sworn before me this 27th day of October, 1987

[Signature] Notary Public
 My commission expires December 19, 1988