

Latitude 38° 10'

Longitude 81° 45'

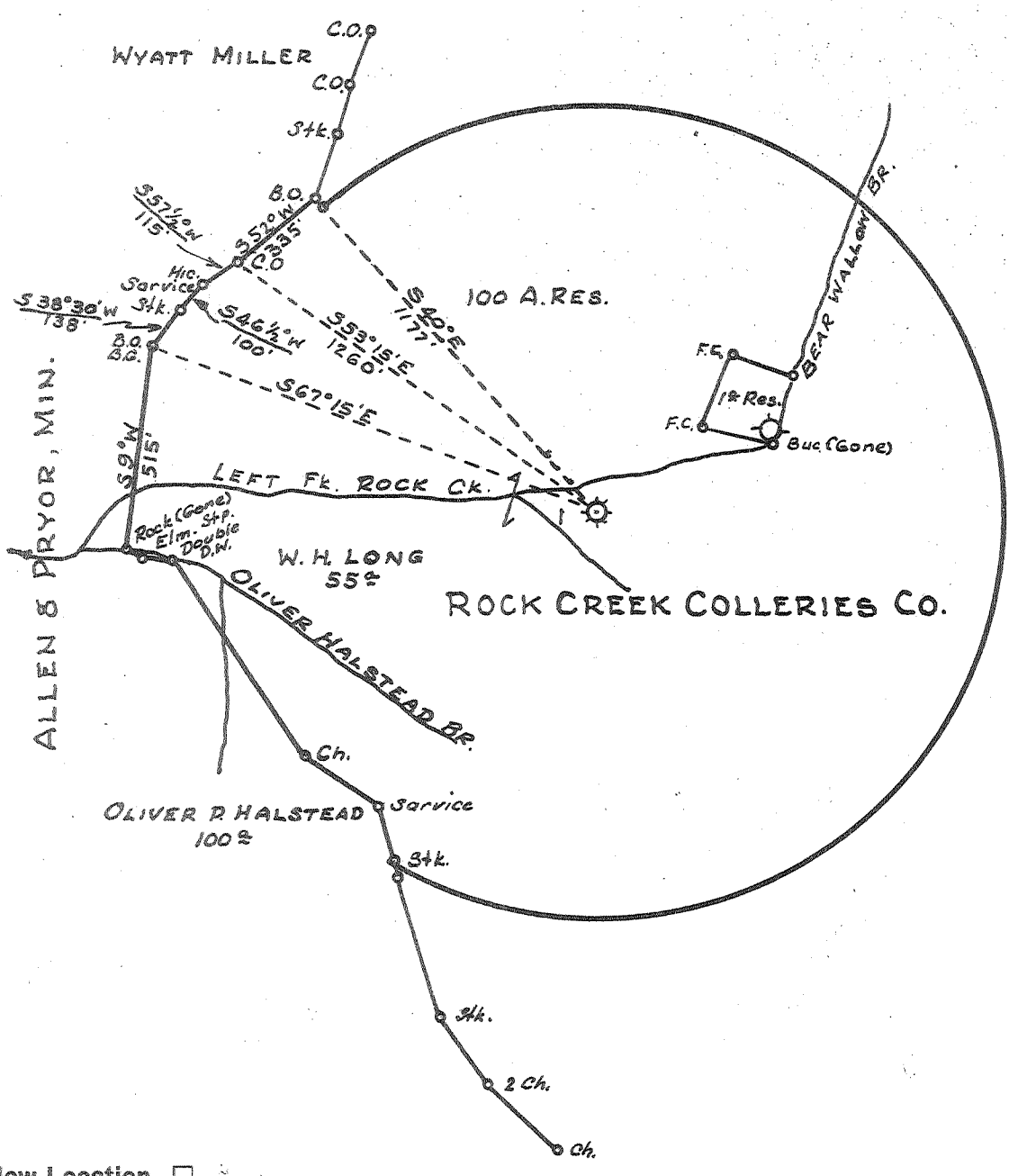

New Location ..
 Drill Deeper
 Abandonment.....

Company	PACK & JACKSON
Address	HAMLIN, W. VA.
Farm	ROCK CREEK COLLIERIES CO
Tract	1 Acres 100 Lease No.
Well (Farm) No.	1 Serial No. 52-F302
Elevation (Spirit Level)	934.1
Quadrangle	MADISON
County	BOONE District SCOTT
Engineer	PAUL E. JOACHIM
Engineer's Registration No.	669
File No.	54-41 Drawing No.
Date	SEPT. 18, 1959 Scale 1" = 500'

STATE OF WEST VIRGINIA
 DEPARTMENT OF MINES
 OIL AND GAS DIVISION
 CHARLESTON

WELL LOCATION MAP
 FILE NO. 300-344-A

+ Denotes location of well on United States Topographic Maps, scale 1 to 62,500, latitude and longitude lines being represented by border lines as shown.
 - Denotes one inch spaces on border line of original tracing.



STATE OF WEST VIRGINIA
DEPARTMENT OF MINES
OIL AND GAS DIVISION

757

WELL RECORD

Permit No. 3448

Oil or Gas Well Gas
(KIND)

Company The Owens Bottle Co.
Address P. O. Box 4158, Charleston, W. Va.
Farm Rock Creek Colliery Co. Acres 100
Location (waters) Left Fork of Rock Creek
Well No. 1 (Serial #52) Elev. 933
District Scott County Boone
The surface of tract is owned in fee by Same
Address _____
Mineral rights are owned by Rock Creek Colliery Co.
812 Peoples Bk. Bldg. Address Lynchburg, Virginia
Drilling commenced 2/24/14
Drilling completed 10/30/14
Date Shot _____ From _____ To _____
With _____
Open Flow _____ /10ths Water in _____ Inch
_____ /10ths Merc. in _____ Inch
Volume _____ Cu. Ft.
Rock Pressure _____ lbs. _____ hrs.
Oil _____ bbls., 1st 24 hrs.
Fresh water _____ feet _____ feet
Salt water _____ feet _____ feet

Casing and Tubing	Used in Drilling	Left in Well	Packers
Size			Kind of Packer
16			<u>special</u>
13	<u>31</u>	<u>31</u>	Size of <u>6 5/8 x 2</u>
10			Depth set <u>1360</u>
8 1/2			Perf. top _____
6 5/8	<u>1354</u>	<u>1354</u>	Perf. bottom _____
5 3/16			Perf. top _____
3			Perf. bottom _____
2	<u>1571</u>	<u>1571</u>	
Liners Used			

CASING CEMENTED _____ SIZE _____ No. Ft. _____ Date _____
COAL WAS ENCOUNTERED AT _____ FEET _____ INCHES
_____ FEET _____ INCHES FEET _____ INCHES
_____ FEET _____ INCHES FEET _____ INCHES

Formation	Color	Hard or Soft	Top	Bottom	Oil, Gas or Water	Depth Found	Remarks
Sand & gravel			0	30			
Sand			30	60	Water	60	
Slate & Shells			60	208			
Slate			208	220	Water	208	
Sand			220	345			
Slate			345	348			
Sand			348	428			
Slate			428	441			
Sand			441	695	Water	505	
Slate			695	702			
Sand			702	895	Water	855	
Slate			895	939			
Sand			939	1055			
Slate			1055	1075			
rock	red		1075	1080			
Slate			1080	1100			
rock	red		1100	1133			
Slate			1133	1148			
Sand			1148	1190			
Slate & Shells			1190	1260			
Black Lime			1260	1300			
Big Lime			1300	1467			
Sand			1467	1470			
Slate			1470	1472			
Sand			1472	1495			
Big Injun			1495	1525			
Slate & Shells			1525	1563			
Total depth				1563			

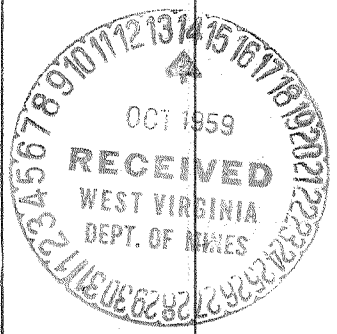

Test June, 1919
2,069,000 Cu. Ft

MAR 26 1960