

Latitude 38 15'

Longitude 81 40'

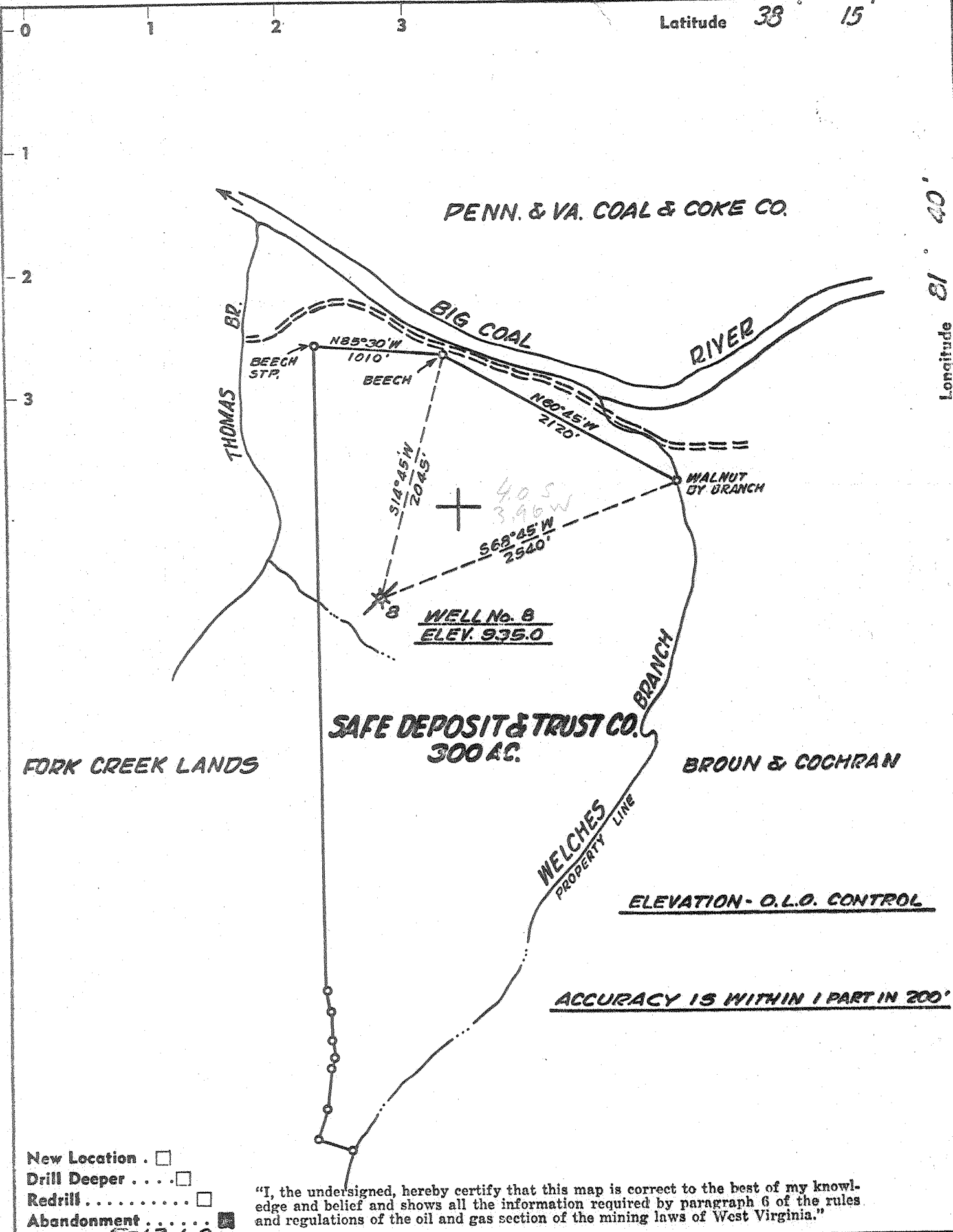

- New Location .
- Drill Deeper . . . .
- Redrill . . . . .
- Abandonment . . . . .

"I, the undersigned, hereby certify that this map is correct to the best of my knowledge and belief and shows all the information required by paragraph 6 of the rules and regulations of the oil and gas section of the mining laws of West Virginia."

5-13-69

Company BLUE CREEK GAS COMPANY  
 Address BOX 6357, CHARLESTON, W. VA.  
 Farm SAFE DEPOSIT & TRUST CO.  
 Tract \_\_\_\_\_ Acres 300 Lease No. \_\_\_\_\_  
 Well (Farm) No. 8 Serial No. \_\_\_\_\_  
 Elevation (Spirit Level) 935.0  
 Quadrangle PEYTONA NW  
 County BOONE District PEYTONA  
 Engineer [Signature]  
 Engineer's Registration No. 773  
 File No. \_\_\_\_\_ Drawing No. \_\_\_\_\_  
 Date JULY 16, 1968 Scale 1"=1000 FT.

STATE OF WEST VIRGINIA  
 DEPARTMENT OF MINES  
 OIL AND GAS DIVISION  
 CHARLESTON

**WELL LOCATION MAP**  
 FILE NO. Boo-441 (A)

+ Denotes location of well on United States Topographic Maps, scale 1 to 62,500, latitude and longitude lines being represented by border lines as shown.  
 - Denotes one inch spaces on border line of original tracing.