

FORM WV 6

LATITUDE 38°47'30"

450'

WELL NO. 1
A.P.I. 47-007-0933
STATE PLANE COORDINATES
(SOUTH ZONE)

MYRTLE TAYLOR HEIRS LEASE

88.75 ACRES ±

WELL NO. 1

A.P.I. 47-007-0933

N. 648,610
E. 2,094,680

RICHARD B. FERGUSON, ET AL.
143.89 ACRES ±

LAT=(N) 38.78048
LONG=(W) 80.66824

UTM (NAD83)
N. 4,292,480
E. 528,832

JOEY E. UNDERWOOD, ET AL.
12.59 ACRES ±

JOEY E. UNDERWOOD, ET AL.
12.59 ACRES ±

JOEY E. UNDERWOOD, ET AL.
12.59 ACRES ±

JOEY E. UNDERWOOD, ET AL.
12.59 ACRES ±

TIMOTHY M. SIMONS
28 ACRES ±

RETTA TAYLOR
43.03 ACRES ±

MIKE ROSS INC., ET AL.
71.84 ACRES ±

RETTA TAYLOR
12.5 ACRES ±

LAWRENCE DEAN
74.87 ACRES ±

NOTES ON SURVEY

1. TIES TO WELLS AND CORNERS ARE BASED ON GRID NORTH FOR THE WV STATE PLANE COORDINATE SYSTEM SOUTH ZONE NAD '27.
2. LEASE BOUNDARY SHOWN HEREON TAKEN FROM A PLAT DATED JUNE 03, 1970 AS PREPARED FOR A.P.I. NO. 47-007-0933.
3. SURFACE OWNER AND ADJOINER INFORMATION TAKEN FROM THE ASSESSOR AND COUNTY CLERK RECORDS OF BRAXTON COUNTY IN JULY, 2011.
4. WELL LAT./LONG. (NAD'27) ESTABLISHED BY DGPS (SUBMETER MAPPING GRADE).

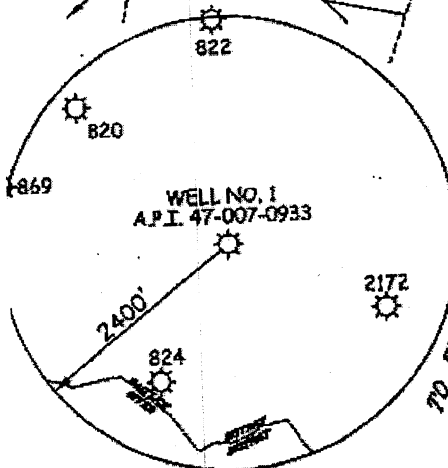

I THE UNDERSIGNED, HEREBY CERTIFY THAT THIS PLAT IS CORRECT TO THE BEST OF MY KNOWLEDGE AND BELIEF AND SHOWS ALL THE INFORMATION REQUIRED BY LAW AND THE REGULATIONS ISSUED AND PRESCRIBED BY THE DIVISION OF ENVIRONMENTAL PROTECTION.

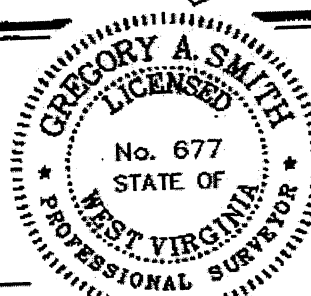

P.S. 577

Gregory A. Smith

(*) DENOTES LOCATION OF WELL ON UNITED STATES TOPOGRAPHIC MAPS.

DATE OCTOBER 19, 20 11

OPERATORS WELL NO. TAYLOR HEIRS #1

API WELL NO. 47 - 007 - 00933P
STATE COUNTY PERMIT

MINIMUM DEGREE OF ACCURACY

1/200

FILE NO. 7745P933 (387-16)

SCALE 1" = 500'

PROVEN SOURCE OF ELEVATION

DGPS (SUBMETER MAPPING GRADE)

STATE OF WEST VIRGINIA
DIVISION OF ENVIRONMENTAL PROTECTION
OFFICE OF OIL AND GAS



WELL TYPE: OIL GAS X LIQUID INJECTION WASTE DISPOSAL IF "GAS" PRODUCTION X STORAGE DEEP SHALLOW X

LOCATION: ELEVATION 1,168' WATERSHED TRIBUTARY OF BURNS RUN

DISTRICT SALT LICK COUNTY BRAXTON QUADRANGLE BURNSVILLE 7.5'

SURFACE OWNER MIKE ROSS, INC., ET AL ACREAGE 71.84 ±

ROYALTY OWNER MIKE ROSS, INC., ET AL LEASE ACREAGE 88.75 ±

PROPOSED WORK: DRILL CONVERT DRILL DEEPER REDRILL FRACTURE OR STIMULATE PLUG OFF OLD

FORMATION PERFORATE NEW FORMATION PLUG AND ABANDON X CLEAN OUT AND REPLUG OTHER

PHYSICAL CHANGE IN WELL (SPECIFY) TARGET FORMATION GORDON ESTIMATED DEPTH 2590'

WELL OPERATOR MIKE ROSS INC., dba ROSS & WHARTON GAS CO. DESIGNATED AGENT MIKE ROSS

ADDRESS BOX 219 ADDRESS BOX 219

10/28/2011

COUNTY NAME PERMIT