

LONG. 80° 32' 54.0" → ← 1990'

LATITUDE 40° 15'

80° 32' 30"

EQUINOCT

13150' LAT 40° 12' 50.0"

UTM CO-ORDS
X=538393
Y=4451380

SPORTSMANS

I CERTIFY THAT
CARMAN #1 IS + 400'
FROM ANY LEASE LINE
AND IS + 3000' FROM
ANY PERMITTED DEEP
WELL THIS DATE.

MARK A. FEDAK

63.1 AC.

111.9 AC.

586-24E
1630.2

80 AC.

MARK WEAVER OWEN

STONE
N.F.C.
LINE

POST ON
BANK OF
RUN

#1
ELEV. 1141'
53.72 AC.

NO WELLS PERMITTED
WITHIN 3000'
THIS DATE

NORTH

STATE
ROUTE 88

BETHANY
COLLEGE

WASH
CREEK
EXCH

W BUFFALO
CREEK

BETHANY
COLLEGE

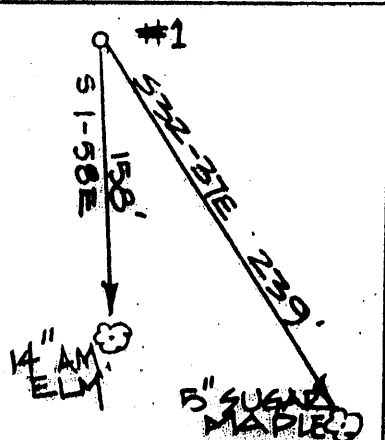

(+) DENOTES LOCATION OF WELL ON UNITED STATES TOPOGRAPHIC MAPS

FILE NO. _____
DRAWING NO. _____
SCALE 1" = 1000'
MINIMUM DEGREE OF
ACCURACY 1:200
PROVEN SOURCE OF
ELEVATION
G.P.S. SURVEY

I THE UNDERSIGNED, HEREBY CERTIFY THAT
THIS PLAT IS CORRECT TO THE BEST OF MY
KNOWLEDGE AND BELIEF AND SHOWS ALL THE
INFORMATION REQUIRED BY LAW AND THE REGU-
LATIONS OF THE STATE OF WEST VIRGINIA
MENT TO BE COMPLIED WITH IN THE
(SIGNED) William R. Mossor
R.P.E. _____ P.S. 551



STATE OF WEST VIRGINIA
DEPARTMENT OF ENERGY
DIVISION OF OIL AND GAS



DATE 20 SEPTEMBER 01
OPERATOR'S WELL NO. _____
API WELL NO. 47 009 00081
STATE COUNTY PERMIT

WELL TYPE: OIL GAS X LIQUID INJECTION WASTE DISPOSAL
(IF "GAS,") PRODUCTION X STORAGE DEEP X SHALLOW
LOCATION: ELEVATION 1141' WATER SHED BOTHEZATION RUN OF BUFFALO CREEK
DISTRICT BUFFALO COUNTY BROOKE
QUADRANGLE BETHANY

SURFACE OWNER KIMBERLY J. CARMAN ACREAGE 80
OIL & GAS ROYALTY OWNER KIMBERLY J. CARMAN LEASE ACREAGE 310 ±
PROPOSED WORK: DRILL X CONVERT DRILL DEEPER REDRILL FRACTURE OR
STIMULATE PLUG OFF OLD FORMATION PERFORATE NEW
FORMATION OTHER PHYSICAL CHANGE IN WELL (SPECIFY) TEST WELL

PLUG AND ABANDON CLEAN OUT AND REPLUG
TARGET FORMATION GRANITE - WASH ESTIMATED DEPTH BASEMENT
WELL OPERATOR MARTIN WITENBERG DESIGNATED AGENT CHARLES DOLLISON
ADDRESS 2644 CONNER DR CHARLESTON, WV 25302 ADDRESS 600 QUAIL CREEK ST CHARLESTON, WV 25302

COUNTY NAME BROOKE
PERMIT 0081 CANCELLED

LONG. 80° 32' 54.0" → 1990'

LATITUDE 40° 15'

UTM CO-ORD'S
X=538393
Y=4451380

SPORTSMANS

I CERTIFY THAT
CARMAN #1 IS + 400'
FROM ANY LEASE LINE
AND IS + 3000' FROM
ANY PERMITTED DEEP
WELL THIS DATE.

80° 32' 30"

LONGITUDE

13150' LAT 40° 12' 50.0'

MARK A. FEDAK

63.1 AC.

111.9 AC.

POST HOLE
@ FNC INTER

586-24E

1630.2

MARK WEAVER
OWEN

80 AC.

STONE
IN FNC.
LINE

2.49
38

STATE
ROUTE 28

BETHANY
COLLEGE

N
W
A
V
E
M
A
N
E
A
C
H

N 74° E

1815'

N 74° E

1344'

N 74° E

1344'

N 74° E

1344'

N 74° E

1344'

N 74° E

1344'

N 74° E

1344'

N 74° E

1344'

N 74° E

1344'

N 74° E

1344'

N 74° E

1344'

N 74° E

1344'

N 74° E

1344'

2187'

N 74° E

1344'

N 74° E

1344'

N 74° E

1344'

N 74° E

1344'

N 74° E

1344'

N 74° E

1344'

N 74° E

1344'

N 74° E

1344'

N 74° E

1344'

N 74° E

1344'

N 74° E

1344'

N 74° E

1344'

N 74° E

ELEV. 1141'
53.72 AC.

NO PERMITTED
WELLS
WITHIN 3000'
THIS DATE

BUFFALO CREEK

BETHANY
COLLEGE

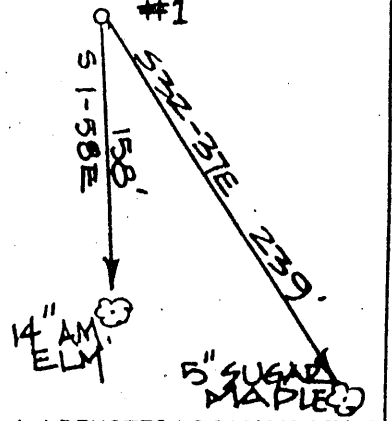

(+) DENOTES LOCATION OF WELL ON UNITED STATES TOPOGRAPHIC MAPS

FILE NO. _____
DRAWING NO. _____
SCALE 1" = 1000'
MINIMUM DEGREE OF ACCURACY 1:200
PROVEN SOURCE OF ELEVATION G.P.S. SURVEY

I THE UNDERSIGNED, HEREBY CERTIFY THAT THIS PLAT IS CORRECT TO THE BEST OF MY KNOWLEDGE AND BELIEF AND SHOWS ALL THE INFORMATION REQUIRED BY LAW AND THE REGULATIONS ISSUED AND PRESCRIBED BY THE DEPARTMENT OF ENERGY AND NATURAL RESOURCES.
(SIGNED) *William R. Mossor*
R.P.E. _____ P.S. 551

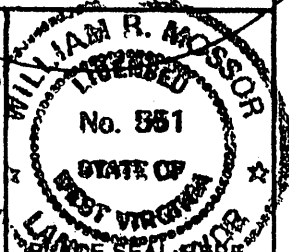

STATE OF WEST VIRGINIA
DEPARTMENT OF ENERGY
DIVISION OF OIL AND GAS



DATE 20 SEPTEMBER 01
OPERATOR'S WELL NO. _____
API WELL NO. _____

WELL TYPE: OIL _____ GAS LIQUID INJECTION _____ WASTE DISPOSAL _____
(IF "GAS,") PRODUCTION STORAGE _____ DEEP SHALLOW _____

LOCATION: ELEVATION 1141' WATER SHED BOTHEATION RUN OF BUFFALO CREEK

DISTRICT BUFFALO COUNTY BROOKE

QUADRANGLE BETHANY

SURFACE OWNER KIMBERLY J. CARMAN ACREAGE 80

OIL & GAS ROYALTY OWNER KIMBERLY J. CARMAN LEASE ACREAGE 310 ±

PROPOSED WORK: DRILL CONVERT _____ DRILL DEEPER _____ REDRILL _____ FRACTURE OR STIMULATE _____ PLUG OFF OLD FORMATION _____ PERFORATE NEW FORMATION _____ OTHER PHYSICAL CHANGE IN WELL (SPECIFY) TEST WELL

PLUG AND ABANDON _____ CLEAN OUT AND REPLUG _____
TARGET FORMATION GRANITE - WASH ESTIMATED DEPTH BASEMENT

WELL OPERATOR MARTIN TWIT ENERGY DESIGNATED AGENT CHARLES DOLLISON

ADDRESS 2644 CONNER DRIVE ADDRESS 602 QUARRIER ST
CHARLESTON, WV 25302 CHARLESTON, WV 25301

QUANTITY NAME 890
PERMIT 0081

FEB 08 2002