

SURFACE HOLE DEC. LONG: 80.535290
SURVEYED LONG: 80° 32' 07.1"

9,790'

Latitude: 40° 20' 00" (NAD 27)

Longitude: 80° 30' 00" (NAD 27)

TOP HOLE (NAD 83) N) 664966.6 E) 1679871.4 LAT.) 40°19'15.7" LONG.) 80°32'06.3" DEC. LAT.) 40.321036 DEC. LONG.) 80.535088	BOTTOM HOLE (NAD 83) N) 661175.2 E) 1681887.4 LAT.) 40°18'38.5" LONG.) 80°31'39.7" DEC. LAT.) 40.310693 DEC. LONG.) 80.527703
TOP HOLE (NAD 27) N) 664929.5 E) 1711305.6 LAT.) 40°19'15.5" LONG.) 80°32'07.1" DEC. LAT.) 40.320966 DEC. LONG.) 80.535296	BOTTOM HOLE (NAD 27) N) 661137.9 E) 1713321.5 LAT.) 40°18'38.2" LONG.) 80°31'40.5" DEC. LAT.) 40.310623 DEC. LONG.) 80.527911

COLLIERS SPORTSMAN'S CLUB
LEASE NUMBER
1-324527-000
4.395 TOTAL ACRES
TAX MAP AND PARCEL
CC20-45

COLLIERS SPORTSMAN'S CLUB
LEASE NUMBER
1-324527-000
67.579 TOTAL ACRES
TAX MAP AND PARCEL
CC20-24

**BUREAU OF THE STATE
OF WEST VIRGINIA**
LEASE NUMBER
1-324527-000
248.98 TOTAL ACRES
TAX MAP AND PARCEL
CC20-25

STARVAGGI INDUSTRIES, INC.
LEASE NUMBER
1-324527-000
63.110 TOTAL ACRES
TAX MAP AND PARCEL
CC16-7

STARVAGGI INDUSTRIES, INC.
LEASE NUMBER
1-324527-000
71.687 TOTAL ACRES
TAX MAP AND PARCEL
CC20-27

STARVAGGI INDUSTRIES, INC.
LEASE NUMBER
1-324527-000
120.061 TOTAL ACRES
TAX MAP AND PARCEL
CC20-31

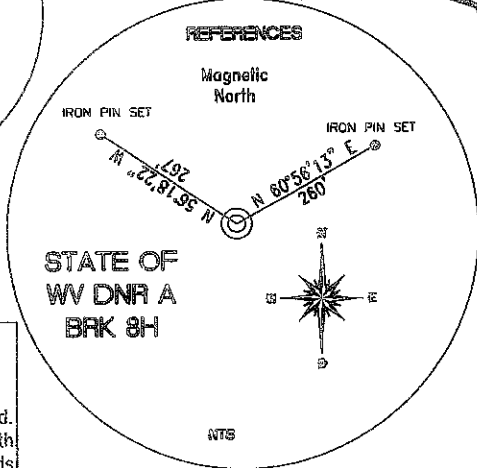
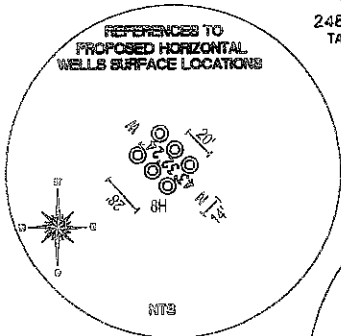
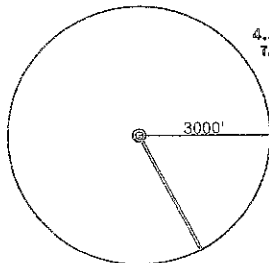

REFERENCE NOTES
Boundaries as shown taken from deeds, tax maps and field locations. A full boundary survey is not expressed nor implied. All bearings are based on true north. Ownership taken from public records Brooke County, West Virginia SEPTEMBER 2011. State Plane Coordinates & NAD 83 Lat/Long by differential submeter mapping grade GPS. Drafted by: E.A.M.

TH (UTM-NAD 83) N) 4463493.8 E) 539498.3
BOTTOM HOLE (UTM-NAD 83) N) 4462349.1 E) 540131.8

FILE #: CHE 094
DRAWING #: 1824
SCALE: 1" = 1200'
MINIMUM DEGREE OF ACCURACY: 1/200
PROVEN SOURCE SUBMETER MAPPING
OF ELEVATION: GRADE GPS

I, THE UNDERSIGNED, HEREBY CERTIFY THAT THIS PLAT IS CORRECT TO THE BEST OF MY KNOWLEDGE AND BELIEF AND SHOWS ALL THE INFORMATION REQUIRED BY LAW AND THE REGULATIONS ISSUED AND PRESCRIBED BY THE DEPARTMENT OF ENVIRONMENTAL PROTECTION.
Signed:
L.L.S. #2124 : Ernest J. Benchek III

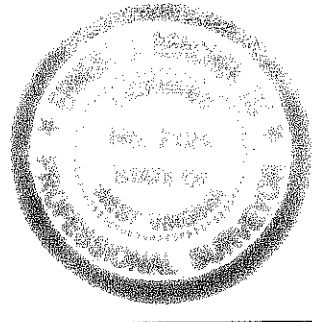

(+) DENOTES LOCATION OF WELL ON UNITED STATES TOPOGRAPHIC MAPS WVDEP
OFFICE OF OIL & GAS
601 57TH STREET
CHARLESTON, WV 25304

Well Type: Oil Waste Diposal Production Deep
 Gas Liquid Injection Storage Shallow

WATERSHED: UPPER OHIO SOUTH ELEVATION: 1,140'
COUNTY/DISTRICT: BROOKE / CROSS CREEK QUADRANGLE: STEUBENVILLE EAST, WV.
SURFACE OWNER: STATE OF WEST VIRGINIA DNR ACREAGE: 63.11 +/-
OIL & GAS ROYALTY OWNER: STARVAGGI INDUSTRIES INC ACREAGE: 575.812 +/-
LEASE NUMBERS:

DRILL CONVERT DRILL DEEPER REDRILL FRACTURE OR STIMULATE
PLUG OFF FORMATION PERFORATE NEW FORMATION PLUG & ABANDON
CLEAN OUT & REPLUG OTHER CHANGE (SPECIFY):

TARGET FORMATION: MARCELLUS ESTIMATED DEPTH: TVD: 6,000 TMD: 10,294
WELL OPERATOR: CHESAPEAKE APPALACHIA, LLC. DESIGNATED AGENT: ERIC GILLESPIE
ADDRESS: PO BOX 18496 ADDRESS: PO BOX 6070
CITY: OKLAHOMA CITY STATE: OK ZIP CODE: 73154-0496 CITY: CHARLESTON STATE: WV ZIP CODE: 25362

DATE: DECEMBER 13, 2011
OPERATOR'S WELL #: STATE OF WV DNR A BRK 8H
API WELL #: 47 09 001254
STATE COUNTY PERMIT

03/23/2012

NEW STATE OF WYOMING A BAK SH
QUAD 8 T14N R10E EAST WY

