

THRASHER

THE THRASHER GROUP, INC.
600 WHITE OAKS BLVD.
BRIDGEPORT, WV 26330
PHONE 304-624-4108

NOTES ON SURVEY

- COORDINATES SYSTEM IS UTM, NAD 83 DATUM, ZONE 17, U.S. FOOT AND WELL COORDINATES ESTABLISHED USING SURVEY GRADE GPS.
- SURFACE AND ROYALTY OWNER INFORMATION AND THEIR BOUNDARIES SHOWN HEREON WERE PLOTTED FROM DEEDS AND/OR TAX PARCEL MAPS PROVIDED BY CLIENT AND FIELD LOCATIONS.
- THIS PLAT DOES NOT REPRESENT A BOUNDARY SURVEY OF THE PARCELS SHOWN HEREON.
- NO DWELLINGS AND BUILDINGS WITHIN 625 FEET OF PROPOSED CENTER OF PAD.
- NO WATER WELLS OR DEVELOPED SPRINGS WITHIN 250 FEET OF PROPOSED WELL.
- NO PERENNIAL STREAMS, LAKES, PONDS, RESERVOIRS OR WETLANDS WITHIN 100 FEET OF THE LIMITS OF DISTURBANCE.
- NO NATURALLY PRODUCING TROUT STREAM WITHIN 300 FEET OF LIMITS OF DISTURBANCE.

GRID NORTH
UTM, NAD83 DATUM, ZONE 17, US FT

SWN PRODUCTION COMPANY, LLC
"RUSSELL HERVEY BRK 210H"
SURFACE HOLE
ELEV: 1166'

Latitude: 39°14'57" 4,232' 190'

Longitude: 84°50'34" 20,319'

TRACT	SURFACE OWNER (S) / ROYALTY OWNER (R)	TAX PARCEL	ACRES
1	(S)RUSSELL D. HERVEY (R)RUSSELL D. HERVEY & LISA K. HERVEY	05-03-828-0045-0000	37.84
2	(S)BROOKE COUNTY PARK COMMISSION (R)RICHARD P. GIST (R)MARGINA GIST ABLITT (R)JANN GIST LEVIN	05-03-828-0064-0000	135.00
3	(S)STARVAGGI INDUSTRIES (R)STARVAGGI INDUSTRIES	05-03-828-0082-0000 05-03-828-0083-0000	3.85 16.88
4	(S)BROOKE COUNTY PARK COMMISSION (R)JAMES ROBERT HERVEY & KAREN L. HERVEY (R)WILLIAM JUDDSON HERVEY II & THERESA J. HERVEY (R)FRED L. HERVEY & CATHY JO HERVEY (R)MARY KATHRYN HERVEY DEGARMO & ALAN H. DEGARMO (R)RUSSELL D. HERVEY & LISA K. HERVEY (R)BROOKE COUNTY PARK & RECREATION COMMISSION	05-03-828-0080-0000	101.81
5	(S)PHOENIX-GREENLAWN PARTNERS (R)JAMES ROBERT HERVEY & KAREN L. HERVEY (R)WILLIAM JUDDSON HERVEY II & THERESA J. HERVEY (R)FRED L. HERVEY & CATHY JO HERVEY (R)MARY KATHRYN HERVEY DEGARMO & ALAN H. DEGARMO (R)RUSSELL D. HERVEY & LISA K. HERVEY	05-30-833-0113-0000	101.55
6	(S)STARVAGGI INDUSTRIES (R)JAMES ROBERT HERVEY & KAREN L. HERVEY (R)WILLIAM JUDDSON HERVEY II & THERESA J. HERVEY (R)FRED L. HERVEY & CATHY JO HERVEY (R)MARY KATHRYN HERVEY DEGARMO & ALAN H. DEGARMO (R)RUSSELL D. HERVEY & LISA K. HERVEY	05-03-833-0026-0000	53.58
7	(S)JAMES H. STEWART (R)JAMES H. STEWART & PAMELA JO STEWART	05-03-833-0031-0000	141.88
8	(S)CHARLES L. & LAURA J. MCGOWAN (R)LAURA G. INMAN AND JAMES C. INMAN JR. (R)KAREN G. YOUNKINS & TERRY D. YOUNKINS	05-03-833-0107-0002	1.01
9	(S)CHARLES L. & LAURA J. MCGOWAN (R)LAURA G. INMAN AND JAMES C. INMAN JR. (R)KAREN G. YOUNKINS & TERRY D. YOUNKINS	05-03-833-0107-0001	1.00
10	(S)JOHN C. WALES, SR. (R)JOHN C. WALES, SR. & BARBARA A. WALES	05-03-833-0110-0000	24.47
11	(S)MARLENE K. HUKILL (R)LAURA G. INMAN AND JAMES C. INMAN JR. (R)KAREN G. YOUNKINS & TERRY D. YOUNKINS	05-03-833-0109-0000	30.00
12	(S)DENZIL H. L. CONLEY & MARY LOU CONLEY (R)LAURA G. INMAN AND JAMES C. INMAN JR. (R)KAREN G. YOUNKINS & TERRY D. YOUNKINS	05-03-833-0108-0000	120.73

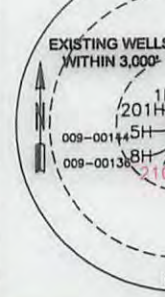

SURFACE HOLE LOCATION (SHL): UTM (NAD83, ZONE 17, METERS): NORTHING: 4,456,496.949 EASTING: 537,707.098	SURFACE HOLE LOCATION (SHL): UTM (NAD83, ZONE 17, METERS): NORTHING: 4,456,496.949 EASTING: 537,707.098
LANDING POINT LOCATION (LPL): UTM (NAD83, ZONE 17, METERS): NORTHING: 4,456,526.710 EASTING: 538,038.087	LANDING POINT LOCATION (LPL): UTM (NAD83, ZONE 17, METERS): NORTHING: 4,456,539.021 EASTING: 538,036.868
BOTTOM HOLE LOCATION (BHL): UTM (NAD83, ZONE 17, METERS): NORTHING: 4,454,044.313 EASTING: 538,959.612	BOTTOM HOLE LOCATION (BHL): UTM (NAD83, ZONE 17, METERS): NORTHING: 4,454,045.307 EASTING: 538,964.190

LINE	DESCRIPTION	DISTANCE
L1	N 43°04'25" W	38.81'
L2	N 68°10'56" W	36.00'
L3	N 70°19'04" W	3703.74'
L4	N 32°43'01" W	2697.75'
L5	N 84°45'14" E	1090.30'
L6	S 20°21'58" E	8687.40'

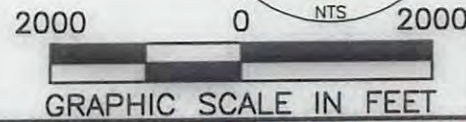
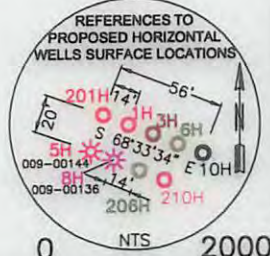

I, THE UNDERSIGNED, HEREBY CERTIFY THAT THIS PLAT IS CORRECT TO THE BEST OF MY KNOWLEDGE AND BELIEF AND SHOWS ALL THE INFORMATION REQUIRED BY LAW AND REGULATIONS ISSUED AND PRESCRIBED BY THE DEPARTMENT OF ENVIRONMENTAL PROTECTION.

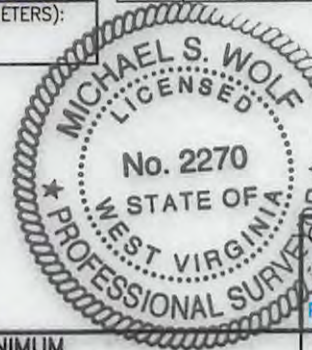

COMPANY: **SWN** Production Company, LLC

(+) DENOTES LOCATION OF WELL ON UNITED STATES TOPOGRAPHIC MAPS WVDEP OFFICE OF OIL & GAS 601 57TH STREET CHARLESTON, WV 25034	MINIMUM DEGREE OF ACCURACY: 1/200 PROVEN SOURCE OF ELEVATION: SURVEY GRADE GPS (NAVD 88, US FT)	RUSSELL HERVEY BRK OPERATOR'S WELL #: 210H API WELL #: 47 009 00172 STATE COUNTY PERMIT
	WELL TYPE: OIL <input type="checkbox"/> WASTE DISPOSAL <input type="checkbox"/> PRODUCTION <input checked="" type="checkbox"/> DEEP <input type="checkbox"/> GAS <input checked="" type="checkbox"/> LIQUID INJECTION <input type="checkbox"/> STORAGE <input type="checkbox"/> SHALLOW <input checked="" type="checkbox"/>	WATERSHED: BUFFALO CREEK DISTRICT: BUFFALO COUNTY: BROOKE SURFACE OWNER: RUSSELL D. HERVEY OIL & GAS ROYALTY OWNER: RUSSELL D. HERVEY & LISA K. HERVEY

DRILL <input checked="" type="checkbox"/> DRILL DEEPER <input type="checkbox"/> REDRILL <input type="checkbox"/> FRACTURE OR STIMULATE <input checked="" type="checkbox"/> PLUG OFF OLD FORMATION <input type="checkbox"/> PERFORATE NEW FORMATION <input type="checkbox"/> CONVERT <input type="checkbox"/> PLUG & ABANDON <input type="checkbox"/> CLEAN OUT & REPLUG <input type="checkbox"/> OTHER CHANGE <input checked="" type="checkbox"/> (SPECIFY) AS-DRILLED	TARGET FORMATION: MARCELLUS ESTIMATED DEPTH: 6,043' TVD 15,182' IMD
---	--

WELL OPERATOR: SWN PRODUCTION COMPANY, LLC ADDRESS: P.O. BOX 1300 CITY: JANE LEW STATE: WV ZIP CODE: 26378	DESIGNATED AGENT: DEE SOUTHALL ADDRESS: P.O. BOX 1300 CITY: JANE LEW STATE: WV ZIP CODE: 26378
--	--

LEGEND: ○ PROPOSED SURFACE HOLE / BOTTOM HOLE ✖ EXISTING / PRODUCING WELLHEAD ✖ ABANDONED WELL ✖ PLUGGED & ABANDONED WELL △ CUT CONDUCTOR	REVISIONS: --- LEASE BOUNDARY --- AS-DRILLED PATH --- PROPOSED PATH --- ABANDONED PATH	DATE: 06-27-2017 DRAWN BY: R.DOERR SCALE: 1" = 2000' DRAWING NO: 050-5495 WELL LOCATION PLAT
---	---	--