

Longitude: 80°32'30"

SURFACE HOLE 8464'

Longitude: 80°32'30"

BOTTOM HOLE 10337'

Latitude: 40°15'00"

Latitude: 40°17'30"



CIVIL & ENVIRONMENTAL CONSULTANTS, INC.
600 MARKETPLACE AVENUE, SUITE 200
BRIDGEPORT, WV 26330
304-933-3119

SURFACE HOLE LOCATION (SHL):
UTM (NAD83, ZONE 17, METERS):
NORTHING: 4,455,198.038
EASTING: 536,403.285

LANDING POINT (LPL):
UTM (NAD83, ZONE 17, METERS):
NORTHING: 4,455,593.206
EASTING: 536,914.078

BOTTOM HOLE LOCATION (BHL):
UTM (NAD83, ZONE 17, METERS):
NORTHING: 4,458,077.176
EASTING: 535,842.819

PERMIT SURFACE HOLE LOCATION (SHL):
UTM (NAD83, ZONE 17, METERS):
NORTHING: 4,455,198.038
EASTING: 536,403.285

PERMIT LANDING POINT (LPL):
UTM (NAD83, ZONE 17, METERS):
NORTHING: 4,455,592.080
EASTING: 536,915.813

PERMIT BOTTOM HOLE LOCATION (BHL):
UTM (NAD83, ZONE 17, METERS):
NORTHING: 4,458,076.187
EASTING: 353,843.232

AS-DRILLED

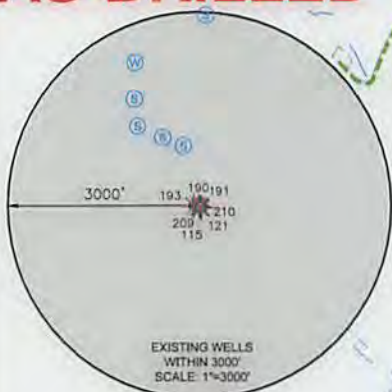

WELL RESTRICTIONS

- 1. NO OCCUPIED DWELLINGS > 2500 SQ FT, WITHIN 625 FEET OF CENTER OF PAD.
2. NO AGRICULTURE BUILDINGS > 2500 SQ FT, WITHIN 625 FEET OF CENTER OF PAD.
3. WATER WELLS OR DEVELOPED SPRINGS ARE WITHIN 977 FEET OF PROPOSED WELL.
4. PERENNIAL STREAMS, LAKES, PONDS, OR RESERVOIRS WITHIN 800 FEET OF THE LIMITS OF DISTURBANCE.
5. NO NATURALLY PRODUCING TROUT STREAM WITHIN 300 FEET OF LIMITS OF DISTURBANCE.
6. NO GROUND INTAKE OR PUBLIC WATER SUPPLY WITHIN 1000 FEET OF WELL PAD, LIMITS OF DISTURBANCE, E & S CONTROLS OR PUBLIC WATER SUPPLY.

NOTES ON SURVEY

- 1. SURFACE AND ROYALTY OWNER INFORMATION AND THEIR BOUNDARIES SHOWN HEREON WERE PLOTTED FROM DEEDS AND/OR TAX PARCEL MAPS PROVIDED BY CLIENT AND/OR FIELD LOCATIONS.
2. THIS PLAT DOES NOT REPRESENT A BOUNDARY SURVEY OF THE PARCELS SHOWN HEREON.
3. ALL INSETS ARE GRID NORTH UNLESS OTHERWISE DEPICTED.

I, THE UNDERSIGNED, HEREBY CERTIFY THAT THIS PLAT IS CORRECT TO THE BEST OF MY KNOWLEDGE AND BELIEF AND SHOWS ALL THE INFORMATION REQUIRED BY LAW AND REGULATIONS ISSUED AND PRESCRIBED BY THE DEPARTMENT OF ENVIRONMENTAL PROTECTION.

P.S. 991

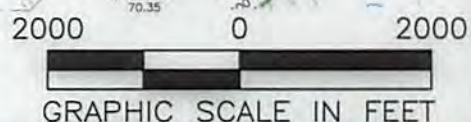

COMPANY: SWN Production Company, LLC

STATE OF WEST VIRGINIA
WVDEP
OFFICE OF OIL & GAS
601 57TH STREET
CHARLESTON, WV 25034

MINIMUM DEGREE OF ACCURACY: 1/200
PROVEN SURVEY SOURCE OF GRADE GPS ELEVATION: (NAVD 88, US FT)

ALAN H DEGARMO BRK
OPERATOR'S WELL #: 405H
API WELL #: 47 STATE 009 COUNTY 00195 PERMIT

WELL TYPE: OIL [] WASTE DISPOSAL [] PRODUCTION [X] DEEP [] GAS [X] LIQUID INJECTION [] STORAGE [] SHALLOW [X]
WATERSHED: UPPER OHIO SOUTH
DISTRICT: BUFFALO COUNTY: BROOKE
SURFACE OWNER: ALAN H. DEGARMO & MARY KAY DEGARMO, LIFE ESTATE
OIL & GAS ROYALTY OWNER: ALAN H. DEGARMO
DRILL [] DRILL DEEPER [] REDRILL [] FRACTURE OR STIMULATE [] PLUG OFF OLD FORMATION [] PERFORATE NEW FORMATION []
CONVERT [] PLUG & ABANDON [] CLEAN OUT & REPLUG [] OTHER CHANGE [X] (SPECIFY) ASDRILLED
TARGET FORMATION: MARCELLUS ESTIMATED DEPTH: 5,899 TVD 15,425 TMD

WELL OPERATOR: SWN PRODUCTION COMPANY, LLC
ADDRESS: P.O. BOX 1300
CITY: JANE LEW STATE: WV ZIP CODE: 26378
DESIGNATED AGENT: DEE SOUTHALL
ADDRESS: P.O. BOX 1300
CITY: JANE LEW STATE: WV ZIP CODE: 26378

LEGEND:
PROPOSED SURFACE HOLE / BOTTOM HOLE
EXISTING / PRODUCING WELLHEAD
LANDING POINT LOCATION
EXISTING WATER WELL
EXISTING SPRING
SURVEYED BOUNDARY
DRILLING UNIT
LEASE BOUNDARY
ASDRILLED PATH
PROPOSED PATH
REVISIONS:
DATE: 04-18-2018
DRAWN BY: K.E.S.
SCALE: 1" = 2000'
DRAWING NO: 164-764
WELL LOCATION PLAT