

State of West Virginia
Department of Environmental Protection - Office of Oil and Gas
Well Operator's Report of Well Work

API 47-009-00241 County BROOKE District BUFFALO
Quad STEUBENVILLE EAST Pad Name VIOLET COSS BRK PAD Field/Pool Name PANHANDLE FIELD WET
Farm name LINDA COEN (LIFE ESTATE-VIOLET L COSS) Well Number VIOLET COSS BRK 206H
Operator (as registered with the OOG) SWN PRODUCTION COMPANY, LLC
Address PO BOX 12359 City SPRING State TX Zip 77391-2359

As Drilled location NAD 83/UTM Attach an as-drilled plat, profile view, and deviation survey
Top hole Northing 4,455,778.747 Easting 532,137.906
Landing Point of Curve Northing 4,456,262.615 Easting 531,347.927
Bottom Hole Northing 4,453,118.225 Easting 532,717.935

Elevation (ft) 1172.8' GL Type of Well New Existing Type of Report Interim Final
Permit Type Deviated Horizontal Horizontal 6A Vertical Depth Type Deep Shallow
Type of Operation Convert Deepen Drill Plug Back Redrilling Rework Stimulate
Well Type Brine Disposal CBM Gas Oil Secondary Recovery Solution Mining Storage Other _____
Type of Completion Single Multiple Fluids Produced Brine Gas NGL Oil Other _____
Drilled with Cable Rotary

Drilling Media Surface hole Air Mud Fresh Water Intermediate hole Air Mud Fresh Water Brine
Production hole Air Mud Fresh Water Brine
Mud Type(s) and Additive(s)
SOBM

Date permit issued 11/02/2020 Date drilling commenced 12/23/2020 Date drilling ceased 1/08/2021
Date completion activities began 2/02/2021 Date completion activities ceased 2/28/2021
Verbal plugging (Y/N) N Date permission granted N/A Granted by N/A

RECEIVED
Office of Oil and Gas

Please note: Operator is required to submit a plugging application within 5 days of verbal permission to plug

APR 30 2021

Freshwater depth(s) ft 334 Open mine(s) (Y/N) depths N
Salt water depth(s) ft 507 Void(s) encountered (Y/N) depths N
Coal depth(s) ft 209 Cavern(s) encountered (Y/N) depths N
Is coal being mined in area (Y/N) N

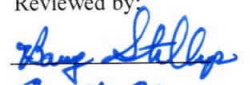
Reviewed by:

08/27/2021

API 47-009 - 00241 Farm name LINDA COEN (LIFE ESTATE-VIOLET L COSS) Well number VIOLET COSS BRK 206H

CASING STRINGS	Hole Size	Casing Size	Depth	New or Used	Grade w/ft	Basket Depth(s)	Did cement circulate (Y/ N) * Provide details below*
Conductor	24	20	126	NEW	J-55/94#		Y
Surface	17.5	13.375	388	NEW	J-55/54.50#	177, 135.6	Y, 25 BBLS
Coal							
Intermediate 1	12.25	9.625	1,637	NEW	J-55/36#		Y, 37 BBLS
Intermediate 2							
Intermediate 3							
Production	8.75/8.50	5.5	18,643	NEW	P-110/20#		Y, 1 BBLS
Tubing		2.875	7,428	NEW	P-110/6.5#		N
Packer type and depth set							

Comment Details _____

CEMENT DATA	Class/Type of Cement	Number of Sacks	Slurry wt (ppg)	Yield (ft ³ /sks)	Volume (ft ³)	Cement Top (MD)	WOC (hrs)
Conductor	CLASS A	GROUT TO SURFACE				SURFACE	24
Surface	CLASS A	381	15.60	1.20	457.2	SURFACE	8
Coal							
Intermediate 1	CLASS A	693	15.60	1.19	824.67	SURFACE	8
Intermediate 2							
Intermediate 3							
Production	CLASS A	4,669	15.60	1.19	5,556.11	SURFACE	24
Tubing							

Drillers TD (ft) 18,643' Loggers TD (ft) 18,643'
 Deepest formation penetrated _____ Plug back to (ft) N/A
 Plug back procedure N/A

Kick off depth (ft) 5,930'

Check all wireline logs run caliper density deviated/directional induction
 neutron resistivity gamma ray temperature sonic

Well cored Yes No Conventional Sidewall Were cuttings collected Yes No

DESCRIBE THE CENTRALIZER PLACEMENT USED FOR EACH CASING STRING _____

SURFACE: 7 CENTRALIZERS - EVERY THIRD JOINT OF CASING
 INTERMEDIATE: 24 CENTRALIZERS - EVERY THIRD JOINT OF CASING
 PRODUCTION: 181 CENTRALIZERS - EVERY THIRD JOINT FROM SURFACE TO TOP OF CURVE, THEN EVERY JOINT UNTIL TD

RECEIVED
Office of Oil and Gas

WAS WELL COMPLETED AS SHOT HOLE Yes No DETAILS APR 30 2021

WAS WELL COMPLETED OPEN HOLE? Yes No DETAILS WV Department of Environmental Protection

WERE TRACERS USED Yes No TYPE OF TRACER(S) USED _____

08/27/2021

Hydraulic Fracturing Fluid Product Component Information Disclosure

Job Start Date:	2/2/2021
Job End Date:	2/15/2021
State:	West Virginia
County:	Brooke
API Number:	47-009-00241-00-00
Operator Name:	Southwestern Energy
Well Name and Number:	VIOLET COSS BRK 206
Latitude:	40.25184597
Longitude:	-80.62210874
Datum:	NAD83
Federal Well:	NO
Indian Well:	NO
True Vertical Depth:	5,742
Total Base Water Volume (gal):	23,457,468
Total Base Non Water Volume:	0



Hydraulic Fracturing Fluid Composition:

Trade Name	Supplier	Purpose	Ingredients	Chemical Abstract Service Number (CAS #)	Maximum Ingredient Concentration in Additive (% by mass)**	Maximum Ingredient Concentration in HF Fluid (% by mass)**	Comments
Base Water	Operator	Base Fluid					
			Water	7732-18-5	100.00000	91.96184	Density = 8.345
Ingredients	Listed Above	Listed Above					
			Water	7732-18-5	85.00000	0.13958	

RECEIVED
 Office of Oil and Gas
 APR 30 2021
 WV Department of
 Environmental Protection

SWN FRW-11LC	SWN Well Services	Friction Reducer					
				Listed Below			
Tolicide PS 50A	SWN Well Services	Biocide					
				Listed Below			
Plexaid 655WG	SWN Well Services	Scale Inhibitor					
				Listed Below			
Sand	SWN Well Services	Proppant					
				Listed Below			
HCL	SWN Well Services	Solvent					
				Listed Below			
Ecopol-FEAC	SWN Well Services	Iron Control					
				Listed Below			
Econo-CI200	SWN Well Services	Corrosion Inhibitor					
				Listed Below			

Items above are Trade Names with the exception of Base Water . Items below are the individual ingredients.

			Crystalline Silica, quartz	14808-60-7	100.00000	7.84846	
			Petroleum Distillates, Hydrotreated	64742-47-8	25.00000	0.01830	
			Hydrochloric Acid	7647-01-0	15.00000	0.01369	
			Tetrakis	55566-30-8	55.00000	0.01013	
			Glycerin	56-81-5	50.00000	0.00310	

RECEIVED
 Office of Oil and Gas
 WV Department of
 Environmental Protection
 APR 30 2021

			Ammonium Chloride	12125-02-9	2.00000	0.00146	
			Oleic Acid Diethanolamide	93-83-4	1.50000	0.00110	
			Alcohols, C12-1, ethoxylated	68551-12-2	1.50000	0.00110	
			Diethylenetriamine penta	15827-60-8	10.00000	0.00062	
			Acrylic acid terpolymer	397256-50-7	1.00000	0.00018	
			Acetic Acid	64-19-7	37.50000	0.00018	
			Methanol	67-56-1	80.00000	0.00011	
			Citric Acid	77-92-9	22.50000	0.00011	
			Oxyalkylated fatty acid	68951-67-7	9.67400	0.00001	
			Fatty acids	61790-12-3	5.02700	0.00001	
			Modified thiourea polymer	68527-49-1	4.74600	0.00001	
			Potassium acetate	127-08-2	0.02200	0.00000	
			Formaldehyde	50-00-0	0.00400	0.00000	

* Total Water Volume sources may include various types of water including fresh water, produced water, and recycled water

** Information is based on the maximum potential for concentration and thus the total may be over 100%

*** If you are calculating a percentage of total ingredients do not add the water volume below the green line to the water volume above the green line

Note: For Field Development Products (products that begin with FDP), MSDS level only information has been provided.

Ingredient information for chemicals subject to 29 CFR 1910.1200(i) and Appendix D are obtained from suppliers Material Safety Data Sheets (MSDS)

RECEIVED
Office of Oil and Gas
APR 30 2021
WV Department of
Environmental Protection

VIOLET COSS BRK 206H
ATTACHMENT 1
PERF REPORT

STAGE NUM	Perf Date	Perf Bottom MD	Perf Top MD2	# SHOTS PER STG
1	2/2/2021	18,551	18,455	36
2	2/3/2021	18,421	18,242	36
3	2/3/2021	18,208	18,029	36
4	2/3/2021	17,996	17,816	36
5	2/4/2021	17,783	17,608	36
6	2/4/2021	17,570	17,391	36
7	2/4/2021	17,357	17,178	36
8	2/4/2021	17,145	16,965	36
9	2/5/2021	16,932	16,753	36
10	2/5/2021	16,719	16,540	36
11	2/5/2021	16,507	16,327	36
12	2/5/2021	16,294	16,115	36
13	2/6/2021	16,081	15,902	36
14	2/6/2021	15,868	15,689	36
15	2/6/2021	15,656	15,476	36
16	2/6/2021	15,443	15,264	36
17	2/6/2021	15,230	15,051	36
18	2/7/2021	15,018	14,838	36
19	2/7/2021	14,800	14,626	36
20	2/7/2021	14,592	14,417	36
21	2/8/2021	14,379	14,200	36
22	2/8/2021	14,167	13,987	36
23	2/8/2021	13,954	13,775	36
24	2/9/2021	13,741	13,562	36
25	2/9/2021	13,529	13,349	36
26	2/9/2021	13,316	13,137	36
27	2/9/2021	13,098	12,924	36
28	2/10/2021	12,890	12,711	36
29	2/10/2021	12,678	12,498	36
30	2/10/2021	12,465	12,289	36
31	2/10/2021	12,252	12,073	36
32	2/11/2021	12,039	11,860	36
33	2/11/2021	11,827	11,648	36
34	2/11/2021	11,614	11,435	36
35	2/11/2021	11,398	11,223	36
36	2/12/2021	11,189	11,009	36
37	2/12/2021	10,976	10,797	36
38	2/12/2021	10,760	10,584	36
39	2/12/2021	10,550	10,371	36
40	2/12/2021	10,340	10,158	36
41	2/12/2021	10,125	9,946	36
42	2/13/2021	9,912	9,733	36
43	2/13/2021	9,700	9,520	36
44	2/13/2021	9,487	9,308	36
45	2/13/2021	9,274	9,095	36
46	2/13/2021	9,059	8,882	36
47	2/13/2021	8,849	8,669	36
48	2/13/2021	8,638	8,457	36
49	2/14/2021	8,423	8,244	36
50	2/14/2021	8,211	8,031	36
51	2/14/2021	7,993	7,819	36
52	2/14/2021	7,785	7,606	36
53	2/14/2021	7,568	7,393	36
54	2/14/2021	7,360	7,183	36

RECEIVED
Office of Oil and Gas

APR 30 2021

WV Department of
Environmental Protection

08/27/2021

VIOLET COSS BRK 206H

ATTACHMENT 2

STIM REPORT

STAGE NUM	Stim Date	Ave Pump Rate (BPM)	Ave Treatment	Max Breakdown	ISIP (PSI)	Amount of Proppant	Amount of water bbls	Amount of nitrogen/othe
1	2/2/2021	70.67	8,083	6,451	4,123	174,440	9,115	0
2	2/3/2021	71.27	7,343	5,540	4,478	285,500	11,140	0
3	2/3/2021	71.78	6,674	5,238	4,490	313,500	11,430	0
4	2/4/2021	77.56	6,865	4,607	4,818	308,820	11,458	0
5	2/4/2021	75.5	6,843	3,803	4,399	313,820	11,668	0
6	2/4/2021	84.67	7,652	3,973	4,367	310,620	10,442	0
7	2/4/2021	79.67	7,226	4,005	4,635	312,420	10,995	0
8	2/4/2021	80.44	7,185	4,869	4,303	306,940	11,060	0
9	2/5/2021	84.78	7,610	4,613	4,507	314,520	10,960	0
10	2/5/2021	84.78	7,773	4,386	4,460	313,740	10,743	0
11	2/5/2021	79.11	7,189	4,327	4,473	311,700	10,880	0
12	2/5/2021	82.67	7,319	5,043	4,214	312,760	10,684	0
13	2/6/2021	83.67	7,235	5,042	4,441	318,040	10,842	0
14	2/6/2021	83.5	7,584	5,278	4,333	312,900	10,993	0
15	2/6/2021	88.22	7,728	5,279	4,298	320,120	10,180	0
16	2/6/2021	81.78	7,017	4,656	4,525	307,560	10,267	0
17	2/6/2021	83.56	7,101	4,116	4,451	314,160	10,539	0
18	2/7/2021	82.56	6,855	5,087	4,691	313,580	10,506	0
19	2/7/2021	84.11	7,366	4,802	4,519	314,640	10,274	0
20	2/7/2021	83.11	7,205	5,247	4,321	312,140	10,574	0
21	2/8/2021	80.33	6,868	5,002	4,349	315,420	10,538	0
22	2/8/2021	87.44	7,089	5,097	4,775	314,340	10,287	0
23	2/8/2021	82.78	7,236	5,137	4,245	309,500	10,369	0
24	2/8/2021	81.33	6,905	5,372	4,105	318,660	10,242	0
25	2/8/2021	74.56	6,690	5,507	4,248	315,960	10,219	0
26	2/9/2021	78.33	6,348	5,079	4,525	306,520	9,892	0
27	2/9/2021	75.67	6,250	5,003	4,525	309,880	10,074	0
28	2/10/2021	75.33	6,375	5,216	4,386	307,280	10,165	0
29	2/10/2021	82	6,668	5,113	4,010	309,040	10,377	0
30	2/10/2021	81.67	7,005	5,362	4,257	313,900	9,956	0
31	2/10/2021	75.78	6,177	4,825	4,544	310,860	10,055	0
32	2/11/2021	89	7,427	4,075	4,469	306,240	10,225	0
33	2/11/2021	87.3	7,885	5,636	4,235	309,020	10,762	0
34	2/11/2021	93.44	7,088	4,765	4,325	311,080	10,168	0
35	2/11/2021	90.33	6,926	4,944	4,711	310,580	9,991	0
36	2/12/2021	91.56	6,826	4,977	4,591	310,320	9,685	0
37	2/12/2021	98.22	7,192	5,280	4,638	311,640	10,294	0
38	2/12/2021	93.22	6,576	5,213	4,785	312,620	10,195	0
39	2/12/2021	94	6,724	5,507	4,786	315,900	10,322	0
40	2/12/2021	91.89	6,920	5,159	4,415	312,180	10,059	0
41	2/12/2021	95	6,936	4,439	4,444	313,260	10,154	0
42	2/13/2021	90.89	6,740	5,136	4,518	314,940	9,702	0
43	2/13/2021	94	6,443	5,093	4,490	313,920	10,227	0
44	2/13/2021	98.33	6,636	5,142	4,562	309,580	10,134	0
45	2/13/2021	97.44	6,708	5,465	4,438	314,580	10,149	0
46	2/13/2021	88.22	6,446	5,241	4,414	308,300	9,808	0
47	2/13/2021	95.11	6,788	4,975	4,181	314,640	10,000	0
48	2/14/2021	95.78	6,895	5,010	4,223	311,400	9,933	0
49	2/14/2021	98.89	6,362	4,978	4,139	307,180	10,071	0
50	2/14/2021	99.44	6,282	4,995	4,204	309,200	10,211	0
51	2/14/2021	98.89	6,236	4,742	4,189	312,580	10,103	0
52	2/14/2021	96.11	6,689	4,796	4,443	307,960	9,766	0
53	2/14/2021	97.22	6,833	4,875	4,346	331,980	10,118	0
54	2/15/2021	97.33	6,730	3,786	4,092	314,080	10,025	0

RECEIVED
Office of Oil and Gas
APR 30 2021
Department of Environmental Protection

08/27/2021



Well Name: Violet Coss BRK 206H

47009002410000

LITHOLOGY/FORMATION	TOP DEPTH, MD (FT)	TOP DEPTH, TVD (FT)	BOTTOM DEPTH, MD (FT)	BOTTOM DEPTH, TVD (FT)	QUANTITY AND TYPE OF FLUID
Base of Fresh Water	0.00	0.00	334.00	334.00	
Top of Salt Water	507.00	507.00	NA	NA	
Pittsburgh Coal	209.00	209.00	221.00	221.00	
Raven Cliff (ss)	697.00	697.00	1316.00	1316.00	
Big Injun (ss)	1316.00	1316.00	1477.00	1477.00	
Berea (siltstone)	1793.00	1749.00	1849.00	1800.00	
Rhinstreet (shale)	6470.00	5139.00	6736.00	5375.00	
Cashaqua (shale)	6736.00	5375.00	6793.00	5420.00	
Middlesex (shale)	6793.00	5420.00	6883.00	5478.00	
Burket (shale)	6883.00	5478.00	6904.00	5502.00	
Tully (ls)	6904.00	5502.00	6976.00	5549.00	
Mahantango (shale)	6976.00	5549.00	7114.00	5622.00	
Marcellus (shale)	7114.00	5622.00	NA	NA	GAS

RECEIVED
 Office of Oil and Gas
 APR 30 2021
 WV Department of
 Environmental Protection

Longitude: 80°35'00" (SHL)

SURFACE HOLE 10823'

BOTTOM HOLE 8961'

Longitude: 80°35'00" (BHL)



CIVIL & ENVIRONMENTAL CONSULTANTS, INC.
600 MARKETPLACE AVENUE, SUITE 200
BRIDGEPORT, WV 26330
304-933-3119

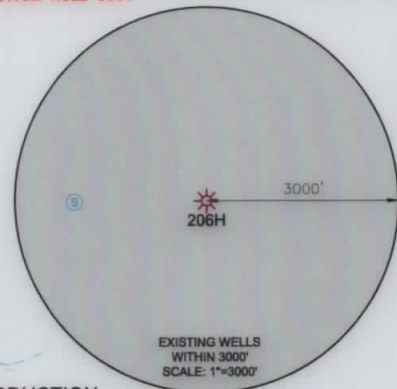
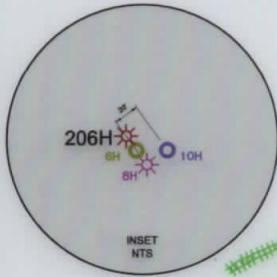

EXISTING WELLS WITHIN 3000' SCALE: 1"=3000'

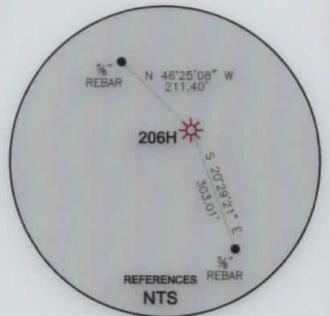

REFERENCES NTS

GRID NORTH
UTM, NAD83 DATUM, ZONE 17, US FT

BOTTOM HOLE 8068'

SURFACE HOLE 14507'

Latitude: 40°15'00" (BHL)

Latitude: 40°17'30" (SHL)

Table with 6 rows of location data for Surface Hole (SHL), Landing Point (LPL), and Bottom Hole (BHL) in UTM coordinates.

WELL RESTRICTIONS

- 1. NO OCCUPIED DWELLINGS > 2500 SQ FT. WITHIN 625 FEET OF CENTER OF PAD.
2. NO AGRICULTURE BUILDINGS > 2500 SQ FT. WITHIN 625 FEET OF CENTER OF PAD.
3. WATER WELLS OR DEVELOPED SPRINGS ARE WITHIN 2,068 FEET OF PROPOSED WELL.
4. PERENNIAL STREAMS, LAKES, PONDS, OR RESERVOIRS WITHIN 800 FEET OF THE LIMITS OF DISTURBANCE.
5. NO NATURALLY PRODUCING TROUT STREAM WITHIN 300 FEET OF LIMITS OF DISTURBANCE.
6. NO GROUND INTAKE OR PUBLIC WATER SUPPLY WITHIN 1000 FEET OF WELL PAD, LIMITS OF DISTURBANCE, E & S CONTROLS OR PUBLIC WATER SUPPLY.

NOTES ON SURVEY

- 1. SURFACE AND ROYALTY OWNER INFORMATION AND THEIR BOUNDARIES SHOWN HEREON WERE PLOTTED FROM DEEDS AND/OR TAX PARCEL MAPS PROVIDED BY CLIENT AND/OR FIELD LOCATIONS.
2. THIS PLAT DOES NOT REPRESENT A BOUNDARY SURVEY OF THE PARCELS SHOWN HEREON.
4. ALL INSETS ARE GRID NORTH UNLESS OTHERWISE DEPICTED.

3000 0 3000



GRAPHIC SCALE IN FEET

I, THE UNDERSIGNED, HEREBY CERTIFY THAT THIS PLAT IS CORRECT TO THE BEST OF MY KNOWLEDGE AND BELIEF AND SHOWS ALL THE INFORMATION REQUIRED BY LAW AND REGULATIONS ISSUED AND PRESCRIBED BY THE DEPARTMENT OF ENVIRONMENTAL PROTECTION.

P.S. 991

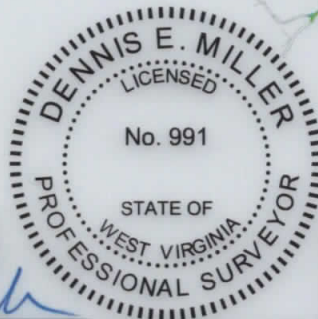

AS-DRILLED

COMPANY:

SWN

SWN R+V+0 A

Production Company, LLC

Production Company™



(+) DENOTES LOCATION OF WELL ON UNITED STATES TOPOGRAPHIC MAPS

WVDEP
OFFICE OF OIL & GAS
601 57TH STREET
CHARLESTON, WV 25034

MINIMUM DEGREE OF ACCURACY: 1/200
PROVEN SOURCE OF ELEVATION: SURVEY GRADE GPS (NAVD 88, US FT)

VIOLET COSS BRK
OPERATOR'S WELL #: 206H
API WELL #: 47 STATE 009 COUNTY 00241 PERMIT

Form with well type, watershed, district, surface owner, oil & gas royalty owner, drill options, convert options, target formation, and designated agent information.

Form with well operator and designated agent contact information.

Form with legend, revisions, and drawing information.



CIVIL & ENVIRONMENTAL CONSULTANTS, INC.
600 MARKETPLACE AVENUE, SUITE 200
BRIDGEPORT, WV 26330
304-933-3119

WELL BORE TABLE FOR SURFACE / ROYALTY OWNERS			
TRACT	SURFACE OWNER (S) / ROYALTY OWNER (R)	TAX PARCEL	ACRES
1	EVERETT ALAN COEN, LORRIE ELLEN WOOLWINE, MELINDA WOOLWINE, MICHAEL TODD COEN (S&R)	3-B32-25	224.303
2	HFS LIMITED LIABILITY COMPANY	3-B27-12	67.95
3	BROOKE CO. RT. 2		
4	WEST VIRGINIA DEPARTMENT OF HIGHWAYS	3-B27-11	
5	CAMPBELL TRANSPORTATION COMPANY, INC.	3-B27-10	12.48
6	STATE OF WEST VIRGINIA		
7	COSS ROAD FARM, LLC	3-B31-114	183.23
8	CHARLES D. BLACKBURN	3-B32-21	10.00
9	GREEN RUN ROAD		
10	MASLO FARMS LLC A PENNSYLVANIA LLC	3-B32-20	78.86
11	MICHAEL & MELISSA BILAK	3-B32-174	21.83
12	MICHAEL S. & MELISSA A. BILAK (SURV)	3-B32-177	1.47
13	MC CORD HILL ROAD		
14	BOYD NILA; MCCORD CLINTON; JOHN JOHN; REBA; JONES CA	3-B32-146	29.057
15	RONALD D. & JEAN A. TAYLOR	3-B37-11	11.96
16	HARLEY J. LEMASTERS	3-B37-12	2.00
17	HARLEY J. LEMASTERS	3-B37-13	33.54

ADJOINING OWNERS TABLE			
TRACT	SURFACE OWNER	TAX PARCEL	ACRES
A	DANIEL P. LOMBARDI	3-B27K-211	6.62
B	NORMA JEAN LILLY, WIDOW	3-B27-17	45.72
C	GERTRUDE LOUISE MCSHANE ROBIE & PATRICK J. MCSHANE, TRUSTEE	3-B32-29	84.79
D	TONY J. CASTILLO; RICHARD R. OSTRANDER (S)	3-B32-28	20.83
E	TONY J. CASTILLO; RICHARD R. OSTRANDER (S)	3-B32-27	10
F	JAMES SCOTT GEAR	3-B32-26	3.11
G	WILLIAM & CAROLYN WALNOHA (S)	3-B32-14	1.34
H	JOHN PORTER & BRIGITTE ROGERS (S)	3-B32-15	0.568
I	DOROTHY L. STEVENS	3-B32-16	2.09
J	RUTH BERNADINE HART	3-B32-22.01	0.262
K	WALNOHA WILLIAM RUSSELL, HART RUTH; THARP MARY FRANC	3-B32-22	0.244
L	WILLIAM RUSSELL WALNOHA	3-B32-22.02	0.259
M	CAROLYN SUE WALNOHA	3-B32-17	4.00
N	MARY CATHERINE WALNOHA	3-B32-18	2.00
O	JOSEPH G. VINDERMAN, JR., JERRY VINDERMAN, DAVID G. VINDERMAN AND LINDA J.R. VINDERMAN, ARNOLD VINDERMAN, LAWRENCE VINDERMAN, GEORGE VINDERMAN, THERESA MCQUILLAN	3-B32-13	43.38
P	MASLO FARMS, LLC	3-B32-19	59.66
Q	RALPH G. JOHNSTON; ROBERT JOHNSTON; KENNETH D. JOHNSTON, DANIEL JOHNSTON, ET AL	3-B32-180	39.862
R	ROBERT A. JOHNSTON, RALPH G. JOHNSTON, JOYCE A. BRADY, BRIAN W. JOHNSTON, DANIEL L. JOHNSTON, KENNETH D. JOHNSTON	3-B32-179	1.17
S	RALPH G. & TRACY A. JOHNSTON	3-B32-181	0.602
T	ROBERT A. & JANICE K. JOHNSTON	3-B32-183	0.403
U	ROBERT A. & JANICE K. JOHNSTON	3-B32-182	0.72
V	NILA H. MCCORD BOYD	3-B32-145	2.42
W	NILA H. MCCORD BOYD	3-B32-144	2.21
X	NILA H. MCCORD BOYD	3-B32-142	5.09
Y	CITY OF WELLISBURG COMBINE WATER AND SEWER BOARD	3-B32-140.2	89.58
Z	SCHIAPPA AND COMPANY INC	3-B37-22	145.963
AA	JAMES W. & DENISE L. MYERS (S)	3-B37-14	5.00
BB	THOMAS & CAROLYN CARBASHO (S)	3-B37-15	5.00
CC	MICHAEL MCCLLOUD	3-B37-18	1.08
DD	RONALD D. & JEAN A. TAYLOR	3-B37-19	1.08
EE	HARLEY J. LEMASTERS	3-B37-20	1.20
FF	EDWARD MICHAEL EVANKA SR.	3-B37-05	5.44
GG	HARLEY J. LEMASTERS	3-B37-09	4.14

ADJOINING OWNERS TABLE			
TRACT	SURFACE OWNER	TAX PARCEL	ACRES
HH	ALICE AND PRESLY BRYAN	3-B37-10	0.556
II	HARLEY J. LEMASTERS	3-B32-149	11.13
JJ	KEVIN S. WEEKLEY	3-B32-151	10.20
KK	JOHN AND NEELEY BROWN	3-B32-154	10.00
LL	KENNETH IVERSON	3-B32-155	2.39
MM	VINCE AND PEARL GALLOWAY	3-B32-156	1.90
NN	VIOLET I. BLAKE	3-B32-148	1.61
OO	THOMAS MURDOCK	3-B32-147	1.41
PP	MICHAEL S. & MELISSA D. BIELAK (S)	3-B32-176	0.49
QQ	SHIRLEY SPENCER	3-B32-175	1.50
RR	HUNTER WALLACE	3-B32-159	1.386
SS	WILLIAM L. & CATHERINE SPENCER	3-B32-160	0.31
TT	WILLIAM L. & CATHERINE SPENCER	3-B32-161	0.30
UU	DOROTHY J. MACGREGOR	3-B32-162	1.36
VV	DONALD THOMAS AND STEVEN THOMAS	3-B32-169	1.105
WW	JOSEPH PETTINI	3-B32-172	2.006
XX	PAMELA J. HUFF	3-B32-172.1	0.531
YY	PAMELA J. HUFF	3-B32-173	1.146
ZZ	CHERYLL L. STEMPEL	3-B31-102	3.48
AAA	STEVEN S. AND DEBRA L. IVERSON	3-B31-101	2.09
BBB	HAROLD STARKEY	3-B31-104	34.04
CCC	JOSEPH C. & KRISTIE J. GASVODA	3-B31-111	0.94
DDD	JOSEPH C. & KRISTIE J. GASVODA	3-B31-112	0.17
EEE	KEITH R. FRANCIS	3-B31-113	26.33
FFF	THOMAS & PAULINE SALEM	3-B31-138	7.73
GGG	RODGER & CONNIE SUMMERS	3-B31-137	11.35
HHH	JERRY C. & ANGEL L. MCCLELLAND	3-B31-136	9.18
III	CURTIS R. & DONNA J. BARONIO (S)	3-B31-135	7.32
JJJ	RONALD C. PARKS	3-B31-134	8.15
KKK	ROBERT J. SR. & MARGARET E. STEWART (S)	3-B31-133	7.88
LLL	ROBERT J. SR. & MARGARET E. STEWART (S)	3-B31-132	7.39
MMM	RAY WALNOHA	3-B31-115	9.27
NNN	AUDREY L. HOLDEN	3-B31-116	0.736
OOO	BARBARA A. TAYLOR	3-B31-117	5.0
PPP	COSS ROAD FARM, LLC	3-B31-118	17.18
QQQ	COSS ROAD FARM, LLC	3-B31-119	5.35
RRR	EDWARD MACIAK	3-B31-120	1.37
SSS	JAMES L. & SONDR A. ELLIOTT	3-B31-121	5.48
TTT	HFS LIMITED LIABILITY COMPANY	3-B31-1	23.87
UUU	CAMPBELL TRANSPORTATION COMPANY INC	3-B27-8	0.41
VVV	GREG PROVENZANO	3-B27-9	0.09

API WELL #: **47** **009** **00241**
STATE COUNTY PERMIT

08/27/2021

REVISIONS:	COMPANY:		
	OPERATOR'S		DATE: 4-14-2021
	WELL #:		DRAWN BY: K.E.S.
	DISTRICT:	COUNTY:	SCALE: N/A
	BUFFALO	BROOKE	DRAWING NO: 172-287
		STATE:	WELL LOCATION PLAT 2
		WV	