

Latitude

Longitude

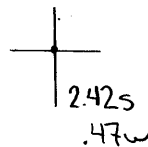

Topo Location

7.5' Loc. _____ 15' Loc. _____
 _____ (calc.) _____

Company Dunn Mas O+G Co

Farm J W Bowman #1

15' Quad _____
(sec.)

7.5' Quad Bethany

District Buffalo

WELL LOCATION PLAT

County 009 Permit 30003

3A Brooke



JW
Bowman

* 3A

* 3A

Buffalo Cr.

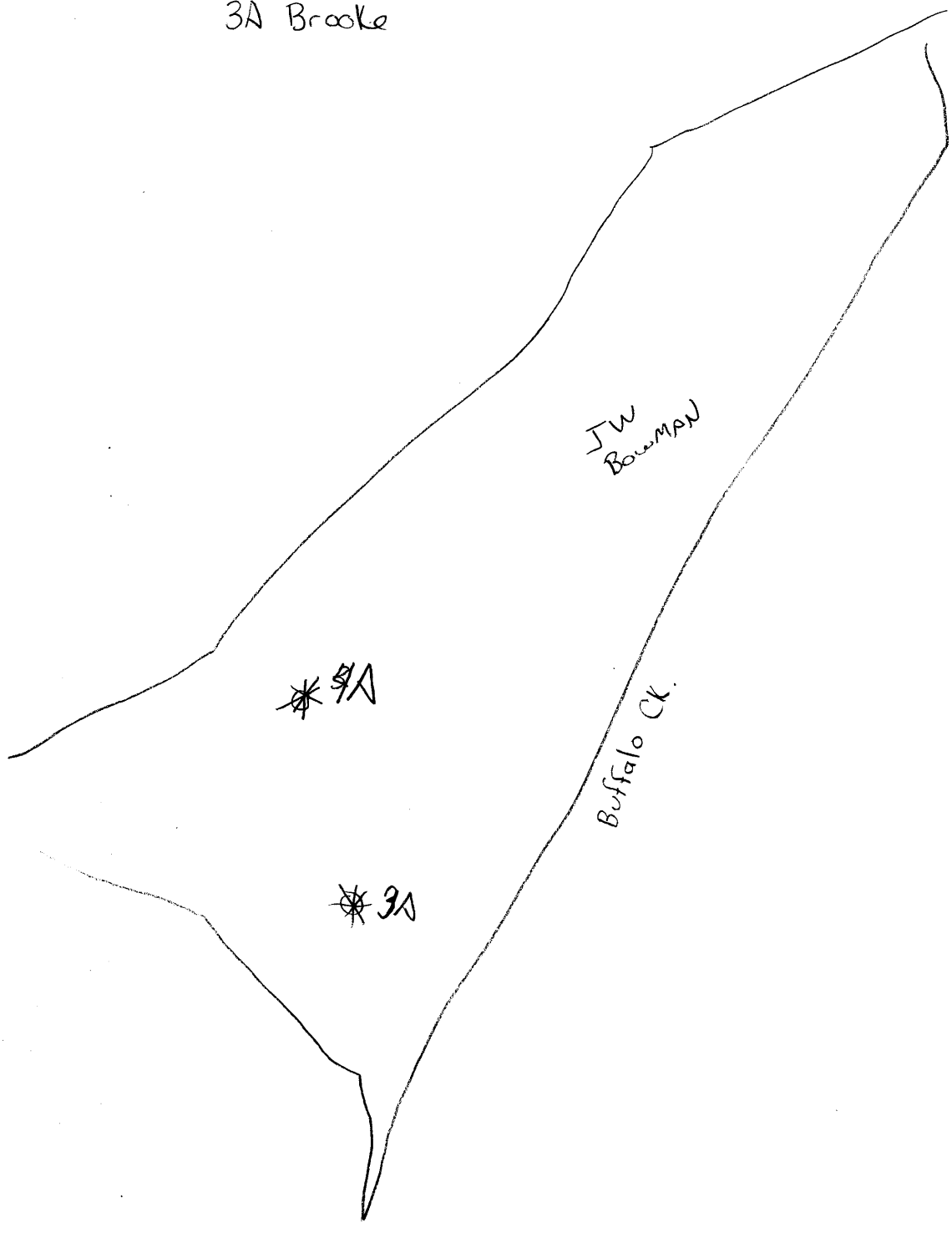

BRO-3-A

Buffalo District, Brooke County, W. Va.
Dunn Mar Oil & Gas Co., Waynesburg, Pa. (John R. Conklin, Secy.)
On 75 acres, surface and mineral rights owned by John Bowman,
Wellsburg, W. Va.

Drilled in 1913.

Elevation, 809.39' L.

8 $\frac{1}{2}$ " casing, 150'; 6-5/8", 870'.

Surface below Pittsburgh Coal.

Abandonment reported to Dept. of Mines Oct. 11, 1930.

Completion data sheet not filed. Write for same.

No record.



Brooke 3-A

Buffalo District, Brooke County, W. Va.

Dunn Mar Oil & Gas Co., Waynesburg, Pa. (John R. Conklin, Secy.)

On 75 acres, surface and mineral rights owned by John Bowman,
Wellsburg, W. Va.

Drilled in 1913.

Elevation, 809.39' L.

8 $\frac{1}{4}$ " casing, 150'; 6-5/8", 870'.

Surface below Pittsburgh Coal.

Abandonment reported to Dept. of Mines Oct. 11, 1930.

Completion data sheet not filed. Write for same.

No record.

J. T. BOWMAN NO. 1 WELL.

No. ¹²²³..... on Map.

3A

Buffalo District, Brooke County, W. Va.
Carter Oil Co.
Starts 75' below Pittsburgh Coal.
Located a short distance from J. A. Crouch No. 1.

	Top.	Bottom.
Cow Run Sand	611	666
Salt Sand	660 ¹	790
Limestone	850	885
Keener Sand	885	1005
Big Injun Sand	1025	1190
Berea Sand (oil at 1524-1528')	1520	1540
Total depth		1546