

82° 51'
82° 07' 30"

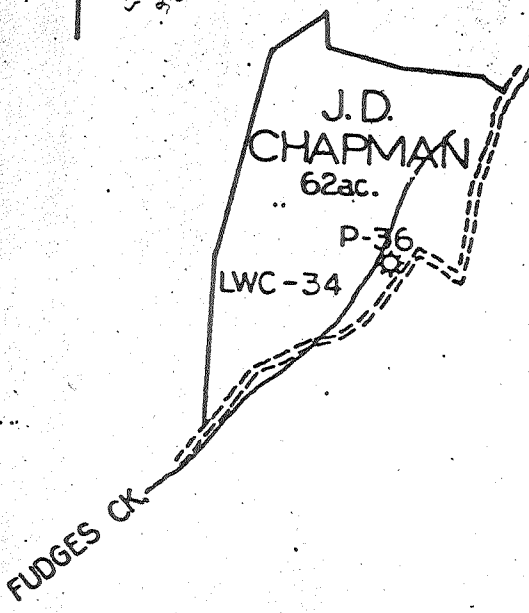
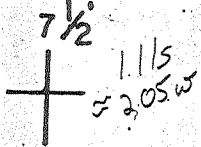

NORTH

SOUTHEASTERN GAS COMPANY
AND AFFILIATED COMPANIES
P. O. BOX 2347
CHARLESTON, W. VA. 25320

15 Cal 1.115 4.31w

FILE NO. _____
DRAWING NO. _____
SCALE _____
MINIMUM DEGREE OF ACCURACY _____
PROVEN SOURCE OF ELEVATION _____

I THE UNDERSIGNED, HEREBY CERTIFY THAT THIS PLAT IS CORRECT TO THE BEST OF MY KNOWLEDGE AND BELIEF AND SHOWS ALL THE INFORMATION REQUIRED BY LAW AND THE REGULATIONS ISSUED AND PRESCRIBED BY THE DEPARTMENT OF MINES.
(SIGNED) _____
R.P.E. _____ L.L.S. _____

PLACE SEAL HERE

(+) DEMOTES LOCATION OF WELL ON UNITED STATES TOPOGRAPHIC MAPS
FORM IV-6
(8-78)



DATE _____, 19____
OPERATOR'S WELL NO. P-36
API WELL NO. 47-011-629
STATE COUNTY PERMIT

STATE OF WEST VIRGINIA
DEPARTMENT OF MINES
OIL AND GAS DIVISION

WELL TYPE: OIL ___ GAS ___ LIQUID INJECTION ___ WASTE DISPOSAL ___
(IF "GAS", PRODUCTION ___ STORAGE ___ DEEP ___ SHALLOW ___
LOCATION: ELEVATION _____ WATER SHED _____
DISTRICT GRANT COUNTY CABELL
QUADRANGLE MILTON

SURFACE OWNER _____ ACREAGE _____
OIL & GAS ROYALTY OWNER J.D. Chapman LEASE NO. _____ LEASE ACREAGE _____

PROPOSED WORK: DRILL ___ CONVERT ___ DRILL DEEPER ___ REDRILL ___ FRACTURE OR STIMULATE ___ PLUG OFF OLD FORLATION ___ PERFORATE NEW FORMATION ___ OTHER PHYSICAL CHANGE IN WELL (SPECIFY) _____

PLUG AND ABANDON ___ CLEAN OUT AND REPLUG ___
TARGET FORMATION _____ ESTIMATED DEPTH _____
WELL OPERATOR _____ DESIGNATED AGENT _____
ADDRESS _____ ADDRESS _____

66 Ball Gas

W E L L R E C O R D

J. D. CHAPMAN FARM 64 ACRES
WATERS OF FUDGES CREEK
GRANT DISTRICT
CABELL COUNTY, W. VA.

<u>FORMATION</u>	<u>TOP</u>	<u>BOTTOM</u>	<u>REMARKS</u>
Sand	14	25	
Sand-slate	25	1375	Gas 150 M.
Salt sand	1375	1495	
Slate-shells	1495	1530	
Red Rock	1530	1540	
Slate shells	1540	1660	
Black lime	1660	1690	
Slate	1690	1693	
Big Lime	1693	1860	
Sand	1860	1900	
Slate	1900	1905	
Injun sand	1905	2048	
Slate shells	2048	2360	
Hard lime	2360	2380	
✓ Berea sand	2457	2471	
Total depth	2471	2492	

Well commenced Feb. 15, 1928 ✓
 Well completed Apr. 9, 1926 ✓

Contractor
 L. E. Means

MATERIAL USED IN WELL

14'-10" Casing
 480'-8 1/2" Casing
 1693'- 6 5/8" Casing
 2058'- 5 3/16" Casing

MATERIAL LEFT IN WELL

14'-10" Casing
 2058'- 5 3/16" Casing
 Oil Well
 2492' Tubing 2"

Rock Pressure 370# ✓

SOUTHEASTERN GAS COMPANY
 AND AFFILIATED COMPANIES
 P. O. BOX 2347
 CHARLESTON, W. VA. 25328

1981 prod. 341 Mcf in 365 days on line