



1) Date: December 6, 19 83
 2) Operator's Well No. 867
 3) API Well No. 47 - -13 - 3690
 State County Permit

STATE OF WEST VIRGINIA
 DEPARTMENT OF MINES, OIL AND GAS DIVISION
 APPLICATION FOR A WELL WORK PERMIT

- 4) WELL TYPE: A Oil / Gas X /
 B (If "Gas", Production X / Underground storage / Deep / Shallow X /)
- 5) LOCATION: Elevation: 985.47' Watershed: Beech Fork
 District: Washington County: Calhoun Quadrangle: 7.5' Tariff
- 6) WELL OPERATOR Sterling Drilling & Prod. Co., INC DESIGNATED AGENT Harry L. Berger, Jr.
 Address 360 Madison Ave. Fifth Floor Address 710 Virginia St., E.
New York, New York 10017 Charleston, W.V. 25301
- 8) OIL & GAS INSPECTOR TO BE NOTIFIED Name Deo Mace
 Address Rt. 1 Box 5
Sandridge, W.V. 25274
- 9) DRILLING CONTRACTOR: Name UNKNOWN AT THIS TIME
 Address
- 10) PROPOSED WELL WORK: Drill X / Drill deeper / Redrill / Stimulate
 Plug off old formation / Perforate new formation
 Other physical change in well (specify)
- 11) GEOLOGICAL TARGET FORMATION, BROWN SHALE
- 12) Estimated depth of completed well, 5325 feet
- 13) Approximate strata depths: Fresh, feet; salt, feet.
- 14) Approximate coal seam depths: 0 Is coal being mined in the area? Yes / No X /
- 15) CASING AND TUBING PROGRAM

RECEIVED
 DEC 27 1983
 OIL & GAS DIVISION
 DEPT. OF MINES

CASING OR TUBING TYPE	SPECIFICATIONS					FOOTAGE INTERVALS		CEMENT FILL-UP OR SACKS (Cubic feet)	PACKERS
	Size	Grade	Weight per ft.	New	Used	For drilling	Left in well		
Conductor									Kinds
Fresh water	9 5/8	LS	33#	X		275'	275'	To Surface	<u>NEAT</u>
Coal									Sizes
Intermediate	7"	J-55	20#	X		1950'	1950'	100 sks	Depths set
Production	4 1/2	ERW	10.5#	X			5325'	250 sks	Perforations:
Tubing								<u>or as req. by rule 15.01</u>	
Liners									Top Bottom

OFFICE USE ONLY
 DRILLING PERMIT

Permit number 47-013-3690 Date January 17, 19 84

This permit covering the well operator and well location shown below is evidence of permission granted to drill in accordance with the pertinent legal requirements subject to the conditions contained herein and on the reverse hereof. **Notification must be given to the District Oil and Gas Inspector, (Refer to No. 8) Prior to the construction of roads, locations and pits for any permitted work.** In addition, the well operator or his contractor shall notify the proper district oil and gas inspector 24 hours before actual permitted work has commenced.)

The permitted work is as described in the Notice and Application, plat, and reclamation plan, subject to any modifications and conditions specified on the reverse hereof.

Permit expires January 17, 1986 unless well work is commenced prior to that date and prosecuted with due diligence.

Bond: <u>BLANKET BOND</u>	Agent: <u>LP</u>	Plat: <u>MH</u>	Casing: <u>MW</u>	Fee: <u>6061</u>
---------------------------	------------------	-----------------	-------------------	------------------

[Signature]
 Administrator, Office of Oil and Gas

NOTE: Keep one copy of this permit posted at the drilling location.

I N S T R U C T I O N S T O A P P L I C A N T

CONCERNING THE LINE ITEMS:

- 1) Date of Notice.
- 2) Your well name and number.
- 3) To be filled out by the Office of Oil & Gas.
- 4) & 5) Use separate sheet if necessary.
- 4) Surface owner(s) of record to be served with Notice and Application. However, see also Code § 22-4-1b(b) if "more than three tenants in common or other co-owners of interest described in subsection (a) of this section hold interests in such lands".
- 5(i) "Coal Operator" means any person, firm, partnership, partnership association or corporation that proposes to or does operate a coal mine.
- 5(ii, iii) See Code § 22-4-20.
- 6) See Code § 22-4-11(c). However, in lieu of filing the lease(s) or other continuing contract(s), the Applicant may fill out the information in the space provided below.
- 7) See Code § § 22-4-11(d, e).

CONCERNING THE REQUIRED COPIES FOR FILING AND SERVICE:

Filing. Code § 22-4-1k and Regulation 7.02 provide that the original and required copies of the Notice and Application must be filed with the Administrator, accompanied by (i) a plat in the form prescribed by Regulation 11, (ii) a bond in one of the forms prescribed by Regulation 12, or in lieu thereof the other security allowed by Code § 22-4-1k(d) and the reclamation required by Code § 22-4-12b and Regulation 23, (iv) unless previously paid on the same well, the fees required by Code § 22-4-1a(c) and 22-3-12a, and (v) if applicable, the consent required by Code § 22-4-8a from the owner of any water well on dwelling within 200 feet of the proposed well.

Service. In addition, service must be made on the surface owner(s) and the person(s) with an interest in the coal. See Code § § 22-4-1m, 22-4-2, 22-4-2a, and 22-4-2b.

INFORMATION SUPPLIED UNDER CODE § 22-4-11(d)

IN LIEU OF FILING LEASE(S) AND OTHER CONTINUING CONTRACT(S)

Under the oath required to make the verification on the obverse side of this Notice, I depose and say that I am the person who signed the Notice for the Applicant, and that--

- (1) the tract of land is the same tract described in the Application to which this Notice applies, partly or wholly depicted in the accompanying plat, and described in the Construction and Reclamation Plan;
- (2) the parties and recordation data (if recorded) for lease(s) or other continuing contract(s) by which the Applicant claims the right to extract, produce or market the oil or gas are as follows:

<u>Grantor, lessor, etc.</u>	<u>Grantee, lessee, etc.</u>	<u>Royalty</u>	<u>Book Page</u>
Sibyl Pischke 1401 N.E. 35th St. Ft. Lauderdale, Fla. 33334	Sterling Drilling and Production Co., Inc.	1/8	081/279

Ann M. Warnick

05/17/2024



IV-9
(Rev 8-81)

DATE 12-14-83

WELL NO. Pischke # 867

State of West Virginia API NO. 47-013-3690

Department of Mines
Oil and Gas Division

CONSTRUCTION AND RECLAMATION PLAN

COMPANY NAME Sterling Drilling & Prod. Co WELL OPERATOR Sterling Drilling & Prod
Address 360 Madison Ave.- NY, NY 10017 Address c/o H.L. Berger - Chars., WV
Telephone (212) 949-9100 Telephone (304) 342-0121

LANDOWNER Ernest Jarvis SOIL CONS. DISTRICT Little Kanawha SCD
Revegetation to be carried out by Sterling Drilling & Prod. Co.-H.L. Berger (Agent)

This plan has been reviewed by Little Kanawha SCD. All corrections and additions become a part of this plan: 12-15-83
(Date)

Jarrett Newton
(SCD Agent)

RECEIVED
DEC 27 1983

ACCESS ROAD

Structure Culvert (A)
Spacing Size 12"
Page Ref. Manual 2-8

Structure Drainage Ditches (B)
Spacing Roadside
Page Ref. Manual 2-12

Structure Cross Ditches -- Broad Based (C)
Spacing 150' for 7-10% grade
Page Ref. Manual 2-4 Table 2

LOCATION

Structure Diversified (1)
Material Earthen
Page Ref. Manual 2-12

Structure Rip-Rap (2)
Material Rock
Page Ref. Manual 2-9

Structure _____ (3)
Material _____
Page Ref. Manual _____

All structures should be inspected regularly and repaired if necessary. All commercial timber is to be cut and stacked and all brush and small timber to be cut and removed from the site before dirt work begins.

REVEGETATION

Treatment Area I

Lime 2 Tons/acre
or correct to pH 6.5
Fertilizer 600 lbs/acre
(10-20-20 or equivalent)
Mulch Hay 2 Tons/acre
Seed* Ky-31 40 lbs/acre
Radio Clover 4 lbs/acre
_____ lbs/acre

Treatment Area II

Lime 2 Tons/acre
or correct to pH 6.5
Fertilizer 600 lbs/acre
(10-20-20 or equivalent)
Mulch Hay 2 Tons/acre
Seed* Ky-31 40 lbs/acre
Radio Clover 4 lbs/acre
_____ lbs/acre

*Inoculate all legumes such as vetch, trefoil and clovers with the proper bacterium. Inoculate with 3X recommended amount.

05/17/2024

Moore's Well Services, Inc.

PLAN PREPARED BY Richard A. Campbell

ADDRESS Route 1 Box 30

Duck, WV 25063

PHONE NO. (304) 364-5780

NOTES: Please request landowners' cooperation to protect new seedling for one growing season. Attach separate sheets as necessary for comments.

IV-9 REVERSE
(REV 8-81)

INVOLVED TOTOGRAPHIC MAP
QUADRANGLE 7 1/2' Tariff
Otter NW

Well Site 
Access Road _____

RECEIVED
DEPT. OF MINES
OIL & GAS DIVISION
DEC 12 1983

05/17/2024

IV-35
(Rev 8-81)

RECEIVED
AUG 30 1984



OIL & GAS DIVISION
DEPT. OF MINES
State of West Virginia
Department of Mines
Oil and Gas Division

Date 6/19/84
Operator's
Well No. 867
Farm Sibyl Pischke, etal
API No. 47 - 013 - 3690

WELL OPERATOR'S REPORT
OF
DRILLING, FRACTURING AND/OR STIMULATING, OR PHYSICAL CHANGE

WELL TYPE: Oil / Gas / Liquid Injection / Waste Disposal /
(If "Gas," Production / Underground Storage / Deep / Shallow /)

LOCATION: Elevation: 985.47 Watershed Beech Fork
District: Washington County Calhoun Quadrangle 7 1/2' Arnoldsburg

COMPANY Sterling Drilling & Production Co., Inc.

ADDRESS 710 Virginia St., E, Charleston, WV 25301

DESIGNATED AGENT Harry L. Berger, Jr.

ADDRESS 710 Va. St., E. Charleston, WV 25301

SURFACE OWNER Ernest Jarvis

ADDRESS Stumptown, WV 25280

MINERAL RIGHTS OWNER Sibyl Pischke, etal

ADDRESS 1401 NE 35th St., Ft Lauderdale, FL 33334

OIL AND GAS INSPECTOR FOR THIS WORK Deo

Mace ADDRESS Rt 1, Box 5, Sandridge, WV 25274

PERMIT ISSUED 1/17/84

DRILLING COMMENCED 5/19/84

DRILLING COMPLETED 5/25/84

IF APPLICABLE: PLUGGING OF DRY HOLE ON CONTINUOUS PROGRESSION FROM DRILLING OR REWORKING. VERBAL PERMISSION OBTAINED ON

Casing & Tubing	Used in Drilling	Left in Well	Cement fill up Cu. ft.
Size 20-16 Cond.			
13-10"			
9 5/8	331'	331'	180 sx
8 5/8			
7	2012'	2012'	175 sx
5 1/2			
4 1/2		5338'	300 sx
3			
2			
Liners used			

GEOLOGICAL TARGET FORMATION Devonian Shale Depth 5325 feet
Depth of completed well 5361 feet Rotary / Cable Tools
Water strata depth: Fresh 220 feet; Salt 1472 feet
Coal seam depths: Is coal being mined in the area? NO

OPEN FLOW DATA
Producing formation Devonian Shale Pay zone depth 3183-5299 feet
Gas: Initial open flow --- Mcf/d Oil: Initial open flow --- Bbl/d
Final open flow Show of gas Mcf/d Final open flow --- Bbl/d
Time of open flow between initial and final tests 05/17/2024 hours
Static rock pressure 1150 psig (surface measurement) after 96 hours shut in
(If applicable due to multiple completion--)
Second producing formation Pay zone depth feet
Gas: Initial open flow Mcf/d Oil: Initial open flow Bbl/d
Final open flow Mcf/d Oil: Final open flow Bbl/d
Time of open flow between initial and final tests hours
Static rock pressure psig (surface measurement) after hours shut in

CAL-3670

DETAILS OF PERFORATED INTERVALS, FRACTURING OR STIMULATING, PHYSICAL CHANGE, ETC.

Perforations: Stage 1: 27 holes 4680' - 5299'
 Stage 2: 27 holes 3853' - 4579'
 Stage 3: 27 holes 3183' - 3702'

Treatment: Stage 1: 750 gal. 15% HCl, 1159 MSCF N₂, BD 3100#
 Stage 2: 1000 gal. 15% HCl, 1236 MSCF N₂, BD 3200#
 Stage 3: 750 gal. 15% HCl, 1193 MSCF N₂, BD 2100#

WELL LOG

FORMATION	COLOR	HARD OR SOFT	TOP FEET	BOTTOM FEET	REMARKS
					Including indication of all fresh and salt water, coal, oil and gas
					All measurements 10' KB
Sandstone and Shale			0	1310	
Salt Sand			1310	1448	
Sandy Shale			1448	1530	
Maxon			1530	1576	
Shale			1576	1612	
Limey Sand			1612	1646	
Little Lime and Shale			1646	1698	
Pencil Cave			1698	1704	
Big Lime			1704	1833	
Big Injun			1833	1869	
Silty Shale			1869	2172	
Sunbury Shale			2172	2197	
Sandy Siltstone			2197	2540	
Silty Shale			2540	4557	
Grey Siltstone			4557	4594	
Grey Shale			4594	4840	
Grey Shaley Siltstone			4840	4936	
Grey Shale			4936	5102	
Sand			5102	5111	
Grey Shale			5111	5361	TD 5361

(Attach separate sheets as necessary)

Sterling Drilling and Production Co., Inc.
 Well Operator
 By: Harry A. Berger Jr 05/17/2024
 Date: 8-20-84

Note: Regulation 2.02(i) provides as follows:
 "The term 'log' or 'well log' shall mean a systematic detailed geological record of all formations, including coal, encountered in the drilling of a well."

STATE OF WEST VIRGINIA
DEPARTMENT OF MINES
OIL AND GAS WELLS DIVISION

RECEIVED
MAY 30 1984

INSPECTOR'S WELL REPORT & GAS DIVISION
DEPT. OF MINES

Permit No. 13-3690

Oil or Gas Well _____
(KIND)

Company Sterling
 Address _____
 Farm Pischke
 Well No. 867
 District Washington County Cal.
 Drilling commenced 5-19-84
 Drilling completed _____ Total depth _____
 Date shot _____ Depth of shot _____
 Initial open flow _____ /10ths Water in _____ Inch
 Open flow after tubing _____ /10ths Merc. in _____ Inch
 Volume _____ Cu. Ft.
 Rock pressure _____ lbs. _____ hrs.
 Oil _____ bbls., 1st 24 hrs.
 Fresh water _____ feet _____ feet
 Salt water _____ feet _____ feet

CASING AND TUBING	USED IN DRILLING	LEFT IN WELL	PACKERS
Size			
16			Kind of Packer _____
13			
10			Size of _____
8 1/4			
6 5/8			Depth set _____
5 3/16			
3			Perf. top _____
2			Perf. bottom _____
Liners Used			Perf. top _____
			Perf. bottom _____

CASING CEMENTED _____ SIZE _____ No. FT. _____ Date _____
 NAME OF SERVICE COMPANY _____
 COAL WAS ENCOUNTERED AT _____ FEET _____ INCHES
 _____ FEET _____ INCHES FEET _____ INCHES
 _____ FEET _____ INCHES FEET _____ INCHES

Drillers' Names Charlie Moore 2

Remarks: 331' 9 5/8" casing, Halibuton, Good cement circulated.
Because of soapy water, small amount of defoamer was used during mixing of cement & displacement water.

5-20-84
DATE

D. M. Moore 0517/2024
DISTRICT WELL INSPECTOR



RECEIVED

JAN 3 - 1985

OIL & GAS DIVISION
DEPT. OF MINES

State of West Virginia
Department of Mines
Oil and Gas Division
Charleston 25305

FINAL INSPECTION REPORT
INSPECTORS COMPLIANCE REPORT
September 24, 1984

COMPANY Sterling Drilling & Prod. Co.
710 Virginia Street, East
Charleston, West Virginia 25301

PERMIT NO 013-3690
FARM & WELL NO Ernest Jarvis #867
DIST. & COUNTY Washington/Calhoun

RULE	DESCRIPTION	IN COMPLIANCE	
		YES	NO
23.06	Notification Prior to Starting Work	_____	_____
25.04	Prepared before Drilling to Prevent Waste	_____	_____
25.03	High-Pressure Drilling	_____	_____
16.01	Required Permits at Wellsite	_____	_____
15.03	Adequate Fresh Water Casing	_____	_____
15.02	Adequate Coal Casing	_____	_____
15.01	Adequate Production Casing	_____	_____
15.04	Adequate Cement Strenght	_____	_____
15.05	Cement Type	_____	_____
23.02	Maintained Access Roads	_____	_____
25.01	Necessary Equipment to Prevent Waste	_____	_____
23.04	Reclaimed Drilling Pits	_____	_____
23.05	No Surface or Underground Pollution	_____	_____
23.07	Requirements for Production & Gathering Pipelines	_____	_____
16.01	Well Records on Site	_____	_____
16.02	Well Records Filed	_____	_____
7.05	Identification Markings	_____	_____

I HAVE INSPECTED THE ABOVE CAPTIONED WELL AND RECOMMEND THAT IT BE RELEASED:

SIGNED *D. Mace*

DATE 12-27-84

Your well record was received and reclamation requirements approved. In accordance with Chapter 22, Article 4, Section 2, the above well will remain under bond coverage for the life of the well.

T. H. v. B.
Administrator-Oil & Gas Division

January 18, 1985

DATE

**APPLICATION FOR DETERMINATION OF THE MAXIMUM LAWFUL
PRICE UNDER THE NATURAL GAS POLICY ACT (NGPA)**

1.0 API well number: (If not assigned, leave blank. 14 digits.)	47 - 013 - 3690 -
2.0 Type of determination being sought: (Use the codes found on the front of this form.)	107 Section of NGPA Category Code
3.0 Depth of the deepest completion location: (Only needed if sections 103 or 107 in 2.0 above.)	5361 feet
4.0 Name, address and code number of applicant: (35 letters per line maximum. If code number not available, leave blank.)	Sterling Drilling and Production Co. Inc. 018084 Name Seller Code 710 Virginia St. East, Arcade Building Street Charleston, WV 25301 City State Zip Code
5.0 Location of this well: (Complete (a) or (b).) (a) For onshore wells (35 letters maximum for field name.) (b) For OCS wells:	Washington District Field Name Calhoun Country State WV Area Name Block Number
(c) Name and identification number of this well: (35 letters and digits maximum.)	Date of Lease: Mo. Day Yr. OCS Lease Number Pischke #867
(d) If code 4 or 5 in 2.0 above, name of the reservoir: (35 letters maximum.)	
6.0 (a) Name and code number of the purchaser: (35 letters and digits maximum. If code number not available, leave blank.)	UNDEDICATED Name Buyer Code
(b) Date of the contract:	 Mo. Day Yr.
(c) Estimated total annual production from the well:	 Mo. Day Yr. Million Cubic Feet

	(a) Base Price	(b) Tax	(c) All Other Prices (Indicate (+) or (-).)	(d) Total of (a), (b) and (c)
7.0 Contract price: (As of filing date. Complete to 3 decimal places.)	S/MMBTU 5 . 7 9 8	-----	-----	-----
8.0 Maximum lawful rate: (As of filing date. Complete to 3 decimal places.)	S/MMBTU 5 . 7 9 8	-----	-----	-----

9.0 Person responsible for this application:	Harry L. Berger, Jr. Name <i>Harry L. Berger Jr.</i> Signature June 20, 1984 Date Application is Completed	Designated Agent Title 05/17/2024 304-342-0121
--	---	---

Agency Use Only
 Date Received by Juris. Agency
AUG 30 1984
 Date Received by FERC

APPLICATION FOR DETERMINATION OF THE MAXIMUM LAWFUL
 PRICE UNDER THE NATURAL GAS POLICY ACT (NGPA)
 (Sections 102, 103, 107 and 108)

GENERAL INSTRUCTIONS

Complete this form if you are applying for price classification under sections 102, 103, 107 or 108 of the NGPA.

Complete each appropriate item on the reverse side of this page. The code numbers used in items 4 and 6 can be obtained from the Buyer/Seller Code Book. If there is more than one purchaser or contract, identify the additional information in the spaces below. Also enter any additional remarks in the space below. The data reported on this form are not considered to be confidential and will not be treated as such.

Submit the completed application to the appropriate Jurisdictional Agency as listed in title 18 of the CFR, part 274.501. If there are any questions, call (202) 357-8585.

SPECIFIC INSTRUCTIONS

Use the codes in the table below for type of determination in item 2.

Section of NGPA (a)	Category Code (b)	Description (c)
102	1	New OCS lease
102	2	New onshore well (2.5 mile test)
102	3	New onshore well (1000 feet deeper test)
102	4	New onshore reservoir
102	5	New reservoir on old OCS lease
103	-	New onshore production well
107	0	Deep (more than 15,000 feet) high-cost gas
107	1	Gas produced from geopressured brine
107	2	Gas produced from coal seams
107	3	Gas produced from Devonian shale
107	5	Production enhancement gas
107	6	New tight formation gas
107	7	Recompletion tight formation gas
108	0	Stripper well
108	1	Stripper well - seasonally affected
108	2	Stripper well - enhanced recovery
108	3	Stripper well - temporary pressure buildup
108	4	Stripper well - protest procedure

Enter the appropriate information regarding other Purchasers/Contracts.

Contract Date (Mo, Da, Yr) (a)	Purchaser (b)	Buyer Code (c)

Remarks:

05/17/2024

DATE: SEP 14 1984
 OPERATOR: Sterling Drilling & Production Co.
 BUYER-SELLER: _____
 PURCHASER: Uncommitted

Department of Mines, Oil & Gas Division
 WELL DETERMINATION FILE NUMBER
840830-107-013 : 3690
 Above File Number on all Communications
 relating to Determination of this Well

Dev
QUALIFIED

CHECK EACH ITEM AS COMPLETE OR NOTE WHAT IS MISSING

NO. _____

FERC -121 _____ Items not completed - Line No. _____
 IV-1 Agent _____
 IV-2 Well Permit _____
 IV-6 Well Plat _____
 IV-35 Well Record _____ Drilling _____ Deepening _____
 IV-36 Gas-Oil Test: Gas Only _____ Was Oil Produced? _____ Ratio _____
 IV-39 Annual Production _____ years
 IV-40 90 day Production _____ Days off line: _____
 IV-48 Application for certification. Complete? _____
 IV Form 51 - 52 - 53 - 54 - 55 - 56 - 57 - 58 Complete? _____ Affidavit Sign _____
 Other: Survey _____ Logs _____ Geological Charts _____
 Structure Map _____ 1: 4000 Map _____ Well Tabulations _____
 Gas Analyses _____
 Date commenced: _____ Date completed _____ Deepened _____
 Production Depth: _____
 Production Formation: _____
 Final Open Flow: _____
 After Frac. R. P. _____
 Other Gas Test: _____
 Avg. Daily Gas from Annual Production: _____
 Avg. Daily Gas from 90-day ending w/1-120 days _____
 Line Pressure: _____
 Oil Production _____ From Completion _____
 Does lease inventory indicate enhanced recovery being done? _____
 Is affidavit signed? _____ Notarized? _____
 Official well record with the Department confirm the submitted information? _____
 Does computer program confirm? _____
 Operator checked to _____ by _____

05/17/2024

DEPARTMENT OF MINES OIL AND GAS DIVISION

Operator's
Well No. Pischke #857

API Well No.

47 - 013 - 3690
State County Permit

WELL CLASSIFICATION FORM

HIGH COST GAS WELL - DEVONIAN SHALE

NGPA Section 107

DESIGNATED AGENT Harry L. Berger, Jr.

ADDRESS Arcade Building; 710 Virginia St., E.
Charleston, WV 25301

LOCATION Elevation 985.47

WELL OPERATOR Sterling Drilling and Production Watershed Beech Fork
Co., Inc.

ADDRESS 710 Virginia St., East Washington County Calhoun Quad. Arnbq 7 1/2'
Charleston, WV 25301

GAS PURCHASER UNDEDICATED

Gas Purchase
Contract No. _____

ADDRESS _____

Meter Chart Code _____

Date of Contract _____

* * * * *

Date surface drilling began: 5/19/84

Indicate the bottom hole pressure of the well and explain how this was calculated.

Bottom Hole Pressure. PSIA -- Pf = Pwe XLGS

$t = 60 + (0.0075 \times 5361) + 459.67 = 560$. $X = \frac{1}{53.34} \times 560 = 1.0000335$

$Pf = 1150 \times 2.7183 \times 1.0000335 \times 4241 \times 0.690 \times 1.08 = 1280$ PSIA

AFFIDAVIT

I, Harry L. Berger, Jr., having been first sworn according to law, state that I have calculated the percentage of footage of the producing interval which is not Devonian Shale as indicated by a Gamma Ray index of less than 0.7 if a Gamma Ray log described in subparagraph (3)(1) or (3)(ii)(A) has been filed, or as indicated by the report described in subparagraph (3)(ii)(B); I have demonstrated that the percentage of potentially disqualifying non-shale footage is equal to or less than five (5) percent of the gross Devonian age interval; and I have no knowledge of any information not described in the application which is inconsistent with a conclusion that the well qualifies as a high-cost natural gas well.

Harry L. Berger Jr

STATE OF WEST VIRGINIA

COUNTY OF Kanawha, TO-WIT:

I, John K Brooks, a Notary Public in and for the state and county aforesaid, do certify that Harry L. Berger, Jr., whose name is signed to the writing above, bearing date the 20th day of June, 1984 05/17/2024 acknowledged the same before me, in my county aforesaid.

Given under my hand and official seal this 20th day of June, 1984.
My term of office expires on the 27 day of October, 1991.

(NOTARIAL SEAL)

John K Brooks
Notary Public

MAGNETIC NORTH

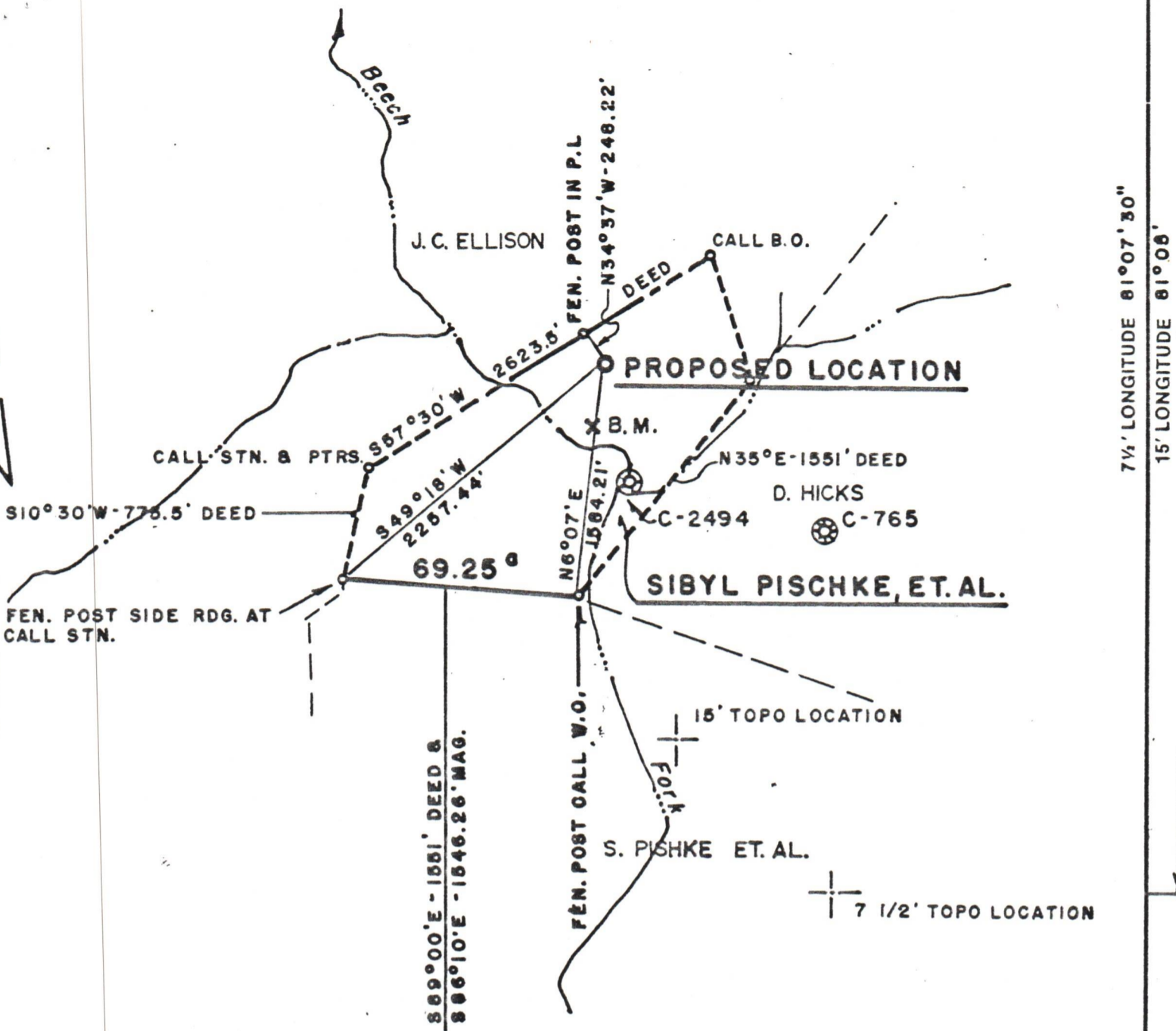

7 1/2' LONGITUDE 81°07'30"
15' LONGITUDE 81°08'

N. B. H - 26, PG. 45

FILE NO. 045-046
 MAP NO. 74-A
 SCALE 1" = 1000'
 MINIMUM DEGREE OF ACCURACY 1:200
 PROVEN SOURCE OF ELEVATION U.S.G.S. DATA B.M. SHOWN EL. 864'

I THE UNDERSIGNED, HEREBY CERTIFY THAT THIS PLAT IS CORRECT TO THE BEST OF MY KNOWLEDGE AND BELIEF AND SHOWS ALL THE INFORMATION REQUIRED BY LAW AND THE REGULATIONS ISSUED AND PRESCRIBED BY THE DEPARTMENT OF MINES.
 (SIGNED) Harry L. Berger, Jr.
 HARRY L. BERGER, JR. L.L.S. 248

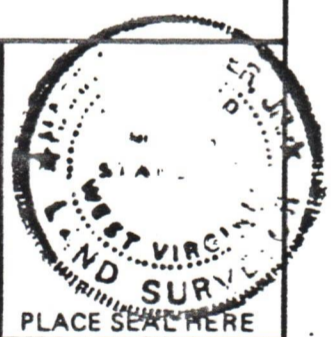

(+) DENOTES LOCATION OF WELL ON UNITED STATES TOPOGRAPHIC MAPS
 FORM IV-6 (8-78)



DATE NOV., 19 83
 OPERATOR'S WELL NO. 867
 API WELL NO. 47-013-3690
 STATE COUNTY PERMIT

STATE OF WEST VIRGINIA
 DEPARTMENT OF MINES
 OIL AND GAS DIVISION

WELL TYPE: OIL GAS LIQUID INJECTION WASTE DISPOSAL
 (IF "GAS,") PRODUCTION STORAGE DEEP SHALLOW
 LOCATION: ELEVATION 985.47' WATER SHED BEECH FORK
 DISTRICT WASHINGTON COUNTY CALHOUN
 QUADRANGLE 7 1/2' TARIFF (OTTER N.W.)
 SURFACE OWNER ERNEST JARVIS ACREAGE 69.25
 OIL & GAS ROYALTY OWNER SIBYL PISCHKE, ET. AL. LEASE ACREAGE 69.25 05/17/2024
 LEASE NO. 045-046

PROPOSED WORK: DRILL CONVERT DRILL DEEPER REDRILL FRACTURE OR STIMULATE PLUG OFF OLD FORMATION PERFORATE NEW FORMATION OTHER PHYSICAL CHANGE IN WELL (SPECIFY) _____

PLUG AND ABANDON CLEAN OUT AND REPLUG
 TARGET FORMATION BROWN SHALE ESTIMATED DEPTH 5325'
 OPERATOR STERLING DRILLING & PRODUCTION CO. INC. AGENT HARRY L. BERGER
 ADDRESS 360 MADISON AVE. - 5TH FLOOR ADDRESS 710 VIRGINIA ST., E.
NEW YORK, N.Y. 10017 CHARLESTON, WV 25301

STATE OF WEST VIRGINIA
DEPARTMENT OF MINES, OFFICE OF OIL & GAS

NOTICE OF APPLICATION FOR A WELL WORK PERMIT

4) SURFACE OWNER(S) OF RECORD TO BE SERVED

(i) Name Ernest Jarvis
Address 2854 Canton Rd.
Uniontown, Ohio 44685
(ii) Name _____
Address _____
(iii) Name _____
Address _____

5(i) COAL OPERATOR UNOPERATED
Address _____

5(ii) COAL OWNER(S) WITH DECLARATION ON RECORD:
Name UNKNOWN
Address _____

Name _____
Address _____

5(iii) COAL LESSEE WITH DECLARATION ON RECORD:
Name _____
Address _____

TO THE PERSON(S) NAMED ABOVE: You should have received this Form and the following documents:

- (1) The Application for a Well Work Permit on Form IV-2(B) (or Form IV-4 if the well is to be plugged, which sets out the parties involved in the drilling or other work, and describes the well and its location and, if applicable, the proposed casing and cementing program;
- (2) The plat (surveyor's map) showing the well location on Form IV-6; and
- (3) The Construction and Reclamation Plan on Form IV-9 (unless the well work is only to plug a well), which sets out the plan for erosion and sediment control and for reclamation for the site and access road.

THE REASON YOU RECEIVED THESE DOCUMENTS IS THAT YOU HAVE RIGHTS REGARDING THE APPLICATION WHICH ARE SUMMARIZED IN THE "INSTRUCTIONS" ON THE REVERSE SIDE OF THE COPY OF THE APPLICATION (FORM IV-2(B) OR FORM 4, DESIGNATED FOR YOU. HOWEVER, YOU ARE NOT REQUIRED TO TAKE ANY ACTION AT ALL.

Take notice that under Chapter 22 of the West Virginia Code, the undersigned well operator proposes to file or has filed this Notice and Application and accompanying documents for a Well Work Permit with the Administrator of the Office of Oil and Gas, West Virginia Department of Mines, with respect to a well at the location described on attached Application and depicted on attached Form IV-6. Copies of this Notice, the Application, the plat, and the Construction and Reclamation Plan have been mailed by registered or certified mail or delivered by hand to the person(s) named above (or by publication in certain circumstances) on or before the day of mailing or delivery to the Administrator.

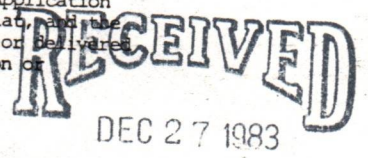

6) EXTRACTION RIGHTS

Check and provide one of the following:

- Included is the lease or leases or other continuing contract or contracts by which I hold the right to extract oil or gas.
- The requirement of Code 22-4-1-(c) (1) through (4). (See reverse side for specifics.)

7) ROYALTY PROVISIONS

Is the right to extract, produce or market the oil or gas based upon a lease or leases or other contract or contracts providing for flat well royalty or any similar provision for compensation to the owner of the oil or gas in place which is not inherently related to the volume of oil or gas so extracted, produced or marketed? Yes No

If the answer above is No, nothing additional is needed. If the answer is Yes, you may use Affidavit Form IV-60.

See the reverse side for line item instructions, and for instructions concerning the required copies of the Notice and Application, plat, and Construction and Reclamation Plan.

The truth of the information on the Notice and Application is verified and sworn to and the Notice is signed on behalf of the Well Operator in my County and State by Harry L. Berger, Jr.

WELL OPERATOR Sterling Drilling & Prod. Co., Inc.

By Harry L. Berger
Its Designated Agent
Address 710 Virginia St., E.
Charleston, W.V. 25301
Telephone 342 - 0121

this 6 day of December, 1983.
My commission expires May 10, 1989.

David M. Gillespie
Notary Public, Kanawha County,
State of West Virginia

05/17/2024

I N S T R U C T I O N S T O A P P L I C A N T

CONCERNING THE LINE ITEMS:

- 1) Date of Notice.
- 2) Your well name and number.
- 3) To be filled out by the Office of Oil & Gas.
- 4) & 5) Use separate sheet if necessary.
- 4) Surface owner(s) of record to be served with Notice and Application. However, see also Code § 22-4-1b(b) if "more than three tenants in common or other co-owners of interest described in subsection (a) of this section hold interests in such lands".
- 5(i) "Coal Operator" means any person, firm, partnership, partnership association or corporation that proposes to or does operate a coal mine.
- 5(ii, iii) See Code § 22-4-20.
- 6) See Code § 22-4-11(c). However, in lieu of filing the lease(s) or other continuing contract(s), the Applicant may fill out the information in the space provided below.
- 7) See Code § 22-4-11(d, e).

CONCERNING THE REQUIRED COPIES FOR FILING AND SERVICE:

Filing. Code § 22-4-1k and Regulation 7.02 provide that the original and required copies of the Notice and Application must be filed with the Administrator, accompanied by (i) a plat in the form prescribed by Regulation 11, (ii) a bond in one of the forms prescribed by Regulation 12, or in lieu thereof the other security allowed by Code § 22-4-1k(d) and the reclamation required by Code § 22-4-12b and Regulation 23, (iv) unless previously paid on the same well, the fees required by Code § 22-4-1a(c) and 22-3-12a, and (v) if applicable, the consent required by Code § 22-4-8a from the owner of any water well on dwelling within 200 feet of the proposed well.

Service. In addition, service must be made on the surface owner(s) and the person(s) with an interest in the coal. See Code § § 22-4-1m, 22-4-2, 22-4-2a, and 22-4-2b.

INFORMATION SUPPLIED UNDER CODE § 22-4-11(d)

IN LIEU OF FILING LEASE(S) AND OTHER CONTINUING CONTRACT(S)

Under the oath required to make the verification on the obverse side of this Notice, I depose and say that I am the person who signed the Notice for the Applicant, and that--

- (1) the tract of land is the same tract described in the Application to which this Notice applies, partly or wholly depicted in the accompanying plat, and described in the Construction and Reclamation Plan;
- (2) the parties and recordation data (if recorded) for lease(s) or other continuing contract(s) by which the Applicant claims the right to extract, produce or market the oil or gas are as follows:

<u>Grantor, lessor, etc.</u>	<u>Grantee, lessee, etc.</u>	<u>Royalty</u>	<u>Book Page</u>
Sibyl Pischke 1401 N.E. 35th St. Ft. Lauderdale, Fla. 33334	Sterling Drilling and Production Co., Inc.	1/8	081/279

Ann M. Warnick

05/17/2024

867
P 522 056 679

RECEIPT FOR CERTIFIED MAIL

NO INSURANCE COVERAGE PROVIDED—
NOT FOR INTERNATIONAL MAIL

(See Reverse)

Sent to ERNEST JARVIS	
Street and No. 2854 CANTON RD.	
P.O., State and ZIP Code UNIONTOWN, OHIO 44685	
Postage	\$54
Certified Fee	75
Special Delivery Fee	
Restricted Delivery Fee	
Return Receipt Showing to whom and Date Delivered	60
Return Receipt Showing to whom, Date, and Address of Delivery	
TOTAL Postage and Fees	189
Postmark or Postmark	UNIONTOWN, WV DEC 27 1983

PS Form 3800, Feb. 1982

RECEIVED

DEC 27 1983

OIL & GAS DIVISION
DEPT. OF MINES

05/17/2024

DEVONIAN SHALE GAMMA RAY LOG ANALYSIS
APPLICATION FOR DETERMINATION OF THE MAXIMUM LAWFUL
PRICE UNDER THE NATURAL GAS POLICY ACT

Operator: Sterling Drilling and Production Co., Inc. Agent: H.L. Berger
 Type Determination being sought - 107 (Devonian Shale)
 API Well No.: 47-013-3690 Well Name: Pischke # 867
 West Virginia Office of Oil and Gas County: Calhoun
 References: SJA File No.

Vol. _____ Page _____ Line _____

I. NOTE: A Gamma Ray Log has been marked with the (a) Shale Base Line, (b) a line representing 0.7 x (Shale Base Line), (c) intervals with Gamma Ray units less than 0.7 x (Shale Base Line) and that log is included with this analysis.

II. Gamma Ray elevation indices:

A. Shale Base Line (API Units)

1. GR Value at Base Line = 160 * API Units
2. Remarks:

Gamma Ray Scale = 0 → 200 units

B. Gamma Ray Log Value at 0.7 x Value at Base Line

1. GR Value = 160 * API Units
2. Calculation: $\frac{0.7 \text{ (GR Value at Base Line)}}{0.7 \text{ (160 *)}} = \underline{112}$ API Units

III. Intervals with GR index less than 0.7 x (Value at Base Line):

Interval		Thickness of Interval Feet	Feet of less than* 0.7 (Shale Base Line) Feet
From**	To***		
2200	5361'		

Total Devonian Interval 3161'

Total Less Than 0.7 (Shale Base) 23

% Less Than 0.7 (Shale Base Line) = $\frac{0.0073}{1} \times 100 = \underline{0.73} \%$ 05/17/2024

*Marked on log included with analysis.
 **Top of Devonian Section Recorded on First Interval in this Column.
 ***Lesser of TD or Bottom of Devonian Section Recorded as last Interval in this Column.

Checklist of minimum Forms and Information needed to apply for each well classification. Each is identified by an "Item No." The "Items" required are listed beneath each well classification.

FOR NEW ONSHORE WELL - Sec. 102 NGPA - More than 2.5 miles from a marker well.
Items - 1, 2, 3, 4, 5, 6, 9, 10, 22, 23 - (18 & 19 Qualified)

FOR NEW ONSHORE WELL - Sec. 102 NGPA - More than 1,000 feet deeper than a marker well,
Items - 1, 2, 3, 4, 5, 6, 9, 11, 22, 23 - (18 & 19 Qualified)

FOR NEW ONSHORE RESERVOIR WELL - Sec. 102 NGPA
Items - 1, 2, 3, 4, 5, 6, 9, 12, 20, 21, 24 - (18 & 19 Qualified)

FOR NEW ONSHORE PRODUCTION WELL - Sec. 103 NGPA
Items - 1, 2, 3, 4, 5, 6, 9, 13

FOR HIGH COST GAS - Sec. 107 NGPA
Items - 1, 2, 3, 4, 5, 6, 9, 14, 19 - (18 Qualified)

FOR STRIPPER WELLS - Sec. 108 NGPA
Items - 1, 2, 3, 4, 5, 6, 7, 8, 9, 15 (28 if Available)

FOR STRIPPER WELLS - Sec. 108 NGPA - Enhanced Recovery
Items - 9, 16

FOR STRIPPER WELLS - Sec. 108 NGPA - Seasonally Affected
Items - 9, 17, 28

<u>ITEM NOS.</u>	<u>FORM NO.</u>	<u>DESCRIPTION</u>
1.	FERC 121	
2.	IV-1	Operator Agent Certification
3.	IV-2	Well Permit Application
4.	IV-6	Well Plat
5.	IV-35	Well Operator's Drilling Report
6.	IV-36	Gas/Oil Ratio Test Report
7.	IV-39	Report of Annual Production
8.	IV-40	Ninety (90) Day Production Report
9.	IV-48WC	State Application for Well Classification
10.	IV-51WC	Wells drilled more than 2.5 miles from a marker well
11.	IV-52WC	Wells drilled more than 1,000 feet deeper than a marker well
12.	IV-53WC	New Onshore Reservoir Well
13.	IV-54WC	New Onshore Production Well
14.	IV-55WC	High Cost Natural Gas Well
15.	IV-56WC	Stripper Well Classification
16.	IV-57WC	Stripper - Increased Production by Enhanced Recovery
17.	IV-58WC	Stripper - Seasonally Affected
18.	N/A	Directional Survey
19.	N/A	Electric Logs
20.	N/A	Subsurface cross-section charts (Geological charts)
21.	N/A	Formation Structure Map
22.	N/A	1:4000 Well Location Map
23.	N/A	Well Tabulation Sheet
24.	N/A	Gas Analysis
25.	N/A	Other
26.	N/A	Notice - Increase of Production
27.	N/A	Lease Inventory
28.	N/A	Tax records or verified copies of billing statements for appropriate period.

05/17/2024

STATE OF WEST VIRGINIA
DEPARTMENT OF MINES, OIL AND GAS DIVISION

Date June 20, 19 84

Operator's Well No. Pischke #867

API Well No. 47 - 013 - 3690
State County Permit

Previous File No. _____
(If Applicable)

STATE APPLICATION FOR WELL CLASSIFICATION

WELL OPERATOR Sterling Drilling and Production

ADDRESS 710 Virginia St., East
Charleston, WV 25301

DESIGNATED AGENT Harry L. Berger, Jr.

ADDRESS Sterling Drilling & Production Co., Inc.
Arcade Building, Charleston, WV. 25301

Gas Purchase Contract No. _____ and Date _____
Meter Chart Code _____ (Month, day and year)

Name of First Purchaser UNDEDICATED

(Street or P. O. Box)

(City) (State) (Zip Code)

FERC Seller Code 018084 FERC Buyer Code _____

TYPE OF DETERMINATION BEING SOUGHT:

- (1) Initial determination (See FERC Form 121.) 107 Section of NGPA 107 Category Code _____
- (2) Determination that increased production is the result of enhanced recovery technology.
- (3) Determination of a seasonally affected well.

Harry L. Berger, Jr. Agent
Name (Print) Title
Harry L. Berger, Jr. Signature
Sterling Drilling & Production Co., Inc.
Street or P. O. Box
Arcade Bldg., Charleston, WV 25301
City State (Zip Code)
(304) 342-0121
Area Code Phone Number

(Certificate of Proof of Service to Purchaser)

(All of the above to be completed by the Operator/Applicant)

(To be completed by Jurisdictional Agency. Executed copy to be returned to Operator/Applicant and purchaser, if known).

The Department of Mines has received a request, for certification of the above described well as meeting the requirements of Section _____ under the Natural Gas Policy Act of 1976. (NGPA); or for determination that increased production is the result of enhanced recovery technology under Section 108 of (NGPA); or for determination of a seasonally affected well under Section 108 of (NGPA).

All interested parties are hereby notified that on the _____ day of _____, 19____, at the office of the Oil and Gas Division in Charleston, West Virginia, or as soon thereafter as it may be heard, there will be a public hearing, if requested, or if objection is filed.

This Application is assigned File No. _____

Initial review of information submitted indicates the well is, is not entitled to certification as claimed under the Natural Gas Policy Act (NGPA). A review of this evidence and any additional evidence will be made at the time appointed for a public hearing or as soon thereafter as the matter may be heard.

Unless objections are timely filed or a request for a hearing is made within fifteen (15) days, a hearing will not be held except on ex parte motion of the department and the matter will go to determination.

WEST VIRGINIA DEPARTMENT OF MINES

RECEIVED
AUG 30 1984

OIL & GAS DIVISION
Date received by _____
Jurisdictional Agency _____

Director 05/17/2024
By _____
Title _____



IV-9
(Rev 8-81)

DATE 12-14-83

WELL NO. Pischke # 867

State of West Virginia API NO. 47-013-3690

Department of Mines
Oil and Gas Division

CONSTRUCTION AND RECLAMATION PLAN

COMPANY NAME Sterling Drilling & Prod. Co WELL OPERATOR Sterling Drilling & Prod
Address 360 Madison Ave.- NY, NY 10017 Address c/o H.L. Berger - Chars., WV
Telephone (212) 949-9100 Telephone (304) 342-0121

LANDOWNER Ernest Jarvis SOIL CONS. DISTRICT Little Kanawha SCD
Revegetation to be carried out by Sterling Drilling & Prod. Co.-H.L. Berger (Agent)

This plan has been reviewed by Little Kanawha SCD. All corrections and additions become a part of this plan: 12-15-83 (Date)

Jarrett Newton
(SCD Agent)

RECEIVED

DEC 27 1983

ACCESS ROAD

LOCATION

OIL & GAS DIVISION

Structure Culvert (A)

Structure Diversions DEPT. OF MINE

Spacing See 12"

Material Earthen

Page Ref. Manual 2-8

Page Ref. Manual 2-12

Structure Drainage Ditches (B)

Structure Rip-Rap (2)

Spacing Roadside

Material Rock

Page Ref. Manual 2-12

Page Ref. Manual 2-9

Structure Cross Ditches -- Broad Based (C)

Structure _____ (3)

Spacing 150' for 7-10% grade

Material _____

Page Ref. Manual 2-4 Table 2

Page Ref. Manual _____

All structures should be inspected regularly and repaired if necessary. All commercial timber is to be cut and stacked and all brush and small timber to be cut and removed from the site before dirt work begins.

REVEGETATION

Treatment Area I

Treatment Area II

Lime 2 Tons/acre
or correct to pH 6.5

Lime 2 Tons/acre
or correct to pH 6.5

Fertilizer 600 lbs/acre
(10-20-20 or equivalent)

Fertilizer 600 lbs/acre
(10-20-20 or equivalent)

Mulch Hay 2 Tons/acre

Mulch Hay 2 Tons/acre

Seed* Ky-31 40 lbs/acre

Seed* Ky-31 40 lbs/acre

Radish Clover 4 lbs/acre

Radish Clover 4 lbs/acre

lbs/acre

lbs/acre

05/17/2024

*Inoculate all legumes such as vetch, trefoil and clovers with the proper bacterium. Inoculate with 3X recommended amount.

Moore's Well Services, Inc.

PLAN PREPARED BY Richard A. Campbell

ADDRESS Route 1 Box 30

Duck, WV 25063

PHONE NO. (304) 364-5780

NOTES: Please request landowners' cooperation to protect new seedling for one growing season. Attach separate sheets as necessary for comments.

