

1500143A

WW-7
8-30-06



West Virginia Department of Environmental Protection
Office of Oil and Gas
WELL LOCATION FORM: GPS

API: 47-015-00143 WELL NO.: WV 412811 (Thompson #30)

FARM NAME: Thompson

RESPONSIBLE PARTY NAME: EQT Production Company

COUNTY: Clay DISTRICT: Pleasant

QUADRANGLE: Elkhurst 7.5'

SURFACE OWNER: John and Robin Sizemore

ROYALTY OWNER: Henry B. Davenport

UTM GPS NORTHING: 4250001

UTM GPS EASTING: 487581 GPS ELEVATION: 419 m (1376 ft)

The Responsible Party named above has chosen to submit GPS coordinates in lieu of preparing a new well location plat for a plugging permit or assigned API number on the above well. The Office of Oil and Gas will not accept GPS coordinates that do not meet the following requirements:

1. Datum: NAD 1983, Zone: 17 North, Coordinate Units: meters, Altitude: height above mean sea level (MSL) – meters.
2. Accuracy to Datum – 3.05 meters
3. Data Collection Method:
Survey grade GPS : Post Processed Differential
Real-Time Differential
Mapping Grade GPS X: Post Processed Differential X
Real-Time Differential

4. Letter size copy of the topography map showing the well location.

I the undersigned, hereby certify this data is correct to the best of my knowledge and belief and shows all the information required by law and the regulations issued and prescribed by the Office of Oil and Gas.

Ben Sigler
Signature
4-5-2013
Date

P.S. 2092
Title

RECEIVED
Office of Oil and Gas
12-16-2013
WV Department of
Environmental Protection

04/26/2013

15 00143 P

Topo Quad: Elkhurst 7.5' Scale: 1" = 2000'

County: Clay Date: March 28, 2013

District: Pleasant Project No: 53-04-00-07

WV 412811 Thompson #30

Topo

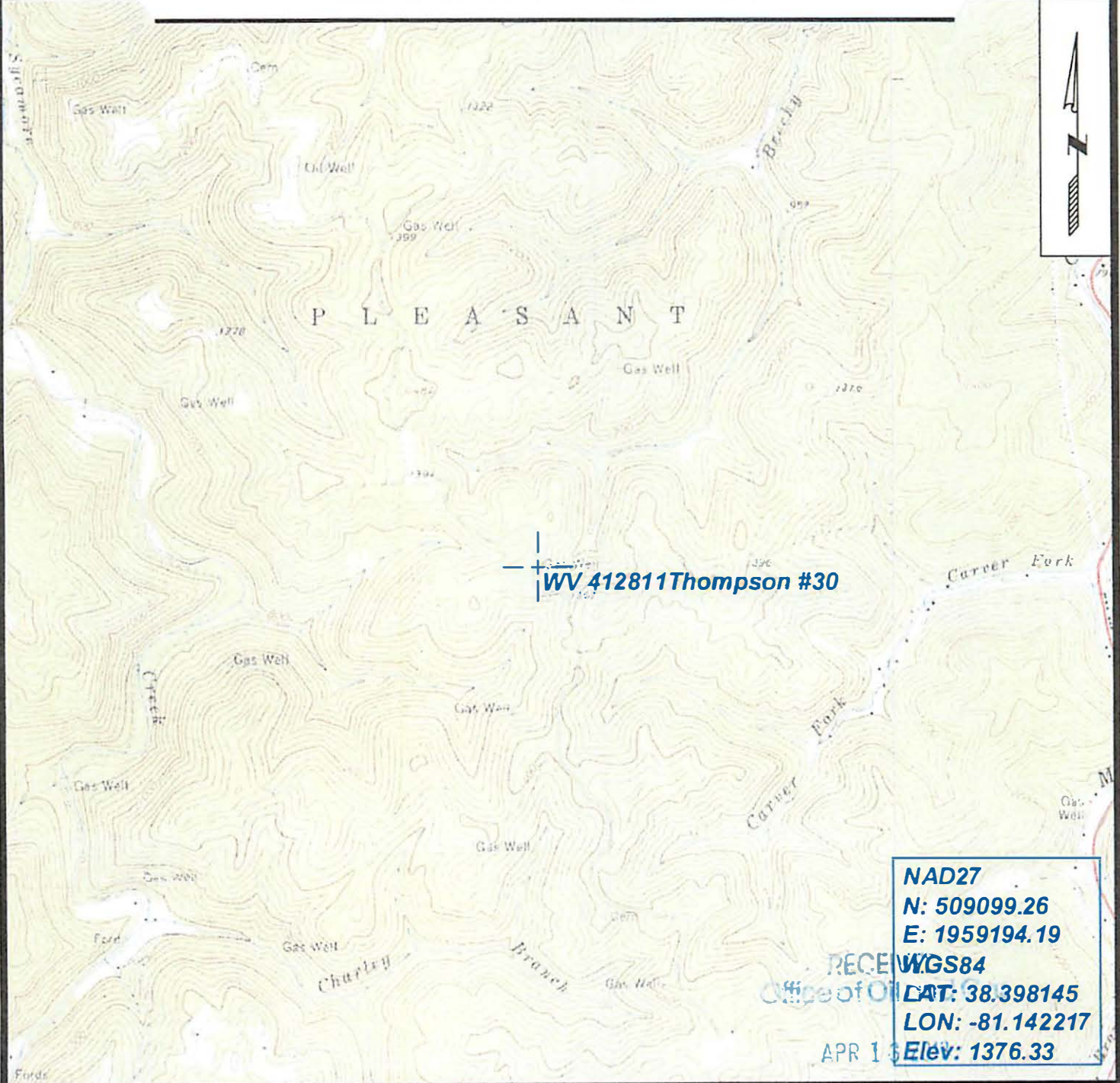

NAD27
N: 509099.26
E: 1959194.19
WGS84
LAT: 38.398145
LON: -81.142217
Elev: 1376.33

RECEIVED
 Office of Oil & Gas

APR 13



SURVEYING AND MAPPING SERVICES PERFORMED BY:
ALLEGHENY SURVEYS, INC.
 1-800-482-8606
 P.O. BOX 438
 BIRCH RIVER, WV 26610
 PH: (304) 649-8606
 FAX: (304) 649-8608

PREPARED FOR:
 Department of
EQT Production Co. Inc.
 1710 Pennsylvania Ave.
 Charleston, WV 25302

04/26/2013