

Latitude 39° 20'

Longitude 80° 50'

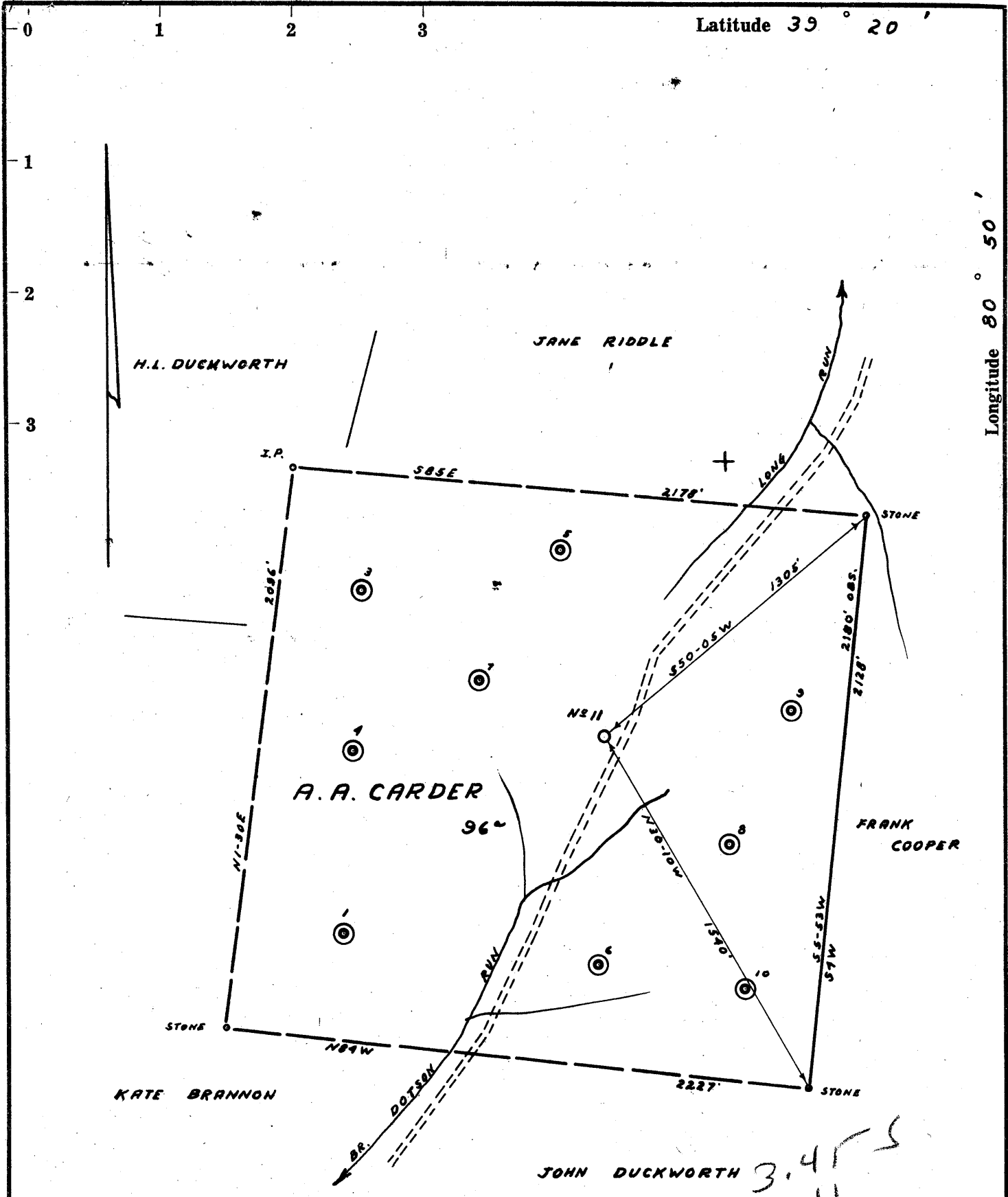

- Redrill.....
- New Location.
- Drill Deeper.....
- Abandonment.....

Company	W. LESLIE ROGERS	
Address	PENNSAUKEN, N.J.	
Farm	A. A. CARDER	
Tract	Acres 96	Lease No.
Well (Farm) No.	11	Serial No. 1
Elevation (Spirit Level)	963' V.A.	
Quadrangle	WEST UNION	SE 3 <sup>1-2</sup> - 50
County	DODDRIDGE District CENTRAL	
Engineer	JAMES D. JEFFRIES	
Engineer's Registration No.	1081	
File No.	198/62	Drawing No.
Date	12-14-59	Scale 1" = 500'

STATE OF WEST VIRGINIA  
 DEPARTMENT OF MINES  
 OIL AND GAS DIVISION  
 CHARLESTON

**WELL LOCATION MAP**

FILE NO. DOD-291

+ Denotes location of well on United States Topographic Maps, scale 1 to 62,500, latitude and longitude lines being represented by border lines as shown.

— Denotes one inch spaces on border line of original tracing.

RDM:

6-6-71



STATE OF WEST VIRGINIA  
DEPARTMENT OF MINES  
OIL AND GAS DIVISION 3

Quadrangle West Union S.E. 31-3

Permit No. DOD-291

WELL RECORD

Oil or Gas Well Oil & Gas  
(KIND)

Company W. Leslie Rogers  
 Address Pennsauken, New Jersey  
 Farm A. A. Carder Acres 96  
 Location (waters) Dotso Run  
 Well No. 1 Elev. 963  
 District Central County Doddridge  
 The surface of tract is owned in fee by Carder Heirs  
 Address Greenwood, W. Va.  
 Mineral rights are owned by Carder Heirs  
 Address Greenwood, W. Va.  
 Drilling commenced March 24, 1960  
 Drilling completed April 26, 1960  
 Date Shot From \_\_\_\_\_ To \_\_\_\_\_  
 With \_\_\_\_\_  
 Open Flow /10ths Water in \_\_\_\_\_ Inch  
 /10ths Merc. in \_\_\_\_\_ Inch  
 Volume 337 M Cu. Ft.  
 Rock Pressure 225 lbs. 24 hrs.  
 Oil 1/2 bbls., 1st 24 hrs.  
 WELL ACIDIZED \_\_\_\_\_  
 WELL FRACTURED (Acid) 12 M gal. 15%

Casing and Tubing	Used in Drilling	Left in Well	Packers
Size			
16			Kind of Packer
13			
10			Size of
8 1/4	532		
6 5/8	1187		Depth set
5 3/16	1927	1927	
3			Perf. top
2		1970	Perf. bottom
Liners Used			Perf. top
			Perf. bottom

CASING CEMENTED 5 1/2" SIZE 350' No. Ft. 4/21/60 Date  
20 lbs. Hi Early - 8 lbs. aquagel  
 COAL WAS ENCOUNTERED AT \_\_\_\_\_ FEET \_\_\_\_\_ INCHES  
Halliputon FEET \_\_\_\_\_ INCHES NONE FEET \_\_\_\_\_ INCHES  
 FEET \_\_\_\_\_ INCHES FEET \_\_\_\_\_ INCHES

RESULT AFTER TREATMENT 350 M cu. ft. - 4 bbl. oil  
 ROCK PRESSURE AFTER TREATMENT 250# - 24 hours  
 Fresh Water 30' Feet Salt Water 1795 - 1804 Feet

Formation	Color	Hard or Soft	Top	Bottom	Oil, Gas or Water	Depth	Remarks
Soil			0	10			
Slate			10	20			
Sand			20	30			
Red Rock			30	50	Water	30'	
Slate			50	85			
Red Rock			85	95			
Slate & Shells			95	185			
Red Rock			185	205			
Lime			205	215			
Red Rock			215	260			
Slate & Shells			260	310			
Sand			310	345	Water	315'	
Slate & Shells			345	360			
Sand			360	390			
Red Rock			390	398			
Lime			398	415			
Slate & Shells			415	430			
Red Rock			430	460			
Slate & Shells			460	560			
Black Slate			560	585			
Slate & Shells			585	605			
Black Slate			605	726			
Lime			726	728			
Slate			728	740			
Red Rock			740	845			
Slate			845	880			
Sand			880	885			
Slate			885	935			
Red Rock			935	975			
Slate & Shells			975	1075			

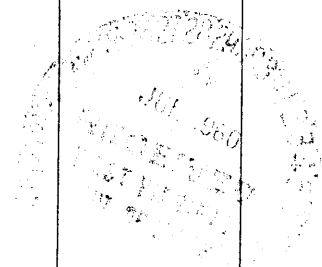

Formation	Color	Hard or Soft	Top $\zeta$	Bottom	Gas or Water	Depth Found	Remarks
Sand			1075	1085			
Slate & Shells			1085	1090			
Black Slate			1090	1100			
Slate & Shells			1100	1125			
Sand			1125	1140			
Slate & Shells			1140	1175			
Pink Rock			1175	1178			
Slate & Shells			1178	1245			
Lime			1245	1255			
Slate & Shells			1255	1300			
Sand			1300	1305			
Slate & Shells			1305	1400			
Sand			1400	1425	Water	1405	
Lime			1425	1430			
Slate & Shells			1430	1460			
Sand			1460	1483			
Slate & Shells			1483	1510			
Sand			1510	1565			
Slate & Shells			1565	1575			
Sand			1575	1608	Gas (Show)	1765	
Slate & Shells			1608	1745	Oil (Show)	1758	
Maxton Sand			1745	1804	Water	1795	
Slate			1804	1809			
Little Lime			1809	1835			
Blue Monday			1835	1842			
Pencil Cave			1842	1846			
Big Lime			1846	1924			
Big Injun			1924	1964	Gas	1936-1945	
Slate			1964	1967	Oil	1946-1954	
Squaw Sand			1967	1974			
Slate			1977			Total Depth	

Date July 28, 1928

APPROVED Th. Leslie Rogers, Owner

By C. A. Lutz, Agent  
(Title)