

Latitude 39 15'

Longitude 80 45'

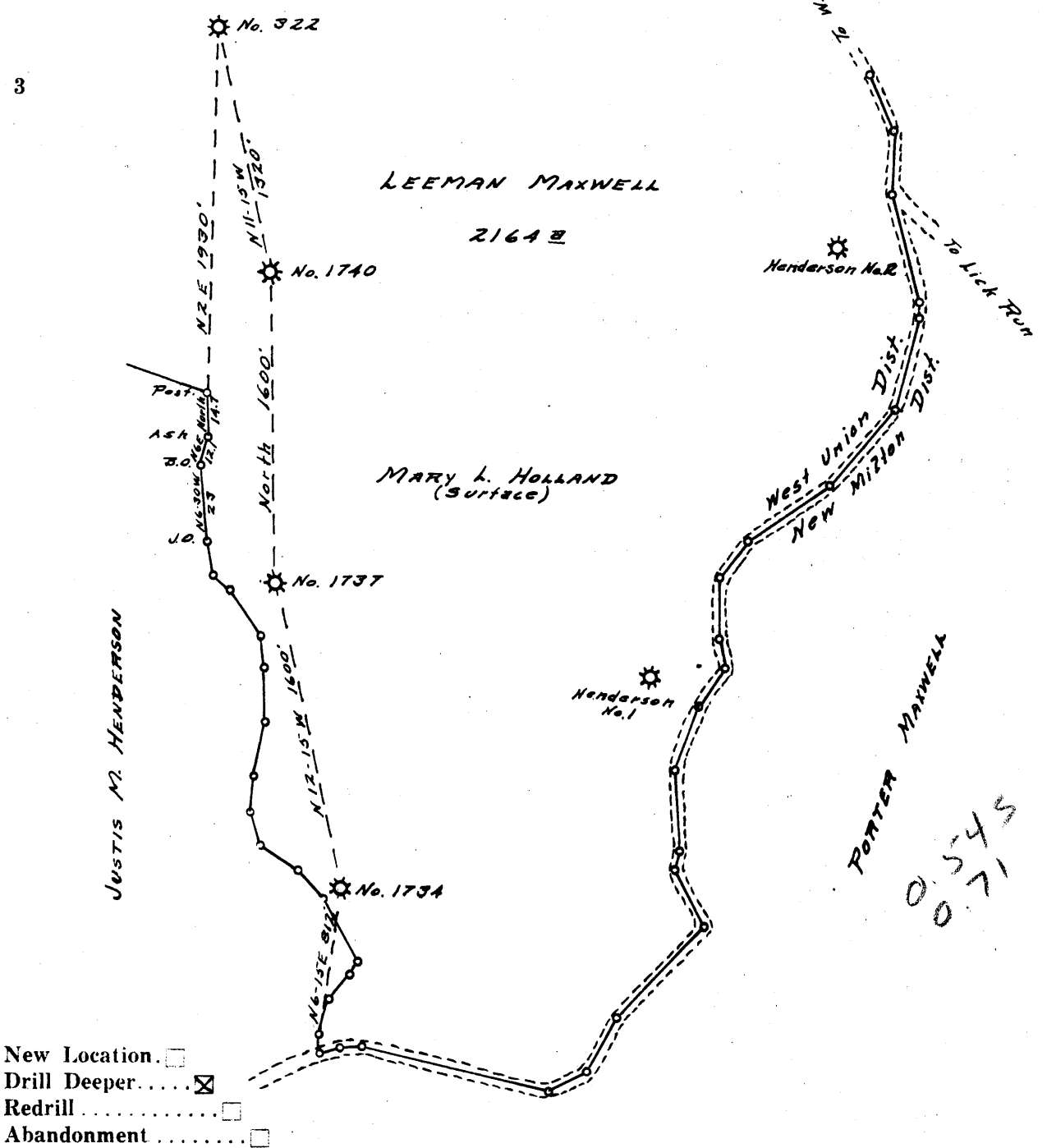

Company CARNEGIE NATURAL GAS
 Address PITTSBURGH, Pa.
 Farm LEEMAN MAXWELL
 Tract _____ Acres 2164 Lease No. E 6764
 Well (Farm) No. 5 Serial No. E 322
 Elevation (Spirit Level) 861'
 Quadrangle HOLBROOK NE
 County DODDRIDGE District WEST UNION
 Engineer [Signature]
 Engineer's Registration No. 1227
 File No. _____ Drawing No. _____
 Date 10-19-60 Scale 1" = 50 Feet

STATE OF WEST VIRGINIA
 DEPARTMENT OF MINES
 OIL AND GAS DIVISION
 CHARLESTON

WELL LOCATION MAP
 FILE NO DoD-490-0
12023?

+ Denotes location of well on United States Topographic Maps, scale 1 to 62,500, latitude and longitude lines being represented by border lines as shown.
 — Denotes one inch spaces on border line of original tracing.



STATE OF WEST VIRGINIA
DEPARTMENT OF MINES
OIL AND GAS DIVISION

Quadrangle Holbrook S. W.

Permit No. DOD-490-D

WELL RECORD

Oil or Gas Well Gas
(KIND)

Company Carnegie Natural Gas Company
Address 1015 Frick Building, Pittsburgh 19, Pa.
Farm Leeman Maxwell Acres 2164
Location (waters) Bluestone Creek
Well No. 5 - 322 Elev. 861'
District West Union County Doddridge
The surface of tract is owned in fee by Mary L. Holland
Address West Union, W.Va.
Mineral rights are owned by See below
Address _____
Drilling commenced October 17, 1960
Drilling completed May 4, 1961
Date Shot _____ From _____ To _____
With _____
Open Flow _____ /10ths Water in _____ Inch
_____ /10ths Merc. in _____ Inch
Volume 235,000 Cu. Ft.
Rock Pressure 720 lbs. 48 hrs.
Oil _____ bbls., 1st 24 hrs.
WELL ACIDIZED _____

| Casing and Tubing | Used in Drilling | Left in Well | Packers |
|-------------------|------------------|--------------|----------------------------|
| Size | | | Kind of Packer _____ |
| 16 | | | <u>Anchor</u> |
| 13 | | | Size of <u>5 1/2" x 7"</u> |
| 10 | | | Depth set <u>1528</u> |
| 8 1/4 | <u>1650</u> | <u>178</u> | Perf. top <u>1575</u> |
| 6 3/4 | <u>1632</u> | <u>1632</u> | Perf. bottom <u>1580</u> |
| 5 3/16 | <u>1578</u> | <u>1578</u> | Perf. top <u>1586</u> |
| 3 | | | Perf. bottom <u>1601</u> |
| 2 | | | |
| Liners Used | | | |

CASING CEMENTED 5 1/2" SIZE _____ No. Ft. _____ Date _____
with 100 bags

COAL WAS ENCOUNTERED AT _____ FEET _____ INCHES
_____ FEET _____ INCHES FEET _____ INCHES
_____ FEET _____ INCHES FEET _____ INCHES

WELL FRACTURED May 4, 1961

RESULT AFTER TREATMENT 2,214,000 cu ft.

ROCK PRESSURE AFTER TREATMENT 750# in 24 hrs.

Fresh Water _____ Feet Salt Water _____ Feet

| Formation | Color | Hard or Soft | Top | Bottom | Oil, Gas or Water | Depth | Remarks |
|--|-------|--------------|---|--------|-------------------|------------|----------------|
| | | | Commenced drilling deeper at <u>1400'</u> | | | | |
| Red Rock | | Soft | 1400 | 1410 | | | |
| Slate & Shls. | | Med. | 1410 | 1429 | | | |
| Lime | Black | Hard | 1429 | 1437 | | | |
| Slate | Gray | Med. | 1437 | 1444 | | | |
| Lime | Black | Hard | 1444 | 1455 | | | |
| Lime | Gray | Hard | 1455 | 1462 | | | |
| Sand | Gray | Hard | 1462 | 1477 | | | |
| Lime | Gray | Hard | 1477 | 1514 | | | |
| Sand | Gray | Hard | 1514 | 1519 | | | |
| Lime | Gray | Hard | 1519 | 1526 | | | |
| Slate | Dark | Med. | 1526 | 1536 | | | |
| Lime-Gritty | Dark | Hard | 1536 | 1545 | | | |
| Sand | Gray | Hard | 1545 | 1630 | Gas | 1553-59' | Big Injun sand |
| Slate | Gray | Soft | 1630 | | Gas | 1575-1604' | |
| Total | | | | 1650 | | | |
| MINERAL RIGHTS ARE OWNED BY: | | | | | | | |
| Ula Virginia Gray, Attorney-in-fact Heirs of L. Bassel Maxwell 1506 Chafton Road Charleston, W. Va. | | | | | | | |
| Mary H. Holland, Attorney-in-fact Heirs of Jane M. Henderson 308 Church Street West Union, W. Va. | | | | | | | |