

Latitude 39 ° 25 '

Longitude 80 ° 30 '

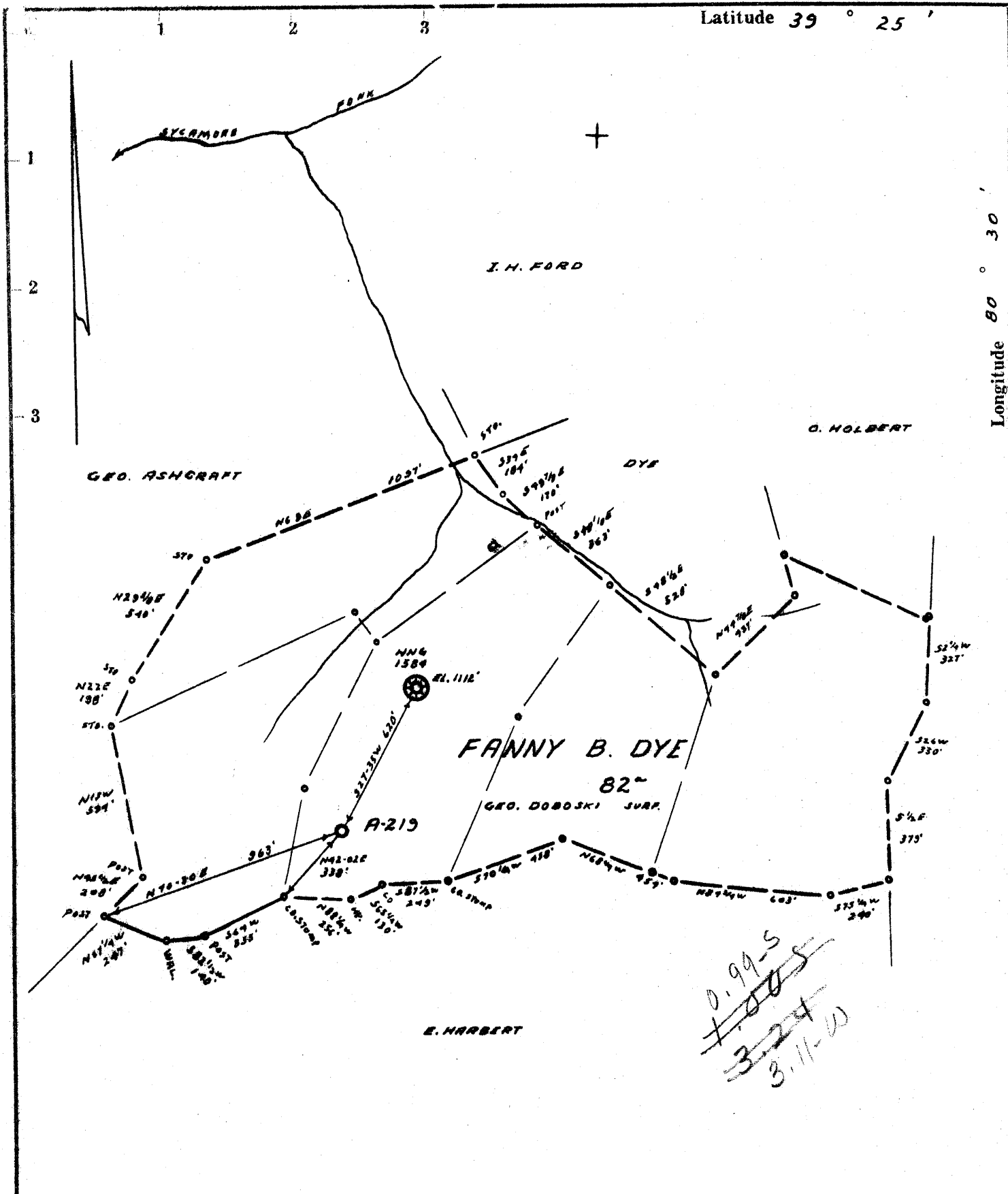

Redrill.....   
 New Location   
 Drill Deeper.....   
 Abandonment   
 ISSUED 5-24-63

I, the undersigned, hereby certify that this map is correct to the best of my knowledge and belief and shows all the information required by paragraph 6 of the rules and regulations of the oil and gas section of the mining laws of West Virginia.

Minimum accuracy, one part in 200

Company ALLEGHENY LAND & MINERAL CO.  
 Address CLARKSBURG, W. VA.  
 Farm FANNY B. DYE  
 Tract \_\_\_\_\_ Acres 82 Lease No. \_\_\_\_\_  
 Well (Farm) No. 2 Serial No. A-219  
 Elevation (Spirit Level) 1284'  
 Quadrangle CENTERPOINT NE 4' EC  
 County DODDRIDGE District M'CLELLAN  
 Engineer James T. Duffin  
 Engineer's Registration No. 1084  
 File No. 206/30 Drawing No. \_\_\_\_\_  
 Date 5-9-63 Scale 1" = 500'

STATE OF WEST VIRGINIA  
 DEPARTMENT OF MINES  
 OIL AND GAS DIVISION  
 CHARLESTON

**WELL LOCATION MAP**  
 FILE NO. Doc-986-P

+ Denotes location of well on United States Topographic Maps, scale 1 to 62,500, latitude and longitude lines being represented by border lines as shown.  
 — Denotes one inch spaces on border line of original tracing.



STATE OF WEST VIRGINIA  
DEPARTMENT OF MINES  
OIL AND GAS DIVISION 5

Quadrangle Centerpoint

Permit No. Dod-986

WELL RECORD

Oil or Gas Well Gas  
(KIND)

Company Allegheny Land & Mineral Co.  
Address Clarksburg, W.Va.  
Farm Fannie B. Dye Acres 82  
Location (waters) \_\_\_\_\_  
Well No. A-219 Elev. 1284  
District McClellan County Doddridge  
The surface of tract is owned in fee by Unknown  
Address \_\_\_\_\_  
Mineral rights are owned by Ashcraft Heirs  
Address Clarksburg, W.V.  
Drilling commenced June 29, 1963  
Drilling completed August 10, 1963  
Date Shot \_\_\_\_\_ From \_\_\_\_\_ To \_\_\_\_\_  
With \_\_\_\_\_  
Open Flow 8/10ths Water in 1 Inch  
\_\_\_\_\_/10ths Merc. in \_\_\_\_\_ Inch  
Volume 29,000 Cu. Ft.  
Rock Pressure None taken lbs. \_\_\_\_\_ hrs.  
Oil None bbls., 1st 24 hrs.  
WELL ACIDIZED \_\_\_\_\_

Casing and Tubing	Used in Drilling	Left in Well	Packers
Size			Kind of Packer
16	18'	18'	
13			
10	178'		Size of
8 1/4	1008'	1008'	
6 3/8			Depth set
5 3/16	2383'	2383'	
3			Perf. top <u>2307</u>
2			Perf. bottom <u>2315</u>
Liners Used			Perf. top <u>2340</u>
			Perf. bottom <u>2347</u>

CASING CEMENTED 4 1/2" SIZE 583 No. Ft. 8-12-63  
90 Bags Cement - 3 Bags Aquajel - Dowell  
COAL WAS ENCOUNTERED AT 952 FEET 959 INCHES  
\_\_\_\_ FEET \_\_\_\_\_ INCHES FEET \_\_\_\_\_ INCHES  
\_\_\_\_ FEET \_\_\_\_\_ INCHES FEET \_\_\_\_\_ INCHES

WELL FRACTURED August 16, 1963 - By Dowell - Water, sand, acid.

RESULT AFTER TREATMENT 30/10 Water 2" OF 231 M

ROCK PRESSURE AFTER TREATMENT 660# 15 hr.

Fresh Water 4 bailers per hour 92 Feet Salt Water \_\_\_\_\_ Feet

Formation	Color	Hard or Soft	Top	Bottom	Oil, Gas or Water	Depth	Remarks
Clay			0	45			
Sand			45	55			
Sand Red Rock			55	70			
Slate			70	82			
Red Rock			82	95			
Slate			95	150	Fresh water	92	4 bailers per hour
Sand			150	175			
Slate			175	200			
Red Rock			200	218			
Slate & shells			218	225			
Red Rock			225	235			
Slate			235	282			
Red Rock			282	306			
Slate & shells			306	336			
Red Rock			336	346			
Slate			346	455			
Red Rock			455	465			
Slate & shells			465	523			
Red Rock			523	552			
Slate & shells			552	605			
Sand			605	650			
Lime			650	664			
Slate & shells			664	688			
Lime			688	775			
Slate & shells			775	930			
Sand			930	945			
Slate			945	952			
Coal			952	959			
Slate & shells			959	1008			
Lime			1008	1018			

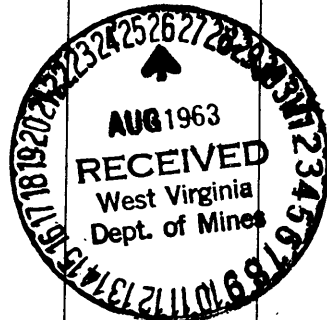

Formation	Color	Hard or Soft	Top	Bottom	Oil, Gas or Water	Depth Found	Remarks
Slate & shells		5	1018	1038			
Sand			1038	1073			
Slate & shells			1073	1095			
Red Rock			1095	1136			
Slate & shells			1136	1163			
Red Rock			1163	1215			
Slate & shells			1215	1245			
Red Rock			1245	1265			
Slate			1265	1326			
Sand			1326	1333			
Black slate			1333	1362			
Sand			1362	1382			
Black slate			1382	1437			
Lime			1437	1445			
Sand			1445	1515			
Slate			1515	1646			
Sand			1646	1666			
Slate			1666	1690			
Sand			1690	1715			
Slate			1715	1745			
Sand			1745	1782			
Slate & shells			1782	1825			
Sand			1825	1890			
Slate			1890	1925			
Lime			1925	1943			
Slate			1943	1954			
Sand			1954	2010			
Slate & shells			2010	2033			
Lime			2033	2042			
Sand			2042	2054			
Slate			2054	2103			
Lime			2103	2134			
Red Rock			2134	2139			
Slate			2139	2145			
Lime			2145	2171			
Slate			2171	2185			
Big Lime			2185	2262			
Sand			2262	2304	Gas	2290-2303	Show
Break <i>in</i>			2304	2318	Gas	2329-2334	8/10 W 1"
Sand			2318	2340			29 M
Shale			2340	2383			
Total Depth				2383			

4 1/2" casing perforated: 2340 to 2347 -- 14 shots  
2307 to 2315 -- 19 "

Date August 22, 19 61

APPROVED Allegheny Land & Mineral Co., Owner

By Claron Dawson, Mahone, W. Va.  
(Title)