

Latitude 39° 20'

Longitude 80° 36'

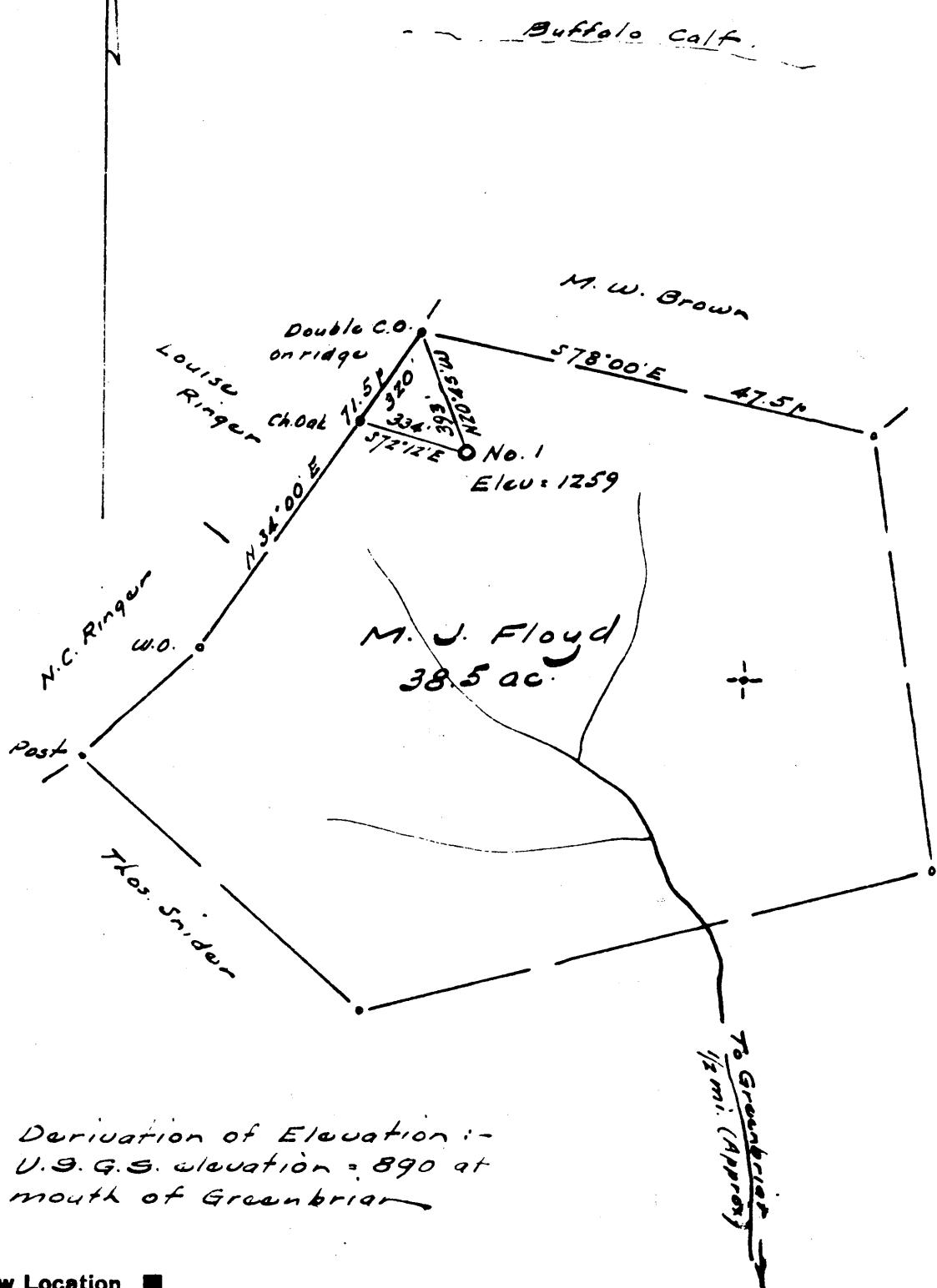

Derivation of Elevation :-  
 U.S.G.S. elevation = 890 at  
 mouth of Greenbrier

I, the undersigned, hereby certify that this map is correct to the best of my knowledge and belief and shows all of the information required by paragraph 5 of the rules and regulations of the oil and gas section of the mining laws of West Virginia.

*W. P. E. No. 1227*  
 W. P. E. No. 1227

- New Location
- Drill Deeper
- Abandonment

Error in closure :- Less than 1/1000'

Company JOHN H. HOLT  
 Address Wells Hotel, Sistersville, W. Va.  
 Farm M. J. Floyd  
 Tract \_\_\_\_\_ Acres 38.5 Lease No. \_\_\_\_\_  
 Well (Farm) No. One Serial No. \_\_\_\_\_  
 Elevation (Spirit Level) 1259  
 Quadrangle Centerpoint - SC  
 County Doddridge District Greenbrier  
 Engineer *W. P. E. No. 1227*  
 Engineer's Registration No. 1227  
 File No. \_\_\_\_\_ Drawing No. \_\_\_\_\_  
 Date June 3, 1963 Scale 1" = 300' = 495'

**STATE OF WEST VIRGINIA**  
 DEPARTMENT OF MINES  
 OIL AND GAS DIVISION  
 CHARLESTON

**WELL LOCATION MAP**  
 FILE NO. Pod - 990 - Council

+ Denotes location of well on United States Topographic Maps, scale 1 to 82,500, latitude and longitude lines being represented by border lines as shown.

- Denotes one inch spaces on border line of original tracing.