

LATITUDE 39 ° 25

LONGITUDE 80 ° 45 ' 12

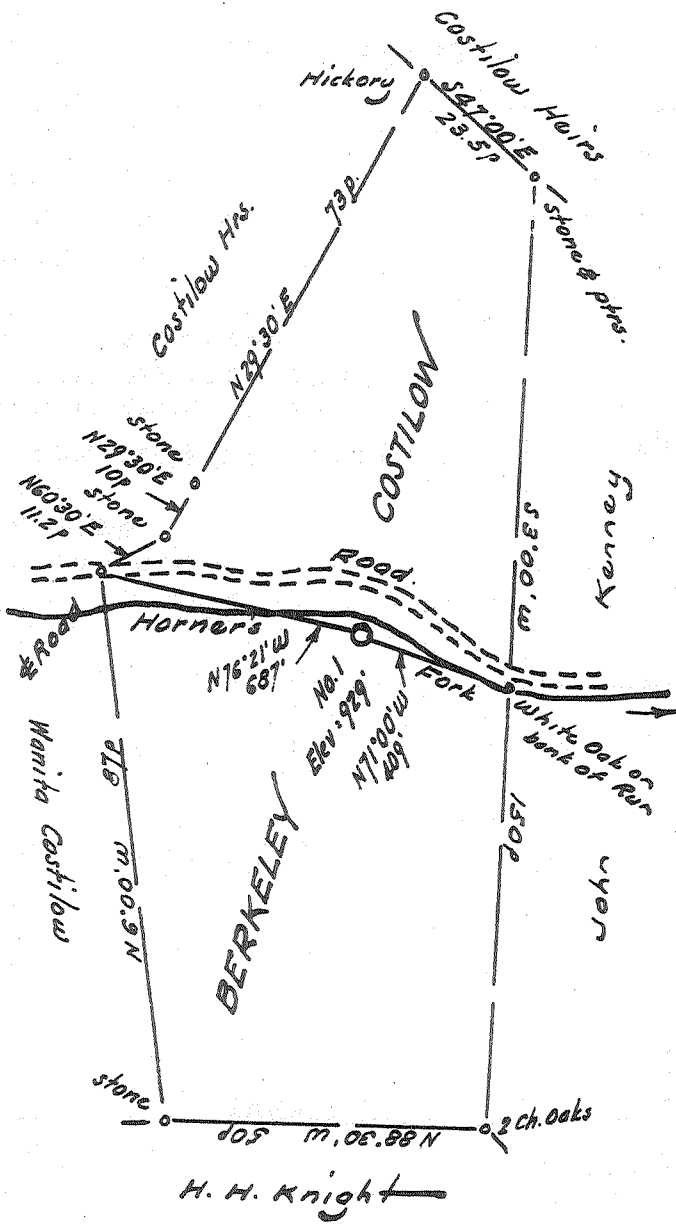

3.185  
0.05

I, the undersigned, hereby certify that this map is correct to the best of my knowledge and belief and shows all of the information required by paragraph 6 of the rules and regulations of the oil and gas division of the State of West Virginia.

*M. H. Knight*  
M. H. Knight

New Location.....

Drill Deeper.....

Abandonment.....

Reference to Elevation :- U. S. G. S. elevation at Kenton = 814

Error in closure :- Less than 1' in 200'

Company KENNETH POWELL

Address West Union, West Va.

Farm Berkeley Costilow, et al

Tract \_\_\_\_\_ Acres 49 Lease No. \_\_\_\_\_

Well (Farm) No. One Serial No. \_\_\_\_\_

Elevation (Spirit Level) 929'

Quadrangle West Union EC

County Doddridge District Grant

Engineer *W. H. Knight*

Engineer's Registration No. 1227

File No. \_\_\_\_\_ Drawing No. \_\_\_\_\_

Date June 25, 1964 Scale 1" = 300' = 495

STATE OF WEST VIRGINIA  
DEPARTMENT OF MINES  
OIL AND GAS DIVISION  
CHARLESTON

WELL LOCATION MAP  
FILE NO. Dod-1156

+ Denotes location of well on United States Topographic Maps, scale 1 to 62,500, latitude and longitude lines being represented by border lines as shown.

- Denotes one inch spaces on border line of original tracing.



STATE OF WEST VIRGINIA  
DEPARTMENT OF MINES  
OIL AND GAS DIVISION 3

Quadrangle WEST UNION

Permit No. DOD-1156

WELL RECORD

Oil or Gas Well DRY  
(KIND)

Company KENNETH POWELL  
Address WEST UNION, W. VA.  
Farm BERKLEY COSTILOW Acres 49  
Location (waters) LITTLE FLING  
Well No. ONE Elev. 929  
District GRANT County DODDRIDGE  
The surface of tract is owned in fee by BERKLEY COSTILOW  
Address PENNSBORO W. VA.  
Mineral rights are owned by BERKLEY COSTILOW ET AL  
Address \_\_\_\_\_

Casing and Tubing	Used in Drilling	Left in Well	Packers
Size			Kind of Packer
16			
13			
10			Size of
8 1/2	<u>450</u>		
8 1/4	<u>1.095</u>		Depth set
5 3/16			
3			Perf. top
2			Perf. bottom
Liners Used			Perf. top
			Perf. bottom

Drilling commenced JULY 13 1964  
Drilling completed SEPT. 4TH 1964  
Date Shot SEPT 8TH From 2046 To 2061  
With \_\_\_\_\_  
Open Flow /10ths Water in \_\_\_\_\_ Inch  
/10ths Merc. in \_\_\_\_\_ Inch  
Volume \_\_\_\_\_ Cu. Ft.  
Rock Pressure \_\_\_\_\_ lbs. \_\_\_\_\_ hrs.  
Oil \_\_\_\_\_ bbls., 1st 24 hrs.  
WELL ACIDIZED SHOT FROM 2046 TO 2061

CASING CEMENTED NO SIZE \_\_\_\_\_ No. Ft. \_\_\_\_\_ Date \_\_\_\_\_  
COAL WAS ENCOUNTERED AT NONE FEET \_\_\_\_\_ INCHES  
\_\_\_\_\_ FEET \_\_\_\_\_ INCHES FEET \_\_\_\_\_ INCHES  
\_\_\_\_\_ FEET \_\_\_\_\_ INCHES FEET \_\_\_\_\_ INCHES

WELL FRACTURED \_\_\_\_\_  
RESULT AFTER TREATMENT \_\_\_\_\_  
ROCK PRESSURE AFTER TREATMENT \_\_\_\_\_  
Fresh Water NONE Feet \_\_\_\_\_ Salt Water \_\_\_\_\_ Feet \_\_\_\_\_

Formation	Color	Hard or Soft	Top	Bottom	Oil, Gas or Water	Depth	Remarks
RED CLAY			0	20			
ROCK	GREY		20	125			
SLATE	BLACK		125	145			
SLATE	GREY		145	250			
RED ROCK			250	270			
LINE		HARD	270	280			
LINE		SOFT	280	360			
SAND		SOFT	360	375			
SLATE		SOFT	375	395			
LINE SHELL	BLACK	HARD	395	420			
SLATE		SOFT	420	448			
LINE		HARD	448	453			
SLATE			453	458			
LINE		HARD	458	489			
RED ROCK		SOFT	489	504			
SLATE		SOFT	504	550			
LINE		SOFT	550	615			
SLATE			615	635			
LINE			635	655			
SLATE			655	700			
SAND			700	725			
SLATE		SOFT	725	745			
RED ROCK			745	840			
LINE		HARD	840	845			
SLATE		SOFT	845	855			
RED ROCK			855	916			
LINE			916	940			
SLATE			940	960			
RED ROCK			960	989			



Formation	Color	Hard or Soft	Top 3	Bottom	Oil, Gas or Water	Depth Found	Remarks
LINE	GREY		989	994			
LINE	BLACK	HARD	994	1019			
LINE			1019	1047			
SAND			1047	1097			
SLATE		BLACK	1097	1108			
LINE		GRITTY	1108	1130			
SLATE SHELLS		BLACK	1130	1165			
SLATE	GREY	HARD	1165	1176			1193 TO 1230
LINE			1176	1193			1ST SALT SAND
SAND	SALT SAND	SOFT	1193	1230			
SLATE SHELLS		SOFT	1230	1276			
LINE	BLACK	HARD	1276	1320			
SLATE			1320	1380			
LINE	BLACK		1380	1385			
SLATE	GRAY	SOFT	1385	1408			1480 TO 1560
SAND			1408	1420			2ND SALT SAND
SLATE SHELLS			1420	1480			
SAND		HARD	1480	1560			
SLATE			1560	1582	1895		
SAND			1582	1612	929	1582 TO 1612 3RD	
LINE			1612	1635	966	SALT SAND	
SLATE SHELLS			1635	1708			
LINE			1708	1715			
SAND	GREY	HARD	1715	1753			1715 TO 1752
SLATE	GREY	SOFT	1753	1780			MAXON SAND
LINE	BLACK	HARD	1780	1815			
RED ROCK			1815	1857			
LINE			1857	1875			
SLATE	SOFT	SOFT	1875	1898			
LINE		HARD	1898	1980			
SAND			1980	2000			
LINE		GRITTY	2000	2010			
SAND		SOFT	2010	2113	GAS	2043	BIG INJUN
LINE		GRITTY	2113	2131			
SLATE		SHELLS	2131	2190			
LINE		<del>2130</del>	2190	2360			
SLATE SHELLS			2360	2445			
LINE		HARD	2445	2485			
SLATE SHELLS			2485	2636			
SLATE	BLACK	SOFT	2636	2657			
GORDON STRAY			2657	2678	GAS	2670	GORDON
SLATE			2678	2680		2680 TO 2690	S TRAY
SAND	BLACK	HARD	2680	2695			GORDON SAND
SLATE		SOFT	2695	2700			
SLATE		HARD	2700	2727			
	TOTAL DEPTH						2727.

Date Sept 23, 1964

APPROVED \_\_\_\_\_, Owner  
 By Arthur J. Powell (Title)