

I, the undersigned, hereby certify that this map is correct to the best of my knowledge and belief and shows all of the information required by paragraph 6 of the rules and regulations of the oil and gas section of the mining laws of West Virginia.

W. H. H. H.

New Location
 Drill Deeper
 Abandonment issued 9/12/74

Elev. ref.: - Well No. 1 - H. L. Hammond = 1175'
 Error in closure: - Less than 1' in 200

Ferrell L. Prior / e b 2
 Company **PRIOR OIL COMPANY**
 Address **224 Washington Bvd., Belore, Ohio.**
 Farm **G. S. Kinney**
 Tract **Acres 38.25** Lease No. _____
 Well (Farm) No. **One** Serial No. _____
 Elevation (Spirit Level) **1166**
 Quadrangle **West Union EC**
 County **Doddridge** District **West Union**
 Engineer ***W. H. H. H.***
 Engineer's Registration No. **1227**
 File No. _____ Drawing No. _____
 Date **March 17, 1966** Scale **1" = 200' x 330'**

STATE OF WEST VIRGINIA
 DEPARTMENT OF MINES
 OIL AND GAS DIVISION
 CHARLESTON
WELL LOCATION MAP
 FILE NO. **DDO-1364-P**
 + Denotes location of well on United States Topographic Maps, scale 1 to 62,500, latitude and longitude lines being represented by border lines as shown.
 - Denotes one inch spaces on border line of original tracing.
47-017

4-1-66-45

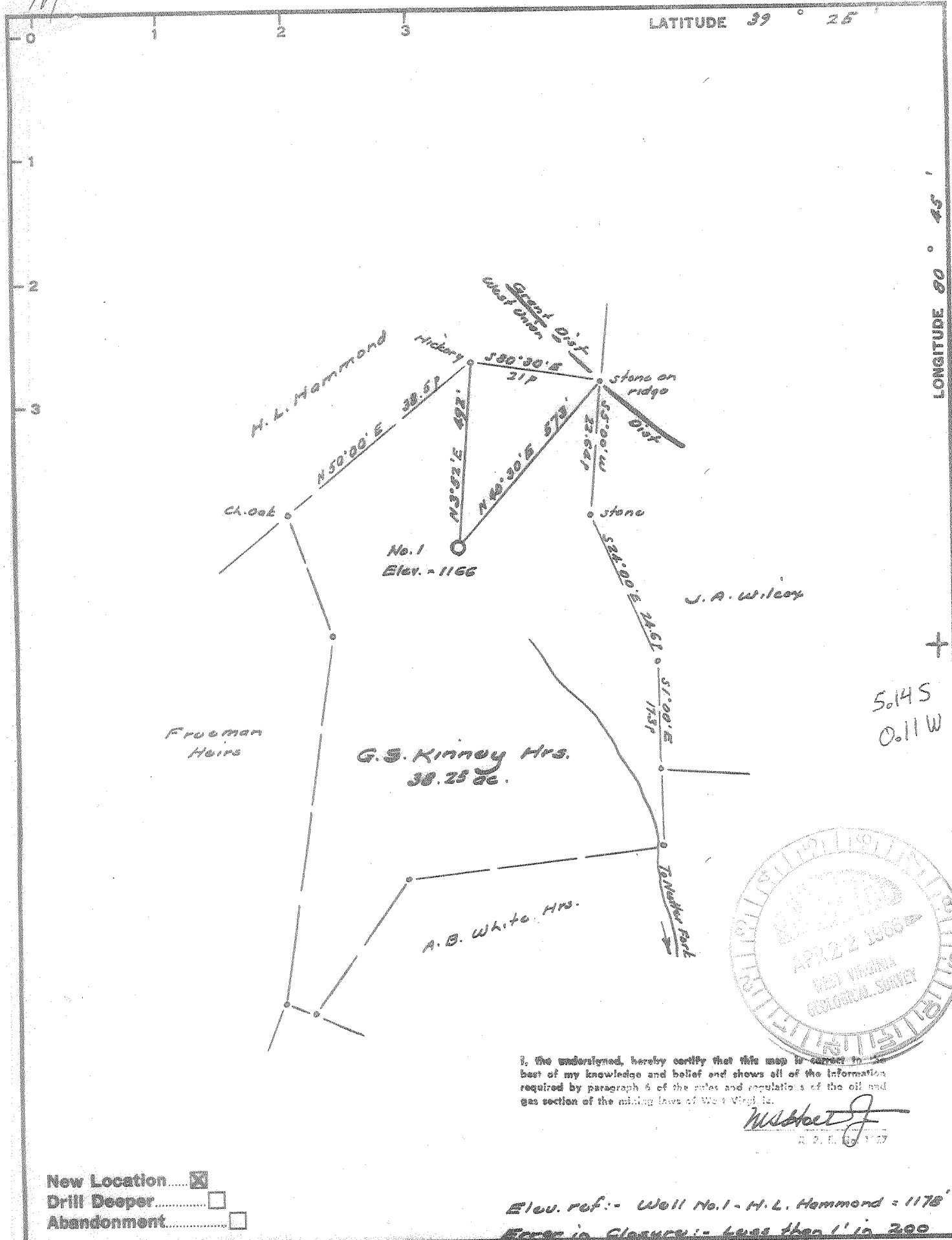

New Location.....
 Drill Deeper.....
 Abandonment.....

Company PRIDE OIL COMPANY
 Address 224 Washington Blvd., Belors, Ohio.
 Farm G. S. Kinney
 Tract _____ Acres 38.25 Lease No. _____
 Well (Farm) No. One Serial No. _____
 Elevation (Spirit Level) 1166
 Quadrangle West Union EC
 County Doddridge District West Union
 Engineer W. S. [Signature]
 Engineer's Registration No. 1227
 File No. _____ Drawing No. _____
 Date March 17, 1966 Scale 1" = 200' or 330'

STATE OF WEST VIRGINIA
 DEPARTMENT OF MINES
 OIL AND GAS DIVISION
 CHARLESTON

WELL LOCATION MAP
 FILE NO. DDO-1364

+ Denotes location of well on United States Topographic Maps, scale 1 to 62,500, latitude and longitude lines being represented by border lines as shown.
 - Denotes one inch spaces on border line of original tracing.

6-6-67



STATE OF WEST VIRGINIA
DEPARTMENT OF MINES
OIL AND GAS DIVISION

Rotary
Spudder
Cable Tools
Storage

Quadrangle WEST UNION

WELL RECORD

Permit No. DOD-1364

Oil or Gas Well OIL ~~GAS~~
(KIND)

Company PRIOR OIL WELL DRILLING COMPANY
Address 224 WASHINGTON BLVD., BELPRE, OHIO
Farm G. S. KINNEY Acres 38.25
Location (waters) _____
Well No. ONE Elev. 1166
District WEST UNION County DODDRIDGE
The surface of tract is owned in fee by G. S. KINNEY
Address PARKERSBURG, W. VA.
Mineral rights are owned by G. S. KINNEY
Address PARKERSBURG, W. VA.

Drilling commenced MAY 23, 1966
Drilling completed JULY 2, 1966

Date Shot _____ From _____ To _____
With _____

Open Flow _____ /10ths Water in _____ Inch
_____ /10ths Merc. in _____ Inch

Volume _____ Cu. Ft.

Rock Pressure NOT TAKEN lbs. _____ hrs.

Oil _____ bbls., 1st 24 hrs.

WELL ACIDIZED 500 GAL.

WELL FRACTURED 675 GAL. WATER 25,000 SAND

Casing and Tubing	Used in Drilling	Left in Well	Packers
Size			Kind of Packer
16			
13			
10 3/4	86' 10"		Size of
8 5/8	661'		
8 7/8	1313' 10"		Depth set
5 3/16			
4 1/2		2275	Perf. top 2234
2		2202	Perf. bottom 2237
Liners Used			Perf. top _____
			Perf. bottom _____

CASING CEMENTED 4 1/2" SIZE 2275 No. Ft. 7/2/66 Date

COAL WAS ENCOUNTERED AT NO COAL FEET _____ INCHES _____
FEET _____ INCHES _____ FEET _____ INCHES _____
FEET _____ INCHES _____ FEET _____ INCHES _____

RESULT AFTER TREATMENT 10 - 15 BBLs.

ROCK PRESSURE AFTER TREATMENT 700 LBS.

Fresh Water _____ Feet

Salt Water _____ Feet

Formation	Color	Hard or Soft	Top	Bottom	Oil, Gas or Water	Depth	Remarks
Clay			0	12			
Red rock			12	18			
Lime			18	28			
Gray slate			28	40			
Lime			40	55			
Red rock			55	85			
Lime			85	105			
Red rock			105	130			
Slate-shells			130	150			
Red rock			150	170			
Sand			170	205			
Lime			205	220			
Red rock			220	255			
Lime			255	270			
Red rock			270	285			
Slate-shells			285	315			
Red rock			315	372			
Lime			372	405			
Slate-shells			405	495			
Sand			495	518			
Slate			518	534			
Red rock			534	608			
Lime			608	626			
Red rock			626	657			
Lime			657	725			
Slate-shells			725	848			
Lime			848	870			
Slate-kshells			870	910			
Sand			910	928			
Red rock			928	1017			

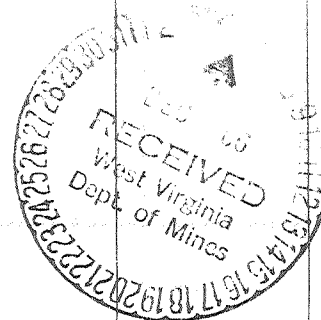

Formation	Color	Hard or Soft	Top δ	Bottom	Oil, Gas or Water	Depth Found	Remarks
Lime			1017	1050			
Red rock			1050	1080			
Lime			1080	1105			
Red rock			1105	1159			
Sand			1159	1175			
Pink rock			1175	1186			
Lime			1186	1246			
Sand			1246	1254			
Slate			1254	1272			
Sand			1272	1405			
Lime			1405	1462			
Slate-shells			1462	1470			
Lime			1470	1535			
Slate-shells			1535	1540			
Lime			1540	1590			
Sand			1590	1615			
Lime			1615	1650			
Sand			1650	1740			
Slate			1740	1748			
Sand			1748	1780			
Lime			1780	1795			
Slate-shells			1795	1840			
Sand			1840	1970			
Slate-shells			1970	2020			
Lime			2020	2028			
Sand			2028	2043			
Slate			2043	2081			
Lime			2081	2094			
Pencil Cave			2094	2102			
Big Lime			2102	2180			
Big Injun			2180	2208			
Squaw			2208	2237			
Slate-lime			2237	2246			
Lime-sand			2246	2275			

Date DECEMBER 2, 1966

APPROVED PRIOR OIL COMPANY, Owner

By *Herold S. Prior*
(Title)