

4-15-66

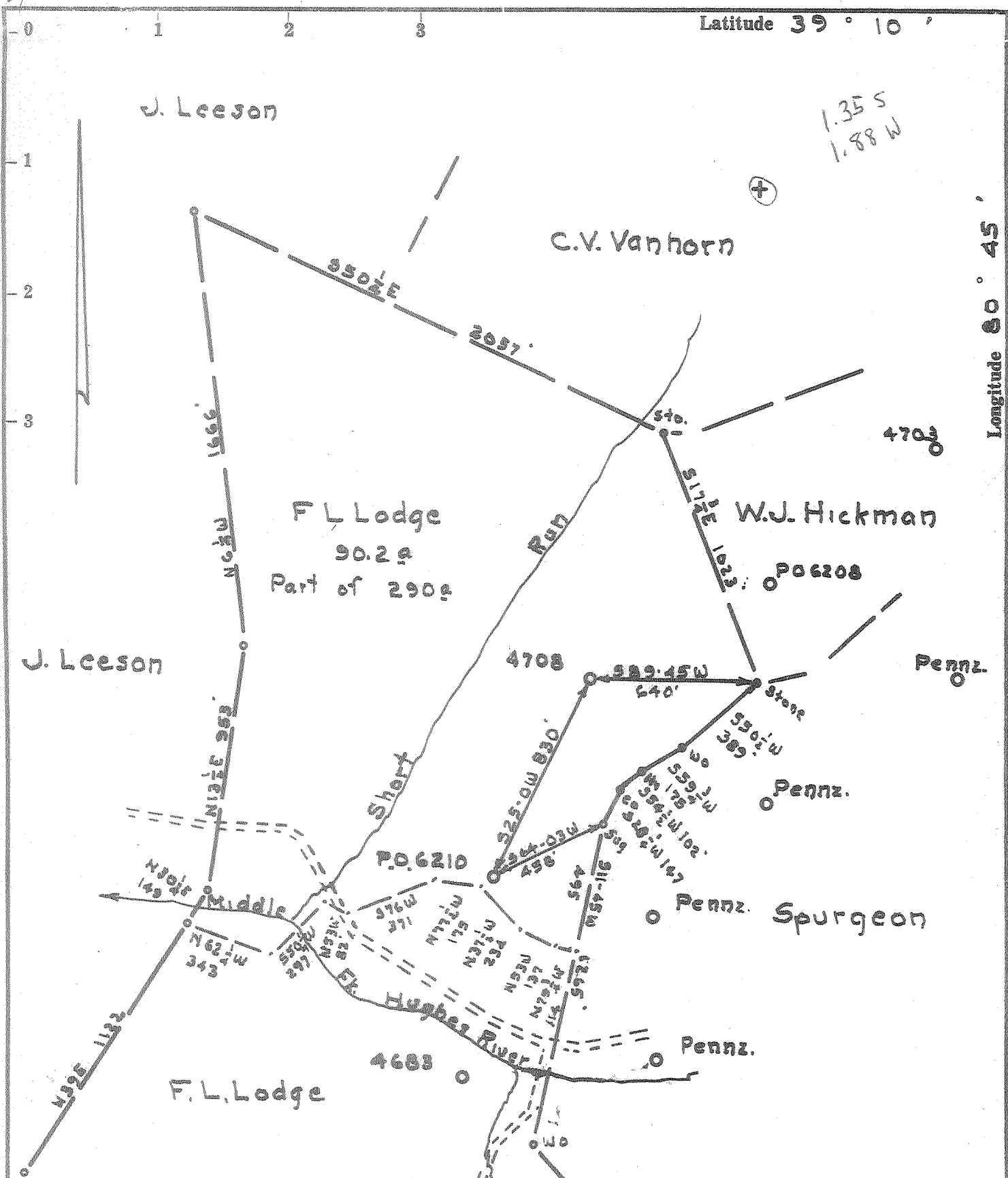

1.35 S
1.88 W

- Fracture.....
- Redrill.....
- New Location.
- Drill Deeper.....
- Abandonment.....

Source of Elevation Well No. 4708, Elev. 1062.0
 I, the undersigned, hereby certify that this map is correct to the best of my knowledge and belief and shows all the information required by paragraph 6 of the rules and regulations of the oil and gas section of the mining laws of West Virginia.
 Minimum accuracy, one part in 200

Company Equitable Gas Co, WVa Div
 Address Pittsburgh, Pa
 Farm F.L. Lodge
 Tract _____ Acres 290 Lease No. 7487
 Well (Farm) No. _____ Serial No. PO-6210
 Elevation (Spirit Level) 1071.0
 Quadrangle Halbrook NE-4 1/2 EC
 County Doddridge District Cove
 Engineer Jamie Duffin
 Engineer's Registration No. 1084
 File No. 210/50 Drawing No. _____
 Date 2-15-66 Scale 1"=500'

STATE OF WEST VIRGINIA
 DEPARTMENT OF MINES
 OIL AND GAS DIVISION
 CHARLESTON

WELL LOCATION MAP
 FILE NO. POD-1367

+ Denotes location of well on United States Topographic Maps, scale 1 to 62,500, latitude and longitude lines being represented by border lines as shown.
 — Denotes one inch spaces on border line of original tracing.

6-6-133



STATE OF WEST VIRGINIA
DEPARTMENT OF MINES
OIL AND GAS DIVISION

Rotary
Spudder
Cable Tools
Storage

Quadrangle Holbrook NE 4.3

Permit No. DOD-1367

WELL RECORD

Oil or Gas Well Oil
(KIND)

Company <u>Equitable Gas Company</u>	Casing and Tubing	Used in Drilling	Left in Well	Packers
Address <u>420 Blvd. of the Allies, Pittsburgh, Pa.</u>	Size			
Farm <u>F. L. Lodge</u> Acres <u>280</u>	16			Kind of Packer
Location (waters) <u>Holbrook NE 4.3</u>	13			Size of
Well No. <u>P.O. 6210</u> Elev. <u>1071</u>	10	<u>182</u>	<u>None</u>	Depth set
District <u>Cove</u> County <u>Doddridge</u>	8 1/4	<u>1079</u>	<u>None</u>	
The surface of tract is owned in fee by <u>Nettie Leeson, Atty.</u>	6 5/8	<u>1805</u>	<u>1805</u>	
in fact Address <u>Auburn, W. Va.</u>	5 3/16	<u>1962</u>	<u>1962</u>	
Mineral rights are owned by <u>Mamie Barnett, Atty. in fact</u>	4 1/2			Perf. top
at <u>al, W. Main St.,</u> Address <u>West Union, W. Va.</u>	3			Perf. bottom
Drilling commenced <u>8-15-66</u>	2			Perf. top
Drilling completed <u>10-19-66</u>	Liners Used			Perf. bottom
Date Shot <u>From</u> <u>To</u>				

Attach copy of cementing record.

Open Flow /10ths Water in Inch
 /10ths Merc. in Inch
 Volume Cu. Ft.
 Rock Pressure lbs. hrs.
 Dil. bbls., 1st 24 hrs.

WELL ACIDIZED (DETAILS)

WELL FRACTURED (DETAILS) 10-18-66

RESULT AFTER TREATMENT (Initial open Flow or bbls.) 222 bbls - 2 1/2 hrs.

ROCK PRESSURE AFTER TREATMENT HOURS

Fresh Water Feet Salt Water Feet

Producing Sand Big Injun Depth 1910-1998

Formation	Color	Hard or Soft	Top	Bottom	Oil, Gas or Water	Depth	Remarks
and			308	388			
Big Dunkard Sand			865	887			
Salt Sand 1			1170	1218			
Salt Sand 2			1260	1292			
Salt Sand 3			1358	1415			
Salt Sand 4			1465	1510			
Salt Sand 5			1530	1600			
Saxton Sand			1673	1715			
Little Lime			1802	1845			
Big Lime			1858	1908			
Big Injun Sand			1910	1998	Gas Gas Oil	1929-39 1992-98 1992-98	Temperature Temperature Temperature
Drilled to				2030			
stone to				2009			
al Seal to				1996			
Completed Total Depth				1996			

NOTE: Log shown from Gamma Ray Survey.
5-3/16" casing cemented in from 1962' to 1600'.

