



west virginia department of environmental protection

Office of Oil and Gas
601 57th Street SE
Charleston, WV 25304
(304) 926-0450
(304) 926-0452 fax

Earl Ray Tomblin, Governor
Randy C. Huffman, Cabinet Secretary
www.dep.wv.gov

April 13, 2015

WELL WORK PLUGGING PERMIT

Plugging

This permit, API Well Number: 47-1701506, issued to EQT PRODUCTION COMPANY, is evidence of permission granted to perform the specified well work at the location described on the attached pages and located on the attached plat, subject to the provisions of Chapter 22 of the West Virginia Code of 1931, as amended, and all rules and regulations promulgated thereunder, and to all conditions and provisions outlined in the pages attached hereto. Notification shall be given by the operator to the Oil and Gas Inspector at least 24 hours prior to the construction of roads, locations, and/or pits for any permitted work. In addition, the well operator shall notify the same inspector 24 hours before any actual well work is commenced and prior to running and cementing casing. Spills or emergency discharges must be promptly reported by the operator to 1-800-642-3074 and to the Oil and Gas inspector.

Upon completion of the plugging well work, the above named operator will reclaim the site according to the provisions of WV Code 22-6-30. The above named operator will also file, as required in WV Code 22-6-23, an affidavit on form WR-38 by two experienced persons in the operator's employment and the Oil and Gas inspector that the work authorized under this permit was performed and a description given. Failure to abide by all statutory and regulatory provisions governing all duties and operations here under may result in suspensions or revocation of this permit and in addition may result in civil and/or criminal penalties being imposed upon the operator.

This permit will expire in two (2) years from date of issue. If there are any questions, please free to contact me at (304) 926-0499 ext. 1654.

James Martin

Chief

Operator's Well No: 1-S-1235

Farm Name: JONES, B. F., JR.

API Well Number: 47-1701506

Permit Type: Plugging

Date Issued: 04/13/2015

04/17/2015

PERMIT CONDITIONS

West Virginia Code §22-6-11 allows the Office of Oil and Gas to place specific conditions upon this permit. Permit conditions have the same effect as law. Failure to adhere to the specified permit conditions may result in enforcement action.

CONDITIONS

1. All pits must be lined with a minimum of 20 mil thickness synthetic liner.
2. In the event of an accident or explosion causing loss of life or serious personal injury in or about the well or while working on the well, the well operator or its contractor shall give notice, stating the particulars of the accident or explosion, to the oil and gas inspector and the Chief within twenty-four (24) hours.
3. Well work activities shall not constitute a hazard to the safety of persons.

I
NOW

1701506P

Form WW-4 (B)
Permit Copy
(Rev 2/01)

CK 19080
\$100.00

Date: 2-19-15
Operator's Well
Well No. WV 655176 (Jones #1235)
API Well No.: 47 017 - 01506

STATE OF WEST VIRGINIA
DIVISION OF ENVIRONMENTAL PROTECTION
OFFICE OF OIL AND GAS

APPLICATION FOR A PERMIT TO PLUG AND ABANDON

4) Well Type: Oil Gas X Liquid Injection Waste Disposal:
If Gas, Production X Or Underground storage Deep Shallow X

5) Elevation: 854 FT Watershed: Buckeye Run of Middle Island Creek of Ohio River
Location: West Union County: Doddridge Quadrangle: Smithburg
District:

6) Well Operator EQT Production Company 7) Designated Agent: Rex C. Ray
Address: 120 Professional Place Address: 120 Professional Place
Bridgeport, WV 26330 Bridgeport, WV 26330

8) Oil & Gas Douglas Newlon 9) Plugging Contractor:
Name: 4060 Dutchman Rd. Name: HydroCarbon Well Service
Address: McFarlan, WV 26148 Address: PO BOX 995
 Buckhannon, WV 26201

10) Work Order: The work order for the manner of plugging this well is as follows:
See Attachment for details and procedures.

RECEIVED
Office of Oil and Gas
FEB 25 2015
WV Department of
Environmental Protection

OFFICE USE ONLY

Notification must be given to the district oil and gas inspector 24 hours before permitted work can commence.
Work order approved by inspector Date

04/17/2015

PLUGGING PROGNOSIS
 Jones B. F. #1-1235, (655176)
 Doddridge Co., West Virginia
 API # 47-017-01506
 District, West Union
 BY: Rick Green
 DATE: 02/02/15

★ THIS WELL HAS 1749' OF 4 1/2"
 PLUG BACK TO WAS 1774'.

CURRENT STATUS:

10" csg @ 86' (pulled)
 8 1/4" csg @ 1026'
 6 5/8" csg @ 1612' (pulled)
 TD @ 2575' (plugged back to 1593') 1774'
 Elevation @ 861'
 Fresh Water @ None Reported
 Salt Water @ None reported
 1" Salt Sand @ 1020'
 Coal @ 520' LESS THAN 20" THICK.
 Oil Shows @ none reported
 Gas shows @ 1530', 1635', and 2364'

- 1.) Notify State Inspector Doug Newlon 304-932-8049, 48 hrs, prior to commencing operations.
- 2.) ~~TIH tbg to 1575', Set 145' CIA cement plug 1575' to 1430' (Gas show, Safety Plug)~~
- 3.) ~~TOOH tbg to 1430' gel hole 1430' to 1080'~~
- 4.) ~~TOOH tbg to 1080' Set 160' CIA cement plug, 1080' to 920' (8 1/4" casing seat, Gas Sand) TOOH tbg.~~
- 5.) ~~Free point 8 1/4" casing, cut casing @ free point, TOOH csg.~~
- 6.) ~~Set 100' CIA cement plug, 50' in/out of cut. Perforate all 1" Salt Sands, freshwater, coal, oil & gas shows below cut. Do not omit any plugs.~~
- 7.) ~~TOOH tbg to 861' set 100' CIA cement plug, 861' to 761'. (Elevation).~~ DCN
- 8.) ~~TOOH tbg to 761' Gel hole 761' to 525'.~~ 2-23-2015
- 9.) ~~Set 100' CIA cement plug 525' to 425', (Coal).~~
- 10.) ~~TOOH tbg to 425', gel hole 425' to 200'.~~
- 11.) ~~TOOH tbg to 200', Set 200' CIA cement plug 200' to surface.~~
- 12.) ~~Erect monument with API#.~~
- 13.) ~~Reclaim location to WV-DEP specifications.~~

- 2.) TIH w/ TBG TO 1700'. GEL HOLE TO ≈ 1700'.
- 2a.) SET 200' CIA CEMENT PLUG FROM 1700' - 1500'. (PERFORATIONS, GAS SHOW)
- 3.) GEL HOLE FROM 1500' TO 1080'
- 4.) FREE POINT 4 1/2" CASING, CUT CASING @ FREE POINT, TOOH CSG.
5. SET 100' CIA CEMENT PLUG, 50' IN/OUT OF CUT (≈ 1200' depth). REMOVE CASING.
6. SET 150' CIA CEMENT PLUG FROM 1100' - 950'. (8 1/4" CASING SEAT)
7. GEL TO 550'. SET 100' CIA PLUG FROM 550' - 450'.
8. GEL HOLE FROM 450' - 200'.
9. SET 200' CIA CEMENT PLUG TO SURFACE.
10. ERECT MONUMENT WITH API #.
11. RECLAIM LOCATION TO WV-DEP SPECIFICATIONS.

04/17/2015
 H. H. H.



STATE OF WEST VIRGINIA
DEPARTMENT OF MINES
OIL AND GAS DIVISION

Rotary
Spudder
Cable Tools
Storage

Quadrangle CENTERPOINT S.W. 1/4
Permit No. DOD-1506-RED

WELL RECORD

Oil or Gas Well Gas
(KIND)

Company <u>Carnegie Natural Gas Company</u>	Casing and Tubing	Used in Drilling	Left in Well	Packers
Address <u>3901 Main Street, Minhall, Pennsylvania</u>				
Farm <u>B. F. Jones</u> Acres <u>11.5</u>	Size			
Location (waters) <u>Middle Island Creek</u>	16			Kind of Packer
Well No. <u>1-1235</u> Elev. <u>870'</u>	13			
District <u>West Union</u> County <u>Doddridge</u>	10	<u>286</u>		Size of
The surface of tract is owned in fee by	8 1/4	<u>1026</u>	<u>1026</u>	
Address	6 3/4	<u>1612</u>		Depth set
Mineral rights are owned by <u>L. H. Jones, Atty-in-Fact</u>	5 3/16			
<u>607 Sterhenson Street, Shreveport, La.</u>	4 1/2		<u>1749</u>	
Drilling commenced <u>6-1-68</u>	3			Perf. top <u>1630</u>
Drilling completed <u>8-19-68</u>	2			Perf. bottom <u>1688</u>
Date Shot From To	Liners Used			Perf. top
With				Perf. bottom

Attach copy of cementing record.
CASING CEMENTED 1 1/2" SIZE 1749 No. Ft. Date
Amount of cement used (bags) 50
Name of Service Co.
COAL WAS ENCOUNTERED AT FEET INCHES
FEET INCHES FBET INCHES
FEET INCHES FBET INCHES

WELL ACIDIZED (DETAILS)
WELL FRACTURED (DETAILS) 6/18/68 By Dowell W/58,000# Sand and 1123 bbls. fluid.
RESULT AFTER TREATMENT (Initial open Flow or bbls.) 381,000 cu. ft.
ROCK PRESSURE AFTER TREATMENT 440# in 16 hours HOURS
Fresh Water Feet Salt Water Feet
Producing Sand Big Injun Depth 1630 to 1688

Formation	Color	Hard or Soft	Top	Bottom	Oil, Gas or Water	Depth	Remarks
Soil & Stone			Surface	520			
Coal			520	520			Blossom only
Slate & Shells			520	840			
Little Durkard			840	860			
Big Durkard			895	925			
Gas Sand			1020	1185			
Slate & Shells			1185	1260			
2nd Salt			1260	1305			
Shelly Lime			1305	1490			
Little Lime			1490	1520			
Blue Monday			1530	1567	Gas	1538'	Show
Big Lime			1567	1625			
Big Injun			1625	1730	Gas	1635-1638	
Gantz			1870	2000			
Slate & Shells			2000	2290			
Gordon Stray			2290	2308			
Gordon			2314	2325			
4th Sand			2364	2372	Gas	2364-70	
5th Sand			2450	2455			
				2575			
				1593			
			1593	1774			
MECHANICAL LOG-TOPS:							
Little Lime			1508	1525			
Pencil Cave			1525	1535			
Blue Monday			1535	1552			
Big Lime			1552	1620			
Big Injun			1620	1692			
Squaw			1698	1719			

RECEIVED
Office of Oil and Gas
FEB 5 2015
WV Department of
Environmental Protection



Date August 19, 1968
APPROVED CARNEGIE NATURAL GAS COMPANY Owner
By [Signature] Chief Engineer (Title)

04/17/2015

Stratification	Color	Hard or Soft	Top	Bottom	Oil, Gas or Water	Depth Found	Remarks
6 Shells			2200	2290			
Iron Stray			2290	2300			
Gordon Sand			2311	2325			
4th Sand			2364	2372	Gas	2364-70	8/10 H-2" Would not test in 24 hrs.
5th Sand			2450	2455			
Total Depth				2750			
Plug ed Back Top			1593				

RECEIVED
Office of Oil and Gas
FEB 25 2015
WV Department of
Environmental Protection

Date May 20, 1968

Carnegie Natural Gas Company, Owner

APPROVED _____

By CC Talley
Chief Engineer (Title)

MAY 20 1968

ENCL. 1143

04/17/2015

Form OG-10



STATE OF WEST VIRGINIA
DEPARTMENT OF MINES
OIL AND GAS DIVISION

- Rotary
- Spudder
- Cable Tools
- Storage

Centerpoint SW
Quadrangle

WELL RECORD

Permit No. 655176

Oil or Gas Well. GAS (KIND)

Company CASH GAS NATURAL GAS
 Address 3904 Main St., Marshall, Penna. 15220
 Farm B. F. Jones Acres 115
 Location (waters) Hickory Creek
 Well No. 1-1235 Elev. 861
 District West Union County Ford ridge
 The surface of tract is owned in fee by _____
 Address _____
 Mineral rights are owned by L. L. Jones, Atty-in-Genl.
617 Stephenson St., Address Shreveport, La.
 Drilling commenced 8-17-1924
 Drilling completed 5-31-1924
 Date Shot 6-3-24 From 2365 To 2370' - 10'
 With 6-6-24 " 1509 " 1564 - 20'
 Open Flow 6 /10ths Water in 2" Inch
 _____ /10ths Merc. in _____ Inch
 Volume 26,000 Cu. Ft.
 Rock Pressure 4250 lbs. hrs.
 Oil _____ bbls., 1st 24 hrs.

Casing and Tubing	Used in Drilling	Left in Well	Packers
Size			Kind of Packer
16			Anchor
13			Size of <u>6-1/2" x 3"</u>
10	<u>206</u>		Depth set <u>2332</u>
8 1/4	<u>1026</u>	<u>1026</u>	
6 3/4	<u>1612</u>		
5 3/16			
4 1/4			
3		<u>279</u>	Perf. top
2		<u>1289</u>	Perf. bottom
			Perf. top
			Perf. bottom

WELL ACIDIZED (DETAILS) _____
 WELL FRACTURED (DETAILS) _____
 RESULT AFTER TREATMENT (Initial open Flow or bbls.) _____
 ROCK PRESSURE AFTER TREATMENT _____ HOURS _____
 Fresh Water _____ Feet _____ Salt Water _____ Feet _____
 Producing Sand _____ Depth _____

Formation	Color	Hard or Soft	Top	Bottom	Oil, Gas or Water	Depth	Remarks
Soil & Stone			Surface	520			
Gnl			520	520	Blowson only		
Slate & Shells			520	810			
Little Limestone			810	850			
Big Limestone			895	925			
Gas Sand			1020	1185			
Slate & Shells			1185	1250			
2nd Salt Sand			1250	1305			
Shelly Lime			1305	1470			
Little Lime			1470	1521			
Blue sanday			1530	1567	Gas	1530	Slow
Big Lime			1567	1625			
Big Limestone			1625	1730	Gas	1635 - 30	
Sandstone			1870	2000			

RECEIVED
 Office of Oil and Gas
 FEB 25 2015
 WV Department of
 Environmental Protection

RECEIVED
Office of Oil and Gas

FEB 25 2015

WV Department of
Environmental Protection

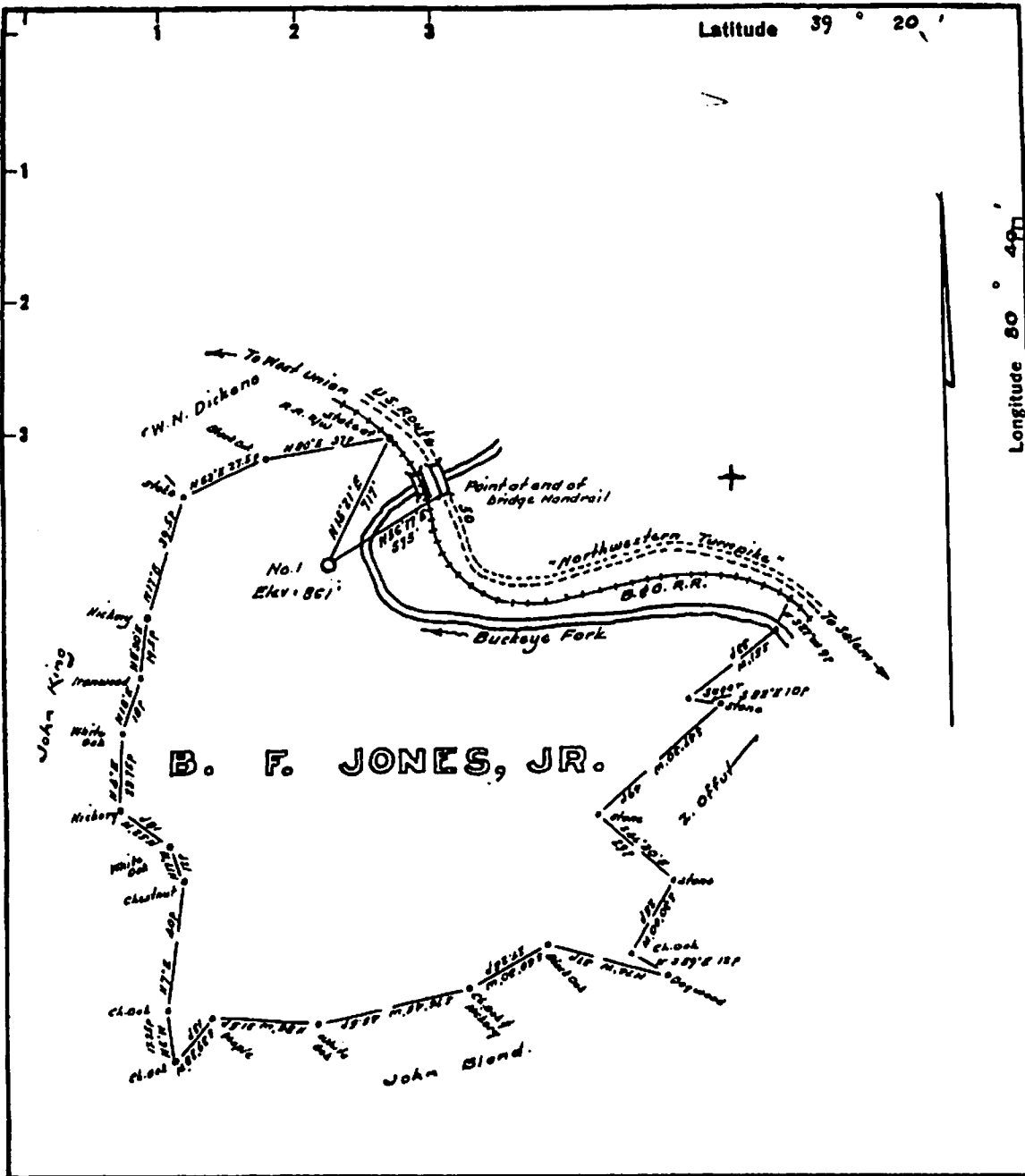

Fracture Before 6/5/29
 New Location
 Drill Deeper
 Redrill
 Abandonment

I, the undersigned, hereby certify that this map is correct to the best of my knowledge and belief and shows all the information required by Paragraph 5 of the Rules and Regulations of the Oil and Gas Section of the Mining Laws of West Virginia.
 The accuracy of this survey is within the limits and as prescribed in paragraph 5 by the Oil and Gas Division of the Department of Mines Regulations
PROVEN ELEVATION B.M. at Bridge = 817'

Company **CARNEGIE NATURAL GAS CO.**
 Address **Munhall, Penna.**
 Farm **B.F. Jones, Jr.**
 Tract **Acres 142** Lease No. **11061**
 Well (Farm) No. **One** Serial No. **1235**
 Elevation (Spirit Level) **861'**
 Quadrangle **Centerpoint**
 County **Doddridge** District **West Union**
 Engineer *W. H. ...*
 Engineer's Registration No. **1227**
 File No. **...** Drawing No. **...**
 Date **May 9, 1968** Scale **1" = 400' x 660'**

STATE OF WEST VIRGINIA
 DEPARTMENT OF MINES
 OIL AND GAS DIVISION
 CHARLESTON

WELL LOCATION MAP
FILE NO. DOD-1506-RED.

+ Denotes location of well on United States Topographic Maps, scale 1 to 62,500 latitude and longitude lines being represented by border lines as shown.

- Denotes one inch spaces on border line of original tracing

WW-4-A
Revised 6/07

FEB 25 2015

1) Date: 2-19-15
2) Operator's Well Number
WV 655176 (Jones #1235)
3) API Well No.: 47 017 - 01506
State County Permit

WV Department of
Environmental Protection
STATE OF WEST VIRGINIA - BUREAU OF ENVIRONMENT
DIVISION OF ENVIRONMENTAL PROTECTION, OFFICE OF OIL & GAS
NOTICE AND APPLICATION TO PLUG AND ABANDON WELL

4) Surface Owner(s) to be served:
(a) Name Jane Helen Jones Credit Trust
Address C/o Janet Elms
6138 S. Marion Ave.
Tulsa, OK 74136
(b) Name _____
Address _____
(c) Name _____
Address _____
6) Inspector Douglas Newlon
Address 4060 Dutchman Rd.
McFarlan, WV 26148
Telephone (304) 932-8049

5) (a) Coal Operator:
Name None
Address _____
(b) Coal Owner(s) with Declaration
Name Thomas A. Jones
332 NE 5th St.
Address Grand Prairie, TX 75050
Name Jane Helen Jones Credit Trust
Address C/o Janet Elms
6138 S. Marion Ave.
Tulsa, OK 74136
(c) Coal Lessee with Declaration
Name None
Address _____

TO THE PERSONS NAMED ABOVE:

You should have received this Form and the following documents:

- (1) The application to Plug and Abandon a Well on Form WW-4B, which sets out the parties involved in the work and describes the well its and the plugging work order; and
- (2) The plat (surveyor's map) showing the well location on Form WW-6.

The reason you received these documents is that you have rights regarding the application which are summarized in the instructions on the reverses side. However, you are not required to take any action at all.

Take notice that under Chapter 22-6 of the West Virginia Code, the undersigned well operator proposes to file or has filed this Notice and Application and accompanying documents for a permit to plug and abandon a well with the Chief of the Office of Oil and Gas, West Virginia Division of Environmental Protection, with respect to the well at the location described on the attached Application and depicted on the attached Form WW-6. Copies of this Notice, the Application, and the plat have been mailed by registered or certified mail or delivered by hand to the person(s) named above (or by publication in certain circumstances) on or before the day of mailing or delivery to the Chief.



OFFICIAL SEAL
STATE OF WEST VIRGINIA
NOTARY PUBLIC
Pamela Sykes
EQT Production
PO Box 280
Bridgeport, WV 26330
My Commission Expires Aug. 24, 2022

Well Operator:
By: Victoria J. Roark
Its: Permitting Supervisor
Address: PO Box 280
Bridgeport, WV 26330
Telephone: (304) 848-0076

Subscribed and sworn before me this 19 day of Feb, 2015
My Commission Expires: 8-24-22
Notary Public

The Office of Oil & Gas processes your personal information, such as name, address and phone number, as part of our regulatory duties. Your personal information may be disclosed to other State agencies or third parties in the normal course of business or as needed to comply with statutory or regulatory requirements, including Freedom of Information Act requests. Our office will appropriately secure your personal information. If you have any questions about our use of your personal information, please contact DEP's Chief Privacy Officer at depprivacyofficer@wv.gov.

neopost
02/19/2015
US POSTAGE



Jane Helen Jones Credit Trust
C/O Janet Elms
6138 S. Marion Ave.
Tulsa, OK 74136
655176 Pluggi

1701506P

RECEIVED
Office of Oil and Gas

FEB 25 2015

WV Department of
Environmental Protection

CERTIFIED MAIL™



7014 0510 0000 4438 9615
7014 0510 0000 4438 9615

U.S. Postal Service™
CERTIFIED MAIL™ RECEIPT
(Domestic Mail Only; No Insurance Coverage Provided)

For delivery information visit our website at www.usps.com

OFFICIAL USE

Postage	\$	Postmark Here
Certified Fee		
Return Receipt Fee (Endorsement Required)		
Restricted Delivery Fee (Endorsement Required)		
Total Postage & Fees	\$	

Sent To: **Jane Helen Jones Credit Trust**
C/O Janet Elms
6138 S. Marion Ave.
Tulsa, OK 74136

PS Form 380 655176 Plugging

SENDER: COMPLETE THIS SECTION

- Complete items 1, 2, and 3. Also complete item 4 if Restricted Delivery is desired.
- Print your name and address on the reverse so that we can return the card to you.
- Attach this card to the back of the mailpiece, or on the front if space permits.

1. Article Addressed to:

Jane Helen Jones Credit Trust
C/O Janet Elms
6138 S. Marion Ave.
Tulsa, OK 74136

655176 Plugging

COMPLETE THIS SECTION ON DELIVERY

A. Signature X Agent Addressee

B. Received by (Printed Name) C. Date of Delivery

D. Is delivery address different from item 1? Yes No
 If YES, enter delivery address below:

3. Service Type
 Certified Mail® Priority Mail Express™
 Registered Return Receipt for Merchandise
 Insured Mail Collect on Delivery

4. Restricted Delivery? (Extra Fee) Yes

2. Article Number 7014 0510 0000 4438 9615
(Transfer from service label)

04/17/2015

EQT
C/O Vicki Roark
P.O. Box 280
Bridgeport, WV 26330

SENDER: COMPLETE THIS SECTION

- Complete items 1, 2, and 3. Also complete item 4 if Restricted Delivery is desired.
- Print your name and address on the reverse so that we can return the card to you.
- Attach this card to the back of the mailpiece, or on the front if space permits.

1. Article Addressed to:

Thomas A. Jones
332 NE 5th St.
Grand Prairie, TX 75075
 655176 Plugging

2. Article Number

(Transfer from service label)

7014 0510

PS Form 3811, July 2013

Domestic R

COMPLETE THIS SECTION ON DELIVERY

A. Signature

X

- Agent
- Addressee

B. Received by (Printed Name)

C. Date of Delivery

D. Is delivery address different from item 1? Yes
 If YES, enter delivery address below: No

3. Service Type

- Certified Mail®
- Priority Mail Express™
- Registered
- Return Receipt for Merchandise
- Insured Mail
- Collect on Delivery

4. Restricted Delivery? (Extra Fee) Yes

PS Form 3800
 655176 Plugging

Thomas A. Jones
332 NE 5th St.
Grand Prairie, TX 75075

Sent To
 Street, Apt. No.
 or PO Box No.
 City, State, ZIP

Postage	\$
Certified Fee	
Return Receipt Fee	
Restricted Delivery Fee	
Total Postage & Fees	\$

Postmark Here

U.S. Postal Service™
CERTIFIED MAIL™ RECEIPT
 (Domestic Mail Only: No Insurance Coverage Provided)
 For delivery information visit our website at www.usps.com

OFFICIAL USE

7014 0510 0000 4438 9622
 7014 0510 0000 4438 9622



EQ1
 C/O Vicki Roark
 P.O. Box 280
 Bridgeport, WV 26330

CERTIFIED MAIL™

Thomas A. Jones
332 NE 5th St.
Grand Prairie, TX 75075
 655176 Plugging

WV Department of
 Environmental Protection
 FEB 25 2015

Office of Oil and Gas
 RECEIVED
 17015069

US POSTAGE
 02-19-2015
 04/17/2015

1701506P

RECEIVED
Office of Oil and Gas

FEB 25 2015

WV Department of
Environmental Protection

Douglas Newlon
4060 Dutchman Road
Macfarlan WV 26148

301612
20150225092

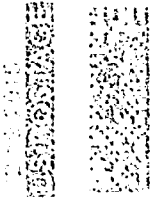

WW-9
Revised 2/03

Page _____ of _____
2) Operator's Well Number
WV 655176 (Jones #1235)
3) API Well No.: 47 017 - 01506

STATE OF WEST VIRGINIA
DEPARTMENT OF ENVIRONMENTAL PROTECTION, OFFICE OF OIL & GAS
CONSTRUCTION AND RECLAMATION PLAN AND SITE REGISTRATION APPLICATION FORM
GENERAL PERMIT FOR OIL AND GAS PIT WASTE DISCHARGE

Operator Name: EQT PRODUCTION COMPANY OP ID: _____
Watershed: Buckeye Run of Middle Island Creek of Ohio River Quadrangle: Smithburg
Elevation: 854 FT County: Doddridge District: West Union

Description of anticipated Pit Waste: Formation Fluids

Do you anticipate using more than 5,000 bbls of water to complete the proposed well work? Yes ___ No X
Will synthetic liner be used in the pit? Yes Is so, what ml.? 10 ml 20 ml.

Proposed Disposal Method for Treated Pit Wastes:

- Land Application
- Underground Injection - UIC Permit Number _____
- Reuse (at API Number) _____
- Offsite Disposal Permit #. _____
- Other: Explain _____

RK N
2-23-2015

Drilling medium anticipated for this well? Air, freshwater, oil based, etc.
If oil based, what type? Synthetic, petroleum, etc. _____

Additives to be used? _____

Will closed loop system be used? _____

Drill Cuttings disposal method? Leave in pit, landfill, remove offsite, etc. _____
If left in pit and plan to solidify what medium will be used? Cement, Lime, sawdust _____
Landfill or offsite name/permit number? _____

I certify that I understand and agree to the terms and conditions of the GENERAL WATER POLLUTION PERMIT issued on August 1, 2005, by the Office of Oil and Gas of the West Virginia Division of Environmental Protection. I understand that the provisions of the permit are enforceable by law. Violations of any terms or condition of the general permit and/or other applicable law or regulation can lead to enforcement action.

I certify under penalty of law that I have personally examined and am familiar with the information submitted on this application form and all attachments thereto and that, based on my inquiry of those individuals immediately responsible for obtaining the information, I believe that the information is true, accurate and complete. I am aware that there are significant penalties for submitting false information, including the possibility of fine or imprisonment.

Company Official Signature *Victoria Roark*

Company Official (Typed or Printed) Victoria Roark

Company Official Title Permitting Supervisor-WV

Subscribed and sworn before me this 19 day of Feb, 2015

My Commission Expires 8-24-20

Notary Public

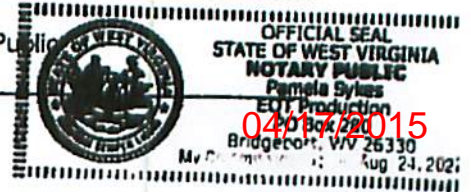

OPERATOR'S WELL NO.:
WV 655176 (Jones #1235)

LEGEND

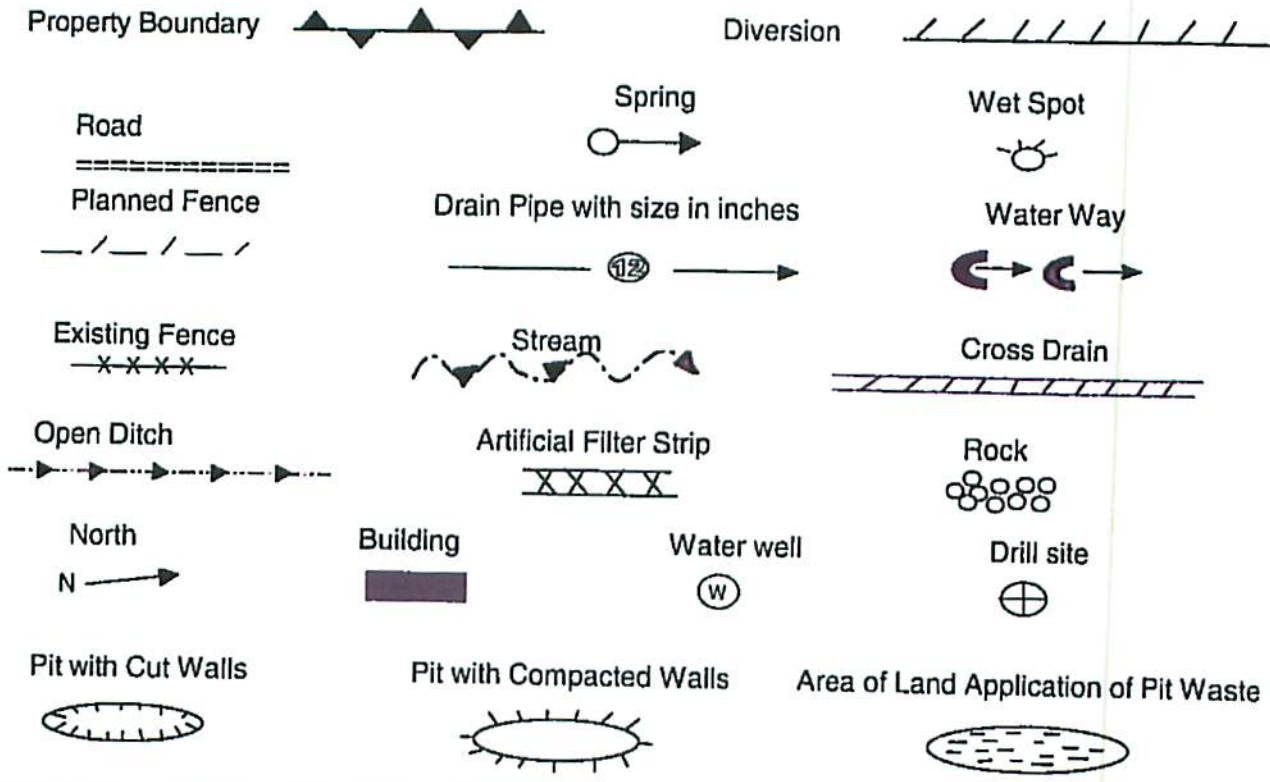

Proposed Revegetation Treatment: Acres Disturbed: 1± Prevegetation pH _____
 Lime 3 Tons/acre or to correct to pH 6.5
 Fertilizer (10-20-20) or equivalent 1/3 ton lbs/acre (500 lbs minimum)
 Mulch 2 Tons/acre or hydroseed.

SEED MIXTURES

Area I		Area II	
Seed Type	lbs/acre	Seed Type	lbs/acre
Red Fescue	40	Red Fescue	15
Alsike Clover	5	Alsike Clover	5
Annual Rye	15		

ATTACH:

Drawing(s) of road, location, pit and proposed area for land application.
 Photocopies section of involved 7.5' topographic sheet.

Plan approved by: Douglas Newlin

Comments: Install ETS to WV DEP regulations. Start Elevation Plog 50' below Elevation.

Title: Oil Pans Inspection Date: 2-27-2015
 Field Reviewed? Yes No

1701506P

Topo Quad: Smithburg 7.5' Scale: 1" = 2000'

County: Doddridge Date: February 12, 2015

District: West Union Project No: 67-30-00-08

47-017-01506 WV 655176 (Jones #1235)

Topo

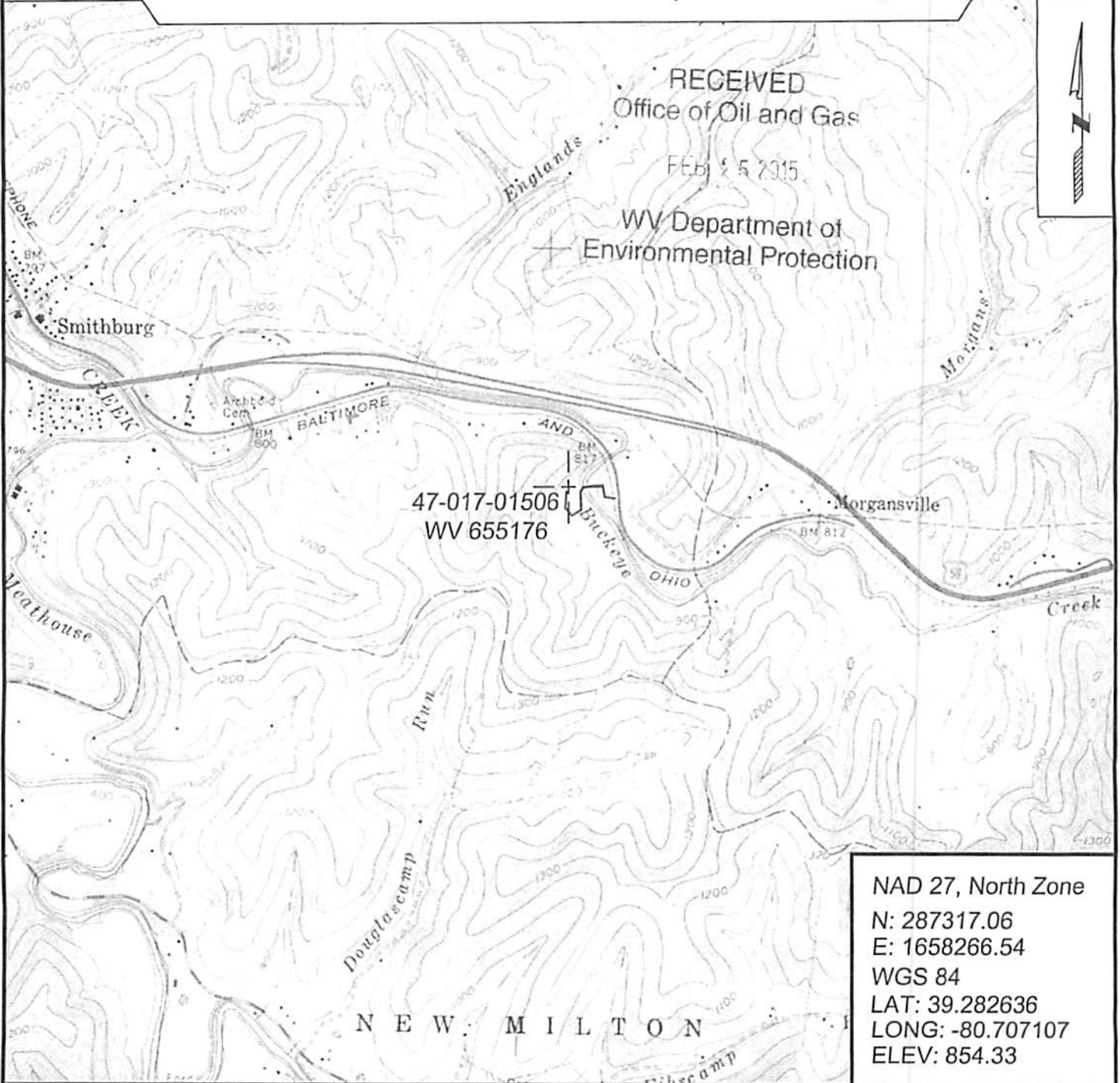

NAD 27, North Zone
 N: 287317.06
 E: 1658266.54
 WGS 84
 LAT: 39.282636
 LONG: -80.707107
 ELEV: 854.33



SURVEYING AND MAPPING SERVICES PERFORMED BY:

ALLEGHENY SURVEYS, INC.

1-800-482-8606
 237 Birch River Road
 Birch River, WV 26610
 PH: (304) 649-8606
 FAX: (304) 649-8608

PREPARED FOR:

EQT Production Company

P.O. Box 280
 Bridgeport, WV 26330

04/17/2015

1701506 P

RECEIVED
Office of Oil and Gas

FEB 25 2015

WV Department of
Environmental Protection

WW-7
8-30-06



West Virginia Department of Environmental Protection
Office of Oil and Gas
WELL LOCATION FORM: GPS

API: 47-017-01506 WELL NO.: WV 655176 (Jones #1235)
FARM NAME: B. F. Jones, Jr.
RESPONSIBLE PARTY NAME: EOT Production Company
COUNTY: Doddridge DISTRICT: West Union
QUADRANGLE: Smithburg 7.5'
SURFACE OWNER: Helen Jane Jones Credit Trust
ROYALTY OWNER: Thomas A. Jones, et al.
UTM GPS NORTHING: 4348183
UTM GPS EASTING: 525261 GPS ELEVATION: 260 m (854 ft)

The Responsible Party named above has chosen to submit GPS coordinates in lieu of preparing a new well location plat for a plugging permit or assigned API number on the above well. The Office of Oil and Gas will not accept GPS coordinates that do not meet the following requirements:

1. Datum: NAD 1983, Zone: 17 North, Coordinate Units: meters, Altitude: height above mean sea level (MSL) – meters.
2. Accuracy to Datum – 3.05 meters
3. Data Collection Method:
Survey grade GPS : Post Processed Differential
Real-Time Differential
Mapping Grade GPS X: Post Processed Differential X
Real-Time Differential

4. Letter size copy of the topography map showing the well location.

I the undersigned, hereby certify this data is correct to the best of my knowledge and belief and shows all the information required by law and the regulations issued and prescribed by the Office of Oil and Gas.

Signature

PS # 2180
Title

2/16/15
Date

04/17/2015



POTENTIAL WATER SAMPLE DATA SHEET

CLIENT: EQT PRODUCTION COMPANY
 LEASE NAME AND WELL No. Jones #1235 - WV 655176 - API No. 47-017-01506

POTENTIAL SAMPLE LOCATIONS

Site: 1 Spacing: 615 +/- Owner: Helen Jane Jones Credit Trust c/o Janet Elms
 Address: 6138 S. Marion Ave., Tulsa, OK 74136 Phone no. _____
 Comments: Camp

Site: 2 Spacing: 960 +/- Owner: Joseph W. Jordan
 Address: Route 2 Box 96, West Union, WV 26456 Phone no. _____
 Comments: Abandoned House

Site: 3 Spacing: 910 +/- Owner: Helen Jane Jones Credit Trust c/o Janet Elms
 Address: 6138 S. Marion Ave., Tulsa, OK 74136 Phone no. _____
 Comments: Abandoned House

RECEIVED
Office of Oil and Gas

FEB 25 2015

WV Department of
Environmental Protection

BIRCH RIVER OFFICE
237 Birch River Road
Birch River, WV 26610
phone: 304-649-8606
fax: 304-649-8608

BRIDGEPORT OFFICE
172 Thompson Drive
Bridgeport, WV 26330
phone: 304-848-5035
fax: 304-848-5037

CALDWELL OFFICE
212 Cumberland Street
Caldwell, OH 43724
phone: 740-305-5007
fax: 740-305-5126

ALUM CREEK OFFICE
P.O. Box 108 • 1413 Childress Rd
Alum Creek, WV 25003
phone: 304-756-2949
fax: 304-756-2948

RANSON OFFICE
401 South Fairfax Blvd, Suite 3
Ranson, WV 25438
phone: 304-724-5008
fax: 304-724-5010

Topo Quad: Smithburg 7.5' Scale: 1" = 2000'

County: Doddridge Date: February 12, 2015

District: West Union Project No: 67-30-00-08

Water

47-017-01506 WV 655176 (Jones #1235)

3 Potential Water Sources within 1000'

RECEIVED
Office of Oil and Gas

FEB 25 2015

WV Department of
Environmental Protection

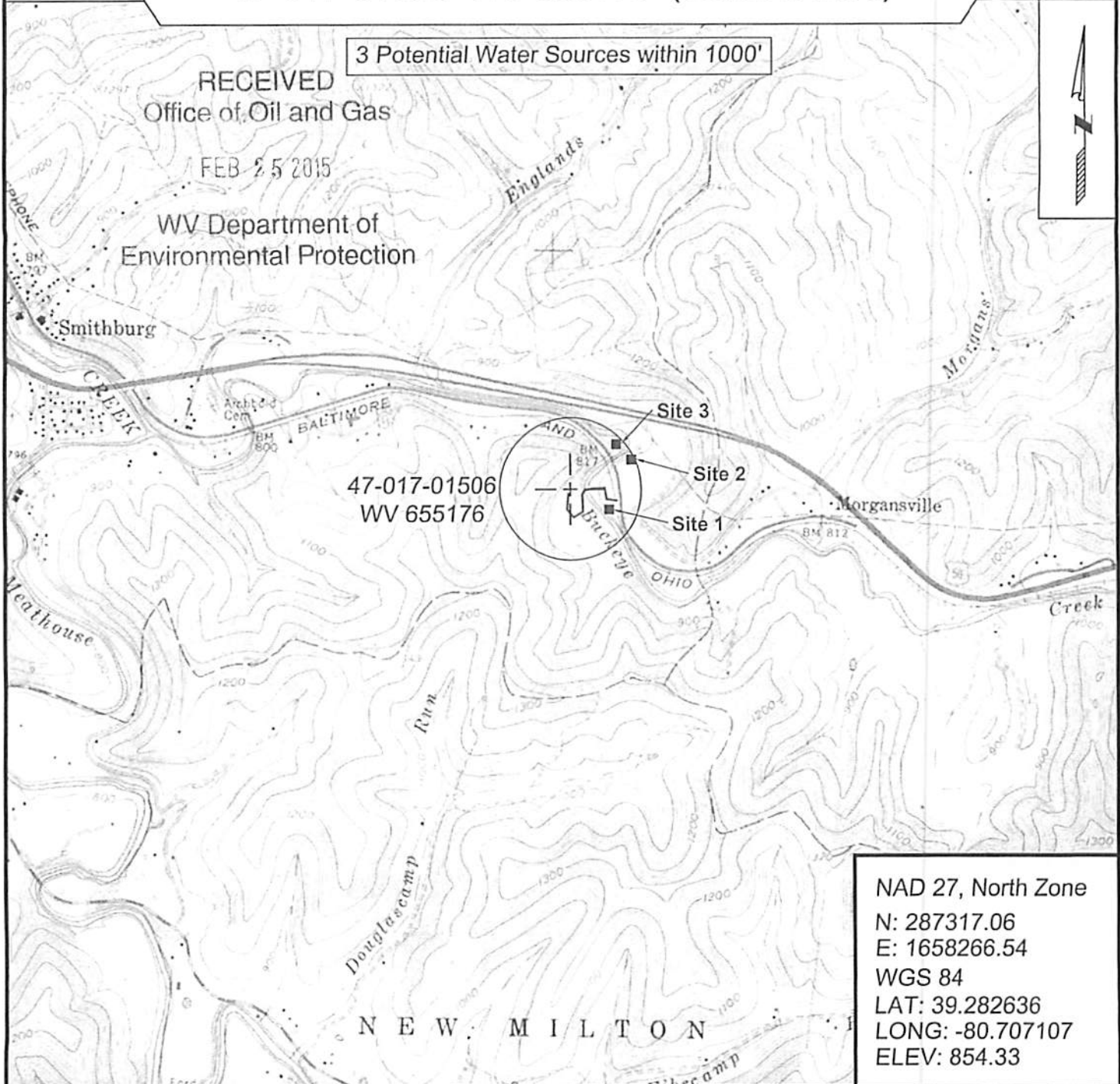

NAD 27, North Zone
 N: 287317.06
 E: 1658266.54
 WGS 84
 LAT: 39.282636
 LONG: -80.707107
 ELEV: 854.33



SURVEYING AND MAPPING SERVICES PERFORMED BY:
ALLEGHENY SURVEYS, INC.

1-800-482-8606
 237 Birch River Road
 Birch River, WV 26610
 PH: (304) 649-8606
 FAX: (304) 649-8608

PREPARED FOR:

EQT Production Company

P.O. Box 280
 Bridgeport, WV 26330