

- Fracture....
- Redrill.....
- New Location.
- Drill Deeper.....
- Abandonment.....

Source of Elevation AB'D. WELL 4634, ELV. 1150'

I, the undersigned, hereby certify that this map is correct to the best of my knowledge and belief and shows all the information required by paragraph 6 of the rules and regulations of the oil and gas section of the mining laws of West Virginia.

Minimum accuracy, one part in 200

Issued 4/22/74

Company	WILLARD E. FERRELL	
Address	PHILADELPHIA, PA. Box 5056	
Farm	C. J. SPURGEON	
Tract	Acres 142	Lease No.
Well (Farm) No.	3	Serial No. 2
Elevation (Spirit Level)	1143'	EC
Quadrangle	HOLBROOK	2° 6' 33" X
County	DODDRIDGE	District SOUTHWEST
Engineer	<i>Carroll D. ...</i>	
Engineer's Registration No.	1084	
File No.	215/26	Drawing No.
Date	10-3-68	Scale 1" = 500'

STATE OF WEST VIRGINIA
DEPARTMENT OF MINES
OIL AND GAS DIVISION
CHARLESTON

WELL LOCATION MAP
FILE NO. Dod-1535-P

+ Denotes location of well on United States Topographic Maps, scale 1 to 62,500, latitude and longitude lines being represented by border lines as shown.

- Denotes one inch spaces on border line of original tracing.

47-017

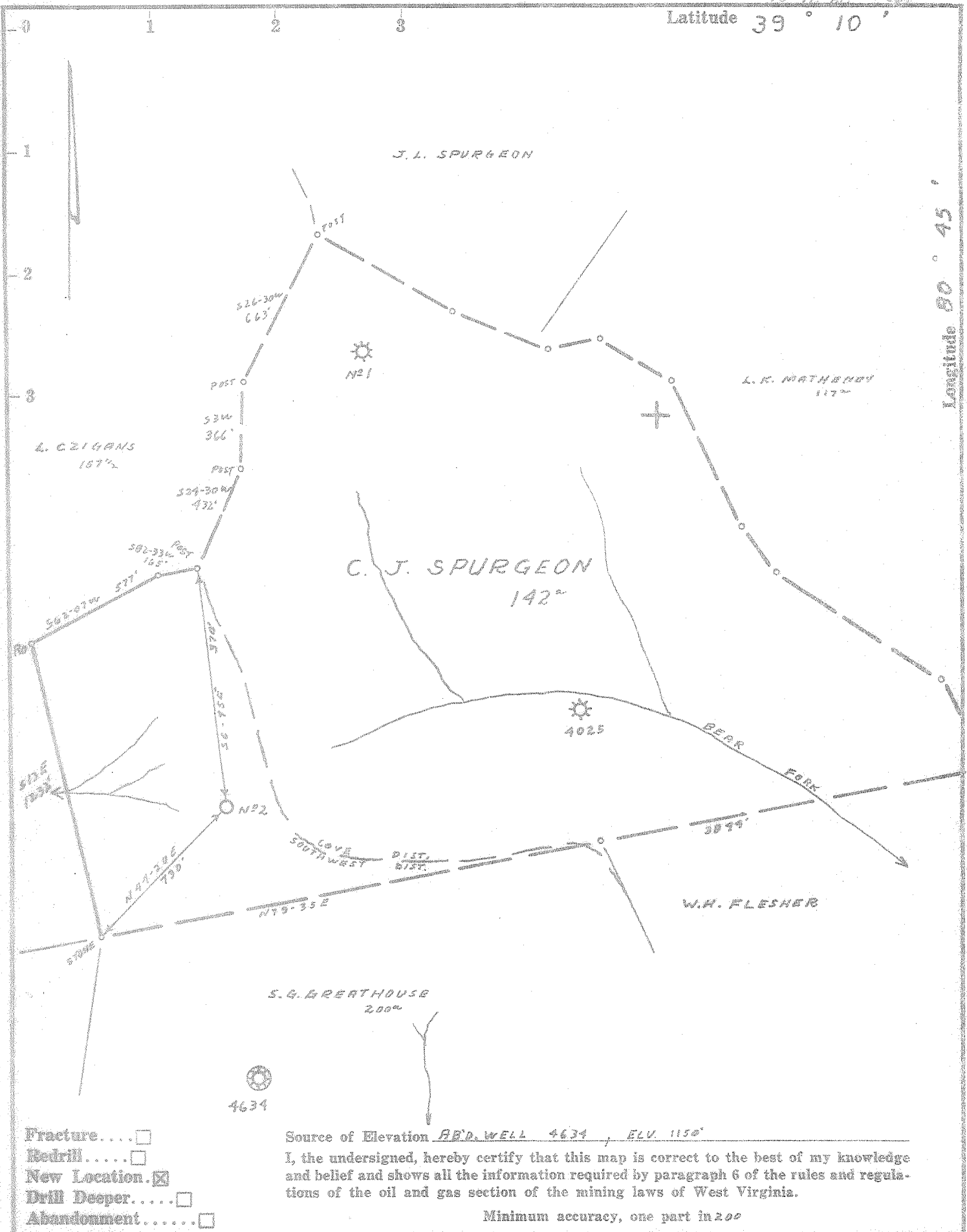

- Fracture.....
- Bedrill.....
- New Location.
- Drill Deeper.....
- Abandonment.....

Source of Elevation AB'D. WELL 4634, ELV. 1150'

I, the undersigned, hereby certify that this map is correct to the best of my knowledge and belief and shows all the information required by paragraph 6 of the rules and regulations of the oil and gas section of the mining laws of West Virginia.

Minimum accuracy, one part in 200

Company	WILLARD E. FERRELL		
Address	PHILADELPHIA, PA. Box 5056		
Farm	C. J. SPURGEON		
Tract	Acres	Lease No.	
Well (Farm) No.	3	Serial No.	2
Elevation (Spirit Level)	1143'		
Quadrangle	HOLBROOK SE2' EC		
County	DODDRIDGE	District	SOUTHWEST
Engineer	<i>Conrad Duffin</i>		
Engineer's Registration No.	1084		
File No.	215/26	Drawing No.	
Date	10-3-68	Scale	1" = 500'

STATE OF WEST VIRGINIA
 DEPARTMENT OF MINES
 OIL AND GAS DIVISION
 CHARLESTON

WELL LOCATION MAP
 FILE NO. Dod-1535

+ Denotes location of well on United States Topographic Maps, scale 1 to 62,500, latitude and longitude lines being represented by border lines as shown.

— Denotes one inch spaces on border line of original tracing.



STATE OF WEST VIRGINIA
DEPARTMENT OF MINES
OIL AND GAS DIVISION

Rotary
Spudder
Cable Tools
Storage

1
2
T

Quadrangle _____

Permit No. DOD 1535

WELL RECORD

Oil or Gas Well Gas
(KIND)

Company <u>Tortuga Development Co. Willard E. Ferrell</u>	Casing and Tubing	Used in Drilling	Left in Well	Packers
Address <u>P.O. Box 5056, Philadelphia, Pa. 19111 Agent</u>	Size			
Farm <u>C. J. Spurgeon</u> Acres <u>142</u>	16. _____	20	20	Kind of Packer _____
Location (waters) _____	13. _____			Size of _____
Well No. <u>Farm # 3 - Serial # 2</u> Elev. <u>1143</u>	10. _____	209	209	Depth set _____
District <u>Cove</u> County <u>Doddridge</u>	8 1/4 _____	792		
The surface of tract is owned in fee by <u>Rose Spurgeon</u>	6 3/4 <u>7</u>	1217		
Address <u>Burnt House, W. Va.</u>	5 3/16 _____			
Mineral rights are owned by <u>Howard C. Grey</u>	4 1/2 _____	7477	2672	
Address <u>Fairmount, W. Va.</u>	3 <u>4 1/2</u>	2152	2152	Perf. top _____
RFD _____	2 _____			Perf. bottom _____
Drilling commenced <u>Oct. 29, 1968</u>	Liners Used _____			Perf. top _____
Drilling completed <u>Dec. 3, 1968</u>				Perf. bottom _____
Date Shot _____ From _____ To _____				
With _____				

Open Flow 5/10ths Water in _____ Inch
 _____/10ths Merc. in _____ Inch
 Volume 30M Cu. Ft.
 Rock Pressure Not taken lbs. _____ hrs.
 Oil Show bbls., 1st 24 hrs.
 WELL ACIDIZED (DETAILS) _____
 WELL FRACTURED (DETAILS) Well was fractured Dec. 13, 1968- using 750 bls. of fluid, 500 gal acid, 40M sand.

RESULT AFTER TREATMENT (Initial open Flow or bbls.) 250M Gas Show of oil Y50,000
 ROCK PRESSURE AFTER TREATMENT 400 HOURS 12
 Fresh Water Surface only Feet _____ Salt Water _____ Feet _____
 Producing Sand Big Injun ~~Wagon~~ Dry in Gordon. Depth 2068 --- ~~7477~~ #

Formation	Color	Hard or Soft	Top	Bottom	Oil, Gas or Water	Depth	Remarks
Clay			0	10			
Red Rock			10	50			
Slate			50	113			
Sand			113	137			
Slate			137	146			
Red Rock			146	280			
Sand			280	300			
Red Rock			300	320			
Slate & Shells			320	340			
Red Rock			340	390			
Slate			390	405			
Red Rock			405	445			
Slate & Shells			445	525			
Red Rock			525	535			
Slate			535	545			
Red Rock			545	570			
Slate & Shells			570	726			
Red Rock			726	890			
Slate & Shells			890	980			
Red Rock			980	1000			
Lime			1000	1030			
Slate & Shells			1030	1090			
Sand			1090	1125			
Slate			1125	1130			
Sand			1130	1153			
Slate			1153	1217			
Lime			1217	1340			
Slate			1340	1365			
Sand			1365	1440			

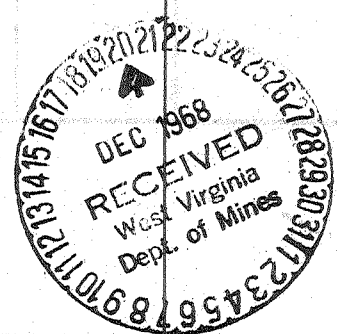

Formation	Color	Hard or Soft	Top /	Bottom	Oil, Gas or Water	Depth Found	Remarks
Lime Gritty			1440	1470			
Sand			1470	1512			
Lime			1512	1531			
Slate			1531	1595			
Lime Gritty			1595	1617			
Slate			1617	1715			
Sand			1715	1730			
Slate & Shells Blk.			1730	1835			
Sand			1835	1856			
Slate			1856	1910			
Lime Gritty			1910	1948			
Slate			1948	1958			
Lime Dark			1958	2003			
Lime Grey Bg.			2003	2068			
Sand			2068	2111			
Lime Gritty Injun			2111	2151			
Slate			2151	2190			
Lime Gritty			2190	2267			
Wier			2267	2380			
Slate & Shells			2380	2680			
Garden Garden			2680	2688			
Slate			2688				
Total Depth				2720			

Dry in the Gordon sand filled back to the Big Injun - 2152

Date Dec. 17, 1968

APPROVED Harold E. Fencil, Owner

By _____ (Title)