

11-6-68-DODD

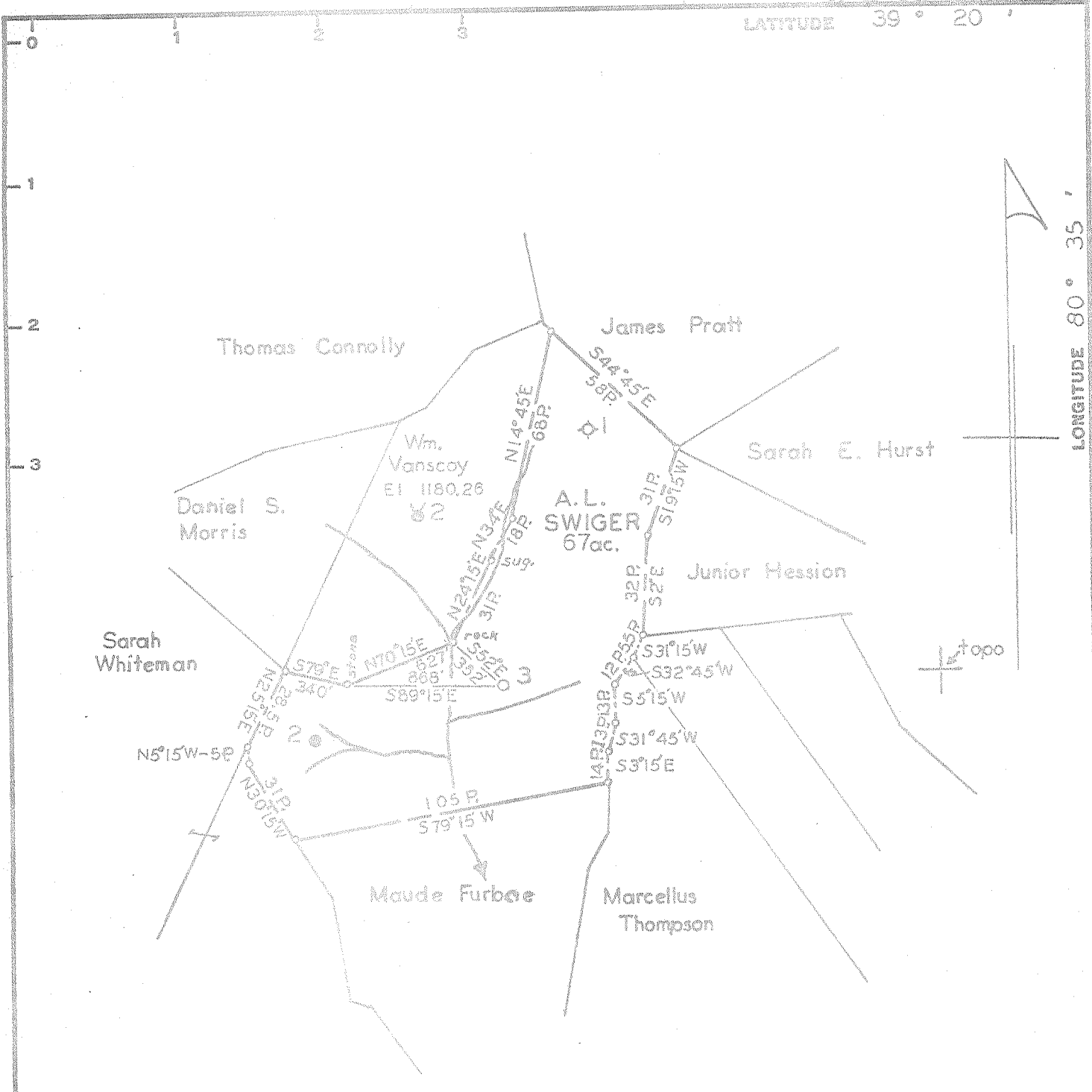

Coal Not Operated

Minimum Error of Closure 1' in 200'

Source of Elevation Wm. Vanscoy No. 2-abd, Elev 1180.26

I, the undersigned, hereby certify that this map is correct to the best of my knowledge and belief and shows all the information required by paragraph 6 of the rules and regulations of the oil and gas section of the mining laws of West Virginia.

Fracture

New Location

Drill Deeper

Abandonment

issued 3-7-69

Signed: A. G. Hillbert

Map No. N28 Square: N 513 E 1 W

Company PENNZOIL UNITED, INC.

Address Box 1588, Parkersburg, W. Va.

Farm A. L. SWIGER

Tract Acres 67 Lease No. 14639-00

Well (Farm) No. 3 Serial No.

Elevation (Spirit Level) 1123.81

Quadrangle Centerpoint SC

County Doddridge District Greenbrier

Engineer A. G. Hillbert

Engineer's Registration No. 2534

File No. 1480 Drawing No.

Date Nov. 4, 1968 Scale 1" = 800'

STATE OF WEST VIRGINIA
DEPARTMENT OF MINES
OIL AND GAS DIVISION
CHARLESTON

WELL LOCATION MAP

FILE NO. Dod-1539-p

* Denotes location of well on United States Topographic Maps, scale 1 to 62,500, latitude and longitude lines being represented by border lines as shown.

-- Denotes one inch spaces on border line of original tracing.

caj

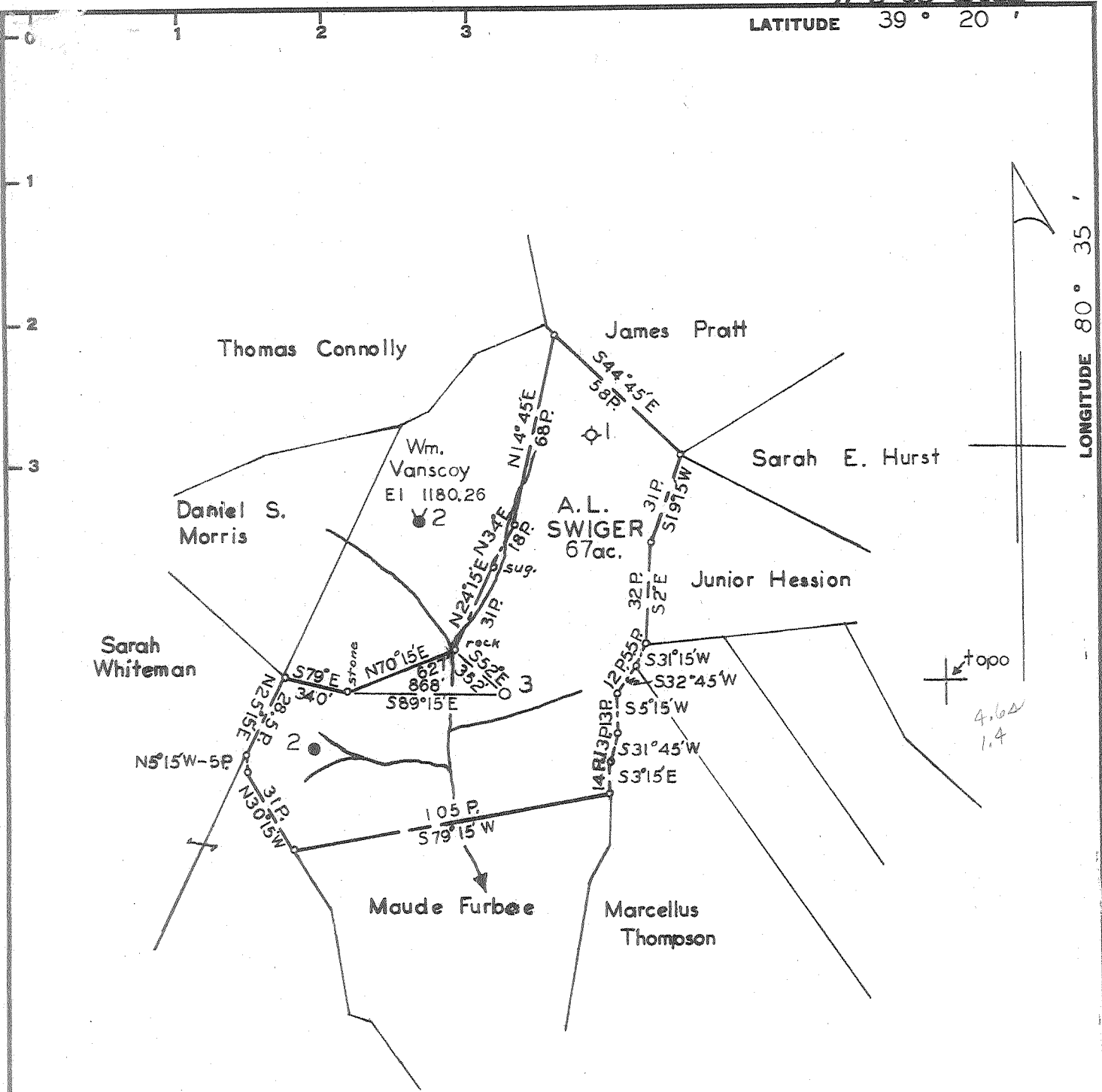

Coal Not Operated

Minimum Error of Closure 1' in 200'

Source of Elevation Wm. Vanscoy, No. 2-abd, Elev 1180.26

- Fracture.....
- New Location.....
- Drill Deeper.....
- Abandonment.....

I, the undersigned, hereby certify that this map is correct to the best of my knowledge and belief and shows all the information required by paragraph 6 of the rules and regulations of the oil and gas section of the mining laws of West Virginia.

Signed: A.C. Hilbert

Map No. N28 Squares: N S 13 E 1 W

Company	PENNZOIL UNITED, INC.		
Address	Box 1588, Parkersburg, W.Va.		
Farm	A.L. SWIGER		
Tract	Acres	Lease No.	67 14639-00
Well (Farm) No.	3	Serial No.	
Elevation (Spirit Level)	1123.81		
Quadrangle	Centerpoint	50	
County	Doddridge	District	Greenbrier
Engineer	<u>A.C. Hilbert</u>		
Engineer's Registration No.	2534		
File No.	1480	Drawing No.	
Date	Nov. 4, 1968	Scale	1" = 800'

STATE OF WEST VIRGINIA
DEPARTMENT OF MINES
OIL AND GAS DIVISION
CHARLESTON

WELL LOCATION MAP

FILE NO. Dod-1539

† Denotes location of well on United States Topographic Maps, scale 1 to 62,500, latitude and longitude lines being represented by border lines as shown.

— Denotes one inch spaces on border line of original tracing.

cal



STATE OF WEST VIRGINIA
DEPARTMENT OF MINES
OIL AND GAS DIVISION 3

- Rotary
- Spudder
- Cable Tools
- Storage

Quadrangle CENTERPOINT

Permit No. DOD-1539

WELL RECORD

Oil or Gas Well DRY
(KIND)

Company PENNZOIL UNITED, INC.
Address P.O. Box 1588, Parkersburg, West Va.
Farm A. L. Swiger Acres 67
Location (waters) _____
Well No. 3 Elev. 1123.81
District Greenbrier County Doddridge
The surface of tract is owned in fee by Clarence Rogers
710 Prunty Building
Address Clarksburg, West Va.
Mineral rights are owned by Ora E. Swiger, Agt.
Route 7
Address Zanesville, Ohio
Drilling commenced December 13, 1968
Drilling completed March 1, 1969
Date Shot _____ From _____ To _____
With _____

Casing and Tubing	Used in Drilling	Left in Well	Packers
Size			Kind of Packer
16			
13			Size of
10	377.00	377.00	
8 5/8"	1439.00	1439.00	Depth set
6 5/8"	2220.00	2220.00	
5 3/16			Perf. top
4 1/2			Perf. bottom
3			Perf. top
2			Perf. bottom
Liners Used			

Open Flow /10ths Water in _____ Inch
/10ths Merc. in _____ Inch
Volume _____ Cu. Ft.
Rock Pressure _____ lbs. _____ hrs.
Oil _____ bbls., 1st 24 hrs.

Attach copy of cementing record. *Note: 8-5/8" casing cemen
50' above coal
CASING CEMENTED 8-5/8" SIZE No. Ft. _____ Date _____
Amount of cement used (bags) _____
Name of Service Co. _____
COAL WAS ENCOUNTERED AT _____ FEET _____ INCHES
_____ FEET _____ INCHES FEET _____ INCHES
_____ FEET _____ INCHES FEET _____ INCHES

WELL ACIDIZED (DETAILS) _____

WELL FRACTURED (DETAILS) _____

RESULT AFTER TREATMENT (Initial open Flow or bbls.) _____ Dry Hole
ROCK PRESSURE AFTER TREATMENT _____ HOURS
Fresh Water _____ Feet _____ Salt Water _____ Feet _____
Producing Sand _____ Depth _____

Formation	Color	Hard or Soft	Top	Bottom	Oil, Gas or Water	Depth	Remarks
Red Rock			0	15			
Sand			15	30			
Red Rock			30	40			
Slate & Lime			40	70			
Red Rock			70	90			
Slate & Lime			90	107			
R. Rock & Lime			107	115			
Slate & Lime			115	120			
Sand			120	150	Water	150'	4 bailers/hr.
Red Rock			150	164			
Sand			164	194			
Slate & Lime			194	200			
Red Rock			200	232			
Slate & Lime			232	246			
Red Rock			246	285			
Slate & Lime			285	310			
Red Rock			310	315			
Slate Gritty Lime			315	330			
Sand			330	341			
Black Slate & Lime			341	355			
Slate & Lime			355	370			
Gritty Lime			370	400			
Sand			400	420			
Slate & Lime			420	456			
R. Rock & Lime			456	499			
Sand			499	523			
R. Rock & Lime			523	541			
Gritty Lime			541	553			
Red Rock & Lime			553	580			
Slate & Lime			580	595			



MAR 16 1969

017-1539

Formation	Color	Hard or Soft	Top 3	Bottom	Oil, Gas or Water	Depth Found	Remarks
Britty Lime			595	607			
Black Slate			607	618			
Lime, Hard			618	635			
Red Rock			635	645			
Lime & Slate			645	655			
Red Rock			655	675			
Slate & Lime			675	690			
Britty Lime			690	705			
Lime, Hard			705	740			
Britty Lime & Slate			740	760			
Sand			760	775			
Britty Lime			775	790			
Slate & Lime			790	900			
Pittsburgh Coal ?			900	905			
Slate			905	940			
Britty Lime			940	955			
Slate & Lime			955	968			
Sand, Hard			968	1000			
Slate & Lime			1000	1017			
Red Rock			1017	1030			
Slate, Lime & R. Rock			1030	1166			
Lime			1166	1195			
Black Slate			1195	1219			
Red Rock			1219	1241			
Slate & Lime			1241	1250			
Britty Lime			1250	1274			
Slate & Lime			1274	1345			
Britty Lime			1345	1365			
Black Slate			1365	1400			
Lime & Slate			1400	1412			
Big Dunkard			1412	1450			
Lime & Slate			1450	1530			
Black Slate			1530	1548			
Britty Lime & Slate			1548	1570			
Slate			1570	1590			
Sand			1590	1620			
Lime & Slate			1620	1641			
Black Slate			1641	1668			
Sand, Hard			1668	1695	Water	1685'	Show
Black Lime			1695	1740			
Britty, Black, Lime			1740	1775			
Britty Lime			1775	1800			
Sand			1800	1828			
Black Slate & Lime			1828	1849			
Britty Lime			1849	1890			
Sand			1890	1925			
Sand, Slate & Lime			1925	1950			
Sand			1950	1985			
Slate			1985	2000			
Sand, & Black Lime			2000	2025			
Slate			2025	2040			
Britty Lime			2040	2063			
Sand			2063	2090			
Black Lime, & Slate			2090	2132			
Britty Lime			2132	2164			
Little Lime			2164	2180			
Slate			2180	2202			
Lime			2202	2207			
Slate			2207	2213			
Big Lime			2213	2260			
Big Injun			2260	2375			
Slate			2375	2402			
Total Depth				2402			

Date March 4, 1962

APPROVED PENNZOIL UNITED, INC., Owner

By A. C. Hilbert
A. C. Hilbert (Title) Engineer