

5/12/71 CEN

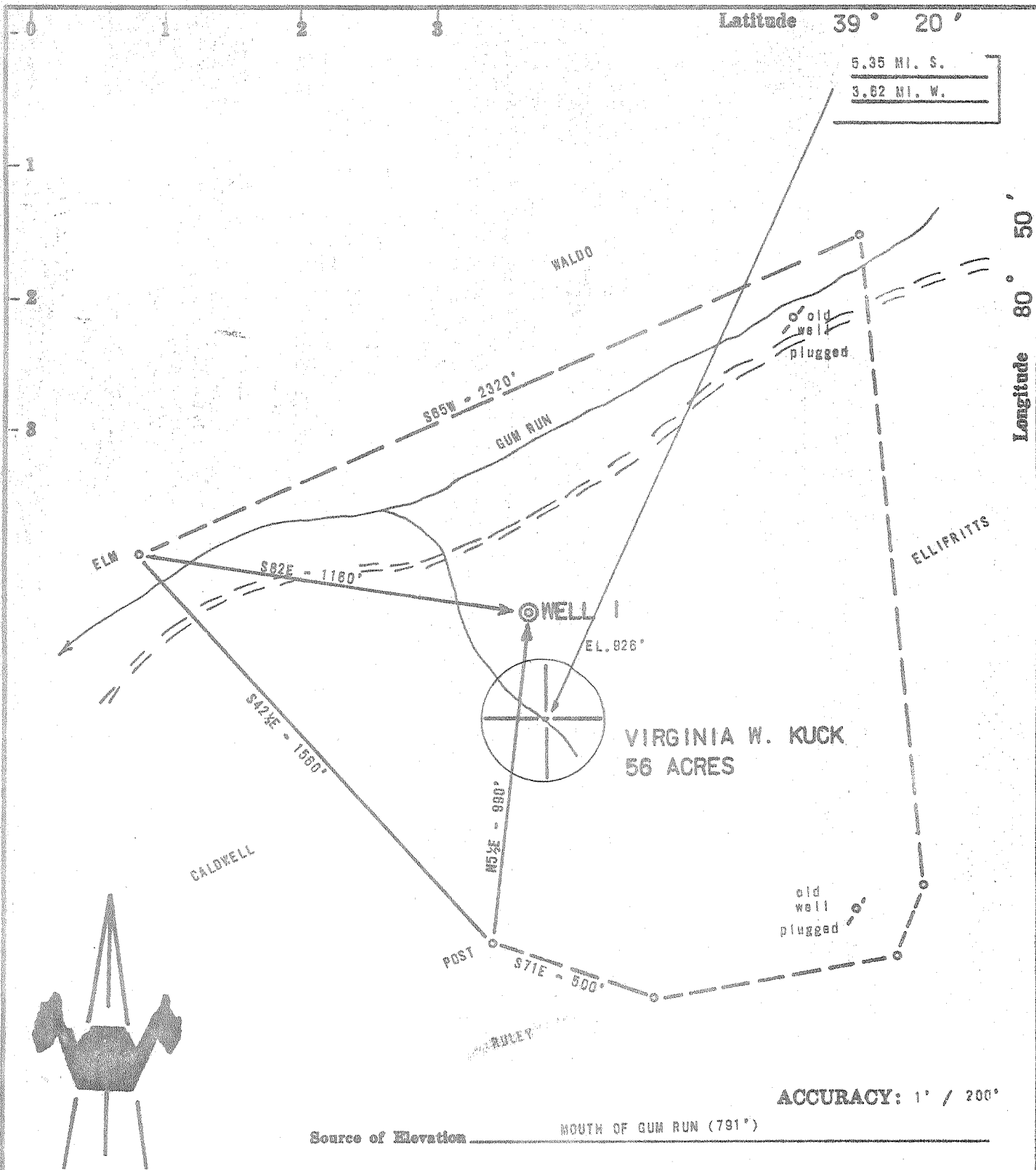

- New Location
- Drill Deeper
- Abandonment
- Fracture
- Redrill

Plugging
7/12/71

I, the undersigned, hereby certify that this map is correct to the best of my knowledge and belief and shows all the information required by paragraph 6 of the rules and regulations of the oil and gas section of the mining laws of West Virginia.

Chet Waterman

| | |
|-----------------------------|----------------------------|
| Company | W. LESLIE ROGERS |
| Address | PENNSAUKEN, N. J. |
| Farm | VIRGINIA W. KUCK |
| Tract | Acres 56 Lease No. |
| Well (Farm) No. | 1 Serial No. |
| Elevation (Spirit Level) | 926' |
| Quadrangle | WEST UNION SC |
| County | DODDRIDGE District CENTRAL |
| Engineer | CHET WATERMAN |
| Engineer's Registration No. | 3788 |
| File No. | 71003-157 Drawing No. |
| Date | 5/8/71 Scale 1" = 400' |

STATE OF WEST VIRGINIA
DEPARTMENT OF MINES
OIL AND GAS DIVISION
CHARLESTON

WELL LOCATION MAP
FILE NO. DODD-1620-P

+ Denotes location of well on United States Topographic Maps, scale 1 to 62,500, latitude and longitude lines being represented by border lines as shown.

— Denotes one inch spaces on border line of original tracing.

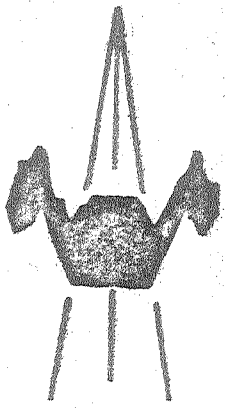
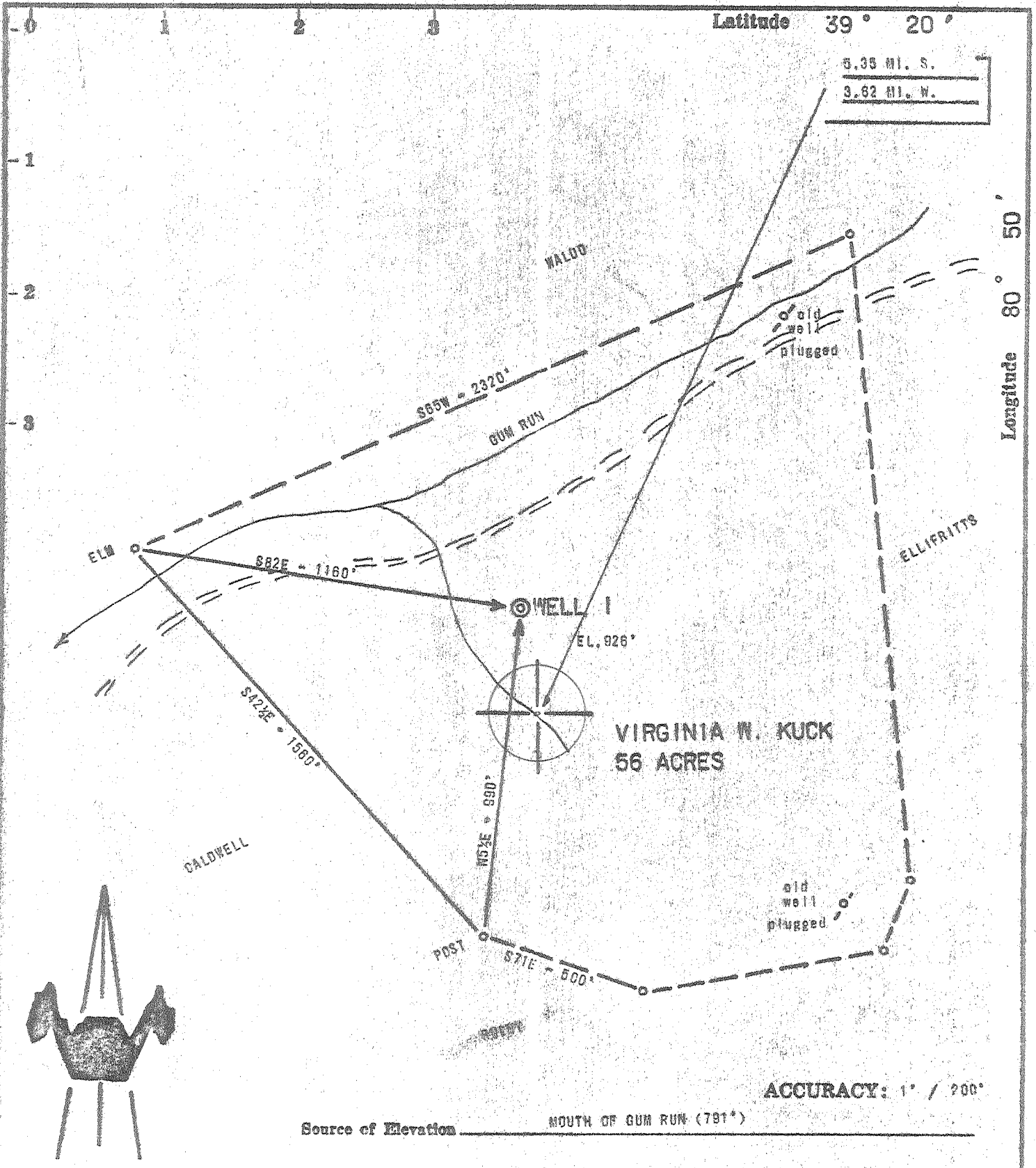

- New Location
- Drill Deeper
- Abandonment
- Fracture
- Redrill

I, the undersigned, hereby certify that this map is correct to the best of my knowledge and belief and shows all the information required by paragraph 6 of the rules and regulations of the oil and gas section of the mining laws of West Virginia.

Chet Waterman

| | | | |
|-----------------------------|-------------------|-------------|-----------|
| Company | W. LESLIE ROGERS | | |
| Address | PENNSAUKEN, N. J. | | |
| Farm | VIRGINIA W. KUCK | | |
| Tract | Acres | 56 | Lease No. |
| Well (Farm) No. | 1 | Serial No. | |
| Elevation (Spirit Level) | 926' | | |
| Quadrangle | WEST UNION 50 | | |
| County | DODDRIDGE | District | CENTRAL |
| Engineer | CHET WATERMAN | | |
| Engineer's Registration No. | 8788 | | |
| File No. | 71003-157 | Drawing No. | |
| Date | 5/8/71 | Scale | 1" = 400' |

STATE OF WEST VIRGINIA
DEPARTMENT OF MINES
OIL AND GAS DIVISION
CHARLESTON

WELL LOCATION MAP
FILE NO. DODD-1620

+ Denotes location of well on United States Topographic Maps, scale 1 to 62,500, latitude and longitude lines being represented by border lines as shown.

-- Denotes one inch spaces on border line of original tracing.



RECEIVED

JUL 12 1971

STATE OF WEST VIRGINIA
OIL & GAS DIVISION
DEPARTMENT OF MINES & MINERAL RESOURCES
OIL AND GAS WELLS DIVISION

- Rotary
- Spudder
- Cable Tools
- Storage

Quadrangle WEST UNION

Permit No. DOD-1620

WELL RECORD

Oil or Gas Well DRY
(KIND)

Company W. LESLIE ROGERS
Address PENNSAUKEN, N. J.
Farm VIRGINIA W. KUCK Acres 56
Location (waters) GUM RUN
Well No. 1 Elev. 926'
District CENTRAL County DODDRIDGE
The surface of tract is owned in fee by V. W. KUCK
Address COLUMBUS, OHIO
Mineral rights are owned by SAME
Address _____
Drilling commenced 6/7/71
Drilling completed 7/9/71
Date Shot _____ From _____ To _____
With _____
Open Flow _____ /10ths Water in _____ Inch
_____ /10ths Merc. in _____ Inch
Volume _____ Cu. Ft.
Rock Pressure _____ lbs. _____ hrs.
Oil _____ bbls., 1st 24 hrs.

| Casing and Tubing | Used in Drilling | Left in Well | Packers |
|-------------------|------------------|--------------|----------------|
| Size | | | Kind of Packer |
| 16 | | | |
| 13 | | | Size of |
| 10 | 320' | 320' | Depth set |
| 8 1/4 | 1118' | | |
| 6 3/4 | 1838' | | |
| 5 3/16 | | | |
| 4 1/2 | | | |
| 3 | | | Perf. top |
| 2 | | | Perf. bottom |
| Liners Used | | | Perf. top |
| | | | Perf. bottom |

WELL ACIDIZED (DETAILS) _____
WELL FRACTURED (DETAILS) _____

Attach copy of cementing record.
CASING CEMENTED 10" SIZE 320' No. Ft. 6/16/71 Date
Amount of cement used (bags) 65
Name of Service Co. LAWSON
COAL WAS ENCOUNTERED AT NONE FEET _____ INCHES
_____ FEET _____ INCHES _____ FEET _____ INCHES
_____ FEET _____ INCHES _____ FEET _____ INCHES

RESULT AFTER TREATMENT (Initial open Flow or bbls.) _____
ROCK PRESSURE AFTER TREATMENT _____ HOURS _____
Fresh Water 100' Feet _____ Salt Water 1395' Feet _____
Producing Sand _____ Depth _____

| Formation | Color | Hard or Soft | Top | Bottom | Oil, Gas or Water | Depth | Remarks |
|-------------|-------|--------------|------|--------|-------------------|-------|---------|
| SOIL | | | 0 | 4 | | | |
| SAND | | | 4 | 35 | | | |
| shale | | | 35 | 135 | water | 100' | |
| sand | | | 135 | 162 | | | |
| shale | | | 162 | 292 | | | |
| sand | | | 292 | 317 | | | |
| shale | | | 317 | 350 | | | |
| sand | | | 350 | 460 | | | |
| shale | | | 460 | 1086 | | | |
| sand | | | 1086 | 1118 | | | |
| shale | | | 1118 | 1388 | | | |
| sand | | | 1388 | 1443 | water | 1395 | |
| shale | | | 1443 | 1455 | | | |
| sand | | | 1455 | 1475 | | | |
| shale | | | 1475 | 1575 | | | |
| sand | | | 1575 | 1625 | | | |
| shale | | | 1625 | 1705 | | | |
| sand | | | 1705 | 1752 | smell gas | 1717 | |
| shale | | | 1752 | 1780 | | | |
| lime & sand | | | 1780 | 1802 | | | |
| Big Lime | | | 1802 | 1886 | | | |
| shale | | | 1886 | 1890 | | | |
| sandy lime | | | 1890 | 1924 | smell gas | 1906 | |
| shale | | | 1924 | 1926 | | | |
| sand | | | 1926 | 1932 | | | |
| shale | | | 1932 | 1934 | | | |
| sand | | | 1934 | 1947 | | | |
| shale | | | 1947 | 1950 | | | |
| sand | | | 1950 | 1966 | | | |
| shale | | | 1966 | 2036 | | | |
| TOTAL DEPTH | | | | 2036 | | | |

(over)

JUL 16 1971