

Latitude 39° 25'

Longitude 80° 35'

3.05 MI. S.
4.05 MI. W.

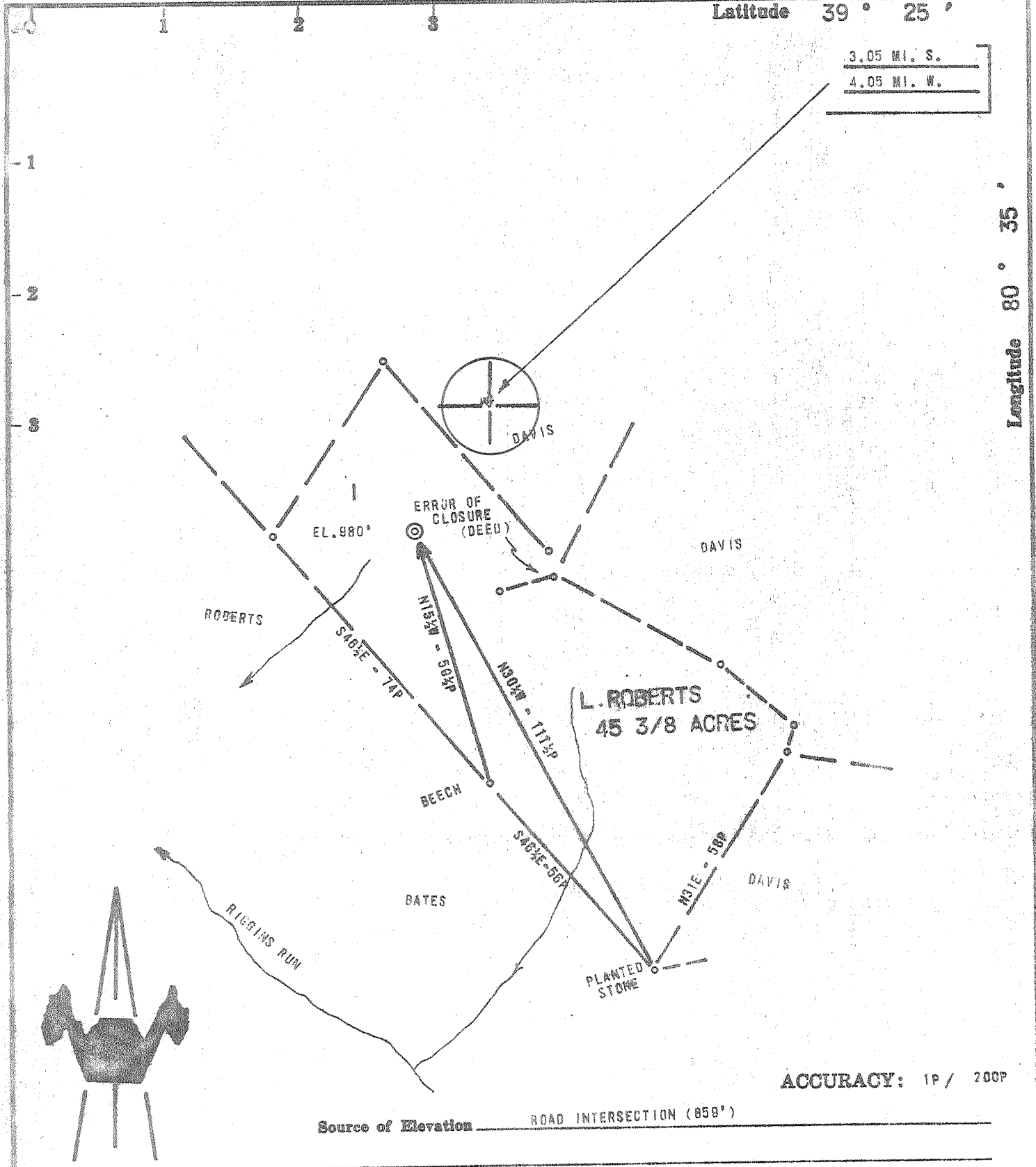

ACCURACY: 1P / 200P

Source of Elevation ROAD INTERSECTION (859')

- New Location
- Drill Deeper
- Abandonment
- Fracture
- Redrill

I, the undersigned, hereby certify that this map is correct to the best of my knowledge and belief and shows all the information required by paragraph 6 of the rules and regulations of the oil and gas section of the mining laws of West Virginia.

*Chet Waterman*

Company	PENN RESOURCES, INC., Willard E. Ferrell, Agt.	
Address	PHILADELPHIA, PA.	
Farm	L. ROBERTS	
Tract	Acres 45 3/8	Lease No. _____
Well (Farm) No.	1	Serial No. _____
Elevation (Spirit Level)	980'	
Quadrangle	CENTERPOINT C	
County	WOODRIDGE	District McCLELLAN
Engineer	CHET WATERMAN	
Engineer's Registration No.	3788	
File No.	71003-229	Drawing No. _____
Date	6/22/71	Scale 1" = 30P

STATE OF WEST VIRGINIA  
DEPARTMENT OF MINES  
OIL AND GAS DIVISION  
CHARLESTON

WELL LOCATION MAP  
FILE NO. Dood-1625

+ Denotes location of well on United States Topographic Maps, scale 1 to 62,500, latitude and longitude lines being represented by border lines as shown.

— Denotes one inch spaces on border line of original tracing.



STATE OF WEST VIRGINIA  
DEPARTMENT OF MINES

Oil and Gas Division

WELL RECORD 2

34-30  
h-31

Quadrangle Centerpoint

Permit No. DOD 1625

Rotary \_\_\_\_\_ Oil \_\_\_\_\_  
Cable X Gas \_\_\_\_\_  
Recycling \_\_\_\_\_ Comb. Both c. NOLL  
Water Flood \_\_\_\_\_ Storage \_\_\_\_\_  
Disposal \_\_\_\_\_ (Kind) \_\_\_\_\_

Company <u>Penn Resources, Inc. Willard E. Ferrell, Agent</u>	Casing and Tubing	Used in Drilling	Left in Well	Cement fill up Cu. ft. (Sks.)
Address <u>1 Decker Sq. Bala Cynwyd, Pa. 19004</u>				
Farm <u>Les Roberts</u> Acres <u>45</u>				
Location (waters) <u>Riggins Run</u>	Size			
Well No. <u>1</u> Elev. <u>980</u>	<u>20-16</u>	<u>20</u>	<u>20</u>	
District <u>McClellan</u> County <u>Dodgridge</u>	Cond. <u>13-10"</u>	<u>605</u>	<u>605</u>	
The surface of tract is owned in fee by <u>Cliff Wilson</u>	<u>9 5/8</u>			
Address <u>Pennsboro, W.Va.</u>	<u>8 5/8</u>	<u>1151</u>		
Mineral rights are owned by <u>Cliff Wilson</u>	<u>7</u>			
Address <u>Pennsboro, W.Va.</u>	<u>5 1/2</u>			
Drilling Commenced <u>Aug. 16, 1971</u>	<u>4 1/2</u>	<u>2195</u>	<u>2195</u>	
Drilling Completed <u>Sept. 21, 1971</u>	<u>3</u>			
Initial open flow <u>40M</u> cu. ft. Show <u>4</u> bbls.	<u>2</u>	<u>2190</u>	<u>2190</u>	
Final production <u>350M</u> cu. ft. per day <u>4</u> bbls.	Liners Used			
Well open <u>24</u> hrs. before test <u>460</u> RP.				

Well treatment details: Attach copy of cementing record.  
Fractured - Halliburton - Oct. 1, 1971  
500 Gal. Acid - 750 Bls fluid - 40,000 lbs of sand

Coal was encountered at \_\_\_\_\_ Feet \_\_\_\_\_ Inches  
 Fresh water \_\_\_\_\_ Feet \_\_\_\_\_ Salt Water \_\_\_\_\_ Feet \_\_\_\_\_  
 Producing Sand Big Injun Depth \_\_\_\_\_

Formation	Color	Hard or Soft	Top Feet	Bottom Feet	Oil, Gas or Water	* Remarks
Top Soil			0	20		
Sand			20	40		
Red Rock			40	60		
Lime			60	70		
Sand			70	90		
Red Rock			90	150		
Slate			150	180		
Sand			180	220		
Slate			220	300		
Lime			300	310		
Slate & Shells			310	455		
Sand			455	486		
Slate & Shells			486	515		
Lime			515	535		
Slate			535	545		
Red Rock			545	579		
Lime			579	595		
Slate & Shells			595	605		
Lime			605	635		
Slate			635	650		
Sand			650	699		
Slate			699	804		
Sand			804	850		

MADE 2 3 1972

Formation	Color	Hard or Soft	Top Feet <u>2</u>	Bottom Feet	Oil, Gas or Water	* Remarks
Slate			850	975		
Red Rock			975	1020		
Slate			1020	1100		
Red Rock			1100	1105		
Slate			1105	1275		
Sand			1275	1300		
Slate & Shells			1300	1360		
Sand			1360	1520		
Black Slate			1520	1560		
Sand			1560	1732		
Gritty Lime			1732	1740		
Sand			1740	1765		
Slate			1765	1795		
Sand Hard			1795	1832		
<del>Slate</del>			1832	1850		
Lime Gritty			1850	1895		
Slate			1895	2034		
Lime Gritty			2034	2061		
Sand - Bl. Mand.			2061	2082		
Lime			2082	2137		
Sand			2137	2140		
Lime			2140	2164		
Sand - Big Inj			2164	2255		
Slate			2255	2256		
Sand			2256	2277		
Slate			2277	2284		
Sand			2284			
			Total Depth	2284		

Date March 20, 1977

APPROVED Harold E. Ford, Owner

By Manager (Title)