

LATITUDE 39° 45' 20"

~~Incorrect~~

5.695
0.900

LONGITUDE 80° 45'

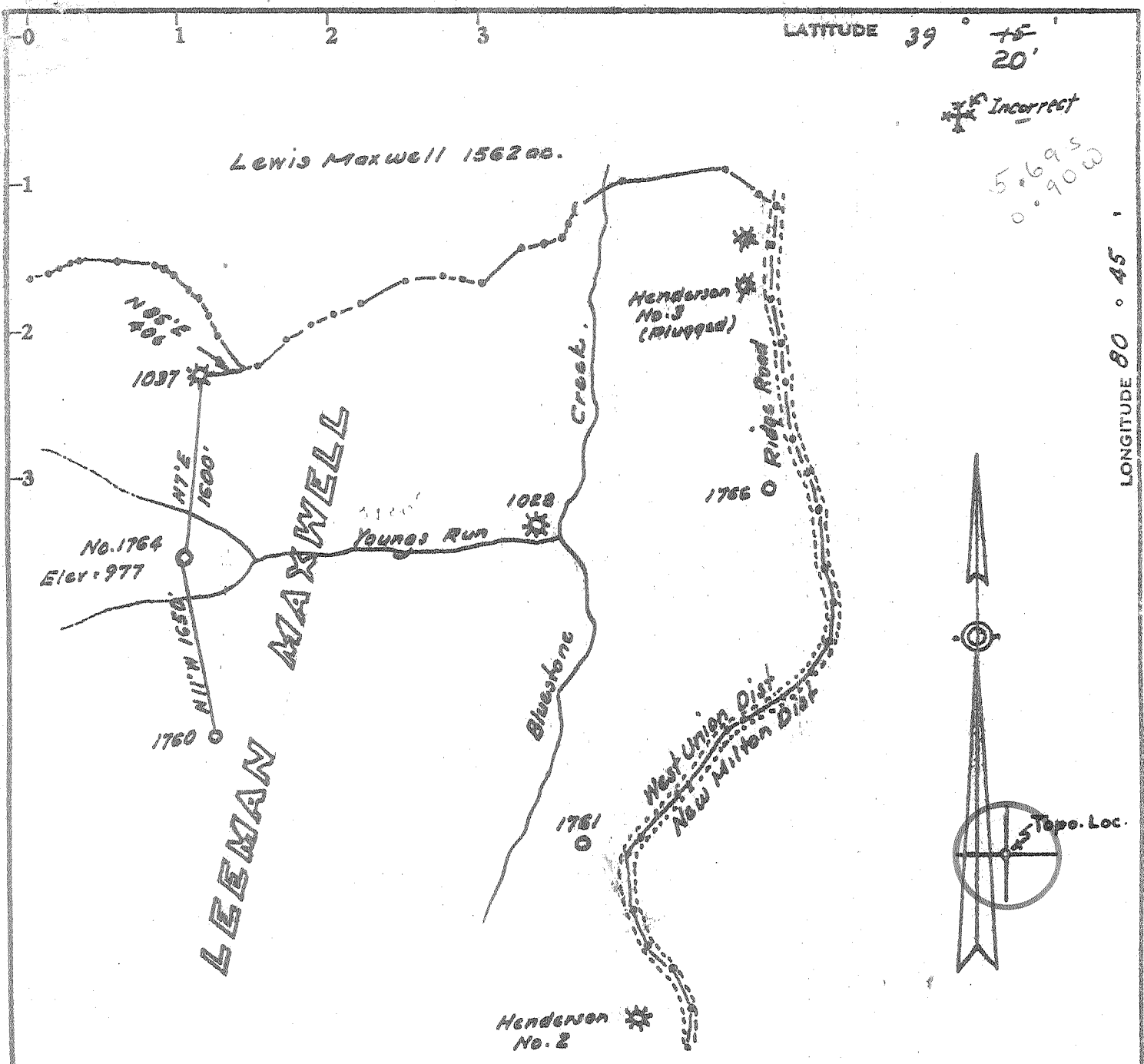

Minimum Error of Closure 1 in 200'

Source of Elevation Elev. Henderson No. 2 = 1152

- Fracture.....
- New Location.....
- Drill Deeper.....
- Abandonment.....

I, the undersigned, hereby certify that this map is correct to the best of my knowledge and belief and shows all the information required by paragraph 6 of the rules and regulations of the oil and gas section of the mining laws of West Virginia.

Signed: [Signature]
Squares: N S E W

Map No.

Company Carnegie Natural Gas Co.
 Address Munhall, Penna.
 Farm Leeman Maxwell
 Tract Acres 1000 Lease No. 6763
 Well (Farm) No. 38 Serial No. 1764
 Elevation (Spirit Level) 977
 Quadrangle West Union SE
 County Doddridge District West Union
 Engineer [Signature]
 Engineer's Registration No. 1277
 File No. _____ Drawing No. _____
 Date Aug. 16, 1972 Scale 1" = 800' = 1320'

STATE OF WEST VIRGINIA
DEPARTMENT OF MINES
OIL AND GAS DIVISION
CHARLESTON

WELL LOCATION MAP

FILE NO. DOD-1687

+ Denotes location of well on United States Topographic Maps, scale 1 to 62,500, latitude and longitude lines being represented by border lines as shown.

- Denotes one inch spaces on border line of original tracing.



RECEIVED
JAN 26 1973

STATE OF WEST VIRGINIA
DEPARTMENT OF MINES

OIL & GAS DIVISION
DEPT. OF MINES

Oil and Gas Division

WELL RECORD

Rotary Oil _____
Cable _____ Gas Oil
Recycling _____ Comb. _____
Water Flood _____ Storage _____
Disposal _____ (Kind)

Quadrangle WEST UNION S. E.

Permit No. DOD - 1687

Company <u>CARBEGIE NATURAL GAS COMPANY</u>	Casing and Tubing	Used in Drilling	Left in Well	Cement fill up Cu. ft. (Sks.)
Address <u>3904 MAIN STREET, MUNHALL, PENNA. 15120</u>	Size			
Farm <u>Leeman Maxwell</u> Acres <u>1000</u>	20-16			
Location (waters) <u>Bluestone Creek</u>	Cond.			
Well No. <u>38 - 1764</u> Elev. <u>977'</u>	13-10' <u>10,750'</u>	<u>248</u>	<u>248</u>	<u>135 sxs 248'</u>
District <u>West Union</u> County <u>Doddridge</u>	9 5/8			
The surface of tract is owned in fee by _____	8 5/8			
Address _____	7			
Mineral rights are owned by _____	5 1/2			
Address _____	4 1/2	<u>1740</u>	<u>1740</u>	<u>110 sxs 562'</u>
Drilling Commenced <u>9/7/72</u>	3			
Drilling Completed <u>After Frac. 10/16/72</u>	2			
Initial open flow _____ cu. ft. _____ bbls.	Liners Used			
Final production <u>298 M</u> cu. ft. per day <u>0</u> bbls.				
Well open _____ hrs. before test _____ RP.				

Well treatment details: Attach copy of cementing record.
Well fractured 10/11/72 in Injun Sand with 570 bbls water and 32,000# Sand.

Notched 1710'-1714' and Slotted 1714'-1720'

Coal was encountered at none Feet _____ Inches _____
Fresh water _____ Feet _____ Salt Water _____ Feet _____
Producing Sand Big Injun Depth 1653 - 1726'

Formation	Color	Hard or Soft	Top Feet	Bottom Feet	Oil, Gas or Water	* Remarks
Red Rock			0	4		
Slate			74	84		
Sand			84	97		
Slate & Red Rock			97	140		
Sand			140	152		
Sand			152	176		
Slate			176	189		
Sand			189	204		
Slate			204	217		
Sand			217	222		
Slate			222	231		
Sand			231	242		
Slate			242	350		
Red Rock			350	362		
Slate			362	384		
Red Rock & Slate			384	487		
Sand			487	501		
Slate			501	540		
Slate & Shells			540	550		
Slate			550	585		
Red Rock			585	598		
Slate & Shells			598	614		
Red Rock			614	641		

(over)

* Indicates Electric Log tops in the remarks section.

FEB 8 1973

Formation	Color	Hard or Soft	Top Feet S	Bottom Feet	Oil, Gas or Water	* Remarks
Slate			641	715		
Sand			715	738		
Slate			738	783		
Sand			783	802		
Slate & Shells			802	932		
Sand			932	1020		
Slate			1020	1064		
Sand			1064	1098		
Slate Shells			1098	1315		
Sand			1315	1407	1st Salt Sand	
Slate			1407	1443	1st	
Sand			1443	1467	2nd Salt Sand	Show gas 1456
Slate			1467	1518		
Sand			1518	1536	Maxon Sand	
Slate			1536	1545		
Lime			1545	1562	Little Lime	
Sand			1562	1571	Blue Monday Sand	
Pencil Cave			1571	1592		
Big Lime			1592	1653		
<u>Big Injun Sand</u>			1563	1726	Gas 1705-1736-	
		T. D.		1747		

Date JANUARY 24, 1973

APPROVED CARNEGIE NATURAL GAS COMPANY Owner

By R. B. Ludwig Geologist
(Title)



STATE OF WEST VIRGINIA
DEPARTMENT OF MINES

RECEIVED

AUG 30 1972

OIL & GAS DIVISION
DEPT. OF MINES

Oil and Gas Division

OIL AND GAS WELL PERMIT APPLICATION

TO THE DEPARTMENT OF MINES,
Charleston, W. Va.

DATE August 29, 1972

Surface Owner Mary A. Holland
Address West Union, W. Va.
Mineral Owner Leeman Maxwell Heirs
Address West Union, W. Va.
Coal Owner No commercial coal
Address _____
Coal Operator _____
Address _____

Company Carnegie Natural Gas Company
Address 3904 Main St., Munhall, Pa. 15120
Farm Leeman Maxwell Acres 1000
Location (waters) Bluestone Creek
Well No. 38-1764 Elevation 977
District West Union County Doddridge
Quadrangle West Union, S.E.

ALL PLATS MUST BE POSTED AT THE WELL SITE

All proposed work being in accordance with Chapter 22,
of the Code of West Virginia, the location is hereby approved
for drilling. This permit shall expire if
operations have not commenced by 12-30-72.

Robert L. Todd
Deputy Director - Oil & Gas Division

INSPECTOR TO BE NOTIFIED
Colfax, W.Va. PH: 363-9105

William Blosser

GENTLEMEN:

The undersigned well operator is entitled to drill upon the above named farm or tract of land for oil and gas, having fee title thereto, (or as the case may be) under grant or lease dated March 15 191899 by Leeman and Mary C. Maxwell made to P. H. Gaffney et al and recorded on the 28th day of March 191899 in Doddridge County, Book 13 Page 326

NEW WELL _____ DRILL DEEPER _____ REDRILL _____ FRACTURE OR STIMULATE
_____ OIL AND GAS WELL ORIGINALLY DRILLED BEFORE JUNE 5, 1969.

The enclosed plat was prepared by a registered engineer or licensed land surveyor and all coal owners and/or operators have been notified as of the above date.

The above named coal owners and/or operator are hereby notified that any objection they wish to make, or are required to make by Section 3 of the Code, must be received by, or filed with the Department of Mines within ten (10) days. *

Copies of this notice and the enclosed plat were mailed by registered mail, or delivered to the above named coal operators or coal owners at their above shown respective address _____ day _____ before, or on the same day with the mailing or delivery of this copy to the Department of Mines at Charleston, West Virginia.

Very truly yours, Carnegie Natural Gas Co.
(Sign Name) John Sweeney
Well Operator Div. Supt.
3904 Main St.
Street
Munhall,
City or Town
Pennsylvania 15120
State

Address
of
Well Operator

*SECTION 3 If no objections are filed or found by the Department of mines, within said period of ten days from the receipt of notice and plat by the department of mines, to said proposed location, the department shall forthwith issue to the well operator a permit reciting the filing of such plat, that no objections have been made by the coal operators or found thereto by the department and that the same is approved and the well operator authorized to proceed.

DODD-1687

PERMIT NUMBER

BLANKET BOND

Sweeney

**THIS IS AN ESTIMATE ONLY
ACTUAL INFORMATION WILL BE SUBMITTED ON OG-10 UPON COMPLETION**

PROPOSED WORK ORDER TO X DRILL _____ DEEPEN _____ FRACTURE-STIMULATE _____
 DRILLING CONTRACTOR: (If Known) RESPONSIBLE AGENT:
 NAME Glenn L. Haught & Sons NAME W. L. Yoho, Foreman
 ADDRESS Smithville, W. Va. 26178 ADDRESS Toll Gate, W. Va.
 TELEPHONE 477-2222 TELEPHONE 659-2921
 ESTIMATED DEPTH OF COMPLETED WELL: 1755 ROTARY X CABLE TOOLS _____
 PROPOSED GEOLOGICAL FORMATION: Big Injun
 TYPE OF WELL: OIL _____ GAS X COMB. _____ STORAGE _____ DISPOSAL _____
 RECYCLING _____ WATER FLOOD _____ OTHER _____

TENTATIVE CASING PROGRAM:

CASING AND TUBING SIZE	USED FOR DRILLING	LEFT IN WELL	CEMENT FILL UP OR SACKS - CUBIC FT.
20 - 16			
13 - 10	<u> 10.750" </u>	<u> 250' </u>	<u> cemented to surface </u>
9 - 5/8			
8 - 5/8			
7	<u> 1600' </u>		
5 ½			
4 ½	<u> 1755' </u>	<u> 1755' </u>	<u> 600' </u>
3			Perf. Top
2			Perf. Bottom
Liners			Perf. Top
			Perf. Bottom

APPROXIMATE FRESH WATER DEPTHS ? FEET SALT WATER ? FEET
 APPROXIMATE COAL DEPTHS No commercial coal
 IS COAL BEING MINED IN THE AREA? _____ BY WHOM? _____

TO DRILL:

SUBMIT FIVE (5) COPIES OF OG - 1, \$100.00 PERMIT FEE, PERFORMANCE BOND AND PERMANENT COPY OF PLAT.

TO DRILL DEEPER OR REDRILL:

SUBMIT FIVE (5) COPIES OF OG - 1, SHOWING ORIGINAL PERMIT NUMBER AND PERFORMANCE BOND. ON WELLS DRILLED PRIOR TO 1929, A PERMANENT COPY OF THE PLAT AND THE ORIGINAL WELL RECORD MUST ALSO BE SUBMITTED.

TO FRACTURE - STIMULATE:

OIL AND/OR GAS WELL ORIGINALLY DRILLED BEFORE JUNE 5, 1929, FIVE (5) COPIES OG - 1, PERFORMANCE BOND, PERMANENT PLAT AND ORIGINAL WELL RECORD.

OIL AND/OR GAS WELL ORIGINALLY DRILLED ON AND/OR AFTER JUNE 5, 1929, FIVE COPIES OG - 1, SHOWING ORIGINAL PERMIT NUMBER, AND PERFORMANCE BOND.

Required forms must be filed within ninety (90) days of completion for bond release. Inspector to be notified twenty-four (24) hours in advance.

The following waiver must be completed by the coal operator if the permit is to be issued within ten days of receipt thereof.

WAIVER: I the undersigned, Agent for _____ Coal Company, Owner or Operator of the coal under this lease have examined and place on our mine maps this proposed well location.

We the _____ Coal Company have no objections to said well being drilled at this location, providing operator has complied with all rules and regulations in Articles 4, 5, and 7, Chapter 22 of the West Virginia Code.

For Coal Company

Official Title