

Minimum Error of Closure 1 in 200'

Source of Elevation Elevation at Route 50 at mouth of Tarkila Run = 949'

I, the undersigned, hereby certify that this map is correct to the best of my knowledge and belief and shows all the information required by paragraph 6 of the rules and regulations of the oil and gas section of the mining laws of West Virginia.

Fracture
 New Location
 Drill Deeper
 Abandonment

Signed: [Signature]
 Squares: N S E W

Company Renco Oil & Gas Corp.
 Address P.O. Box 99, Balpara, Ohio
 Farm J. L. Cottrill
 Tract Acres 56.25 Lease No. _____
 Well (Farm) No. One Serial No. _____
 Elevation (Spirit Level) 1179'
 Quadrangle Centerpoint SC
 County Doddridge District Grant
 Engineer [Signature]
 Engineer's Registration No. 1227
 File No. _____ Drawing No. _____
 Date Dec. 3, 1973 Scale 1" = 300' = 496'

STATE OF WEST VIRGINIA
 DEPARTMENT OF MINES
 OIL AND GAS DIVISION
 CHARLESTON

WELL LOCATION MAP
 FILE NO. Ad-1757-P

+ Denotes location of well on United States Topographic Maps, scale 1 to 62,500, latitude and longitude lines being represented by border lines as shown.
 - Denotes one inch spaces on border line of original tracing.

47 017

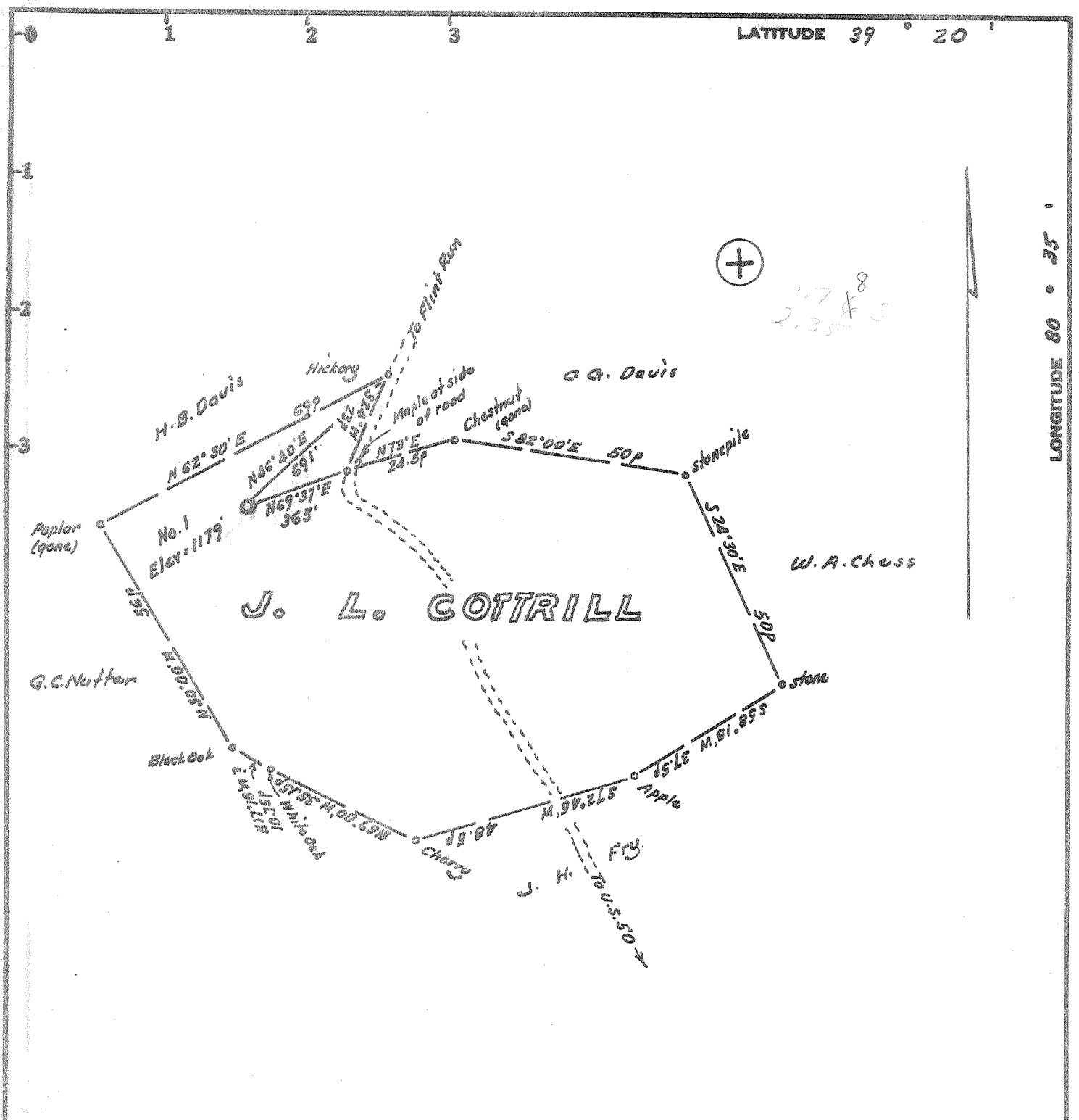

Minimum Error of Closure 1 in 200'
 Source of Elevation Elevation at Route 50 at mouth of Tarkila Run = 949'

- Fracture.....
- New Location.....
- Drill Deeper.....
- Abandonment.....

I, the undersigned, hereby certify that this map is correct to the best of my knowledge and belief and shows all the information required by paragraph 6 of the rules and regulations of the oil and gas section of the mining laws of West Virginia.

Signed: [Signature]
 Squares: N S E W

Map No.

Company Renco Oil & Gas Corp.
 Address P.O. Box 99, Belpra, Ohio
 Farm J. L. Cottrill
 Tract _____ Acres 56.25 Lease No. _____
 Well (Farm) No. One Serial No. _____
 Elevation (Spirit Level) 1179'
 Quadrangle Centerpoint SC
 County Doddridge District Grant
 Engineer [Signature]
 Engineer's Registration No. 1227
 File No. _____ Drawing No. _____
 Date Dec. 3, 1973 Scale 1" = 300' = 495'

STATE OF WEST VIRGINIA
 DEPARTMENT OF MINES
 OIL AND GAS DIVISION
 CHARLESTON

WELL LOCATION MAP

FILE NO. Dad-1757

+ Denotes location of well on United States Topographic Maps, scale 1 to 62,500, latitude and longitude lines being represented by border lines as shown.

- Denotes one inch spaces on border line of original tracing.

47 017



RECEIVED

JAN 18 1974

STATE OF WEST VIRGINIA
DEPARTMENT OF MINES

OIL & GAS DIVISION
DEPT. OF MINES

Oil and Gas Division

WELL RECORD

Rotary Oil _____
Cable _____ Gas _____
Recycling _____ Comb. _____
Water Flood _____ Storage _____
Disposal _____ dry (KMG)

Quadrangle Centerpoint

Permit No. DOD-1757

Company RAMCO Oil & Gas Corp.
Address P.O. Box 99, Belpre, Ohio 45714
Farm J. L. Cottrill Acres 56.25
Location (waters) Buckeye Run of Buckeye Creek
Well No. 1 Elev. 1170'
District Grant County Doddridge
The surface of tract is owned in fee by _____
J. L. Cottrill
Address Salem, W. Va. 26426
Mineral rights are owned by J. L. Cottrill
Address Salem, W. Va. 26426
Drilling Commenced 12/12/73
Drilling Completed 12/18/73
Initial open flow dry cu. ft. _____ bbls.
Final production _____ cu. ft. per day _____ bbls.
Well open _____ hrs. before test _____ RP.
Well treatment details:

Casing and Tubing	Used in Drilling	Left in Well	Cement fill up Cu. ft. (Sks.)
Size 20-16			130 sks. circulated to surface
Cond. 13-10"			
9 5/8			
8 5/8	901'	901'	
7			
5 1/2			
4 1/2			
3			
2			
Liners Used			

Attach copy of cementing record. Lawson Cementing Co., Inc.

Coal was encountered at none reported Feet _____ Inches _____
Fresh water _____ Feet _____ Salt Water _____ Feet _____
Producing Sand _____ Depth _____

Formation	Color	Hard or Soft	Top Feet	Bottom Feet	Oil, Gas or Water	* Remarks
Sand & Shale		Soft	0	1990		water @ 1690'
Shale		Soft	1990	2043		
Little Lime		Hard	2043	2058		
Pencil Cave		Soft	2058	2087		
Big Lime		Hard	2087	2168		
Big Injun		Hard	2168	2188		
<u>Squaw</u>		Hard	2188	2243		
Shale		Soft	2243	2285		
TD			2285			

(over)

* Indicates Electric Log tops in the remarks section.

FEB 7 1974



STATE OF WEST VIRGINIA
DEPARTMENT OF MINES

RECEIVED

DEC 6 1973

OIL & GAS DIVISION
DEPT. OF MINES

Oil and Gas Division
OIL AND GAS WELL PERMIT APPLICATION

TO THE DEPARTMENT OF MINES,
Charleston, W. Va.

DATE December 6, 1973
Company RAMCO Oil & Gas Corp.
Address P. O. Box 89, Belpro, Ohio 45714
Farm J. L. Cottrill Acres 3.6
Location (waters) North Buckeye Run
Well No. 1 Buckeyeck Elevation 1140
District Grant County Codrriage
Quadrangle Centerpoint

Surface Owner J. L. Cottrill
Address Belpro, W. Va.
Mineral Owner J. L. Cottrill
Address Belpro, W. Va.
Coal Owner J. L. Cottrill
Address Belpro, W. Va.
Coal Operator none - no coal is being mined in this area.
Address Belpro

THIS PERMIT MUST BE POSTED AT THE WELL SITE

All provisions being in accordance with Chapter 22, of the W. Va. Code, the location is hereby approved for Drilling. This permit shall expire if operations have not commenced by 4-6-74.

Robert E. Dodd
Deputy Director - Oil & Gas Division

INSPECTOR TO BE NOTIFIED
Mr. Wm. Blosser
Box 1028 PH: Fairmont
Calfax 363-9105
W. Va. 26566

GENTLEMEN:

The undersigned well operator is entitled to drill upon the above named farm or tract of land for oil and gas, having fee title thereto, (or as the case may be) under grant or lease dated May 22, 1973 by Ronald V. Eason made to RAMCO Oil & Gas Corp. and recorded on the 21st day of September 1973, in Codrriage County, Book 197 Page 283

NEW WELL DRILL DEEPER REDRILL FRACTURE OR STIMULATE
OIL AND GAS WELL ORIGINALLY DRILLED BEFORE JUNE 5, 1969.

The enclosed plat was prepared by a registered engineer or licensed land surveyor and all coal owners and/or operators have been notified as of the above date.

The above named coal owners and/or operator are hereby notified that any objection they wish to make, or are required to make by Section 3 of the Code, must be received by, or filed with the Department of Mines within ten (10) days. *

Copies of this notice and the enclosed plat were mailed by registered mail, or delivered to the above named coal operators or coal owners at their above shown respective address _____ day _____ before, or on the same day with the mailing or delivery of this copy to the Department of Mines at Charleston, West Virginia.

PLEASE SUBMIT COPIES OF ALL GEOLOGICAL LOGS DIRECTLY TO:

West Virginia Geological and Economic Survey
P. O. Box 879
Morgantown, W. Va. 26505
AC 304-296-4461

Very truly yours,
(Sign Name) Karl E. Moon
Well Operator
Address P. O. Box 89
Street Belpro
City or Town Ohio 45714
State

*SECTION 3 . . . If no objections are filed or found by the Department of mines, within said period of ten days from the receipt of notice and plat by the department of mines, to said proposed location, the department shall forthwith issue to the well operator a permit reciting the filing of such plat, that no objections have been made by the coal operators or found thereto by the department and that the same is approved and the well operator authorized to proceed.

THIS IS AN ESTIMATE ONLY
ACTUAL INFORMATION WILL BE SUBMITTED ON OG-10 UPON COMPLETION

PROPOSED WORK ORDER TO X DRILL DEEPEN FRACTURE-STIMULATE
 DRILLING CONTRACTOR: (If Known) RESPONSIBLE AGENT:
 NAME Hought Brothers Drilling Co. NAME Brad Crouse
 ADDRESS Smithville, W. Va. ADDRESS P. O. Box 243, West Leno, W. Va.
 TELEPHONE _____ TELEPHONE (64) 870-1745
 ESTIMATED DEPTH OF COMPLETED WELL: 222' ROTARY X CABLE TOOLS _____
 PROPOSED GEOLOGICAL FORMATION: Big Inlet
 TYPE OF WELL: OIL _____ GAS X COMB. _____ STORAGE _____ DISPOSAL _____
 RECYCLING _____ WATER FLOOD _____ OTHER _____

TENTATIVE CASING PROGRAM:

CASING AND TUBING SIZE	USED FOR DRILLING	LEFT IN WELL	CEMENT FILL UP OR SACKS - CUBIC FT.
20 - 16			
13 - 10			
9 - 5/8			
8 - 5/8	<u>220'</u>	<u>220'</u>	<u>cemented to surface</u>
7			
5 1/2			
4 1/2		<u>220'</u>	<u>220'</u>
3			Perf. Top
2			Perf. Bottom
Liners			Perf. Top
			Perf. Bottom

APPROXIMATE FRESH WATER DEPTHS _____ FEET SALT WATER _____ FEET
 APPROXIMATE COAL DEPTHS _____
 IS COAL BEING MINED IN THE AREA? no BY WHOM? _____

TO DRILL:

SUBMIT FIVE (5) COPIES OF OG - 1, \$100.00 PERMIT FEE, PERFORMANCE BOND AND PERMANENT COPY OF PLAT.

TO DRILL DEEPER OR REDRILL:

SUBMIT FIVE (5) COPIES OF OG - 1, SHOWING ORIGINAL PERMIT NUMBER AND PERFORMANCE BOND. ON WELLS DRILLED PRIOR TO 1929, A PERMANENT COPY OF THE PLAT AND THE ORIGINAL WELL RECORD MUST ALSO BE SUBMITTED.

TO FRACTURE - STIMULATE:

OIL AND/OR GAS WELL ORIGINALLY DRILLED BEFORE JUNE 5, 1929, FIVE (5) COPIES OG - 1, PERFORMANCE BOND, PERMANENT PLAT AND ORIGINAL WELL RECORD.

OIL AND/OR GAS WELL ORIGINALLY DRILLED ON AND/OR AFTER JUNE 5, 1929, FIVE COPIES OG - 1, SHOWING ORIGINAL PERMIT NUMBER, AND PERFORMANCE BOND.

Required forms must be filed within ninety (90) days of completion for bond release. Inspector to be notified twenty-four (24) hours in advance.

The following waiver must be completed by the coal operator if the permit is to be issued within ten days of receipt thereof.

WAIVER: I the undersigned, Agent for _____ Coal Company, Owner or Operator of the coal under this lease have examined and place on our mine maps this proposed well location.

We the _____ Coal Company have no objections to said well being drilled at this location, providing operator has complied with all rules and regulations in Articles 4, 5, and 7, Chapter 22 of the West Virginia Code.

 For Coal Company

 Official Title