

LATITUDE 39° 20' 00"

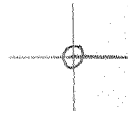

LONGITUDE 98° 47' 30"

7'5 OGIS topo location

7.5' loc 1.02S
0.79W

15' loc 1.02S
(calc.) 3.02W

Company 0384

Farm FB McClain (232)

Elev. 1020' 75' topo k/a 315/93
Centerpoint SW.

Quad SMITHBURG 7 1/2'

County DODDRIDGE

District WEST UNION

WELL LOCATION MAP

File No. 017-1906

HOPE NATURAL GAS COMPANY,

Pittsburg, Pa. Dec 8th 1907

123
RECORDED
INDEXED

Mr. W. G. Carter, Genl. Supt.
Below find plat of P. B. McLain farm 247 acres.
Waters of Butlers Fork West Union District
Rockledge County, W. Va. Range N. S. 9 E. W. 687
Scale 10" = 800 poles.

Please furnish us with the following information on plat or space below provided and return this paper at your earliest convenience.

Please give correct location of well 232 P. B. McLain

Yours truly,
Geo. H. Harris

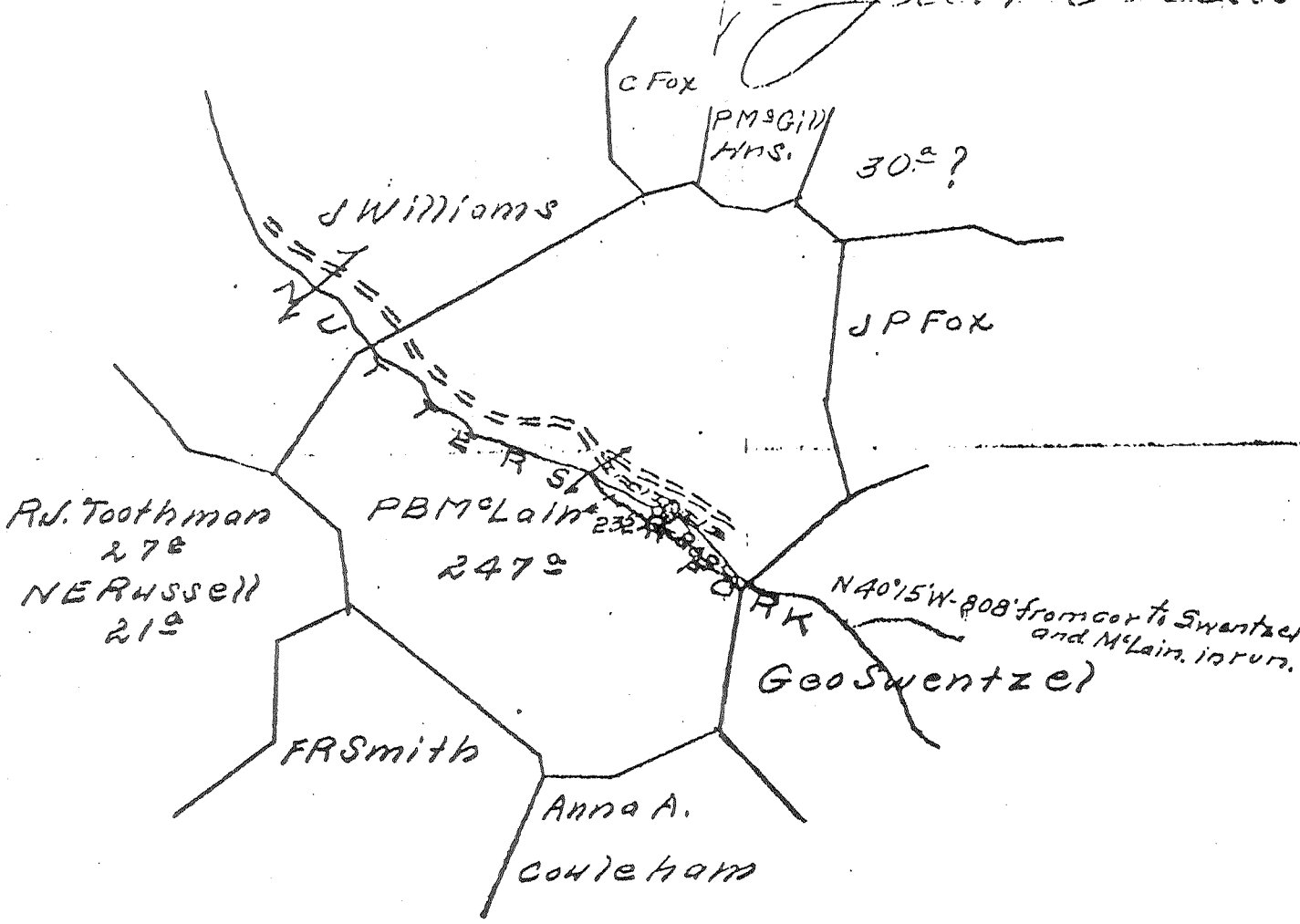

ENTERED
WELL BOOK
LEASE RECORD
WELL BOOK
WELL MAP 12-27-07
VICTORIAN
LOG

100 111 Blakeburg W. Va. Dec 21 1907

Mr. B. Harris
Pittsburg, Pa.

Dear Sir: Information from Survey
S.H.B.

P. B. McCLAIN NO. 1 WELL.

No. 132 O.F.-1-Doddridge.

No. 155 D&H Rept.p.....

#155 OH Co Rep

.....District, Doddridge County, W. Va.
By Eastern Oil Co.
On 200 acres.

13" casing, 15'; 10", 225'; 8 1/2", 1015'; 6-5/8", 1825'.

70312
was
70143
now
Dodd. 1906

	Top.	Bottom.
Water		30
Pittsburgh Coal		465
Maxton Sand		1500
Little Lime		1738
Blue Monday Sand		1810
Big Line		1825
Big Injun Sand (first gas, 1915'; second gas, 1985'; third gas, 2005')		1875 - 2015
Gas in Gordon Stray Sand		2600
Top Gordon Sand		2608
Total depth		2630

HOPE NATURAL GAS COMPANY
Report on Hydraulic Fracturing

WELL NO. 232
MAP _____
SQUARES N E S 9 W 7

NEW WELL _____
D.D. _____
OLD WELL X

FARM NAME P.B. McClain DISTRICT Grant COUNTY Doddridge STATE W. Va.

OPERATOR Hope Natural Gas SERVICE COMPANY Dowell Chemical Co. DATE 4-21-59

FORMATION Injun TOP 1875 BOTTOM 2015

PAY ZONE: TOP 1875 BOTTOM 2015 WAS FORMATION SHOT? No

TOTAL DEPTH 2630 PLUGGED BACK TO 2020 WITH Stone & cement

SURVEYS: CALIPER Yes TEMPERATURE Yes GAMMA RAY Yes OTHER _____

O. F. ORIGINAL Unknown MCF, R. P. _____ # IN _____ HOURS

O. F. BEFORE FRAC. 30 MCF, R. P. 60 # IN 48 HOURS

PRODUCTION STRING: SIZE 4-1/2 LENGTH 1905 CEMENTED WITH 39 BAGS OF Uniflow CEMENT

WAS LINER SET? No SIZE _____ TOP _____ BOTTOM _____

INJECTION STRING: SIZE 4-1/2 LENGTH 1905 PACKER: SET None SIZE _____

PACKER (CONTD): TYPE _____ MAKE _____ CEMENTED WITH _____ BAGS OF _____ CEMENT

(TO BE FILLED IN BY SERVICE ENGINEER)

TYPE OF TREATMENT Waterfrac VOLUME OF FLUID REQUIRED TO FILL HOLE 1890 GALS

TREATMENT - BREAKDOWN

FLUID: KEROSENE _____ GALS
~~Water~~ Water 1680 GALS
M. C. A. 200 GALS
To fill hole 1890 GALS
TOTAL 3770 GALS

Water

BREAKDOWN PRESSURE: MAXIMUM 1800 #
FINAL 1800 #
TIME 1 MINUTES
INJECTION RATE: 1680 GALS PER MINUTE
VISCOSITY _____ (SSU) SP. GR. _____

TREATMENT - FRACTURE

FLUID: KEROSENE _____ GALS
~~Water~~ Water 23,100 GALS
GEL AGENT _____ GALS
TOTAL 23,100 GALS

SAND: AMOUNT 38,000 POUNDS
SIZE 20-40
PRESSURE: MAXIMUM 2200 #
FINAL 2200 #
TIME 11 MINUTES
INJECTION RATE: START OF GEL 1616 GALS PER MINUTE
AVERAGE 1532 GALS PER MINUTE
VISCOSITY _____ (SSU) SP. GR. _____

TREATMENT - FLUSH

FLUID: KEROSENE _____ GALS
~~Water~~ Water 2520 GALS
TOTAL 2520 GALS

PRESSURE: MAXIMUM 2200 #
FINAL 2200 #
TIME 2 MINUTES
INJECTION RATE: 1448 GALS PER MINUTE
VISCOSITY _____ (SSU) SP. GR. _____

TOTAL FLUID USED 29,390 GALS

COMPLETION

PRESSURE 10 MINUTES AFTER PUMPS SHUT DOWN: None #
PRESSURE AT END OF SHUT IN PERIOD: 220
FLUID RECOVERED: 30 BBL IN 24 HOURS, 100 IN 48 HOURS, 300 IN 72 HOURS
FLUID REMAINING IN FORMATION: 400 BBL ~~XXXX~~ VOLUME OF SAND RECOVERED None

O. F. AFTER FRAC. 624 MCF, R. P. 220 # IN 18 HOURS

REMARKS: Well feeding line. Not completely cleaned out.

(CONTINUE ON BACK)

COPY TO: A. R. MCCAMEY
LAND DEPARTMENT
J. W. HENDRICKSON
DIVISION SUPERINTENDENT ✓
DISTRICT SUPERINTENDENT

REPORTED BY: Warren R. Mason
DATE: 5-13-59
WORKING DISTRICT: Salon

Eastern Oil Company.

017-1906

RECORD of Well No. 1 on M. P. Linn Farm 2.00 Acres.
Hullus Field, West Union Township, Adair County, Mo.
 Rig Commenced..... 190....., Completed..... 190.....
 Drilling Commenced July 1st 1901....., Completed March 13 1901.....
 Cost per foot,..... Contractor, P. N. Gaffney Address, Leitchville
 Drillers' Names,.....

BOILER			ENGINE			RIG			
H. P.	No.	Name of Maker	H. P.	No.	Name of Maker	New	Old	Height	Name of Builder
75		<u>Paul J.</u>	75		<u>Wheeler-White</u>				

CONDUCTOR AND CASING USED IN DRILLING.

Conductor	13 Inch	10 Inch	8 1/2 Inch	8 Inch	7 1/2 Inch	6 1/2 Inch	6 Inch	5 1/2 Inch	5 1/4 Inch	4 1/2 Inch
<u>15 1/2</u>		<u>225</u>	<u>1015</u>			<u>1875</u>				

CONDUCTOR AND CASING LEFT IN WELL.

Conductor	13 Inch	10 Inch	8 1/2 Inch	8 Inch	7 1/2 Inch	6 1/2 Inch	6 Inch	5 1/2 Inch	5 1/4 Inch	4 1/2 Inch
		<u>745</u>	<u>715</u>			<u>1875</u>				

OIL WELL

GAS WELL

When Shot	Size of Torpedo	1st day's Production	Tubing	Rods	Size of Packer	Depth Set	Tubing	1st Minute Pressure	Rock Pressure

Formation	Top	Bottom	Thickness	Remarks
<u>Pittsburg Coal</u>	<u>465</u>			<u>Well is now filled with 2" pipe</u>
<u>Mason Sand</u>	<u>1500</u>			
<u>Little Linn</u>	<u>1738</u>			
<u>Blue Monday</u>	<u>1810</u>			
<u>Big Linn</u>	<u>1825</u>			
<u>Pop. Big Linn</u>	<u>1875</u>			
<u>1st Gas</u>	<u>1915</u>			
<u>2nd "</u>	<u>1985</u>			
<u>3rd "</u>	<u>2005</u>			
<u>Through Big Linn</u>	<u>2015</u>			
<u>Gas in Stray London</u>	<u>2600</u>	<u>Fair</u>		
<u>Pop London Sand</u>	<u>2608</u>	<u>Poor</u>		
<u>Through London "</u>	<u>2613</u>			
<u>Total depth:</u>	<u>2630</u>			

Examined and Approved by Chas. Bennett Foreman.

NOTE.—The above blank must be filled out carefully by the Contractor with a complete and accurate record of the Well, and accompany, when presented for payment, the bill for drilling.
 All formations and known sands must be given their proper name, and under head of "Remarks" must be reported in what sand and at what depth Oil, Gas, or Water was found, the quantity of same, the quality of the sand, and thickness of pay.
 Make no memoranda of Boiler and Engine if owned by the Driller.