

LATITUDE 39° 20' 00"

80° 45' 00"

LONGITUDE



7'5 OGIS topo location

7.5' loc  $\frac{1.415}{0.27W}$

15' loc  $\frac{1.415}{0.27W}$   
(calc.)

Company \_\_\_\_\_

Farm \_\_\_\_\_

Elev. 1160' - 7.5' topo k/a 3/5/93  
Centerpoint SW

Quad SMITHBURG 7 1/2'

County DODDRIDGE

District GRANT

WELL LOCATION MAP

File No. 017-1927

# HOPE NATURAL GAS COMPANY.

## LOCATION FOR WELL No. 1571

On Salem DISTRICT  
Lelia Arnett Farm, on waters of Morgan Run  
Grant District, Doddridge County, West Virginia  
 Lease No. 10096 Acres 28 N. 10 E. W. 4  
 Scale, one inch equals 80 Poles Sent to W. C. 1-24-1910  
 Location to be 400 feet from C. R. Rush farm line and 500 feet from Jas. H. Ball's farm line.

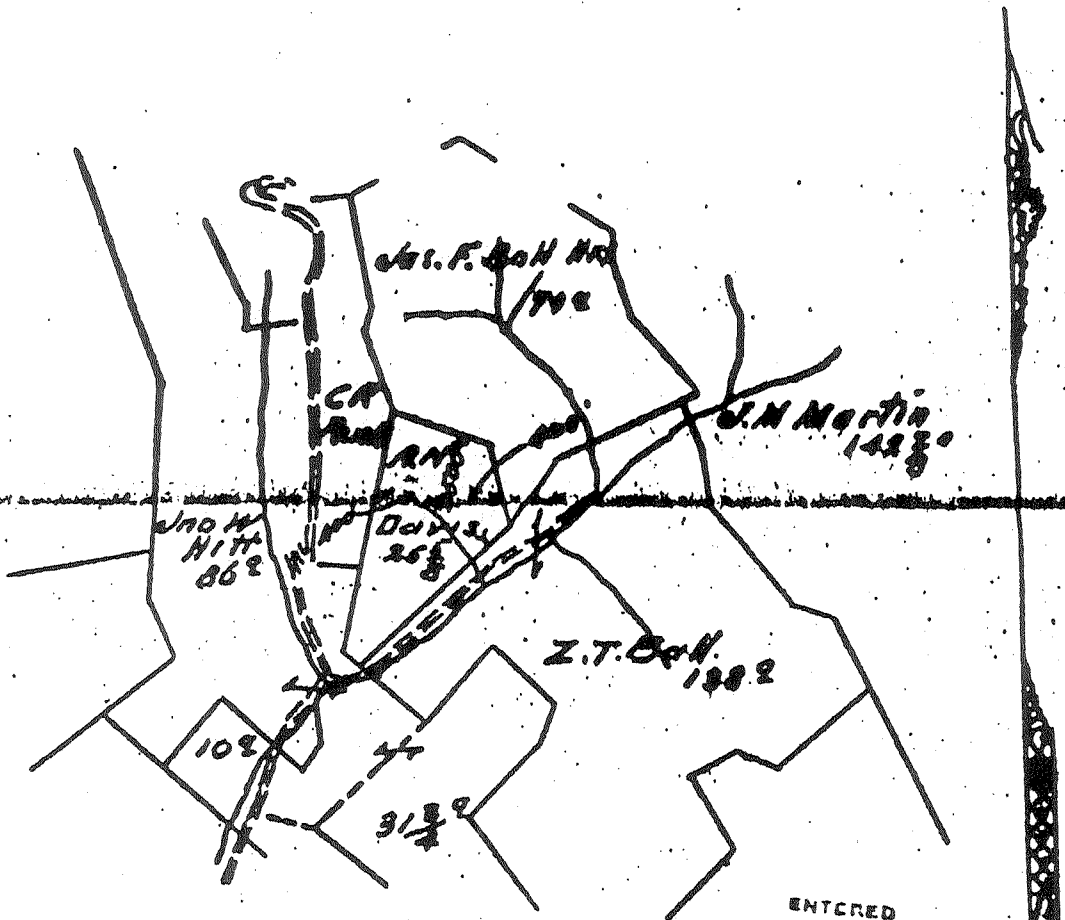

*API -  
017-1927*

ENTERED  
LINE MAP  
2/3-1910

ENTERED
WELL BOOK.....
LEASE DOCKET.....
LEASE DOCKET.....
WELL MAPS.....
LOCATION MAP.....

RESERVE None

SPECIAL INSTRUCTIONS Complete well on or before April 7, 1910

Location made 1-27-10 by J. S. Lang As per plat, except as noted. On field map

2-1-10 Returned to Pittsburgh..... 1

Location changed on account of.....

Authorized by..... Date..... 1 Signed.....

Record of Hope Nat. Gas Company

1571

Location on Grant District Woodbridge County W. Va.  
 Location made 1-27-10 First work done 2-1-10

Rig Commenced 2-8-10 Rig Completed 2-16-10  
 Drilling Commenced 2-24-10 Drilling Completed 3-18-10  
 Rig Contractor Hope Nat. Gas Co. (Drilling Contractor if H. N. G. Co. Tools, String No.) H. N. G. Co. #2  
 Drillers Carl Bantwell & A. J. Catehion  
 Tool Dressers W. J. Horton & Amos Cooper

FORMATION	TOP	BOTTOM	Steel Line Measurements	Water Found Depth	Gas or Oil Depth Found	REMARKS
Native Coal	352	355				
Pittsburgh Coal	621	626				
Little Dunkard	964	969				
Big Dunkard						20' Big Dunkard
Gas Sand	1255	1400				
First Salt	1530	1580		1555		
Second Salt	1600	1700				
Maxon	1800	1844	1800-1844		1811	No Mercury 4" Opening 1237' depth
Little Lime	1858					
Pencil Cave						
Big Lime						
Big Injun						
Squaw						
Berea						
Gantz						
Fifty Foot						
Thirty Foot						
Gordon Stray						
Gordon						
Fourth						
Fifth						
Bayard						
TOTAL DEPTH		1876	1876			

ENTERED  
 WELL BOOK  
 LEASE RECORD  
 LEASE DOCKET  
 WALL MAP  
 LINE MAP  
 LOCATION BOOK  
 CONTRACTORS' PLAT  
 CONTRACTOR  
 TITLE

CASING RECORD

Size	Charged to Well		Put in Well		Pulled Out		Left in Well		Transferred before Completing		Left at Well Not in Use		Remarks
	Foot	In.	Foot	In.	Foot	In.	Foot	In.	Foot	In.	Foot	In.	
10"	634	2	318	-	-	-	318	-	-	-	316	2	8x10 13.8' Catehion
8 1/2"	1255	-	1255	-	-	-	1255	-	-	-	-	-	6 1/2 x 1 1/4

Note.—If 10" casing cemented, so state, and at what depth

If tubed note size and amount of tubing  
 If more than two strings of casing are left in hole give reasons for leaving additional strings  
to prevent waste of gas from Maxon sand as  
not have 6 1/2" casing in well when gas was found

Steel line measurements should be made of Top and Bottom of Pittsburgh Coal and all the principal sands.  
 Under Remarks note if any of principal sands are not found and if any peculiarities in sands, as looser or harder than ordinary, etc.  
 If any coal other than native or Pittsburgh be found, give steel line measurements of Top and Bottom and nature of coal.  
 Note if water found is fresh or salt.

Checked by  
*[Signature]*

Very Bad Copy ADP - 017-1977