

LATITUDE 3910

→ 75' 10c
kla
3/11/93

5405

LONGITUDE

7'5 OGIS topo location

7.5' 10c $\frac{0.495}{0.91W}$

15' 10c $\frac{0.495}{0.91W}$
(calc.)

Company _____

Farm _____

ELW. 995' - 7.5' topo - kla 3/11/93

Quad Oxford Holbrook EC

County _____

District Cove²

WELL LOCATION MAP

File No. Dodd, 1939

HOPE NATURAL GAS CO.

LOCATION FOR WELL No 3083

M.C. Williams Farm on waters of Greggore Fork
Cove District Doolidge County, West Virginia.

Well No 13232 Acres 125 N. 20 E. 9
Section 8066 Sent to Clarksburg Office June 18, 1913

Location to be Nine hundred feet from Mrs. Plumber farm and
two hundred feet from Y. B. Chapman farm.
6-17-13

Holbrook 15' Oxford T₂
39° 10' E Same
80° 45' Same

Cove District
Section 6

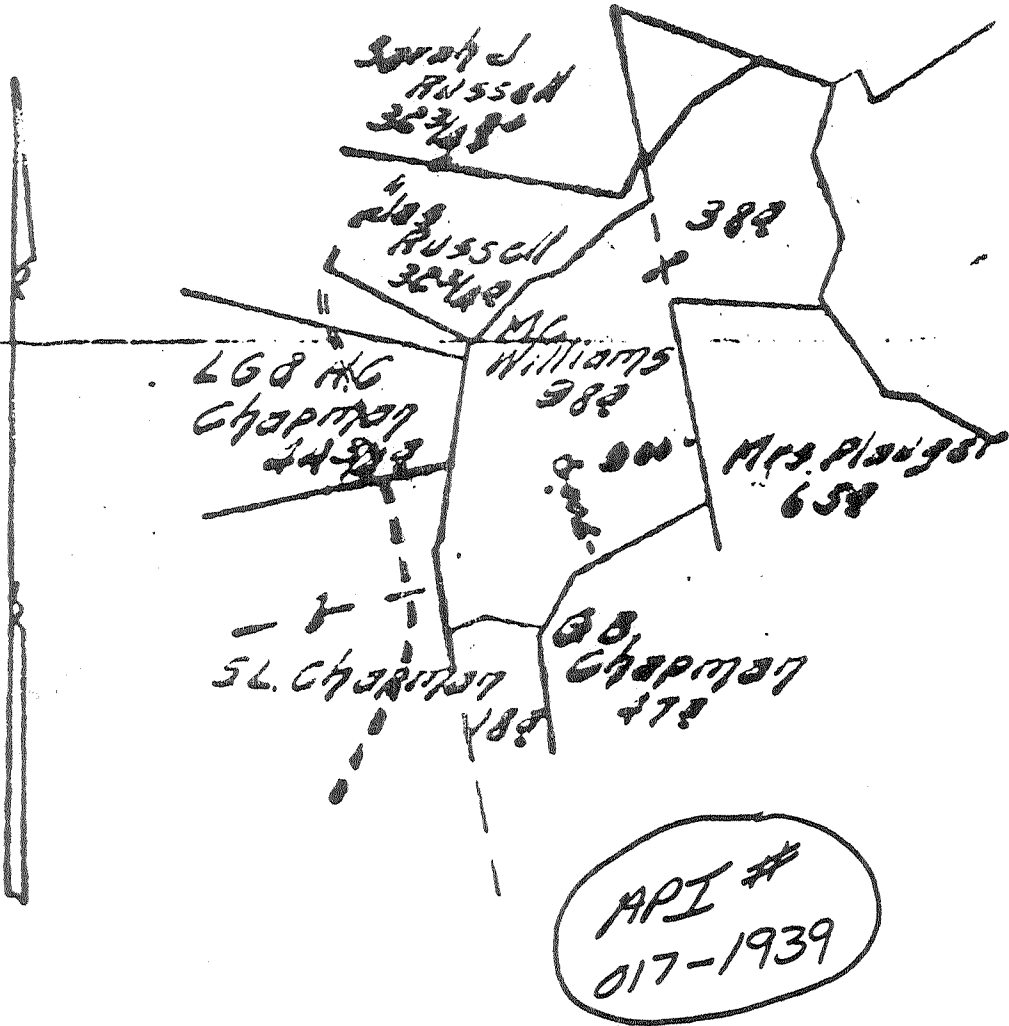

Only rough location could be determined by checking neighboring property owners and well on their property.

68
68

NOTE: Two hundred feet around the
location?
FINAL INSTRUCTIONS COMPLETE WELL ON OR BEFORE Sept. 30 1913

Map made 6-26-13 by J. C. Owen As per plat, except as noted. On field map.
6-28-13 Returned to Pittsburgh 6-28-13

Location changed on account of
Authorized by _____ Date _____ Signed _____

