

LATITUDE 39°20'00"

LONGITUDE 80°37'28"

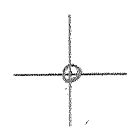

7.5 OGIS topo location

7.5' loc	<u>1.675</u>	15' loc	<u>1.675</u>
	<u>0.94 W</u>	(calc.)	<u>3.17 W</u>

Company \_\_\_\_\_

Farm \_\_\_\_\_

Elev 1150' - 75' topo lda 3/5/93  
Centerpoint SC

Quad SMITHBURG 7 1/2'

County DODDRIDGE

District GRANT

WELL LOCATION MAP

File No. 017-1948

# HOPE NATURAL GAS CO.

LOCATION FOR WELL No. 3672

N.

*Gale*  
 Milroy *Barlow* Farm, on waters of *Shenandoah River*  
 District... *Doddridge* County, West Virginia.

No. *17792* Acres *102* N. *80* S. *10* E. *2*  
 one inch equals *80 Paces* Sent to Clarksburg Office *Apr. 5* 1914

Location to be *700 feet from C. Powell farm and 900 feet from*  
*J. L. Freeman farm*

*11-5-14*

RECEIVED BY THE HOPE NATURAL GAS CO. IN TRANSIT TO A FIELD LOCATION  
 ALL INFORMATION CONTAINED HEREIN IS UNCLASSIFIED  
 DATE 11-17-1948 BY 6032 JRS/STW

*J. L. Freeman* adjoining land  
*D. Gale*, owner

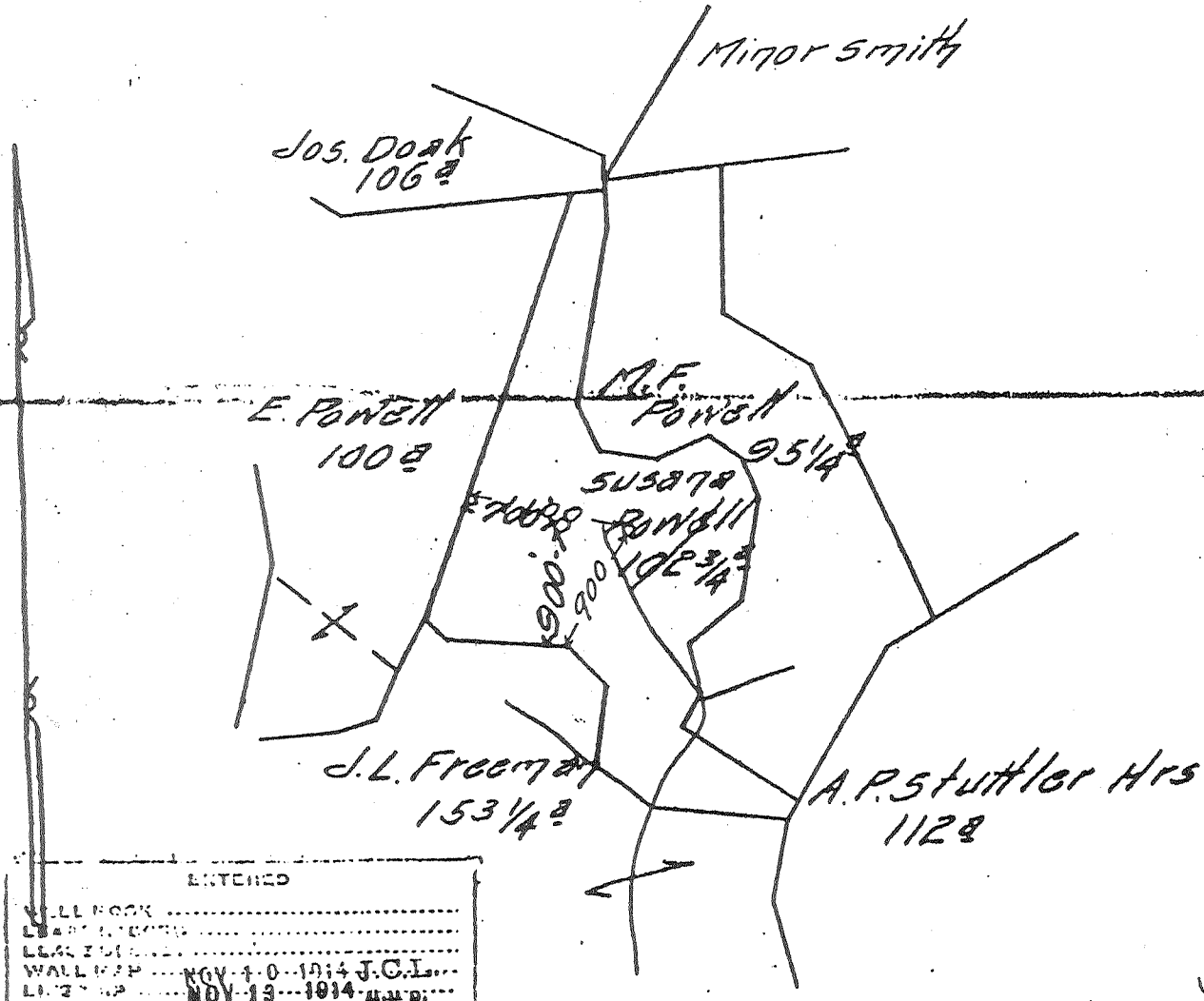

ENTERED  
 WELL BOOK .....  
 LEASE .....  
 WALL MAP .....  
 NOV 13 1914 J.C.L.  
 NOV 13 1914

*54*

NOV 13 1914 U.S.

TITLE...  
 RESERVE *Three hundred feet around*  
*drilling house*

SPECIAL INSTRUCTIONS: COMPLETE WELL ON OR BEFORE *Jan. 24 1915*

Location made *11-7-14* by *J. D. Lang* As per plat, except as noted. On field map...  
*11-9-14* Returned to Pittsburgh *11-9-14*

Location changed on account of *Instructions from Clarksburg*

Authorized by... Date... Signed...  
*0.17-1948*

Record of *W. E. P. Natural Gas Co.* Company *JAI*  
 Well No. *3672* Located on *Lease No 17792 - 102 acres - Milray, Buchanan* District *Grant* County *Doddridge* State *W. Va.*

Location Made *11-7-14* First Work Done *11-9-14*  
 Rig Commenced *11-16-14* Rig Completed *11-21-14*  
 Drilling Commenced *11-26-14* Drilling Completed *1-19-15*  
 Rig Contractor *Hope Natural Gas Co.* Drilling Contractor *Hope Nat. Gas Co. - Eng Dept - Stg*  
 Drillers *Andy Baker and Jack* H. N. O. Co. Tools String No. *13*  
 Tool Dressers *Pat ... and J. A. ...*

FORMATION	TOP	BOTTOM	Steel Line Measurements	Water Found Depth	Oil Found Depth	Gas Found Depth	REMARKS
Native Coal	284	285					1-13" x 16' Hoop Conduct.
Pittsburg Coal	700	706	700				No Little Dunkard
Little Dunkard	-	-					
Big Dunkard	1240	1280					
First Salt	1505	1500					
Second Salt	1575	1665		1600/1620			8 Bails Salt Water per Hour
Maxon	1852	1875	1788			1788	Third Salt Sand 1680-1820
Little Lime	1970	1975					3/10 Water 1/2" Opening
Pencil Cave	1995	1999					
Big Lime	1999	2065					
Big Injuu	2065	2178	2065			2104-2111	1/10 water 1" opening
Squaw	2185	2195	2104-2111			2116-2120	3/10 mercury 1" opening
Berea	-	-	2116-2120				No Berea
Gantz	2295	2400					
Fifty Foot	2530	2595					
Thirty Foot	2790	2745					
Gordon Stray	-	-					
Gordon	2829	2830	2829			2829	No Stray Sand Show of Gas in Gordon Stray Hole Reduced to 5 3/16" at 2829 feet
Fourth	None	None					
Fifth	None	None					
Bayard	None	None					
Total Depth		3099	3099				By Contractors Line By Instrument Case

SIZE	Charged to Well		Put in Well		Pulled Out		Left in Well		Transferred Before Completing		Left at Well Not in Use		If more than two strings of casing are left in hole, give reasons for leaving additional strings.
	Feet	In.	Feet	In.	Feet	In.	Feet	In.	Feet	In.	Feet	In.	
13" Csg.	-	-	-	-	-	-	-	-	-	-	-	-	10" casing will be pulled out well after pipes are completed
10" "	482	3	424	9	-	-	424	9	40	3	17	3	
8 1/2" "	1844	10	1252	3	-	-	1252	3	565	1	27	6	
6 3/8" "	2157	5	2029	10	-	-	2029	10	111	7	116	-	
5 3/16" "	3251	7	-	-	-	-	-	-	-	-	3251	7	
Tbg.													

PACKER RECORD

SIZE	KIND	Amount Anchor	Amount Above Anchor	REMARKS
1-	8 1/2" Steel Casing			Set at 1250' on Bottom 8 1/2" Casing
1-	6 7/8" "			" " " 2016' " " 6 7/8" "

SHOOTING RECORD (If shot before or upon completion of well)

DATE	Gauge	Top of Shell	Bottom of Shell	Diameter	Sand	Test Before Shot			Test After Shot			Test Taken After Shot No. Hours
						Reading	Liquid	Opening	Reading	Liquid	Opening	
1-19-15	10	2829	2833	3 3/4"	Gordon	4/10 Mercury	1"	4/10 Mercury	1"	1		
1-19-15	15	2114	2120	4"	Dequre	4/10 Mercury	1"	4/10 Mercury	1"	1		
1-19-15	15	2184	2110	4"	Dequre	4/10 Mercury	1"	4/10 Mercury	1"	1		

CEMENTING RECORD

Date Cemented..... Size Hole Cemented..... Size Casing Cemented.....  
 Top Pittsburg Coal..... Top Cementing..... Amount Cement Used.....  
 Bottom Pittsburg Coal..... Bottom Cementing..... Amount Cement Used.....  
 Mr. .... of ..... Coal Company on ground when coal was cemented  
 Remarks: *Pittsburg Coal not cemented*  
 Signature of persons *J. H. ...*  
 LOCATION BOOK  
 CONTRACTOR

017-1948

Approved by... *J. H. ...* FEB 17 1915 U.S.S.  
 Foreman