

Plot *Case V*

LATITUDE 39°27'30"

4230'

LONGITUDE 80°32'30"

1380'

L.G. ROBINSON  
HENRY SMITH

N32°E-1122'

A. HELDRETH

1/2 Set in Chestnut Stump at  
A in FE.  
N50°30'E-964'

S31°40'E-786'

(2)

Talkington Fork

14" Maple at A in FE.

S87°10'E  
1155'

\* 6401  
EL-1067'

S16°30'E-3300'

FLOYD E. GLASPELL  
38180-107d  
(Now STANTON HARBERT)

LOTS

N24°26'E-1311'

\* F-15722  
NO REC

LILLIE MARTIN

CALEB ASHCRAFT

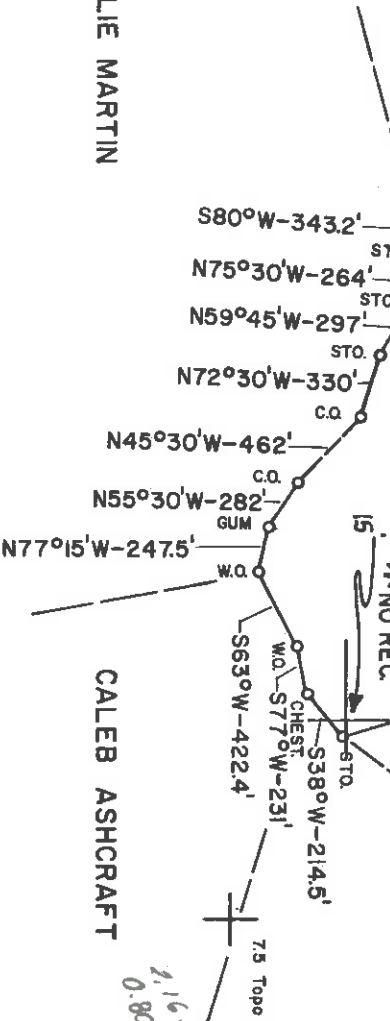

MAP SHEET 45-S2,E4 FB.2136 PG.12-14

FILE NO. \_\_\_\_\_  
 DRAWING NO. \_\_\_\_\_  
 SCALE 1"=1000'  
 MINIMUM DEGREE OF ACCURACY 1 in 200'  
 PROVEN SOURCE OF ELEVATION BM=RD. FK. ELEV. EL.=1454 FOLSOM TOPO 75

I THE UNDERSIGNED, HEREBY CERTIFY THAT THIS PLAT IS CORRECT TO THE BEST OF MY KNOWLEDGE AND BELIEF AND SHOWS ALL THE INFORMATION REQUIRED BY LAW AND THE REGULATIONS ISSUED AND PRESCRIBED BY THE DEPARTMENT OF MINES.  
 (SIGNED) *Floyd E. Glaspell*  
 R.P.E. \_\_\_\_\_ L.L.S. 211

PLACE SEAL HERE

STATE OF WEST VIRGINIA  
 DEPARTMENT OF MINES  
 OIL AND GAS DIVISION



DATE APRIL 18 1983  
 OPERATOR'S WELL NO. 6401  
 API WELL NO. 47-017-1972-Frac  
 STATE \_\_\_\_\_ COUNTY \_\_\_\_\_ PERMIT \_\_\_\_\_

(+) DENOTES LOCATION OF WELL ON UNITED STATES TOPOGRAPHIC MAPS  
 WELL TYPE: OIL \_\_\_\_\_ GAS X LIQUID INJECTION \_\_\_\_\_ WASTE DISPOSAL \_\_\_\_\_  
 (IF "GAS") PRODUCTION X STORAGE \_\_\_\_\_ DEEP \_\_\_\_\_ SHALLOW \_\_\_\_\_  
 LOCATION: ELEVATION 1067 WATER SHED TALKINGTON FORK  
 DISTRICT MCLELLAN COUNTY DODDRIDGE  
 QUADRANGLE FOLSOM 75 CENTERPOINT NE  
 SURFACE OWNER HENRY A. BROOKS ACREAGE 107d  
 OIL & GAS ROYALTY OWNER FLOYD E. GLASPELL(NOW STANTON HARBERT) LEASE ACREAGE 107d

PROPOSED WORK: DRILL \_\_\_\_\_ CONVERT \_\_\_\_\_ DRILL DEEPER \_\_\_\_\_ REDRILL \_\_\_\_\_ FRACTURE OR STIMULATE X PLUG OFF OLD FORMATION \_\_\_\_\_ PERFORATE NEW FORMATION \_\_\_\_\_ OTHER PHYSICAL CHANGE IN WELL (SPECIFY) \_\_\_\_\_

PLUG AND ABANDON \_\_\_\_\_ CLEAN OUT AND REPLUG \_\_\_\_\_  
 TARGET FORMATION \_\_\_\_\_ ESTIMATED DEPTH \_\_\_\_\_  
 WELL OPERATOR CON. GAS SUPPLY CORP. DESIGNATED AGENT L.J. TIMMS, JR.  
 ADDRESS 445 WEST MAIN STREET ADDRESS 445 WEST MAIN STREET

*Dodd. 1972 Frac.*

*Cable 15 loc  
5.045  
3.032d*



Line Item Explanation

- 1) Date of Application
- 2) Your well name and number
- 3) To be filled out by office of oil & gas
- 4A) "Oil" means natural crude oil or petroleum and other hydrocarbons, regardless of gravity, which are produced at the well in liquid form by ordinary production methods and which are not the result of condensation of gas after it leaves underground reservoirs; "Gas" means all natural gas and all other fluid hydrocarbons not defined as oil.
- 4B) "Shallow well" means any well drilled and completed in a formation above the top of the uppermost member of the "Onondaga Group" or a depth less than six thousand feet, whichever is shallower.  
"Deep well" means any well drilled and completed in a formation at or below the top of the uppermost member of the "Onondaga Group" or at a depth less than six thousand feet, whatever is shallower.
- 5) Where well is located
- 6) Before a permit can be issued in a corporation, company partnership, or fictitious name, the name must be registered with the Secretary of State Office
- 7) Use separate sheet if necessary
- 8) Present surface owner at time application is filed.
- 9) Optional
- 11) See Reg. 7.01 relating to code §22-4-1k
- 12) "Coal Operator" means any persons, firm, partnership, partnership association or corporation that proposes to or does operate a coal mine. See Note 24
- 13 & 14) As per §22-4-20; See Note 24
- 15) Work that will be attempted—A separate Form IV-2 shall not be required for fracturing or stimulating a well where fracturing or stimulating is to be part of the work for which a permit is sought and is noted as such on the Form IV-2 filed in connection therewith.
- 16) Anticipated formation for which well will be completed
- 17) Self explanatory
- 18) Depth to deepest freshwater, and shallowest salt water, taken from nearby wells corrected for differences in elevation
- 19) All coal seam depths
- 20) Proposed casing program and cementing refer to Code 22-4-5, 22-4-6, 22-4-7, 22-4-8, 22-4-8a Reg 9.01, 15.01, 15.02, 15.03, 15.04, 25.01, 25.02, 25.03, 25.04
- 21) Code 22-4-11(c) - In lieu of filing the lease or leases or other continuing contract or contracts, the applicant for a permit described herein may file the following:
  - (1) A brief description of the tract of land including the district and county wherein the tract is located;
  - (2) The identification of all parties to all leases or other continuing contractual agreements by which the right to extract, produce or market the oil or gas is claimed;
  - (3) The book and page number wherein each such lease or contract by which the right to extract, produce or market the oil or gas is recorded;
  - (4) A brief description of the royalty provisions of each such lease or contract.
- 22) Code 22-4-11(d) and 22-4-11(e).
- 23) Regulation 7.02 of the Department of Mines provides that the original and four copies of Form IV-2 must be filed with the Department, accompanied by (i) a plat in the form prescribed by Regulation 11, (ii) a bond in one of the forms prescribed by Regulation 12, or in lieu thereof the other security allowed by Code §22-4-2, (iii) Form IV-9, "Reclamation Plan", applicable to the reclamation required by Code §22-4-12b and Regulation 23, (iv) unless previously paid on the same well, the fee required by Code §22-4-12a, and (v) if applicable, the consent required by Code §22-4-8a from the owner of any water well or dwelling within 200 feet of the proposed well.
- 24) **The above named coal operator, coal owners, and coal lessee are hereby notified that any objection they wish to make or are required to make by Code §22-4-3 must be filed with the Department of Mines within fifteen (15) days after the receipt of this Application by the Department.**

The following waiver must be completed by the coal operator and by any coal owner or coal lessee who has recorded a declaration under Code 22-4-20, if the permit is to be issued within fifteen (15) days of receipt thereof.

WAIVER

The undersigned coal operator \_\_\_\_\_ / owner \_\_\_\_\_ / lessee \_\_\_\_\_ / of the coal under this well location has examined this proposed well location. If a mine map exists which covers the area of the well location, the well location has been added to the mine map. The undersigned has no objection to the work proposed to be done at this location, provided, the well operator has complied with all applicable requirements of the West Virginia Code and the governing regulations.

Date: \_\_\_\_\_, 19\_\_\_\_, By \_\_\_\_\_  
Its \_\_\_\_\_

Location Made 10-27-23  
 Rig Completed 11-19-23  
 Drilling Commenced 12-6-23  
 Rig Contractor H.W.G. Company  
 Drillers R. Long and Walter Dye  
 First Work Done 10-27-23  
 Rig Completed 12-1-23  
 Drilling Completed 1-25-24  
 Drilling Contractor H.W.G. Co. Stg. #271  
 (If H. W. Co. took, show No.)

| FORMATION                                                                                                                                                                    | Open or Close<br>Hard or Soft | TOP                                      | BOTTOM                                   | Steel Line<br>Measurements | Water Found<br>Depth | Oil Found<br>Depth | Gas Found<br>Depth | REMARKS                                                                                   |
|------------------------------------------------------------------------------------------------------------------------------------------------------------------------------|-------------------------------|------------------------------------------|------------------------------------------|----------------------------|----------------------|--------------------|--------------------|-------------------------------------------------------------------------------------------|
| active Coal<br>Gordon Stray<br>Sand<br>Idle Dunkard                                                                                                                          |                               | 340<br>450<br>715<br>870<br>1110<br>1205 | 343<br>454<br>723<br>880<br>1180<br>1225 | S. L.<br>1214              | 170                  |                    |                    | 4 ballers per hour                                                                        |
| Gas Sand<br>First Salt                                                                                                                                                       |                               | 1360<br>1420<br>1548                     | 1360<br>1500<br>1588                     |                            | 1485                 |                    |                    |                                                                                           |
| Second Salt<br>3rd Salt<br>Mazon                                                                                                                                             | none                          | 1925<br>1942<br>1958<br>2045             | 1942<br>1958<br>2045<br>2125             | 1972                       |                      |                    |                    | 2067 3/10 water on 1"<br>2117-24/10 water 1"                                              |
| Idle Linn<br>Fencil Cave<br>Big Linn<br>Big Linn<br>Big Linn<br>Squaw<br>Herein<br>Gantz<br>Fifty Feet<br>Thirty Feet<br>Gordon Stray<br>Gordon<br>Fourth<br>Fifth<br>Haydel | none                          | 2270<br>2575<br>2608<br>2705<br>2758     | 2290<br>2585<br>2625<br>2730<br>2812     | 2612<br>2761               |                      |                    |                    | 2794 to 2806 60/10 W. on 2"<br>Gordon Stray and<br>Gordon run together<br>w/ thout break. |
| Total Depth                                                                                                                                                                  |                               |                                          |                                          | 2815                       |                      |                    |                    |                                                                                           |

| SIZE       | Charged to Well |     | Put in Well |     | Pulled Out | Left in Well |     | Transferred<br>Before Completion | Left at Well<br>Not in Use |     | REMARKS |
|------------|-----------------|-----|-------------|-----|------------|--------------|-----|----------------------------------|----------------------------|-----|---------|
|            | Feet            | In. | Feet        | In. |            | Feet         | In. |                                  | Feet                       | In. |         |
| 1 3/4" CSR | 1300            | 9   | 254         |     |            | 1304         |     |                                  | 46                         | 9   |         |
| 1 1/2" "   | 1349            | 9   | 1224        |     |            | 1204         |     |                                  | 125                        |     |         |
| 8 1/2" "   | 2102            | 2   | 1988        |     |            | 1980         |     |                                  | 114                        |     |         |
| 6 1/2" "   | 2394            | 5   | 2782        |     |            | 2782         |     |                                  | 112                        | 5   |         |
| 5 1/2" "   |                 |     |             |     |            |              |     |                                  |                            |     |         |

**PACKER RECORD**

| SIZE   | KIND                     | Amount Added | Amount Above Arch | TEST BEFORE SHOT | TEST AFTER SHOT | Test Taken<br>After Shot<br>No. Hours | by Whose Sh |
|--------|--------------------------|--------------|-------------------|------------------|-----------------|---------------------------------------|-------------|
| 10     | Rhd. Protector on bottom |              | 252 Steel Line    |                  |                 |                                       |             |
| 6-1/4  | Steel shoe on bottom     |              | 1214              | db               |                 |                                       |             |
| 6-5/8  | " " " "                  |              | 1972              | db               |                 |                                       |             |
| 5-3/16 | " " " "                  |              | 2761              | db               |                 |                                       |             |

**SHOOTING RECORD (If shot holes or pipe completion of well)**

| DATE | Gauge | Top of Shot | Bottom of Shot | Diameter | Kind     | TEST BEFORE SHOT |        | TEST AFTER SHOT |        | Test Taken<br>After Shot<br>No. Hours | by Whose Sh |
|------|-------|-------------|----------------|----------|----------|------------------|--------|-----------------|--------|---------------------------------------|-------------|
|      |       |             |                |          |          | Sealing          | Liquid | Sealing         | Liquid |                                       |             |
|      |       |             |                |          | Not shot |                  |        |                 |        |                                       |             |

**CEMENTING RECORD**

Date Cemented ..... Size Hole Cemented ..... Size Casing Cemented .....  
 Top Pittsburgh Coal ..... Top Cementing ..... Amount Cement Used .....  
 Bottom Pittsburgh Coal ..... Bottom Cementing ..... Amount Sand Used .....  
 Remarks: Not cemented .....  
 Signature of persons who cemented well .....