

2-7-85

PLAT

7600'

LATITUDE 39° 15' 00"

CODE

CARD

UNNAMED BRANCH OF LEFT FORK ARNOLDS CR.

LEWIS MAXWELL
2654.88 a
WV 427

LONGITUDE 80° 45' 00"

12,800'

A-38
GW-98

A-21
GW-78

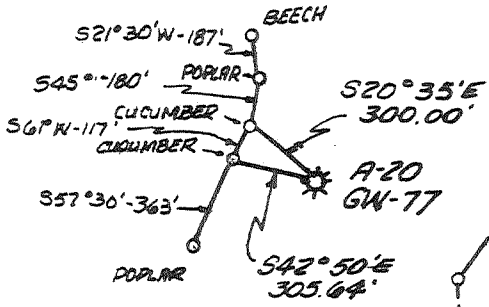

W. BRENT MAXWELL



FILE NO. _____
 DRAWING NO. W-2-84
 SCALE 1" = 660'
 MINIMUM DEGREE OF ACCURACY 1" IN 200
 PROVEN SOURCE OF ELEVATION 1200.00

I THE UNDERSIGNED, HEREBY CERTIFY THAT THIS PLAT IS CORRECT TO THE BEST OF MY KNOWLEDGE AND BELIEF AND SHOWS ALL THE INFORMATION REQUIRED BY LAW AND THE REGULATIONS ISSUED AND PRESCRIBED BY THE DEPARTMENT OF MINES.
 (SIGNED) Donald J. Bay
 R.P.E. _____ L.L.S. 247

PLACE SEAL HERE

(+) DENOTES LOCATION OF WELL ON UNITED STATES TOPOGRAPHIC MAPS
 FORM IV-6 (8-78)



DATE OCT 13, 19 84
 OPERATOR'S WELL NO. A-20, GW-77
 API WELL NO. 47-017-02190-P
 STATE COUNTY PERMIT

STATE OF WEST VIRGINIA
 DEPARTMENT OF MINES
 OIL AND GAS DIVISION

WELL TYPE: OIL ___ GAS X LIQUID INJECTION ___ WASTE DISPOSAL ___
 (IF "GAS,") PRODUCTION ___ STORAGE ___ DEEP ___ SHALLOW ___
 LOCATION: ELEVATION 1200.0' WATER SHED LEFT FORK OF ARNOLDS CREEK
 DISTRICT WEST UNION COUNTY DODDRIDGE
 QUADRANGLE OXFORD 7 1/2'
 SURFACE OWNER R.S. MAXWELL & LORENTY BOY ACREAGE 2104.68
 OIL & GAS ROYALTY OWNER LEWIS MAXWELL LEASE ACREAGE 2654.88
 LEASE NO. WV 427
 PROPOSED WORK: DRILL ___ CONVERT ___ DRILL DEEPER ___ REDRILL ___ FRACTURE OR STIMULATE ___ PLUG OFF OLD FORMATION ___ PERFORATE NEW FORMATION ___ OTHER PHYSICAL CHANGE IN WELL (SPECIFY) _____

PLUG AND ABANDON X CLEAN OUT AND REPLUG ___
 TARGET FORMATION _____ ESTIMATED DEPTH _____
 WELL OPERATOR CITIES SERVICE DESIGNATED AGENT PAUL D. PHILLIPS
 ADDRESS OIL AND GAS CORPORATION ADDRESS P.O. BX 873
P.O. BX 873 CHARLESTON WV 25329 CHARLESTON WV 25323

FEB 25 1985

LATITUDE 39° 15' 00"

100° 54' 08"

LONGITUDE

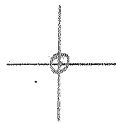

7'5 OGIS topo location

7.5' loc 2.44 S
1.47 W

15' loc 2.44 S
(calc.) 1.47 W

Company _____

Farm _____

Quad OXFORD 7 1/2' Holbrook NE

County DOORIDGE

District WEST UNION

WELL LOCATION MAP

File No. 017-2130 P

