

LATITUDE 39° 10' 00"

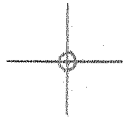

08.44.08
LONGITUDE

7'5 OGIS topo location

7.5' loc 0.80S
2.09 W

15' loc 0.80S
(calc.) 4.32W

Company _____

Farm _____

Elevation topo est. 1085'

Quad NEW MILTON 7 1/2' Vadis wa

County DODDRIDGE

District COVE



WELL LOCATION MAP

File No. 017-2199

DODD-2199

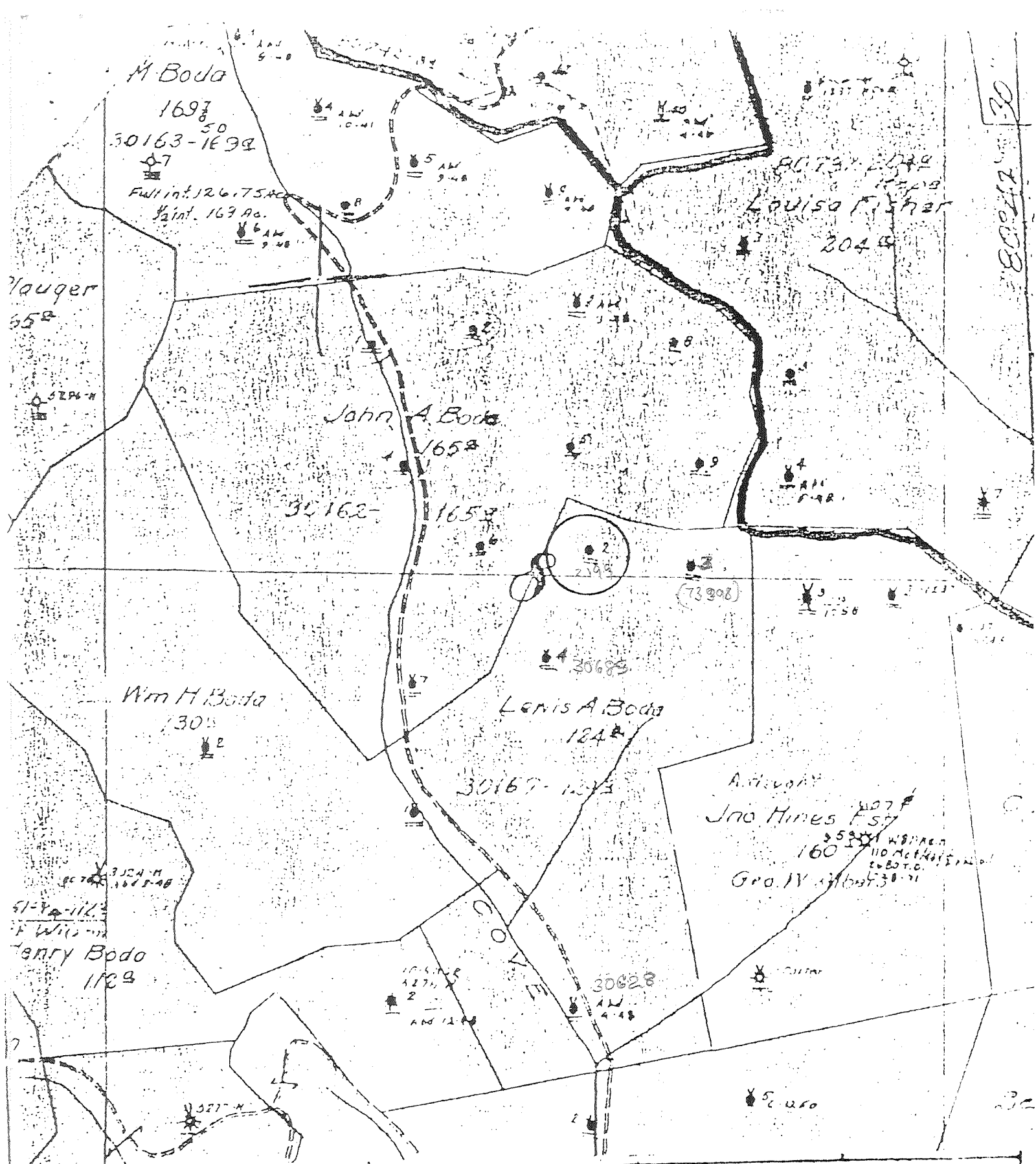

(+) DEMOTES LOCATION OF WELL ON UNITED STATES TOPOGRAPHIC MAPS
 FORM IV-B (8-78)
 7521WB

 STATE OF WEST VIRGINIA
 DEPARTMENT OF MINES
 OIL AND GAS DIVISION

DATE 1-25, 1979
 OPERATOR'S WELL NO. 2
 API WELL NO. 47-017-2199
 STATE COUNTY PERMIT

WELL TYPE: OIL GAS LIQUID INJECTION WASTE DISPOSAL
 (IF "GAS", PRODUCTION STORAGE DEEP SHALLOW
 LOCATION: ELEVATION _____ WATER SHED Cave Creek
 DISTRICT Cave COUNTY Doddridge
 QUADRANGLE New Milton 7 1/2 ACREAGE _____
 SURFACE OWNER _____ LEASE ACREAGE _____
 OIL & GAS ROYALTY OWNER _____ LEASE NO. _____
 PROPOSED WORK: DRILL CONVERT DRILL DEEPER REDRILL FRACTURE OR STIMULATE PLUG OFF OLD FORMATION PERFORATE NEW FORMATION OTHER PHYSICAL CHANGE IN WELL (SPECIFY) _____
 PLUG AND ABANDON CLEAN OUT AND REPLUS
 TARGET FORMATION _____ ESTIMATED DEPTH _____
 WELL OPERATOR Pennzoil Company DESIGNATED AGENT James A. Crews
 ADDRESS P. O. Box 1588 ADDRESS P. O. Box 1588
Parkersburg, WV 26101 Parkersburg, WV 26101

1 A Boda-2

