

4/2/79

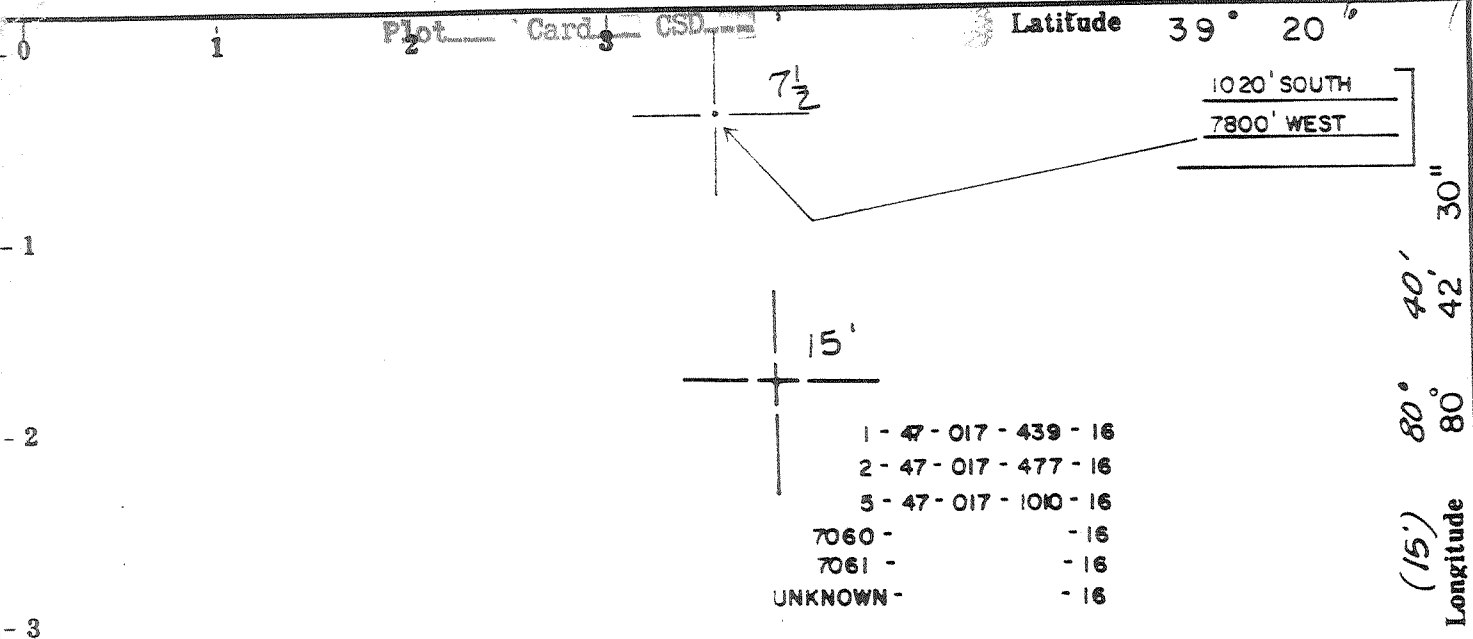

SURFACE 35.61 ACRES
JAMES E. MURPHY

MINERALS 234 ACRES
 GEORGE TURNER, AGENT
 NELLIE CUMMINS ESTATE

W.B. POLAND
 GLADYS WILSON
 ICIE RHODES, AGENT
 J. B. FORD ESTATE

ADRIAN POLAN, AGENT
 RUBY DAVIDSON ESTATE

ERROR OF CLOSURE (DEED)

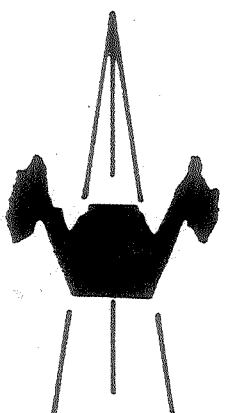
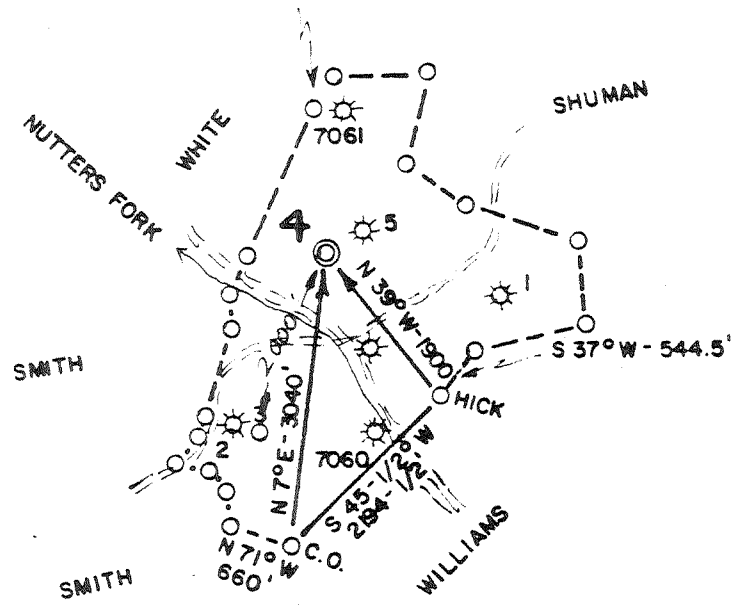

ACCURACY: 1' / 200'

Source of Elevation B.M. ON ROAD (975')

- New Location GAS
- Drill Deeper
- Abandonment
- Fracture
- Redrill

DEVONIAN SHALE - 5900'

I, the undersigned, hereby certify that this map is correct to the best of my knowledge and belief and shows all the information required by paragraph 6 of the regulations of the oil and gas section of the mining laws of West Virginia.

Chet Waterman

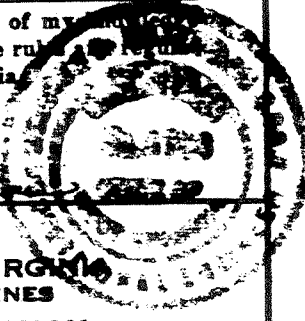

Company CARL E. SMITH, INC.
 Address SANDYVILLE, WV
 Farm E. DAVIDSON EST. ET AL (AS ABOVE)
 Tract _____ Acres 234 Lease No. _____
 Well (Farm) No. 4 Serial No. _____
 Elevation (Spirit Level) 1100'
 Quadrangle SMITHBURG (7.5' SERIES)
 County DODDRIDGE District WEST UNION
 Engineer CHET WATERMAN
 Engineer's Registration No. 3788
 File No. 79-32 Drawing No. _____
 Date 1 / 16 / 79 Scale 1" = 2000'

STATE OF WEST VIRGINIA
 DEPARTMENT OF MINES
 OIL AND GAS DIVISION
 CHARLESTON

WELL LOCATION MAP
 FILE NO. 47-017-2367

Cancelled

+ Denotes location of well on United States Topographic Maps, scale 1 to 24,000 latitude and longitude lines being represented by border lines as shown.

— Denotes one inch spaces on border line of original tracing.

MAR 26 1984

5900' Devonian

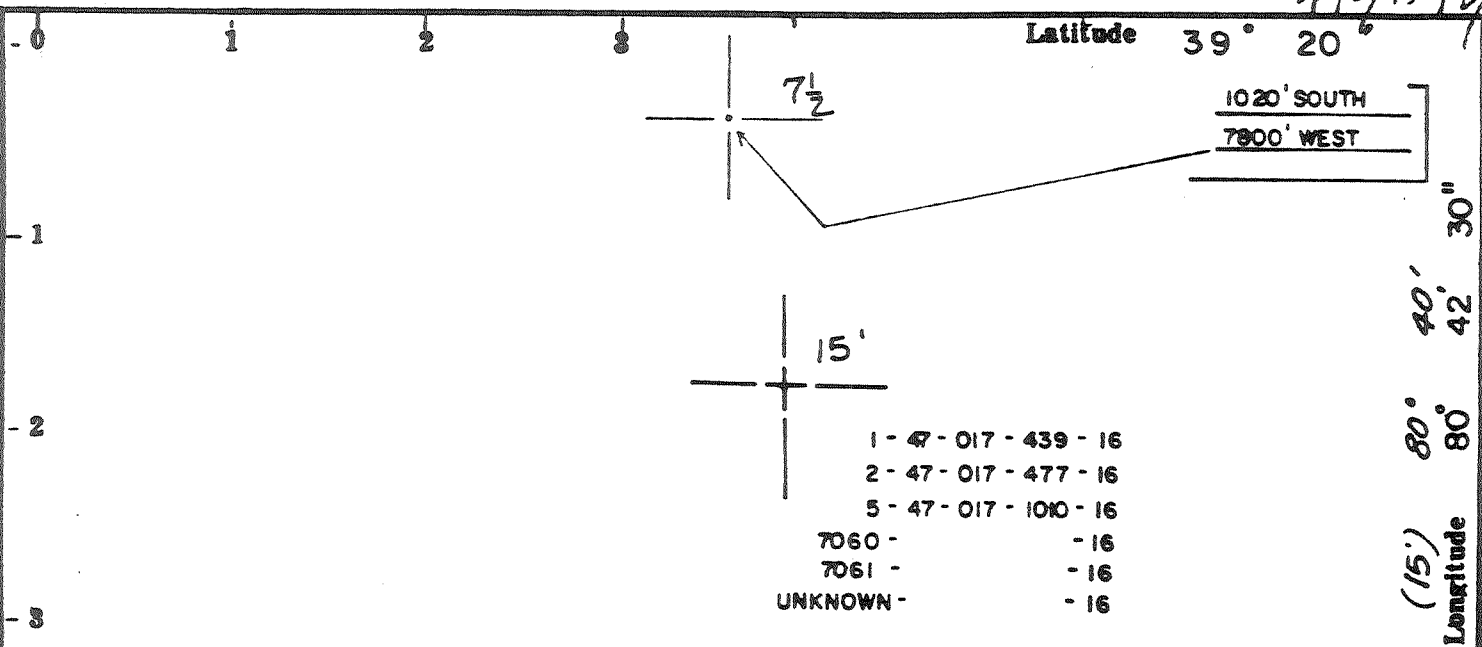

SURFACE 35.61 ACRES
JAMES E. MURPHY

MINERALS 234 ACRES
GEORGE TURNER, AGENT
NELLIE CUMMINS ESTATE

W. B. POLAND

GLADYS WILSON

ICIE RHODES, AGENT
J. B. FORD ESTATE

ADRIAN POLAN, AGENT
RUBY DAVIDSON ESTATE

ERROR OF
CLOSURE (DEED)

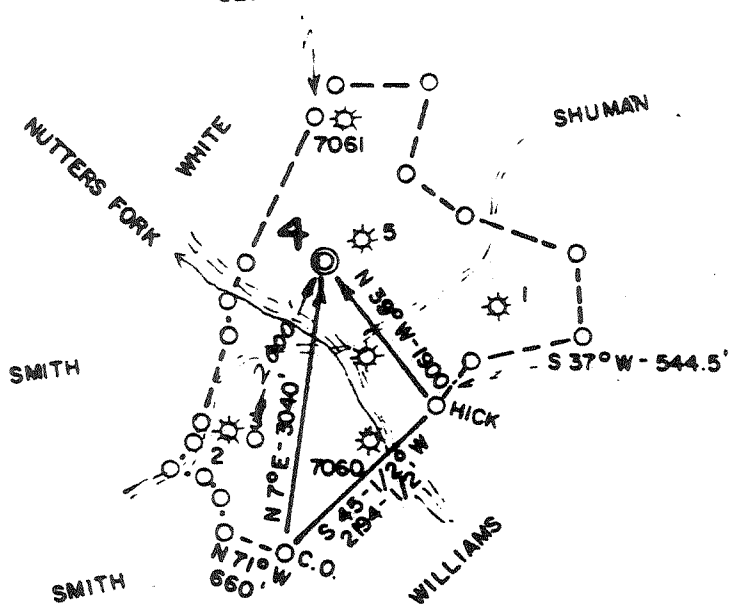

ACCURACY: 1' / 200'

Source of Elevation B.M. ON ROAD (975')

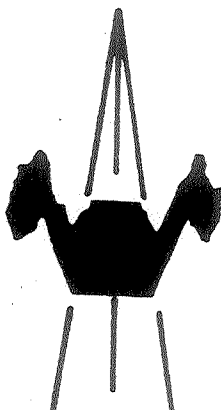

- New Location GAS
- Drill Deeper
- Abandonment
- Fracture
- Redrill

DEVONIAN SHALE - 5900'

I, the undersigned, hereby certify that this map is correct to the best of my knowledge and belief and shows all the information required by paragraph 6 of the regulations of the oil and gas section of the mining laws of West Virginia.

Chet Waterman

Company	CARL E. SMITH, INC.
Address	SANDYVILLE, WV
Farm	E. DAVIDSON EST. ET AL (AS ABOVE)
Tract	Acres 234 Lease No.
Well (Farm) No.	4 Serial No.
Elevation (Spirit Level)	1100'
Quadrangle	CENTERPOINT 75 SMITHBURG (7.5' SERIES)
County	DODDRIDGE District WEST UNION
Engineer	CHET WATERMAN
Engineer's Registration No.	3788
File No.	79-32 Drawing No.
Date	1 / 16 / 79 Scale 1" = 2000'

STATE OF WEST VIRGINIA
DEPARTMENT OF MINES
OIL AND GAS DIVISION
CHARLESTON

WELL LOCATION MAP
FILE NO. 47-017-2367

Cancelled

+ Denotes location of well on United States Topographic Maps, scale 1 to 24,000, latitude and longitude lines being represented by border lines as shown.

- Denotes one inch spaces on border line of original tracing.

4/2/79

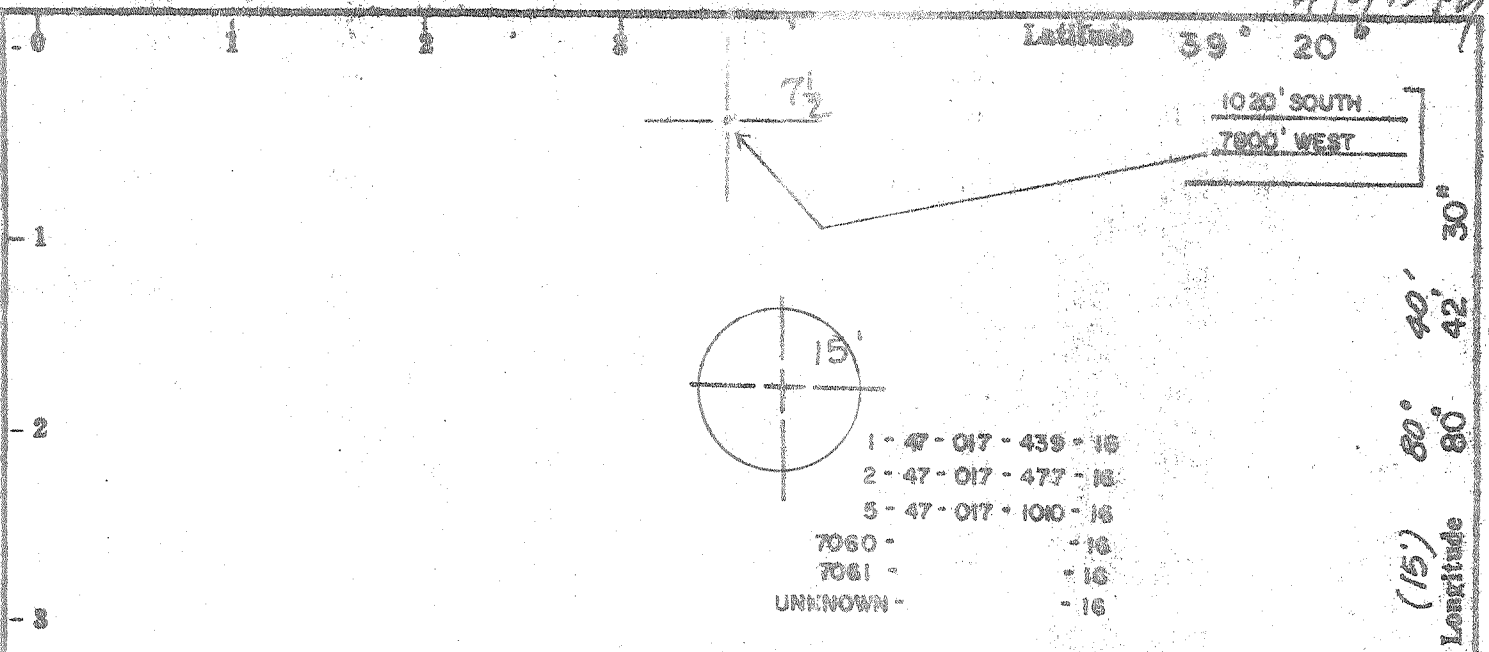

- 1 - 47 - 017 - 439 - 16
- 2 - 47 - 017 - 477 - 16
- 5 - 47 - 017 - 1010 - 16
- 7060 - - 16
- 7061 - - 16
- UNKNOWN - - 16

SURFACE 35.61 ACRES
JAMES E. MURPHY

MINERALS 234 ACRES
GEORGE TURNER, AGENT
NELLIE CUMMINS ESTATE
W. B. POLAND
GLADYS WILSON
ICIE RHODES, AGENT
J. B. FORD ESTATE
ADRIAN POLAN, AGENT
RUBY DAVIDSON ESTATE

ERROR OF CLOSURE (DEED)

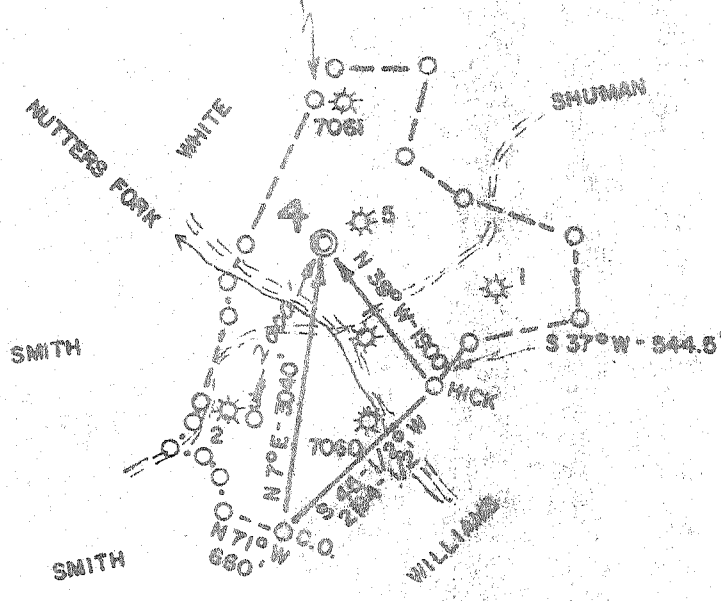

ACCURACY: 1' / 200'

Source of Elevation B.M. ON ROAD (975')

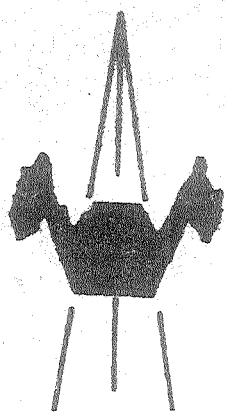

I, the undersigned, hereby certify that this map is correct to the best of my knowledge and belief and shows all the information required by paragraph 6 of the rules and regulations of the oil and gas section of the mining laws of West Virginia.

- New Location GAS
- Drill Deeper
- Abandonment
- Fracture
- Redrill

DEVONIAN SHALE - 5900'

Company CARL E. SMITH, INC.
 Address SANDYVILLE, WV
 Farm E. DAVIDSON EST. ET AL (AS ABOVE)
 Tract Acres 234 Lease No. _____
 Well (Farm) No. 4 Serial No. _____
 Elevation (Spirit Level) 1100' SW
 Quadrangle SMITHBURG (7.5' SERIES)
 County DODDRIDGE District WEST UNION
 Engineer CHET WATERMAN
 Engineer's Registration No. 3788
 File No. 79-32 Drawing No. _____
 Date 1/16/79 Scale 1" = 2000'

STATE OF WEST VIRGINIA
DEPARTMENT OF MINES
OIL AND GAS DIVISION
CHARLESTON

WELL LOCATION MAP
FILE NO. 47-017-2367

+ Denotes location of well on United States Topographic Maps, scale 1 to 24,000, latitude and longitude lines being represented by border lines as shown.

- Denotes one inch spaces on border line of original tracing.

APR 16 1979

5900' Devonian

[08-78]

OIL AND GAS WELL PERMIT APPLICATION

Operator's Well No. 4
API Well No. 47 - 017 - 2367
State County Permit

WELL TYPE: Oil / Gas X /
(If "Gas", Production X / Underground storage / Deep / Shallow X /)

LOCATION: Elevation: 1100' Watershed: Nutters Fork
District: West Union County: Doddridge Quadrangle: Smithburg 7.5'

WELL OPERATOR CARL E. SMITH, INC. DESIGNATED AGENT CARL E. SMITH, INC.
Address P. O. Box 4 Address P. O. Box 4
Sandyville, WV 25275 Sandyville, WV 25275

OIL & GAS ROYALTY OWNER E. Davidson Est., et al
Address Box 185
West Union, WV 26456
Acreage 234

COAL OPERATOR None
Address

SURFACE OWNER James E. Murphy
Address 14098 Orville St., N.W.
North Lawrence, OH 44666
Acreage 35.61

COAL OWNER(S) WITH DECLARATION ON RECORD:
Name E. Davidson Est., et al
Address Box 185
West Union, WV 26456

FIELD SALE (IF MADE) TO:
Name
Address

Name
Address

OIL & GAS INSPECTOR TO BE NOTIFIED
Name Paul Garrett
Address 321 Beech Street
Clarksburg, WV 26301

COAL LESSEE WITH DECLARATION ON RECORD:
Name None
Address
MAR 30 1979

OIL & GAS DIVISION
DEPT. OF MINES

The undersigned well operator is entitled to operate for oil or gas purposes at the above location under a deed / lease / other contract X / dated July 22, 1960, to the undersigned well operator from Hope Natural Gas Co.
[If said deed, lease, or other contract has been recorded:]

Recorded on July 26, 1960, in the office of the Clerk of the County Commission of Doddridge County, West Virginia, in Assignment Book 65 at page 191. A permit is requested as follows:

PROPOSED WORK: Drill X / Drill deeper / Redrill / Fracture or stimulate /
Plug off old formation / Perforate new formation /
Other physical change in well (specify)

--planned as shown on the work order on the reverse side hereof.

The above named coal operator, coal owner(s), and coal lessee are hereby notified that any objection they wish to make or are required to make by Code § 22-4-3 must be filed with the Department of Mines within fifteen (15) days after the receipt of this Application by the Department.

Copies of this Permit Application and the enclosed plat and reclamation plan have been mailed by registered mail or delivered by hand to the above named coal operator, coal owner(s), and coal lessee on or before the day of the mailing or delivery of this Permit Application to the Department of Mines at Charleston, West Virginia.

PLEASE SUBMIT COPIES OF ALL GEOPHYSICAL LOGS DIRECTLY TO:
WEST VIRGINIA OIL AND GAS CONSERVATION COMMISSION
1019 WASHINGTON STREET EAST
CHARLESTON, WV 25311
TELEPHONE: (304) 348-3092

BLANKET BOND

CARL E. SMITH, INC.
Well Operator
By Carl Smith
Its President

[08-78]

PROPOSED WORK ORDER

THIS IS AN ESTIMATE ONLY:
ACTUAL INFORMATION MUST BE SUBMITTED ON FORM IV-35 UPON COMPLETION

DRILLING CONTRACTOR (IF KNOWN) CARL E. SMITH, INC.

Address P. O. Box 4
Sandyville, WV 25275

GEOLOGICAL TARGET FORMATION, Devonian Sands and Shale

Estimated depth of completed well, 5900 feet Rotary / Cable tools /

Approximate water strata depths: Fresh, 150 feet; salt, 1800 feet.

Approximate coal seam depths: None expected Is coal being mined in the area? Yes / No /

CASING AND TUBING PROGRAM

CASING OR TUBING TYPE	SPECIFICATIONS				FOOTAGE INTERVALS		CEMENT FILL-UP OR SACKS (Cubic feet)	PACKERS	
	Size	Grade	Weight per ft	New	Used	For drilling			Left in well
Conductor	10 3/4"	H-40	32.75	X		250	250	125	Kinds
Fresh water									
Coal									Sizes
Intermediate	7"	K55	20	X		2200	2200	125	
Production	4 1/2"	K55	10.5	X		5900	5900	250	Depths set
Tubing									
Liners									Perforations:
									Top Bottom

NOTE: Regulation 7.02 of the Department of Mines provides that the original and four copies of Form IV-2 must be filed with the Department, accompanied by (i) a plat in the form prescribed by Regulation 11, (ii) a bond in one of the forms prescribed by Regulation 12, or in lieu thereof the other security allowed by Code § 22-4-2, (iii) Form IV-9, "Reclamation Plan", applicable to the reclamation required by Code § 22-4-12b and Regulation 23, (iv) unless previously paid on the same well, the fee required by Code § 22-4-12a, and (v) if applicable, the consent required by Code § 22-4-8a from the owner of any water well or dwelling within 200 feet of the proposed well.

A separate Form IV-2 shall not be required for fracturing or stimulating a well where fracturing or stimulating is to be part of the work for which a permit is sought and is noted as such on the Form IV-2 filed in connection therewith.

THIS PERMIT MUST BE POSTED AT THE WELL SITE

All provisions being in accordance with Chapter 22, of the W. Va. Code, the location is hereby approved

for drilling. This permit shall expire if operations have not commenced by 12-2-79

John R. [Signature]

The undersigned hereby certifies that the work proposed is regulated by the coal operator and by any coal owner or coal lessee who has recorded a declaration under Code § 22-4-20, if the permit is to be issued within fifteen (15) days of receipt thereof:

W A I V E R

The undersigned coal operator / owner / lessee / of the coal under this well location has examined this proposed well location. If a mine map exists which covers the area of the well location, the well location has been added to the mine map. The undersigned has no objection to the work proposed to be done at this location, provided, the well operator has complied with all applicable requirements of the West Virginia Code and the governing regulations.

Date: , 19

By
Its