

0.85
0.22

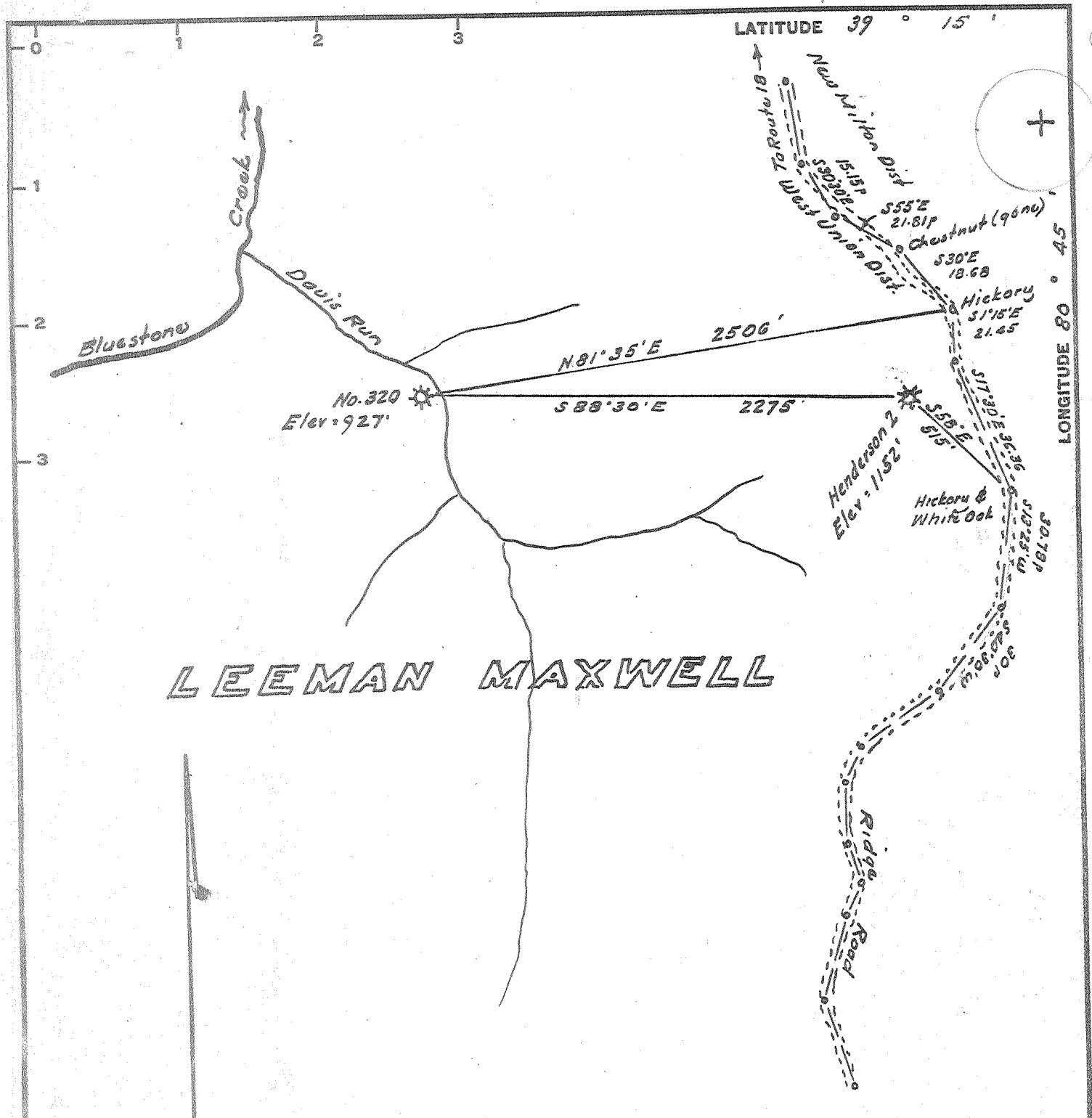

Minimum Error of Closure 1 in 200

Source of Elevation Elev. Henderson No 2 = 1152

I, the undersigned, hereby certify that this map is correct to the best of my knowledge and belief and shows all the information required by paragraph 6 of the rules and regulations of the oil and gas section of the mining laws of West Virginia.

- Fracture
- New Location
- Drill Deeper
- Abandonment

Signed: W. H. J.

Map No.

Squares: N S E W

Company Carnegie Natural Gas Co.
 Address Munhall, Penna.
 Farm Leeman Maxwell
 Tract Acres 2164 Lease No. 6764
 Well (Farm) No. 8 Serial No. 320
 Elevation (Spirit Level) 927
 Quadrangle Halbrook NE
 County Putnam District West Union
 Engineer W. H. J.
 Engineer's Registration No. 1227
 File No. _____ Drawing No. _____
 Date May 21, 1969 Scale 1" = 400' = 660'

STATE OF WEST VIRGINIA
 DEPARTMENT OF MINES
 OIL AND GAS DIVISION
 CHARLESTON

WELL LOCATION MAP
 FILE NO. DOD-35 FRAC.
2407

+ Denotes location of well on United States Topographic Maps, scale 1 to 62,500, latitude and longitude lines being represented by border lines as shown.

- Denotes one inch spaces on border line of original tracing.



STATE OF WEST VIRGINIA
DEPARTMENT OF MINES
OIL AND GAS DIVISION

Quadrangle HOLBROOK N. E. 1/4

Permit No. DOD-35-FRAC.

WELL RECORD

Oil or Gas Well Gas
(KIND)

Company CARNEGIE NATURAL GAS COMPANY
Address 3904 Main St., Munhall, Penna. 15120
Farm Leeman Maxwell Acres 2164
Location (waters) Bluestone Creek
Well No. 8 - 320 Elev. 915
District West Union County Doddridge
The surface of tract is owned in fee by Mary L. Holland
Address West Union, W. Va.
Mineral rights are owned by Leeman Maxwell Hrs.
Address _____
C.O. & Frac. 5/12/69
C.O. & Frac. 6/4/69
Date Shot _____ From _____ To _____
With _____
Open Flow _____ /10ths Water in _____ Inch
_____ /10ths Merc. in _____ Inch
Volume 133,000 _____ Cu. Ft.
Rock Pressure 119 _____ lbs. _____ hrs.
Oil _____ bbls., 1st 24 hrs.
WELL ACIDIZED _____

Casing and Tubing	Used in Drilling	Left in Well	Packers
Size			Kind of Packer
16			None
13			Size of <u>4 1/2"</u> set
10	225	-	on Steel Shoe
8 1/4	850	-	Depth set <u>1675</u>
6 5/8	1525	1525	
5 3/16			
xxx <u>4 1/2"</u>	1675	1675	Perf. top <u>1574</u>
2	1586	None	Perf. bottom <u>1636</u>
Liners Used			Perf. top _____
			Perf. bottom _____

CASING CEMENTED 4 1/2" SIZE 1675 No. Ft. 5/23/69 Date
35 Sacks Garaton Service, Jane Lew, W. Va.

COAL WAS ENCOUNTERED AT 235 FEET 0 INCHES
484 FEET 0 INCHES FEET INCHES
FEET INCHES FEET INCHES

WELL FRACTURED 6/2/69 by Dowell W/30,000# Sand & 648 bbls water in Injun Sand.

RESULT AFTER TREATMENT 1,565,000 cu. ft. 1,565 McF

ROCK PRESSURE AFTER TREATMENT 260# in 12 hrs.

Fresh Water 18 Feet Salt Water _____ Feet

Formation	Color	Hard or Soft	Top	Bottom	Oil, Gas or Water	Depth	Remarks
Coal			235	235			Blossom
Coal			484	484			Just show
1st Salt Sand			1234	1294			
Blue Monday Sand			1490	1505			
Big Lime			1505	1572	Gas show	1515	
Big Injun Sand			1572	1657	Gas	1573-85'	
Slate & Shells			1657	1675			
				1675 T.D.			

OWWO - no new footage drld

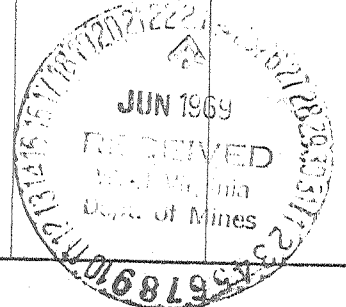

(over)

JUN 28 1969