

NORTH

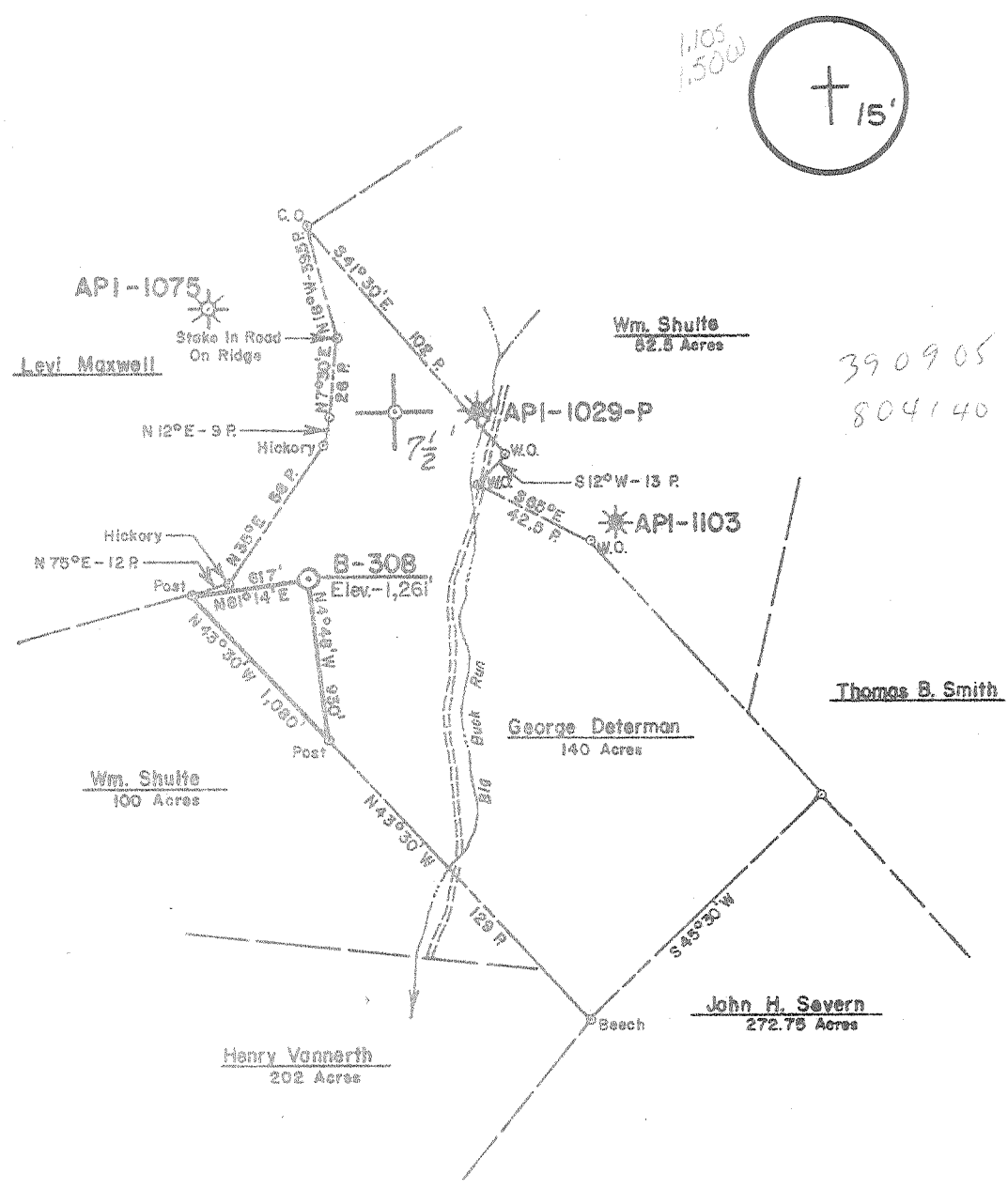

390905  
804140

FILE NO. \_\_\_\_\_  
 DRAWING NO. \_\_\_\_\_  
 SCALE 1" = 1,000'  
 MINIMUM DEGREE OF ACCURACY 1 Part In 200  
 PROVEN SOURCE OF ELEVATION Rd. Fks. Sec. Rt. 18 S S.L.S. Rt. 54 U.E.-929

I THE UNDERSIGNED, HEREBY CERTIFY THAT THIS PLAT IS CORRECT TO THE BEST OF MY KNOWLEDGE AND BELIEF AND SHOWS ALL THE INFORMATION REQUIRED BY LAW AND THE REGULATIONS ISSUED AND PRESCRIBED BY THE DEPARTMENT OF MINES.  
 (SIGNED) Daniel L. Wheeler  
 R.P.E. \_\_\_\_\_ L.L.S. 530

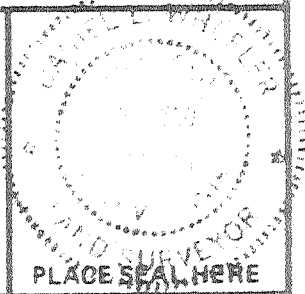

(+) DENOTES LOCATION OF WELL ON UNITED STATES TOPOGRAPHIC MAPS  
 FORM IV-6 (8-78)



DATE October 30, 19 79  
 OPERATOR'S WELL NO. B-308  
 API WELL NO. \_\_\_\_\_  
47 - 017 - 2553  
 STATE COUNTY PERMIT

STATE OF WEST VIRGINIA  
 DEPARTMENT OF MINES  
 OIL AND GAS DIVISION

WELL TYPE: OIL \_\_\_ GAS X LIQUID INJECTION \_\_\_ WASTE DISPOSAL \_\_\_  
 (IF "GAS,") PRODUCTION X STORAGE \_\_\_ DEEP \_\_\_ SHALLOW X  
 LOCATION: ELEVATION 1261' W.C. WATER SHED Big Buck Run  
 DISTRICT Cove COUNTY Doddridge  
 QUADRANGLE New Milton 7.5' VAD 15  
 SURFACE OWNER George Determan ACREAGE 140  
 OIL & GAS ROYALTY OWNER George Determan LEASE ACREAGE 140  
 LEASE NO. 2004  
 PROPOSED WORK: DRILL X CONVERT \_\_\_ DRILL DEEPER \_\_\_ REDRILL \_\_\_ FRACTURE OR STIMULATE \_\_\_ PLUG OFF OLD FORMATION \_\_\_ PERFORATE NEW FORMATION \_\_\_ OTHER PHYSICAL CHANGE IN WELL (SPECIFY) \_\_\_\_\_  
 PLUG AND ABANDON \_\_\_ CLEAN OUT AND REPLUG \_\_\_  
 TARGET FORMATION Benson ESTIMATED DEPTH 4500'  
 WELL OPERATOR J.S.J. Enterprises, Inc. DESIGNATED AGENT Berry Energy Consultants & Managers, Inc.  
 ADDRESS Berry Energy Consultants & Managers, Inc. Suite 309 Professional Bldg. Suite 309 Professional Bldg Clarksburg, W.Va 26301 ADDRESS Suite 309 Professional Bldg. Clarksburg, W.Va. 26301

SEP 19 1980

Oil and Gas Division

WELL RECORD

Rotary  Oil \_\_\_\_\_  
Cable \_\_\_\_\_ Gas   
Recycling \_\_\_\_\_ Comb. \_\_\_\_\_  
Water Flood \_\_\_\_\_ Storage \_\_\_\_\_  
Disposal \_\_\_\_\_ (Kind)

Quadrangle NEW MILTON

Permit No. DOD-2553

J & J Enterprises, Inc.

Company c/o Berry Energy Consultants, Inc.

Address 309 Professional Bldg., Clarksburg, WV

Farm George Determan Acres 140

Location (waters) Big Buck Run

Well No. B-308 Elev. 1251'

District Cove County Doddridge

The surface of tract is owned in fee by George J. Determan

Address 604 Court St., Weston, WV

Mineral rights are owned by Same

Address \_\_\_\_\_

Drilling Commenced 5-27-80

Drilling Completed 6-2-80

Initial open flow Show cu. ft. \_\_\_\_\_ bbls.

Initial production 223 M. cu. ft. per day \_\_\_\_\_ bbls.

Well open 4 hrs. before test 1350# RP.

Well treatment details: 14 days

Casing and Tubing	Used in Drilling	Left in Well	Cement fill up Cu. ft. (Sks.)
Size 20-16			
Cond. 11-3/4"	30'	30'	To surface
13-10"			
9 5/8			
8 5/8	1796'	1796'	To surface
7			
5 1/2			
4 1/2	5315'	5315'	250 sks
3			
2			
Liners Used			

Attach copy of cementing record.

Benson sand treated 7-3-80 with 60,000# sand, 690 bbl water and 500 gal acid

Perforations: 5257-5259' with 13 holes

Oil was encountered at 956' Feet 18" Inches  
Fresh water 135' Feet 3/4" stream Salt Water None Feet \_\_\_\_\_  
Producing Sand Benson Depth 5257-59'

Formation	Color	Hard or Soft	Top Feet	Bottom Feet	Oil, Gas or Water	* Remarks
Sand & Shale			0	256	Water	135' Fresh
Red Rock			256	956		
Coal			956	960		
Sand & Shale			960	1380		
Sand			1380	1510		
Sand & Shale			1510	2265		
Lime			2265	2280		
Shale & Red Rock			2280	2295		
Sand & Shale			2295	2365		
Big Lime			2365	- -		
Big Injun			- -	2520		
Sand & Shale			2520	5247		
Benson			5247	5261	Gas	5257-59'
Sand & Shale			5261	5540		
Light Brown Sand <b>ALEX.</b>			5540	5590		
Sand & Shale			5590	5728		
Total Depth drilled				5728		
Cement & gel back to				5315		

Present T.D.

J & J Enterprises, Inc.  
c/o Berry Energy Consultants, Inc.  
Clarksburg, W. Va.

By: [Signature]

(over)

Indicates Electric Log tops in the remarks section.

SEP 23 1980



STATE OF WEST VIRGINIA  
DEPARTMENT OF MINES

RECEIVED  
DEC 17 1979

Oil and Gas Division

OIL & GAS DIVISION  
DEPT. OF MINES

OIL AND GAS WELL PERMIT APPLICATION

TO THE DEPARTMENT OF MINES,  
Charleston, W. Va.

Surface Owner George J. Determan  
Address 604 Court St., Weston, WV 26452  
Mineral Owner Same  
Address \_\_\_\_\_  
Coal Owner Same  
Address \_\_\_\_\_  
Coal Operator Not Operated  
Address \_\_\_\_\_

DATE December 12, 1979  
J & J Enterprises, Inc.  
Company c/o Berry Energy Consultants & Mgrs.  
Address 308-309 Professional Bldg., Clarksburg WV  
Farm George Determan Acres 140  
Location (waters) Big Buck Run  
Well No. B-308 Elevation 1261'  
District Cove County Doddridge  
Quadrangle New Milton 7.5'

THIS PERMIT MUST BE POSTED AT THE WELL SITE

All provisions being in accordance with Chapter 22, of the W. Va. Code, the location is hereby approved for drilling. This permit shall expire if operations have not commenced by 8-18-80

INSPECTOR  
TO BE NOTIFIED Paul Garrett  
ADDRESS 321 Beech St., Clarksburg, WV 26301  
PHONE 622-3871

*Robert T. Berry*  
Deputy Director - Oil & Gas Division

GENTLEMEN:

The undersigned well operator is entitled to drill upon the above named farm or tract of land for oil and gas, having fee title thereto, (or as the case may be) under grant or lease dated June 9 1978 by George J. Determan, et ux made to W. B. Berry and recorded on the 30th day of October 1978 in Doddridge County, Book 105 Page 309

NEW WELL  DRILL DEEPER  REDRILL  FRACTURE OR STIMULATE  
OIL AND GAS WELL ORIGINALLY DRILLED BEFORE JUNE 5, 1969.

The enclosed plat was prepared by a registered engineer or licensed land surveyor and all coal owners and/or operators have been notified as of the above date.

The above named coal owners and/or operator are hereby notified that any objection they wish to make, or are required to make by Section 3 of the Code, must be received by, or filed with the Department of Mines within ten (10) days. \*

Copies of this notice and the enclosed plat were mailed by registered mail, or delivered to the above named coal operators or coal owners at their above shown respective address Same day \_\_\_\_\_ before, or on the same day with the mailing or delivery of this copy to the Department of Mines at Charleston, West Virginia.

PLEASE SUBMIT COPIES OF ALL  
GEOPHYSICAL LOGS DIRECTLY TO:

WEST VIRGINIA GEOLOGICAL AND  
ECONOMIC SURVEY  
P. O. BOX 879  
MORGANTOWN, WEST VIRGINIA 26505  
AC-304 - 292-6331

Address  
of  
Well Operator

Very truly yours, J & J Enterprises, Inc.  
(Sign Name) c/o Berry Energy Consultants & Mgrs  
Well Operator

308-309 Professional Building  
Street  
Clarksburg, WV 26301  
City or Town

BY: *W. B. Berry*

\*SECTION 3 . . . . If no objections are filed or found by the Department of mines, within said period of ten days from the receipt of notice and plat by the department of mines, to said proposed location, the department shall forthwith issue to the well operator a permit reciting the filing of such plat, that no objections have been made by the coal operators or found thereto by the department and that the same is approved and the well operator authorized to proceed.

47-017-2553

PERMIT NUMBER

"I have read and understand the reclamation requirements as set forth in Chapter 22, Article 4, Section 12-b and will carry out the specified requirements."

Signed by \_\_\_\_\_

BLANKET BOND

