

FILE NO. _____
DRAWING NO. _____
SCALE 1" = 500'
MINIMUM DEGREE OF ACCURACY 1 PART IN 200
PROVEN SOURCE OF ELEVATION INT. RT. 54 & RT. 54 1/2
ELEV. - 868'

I THE UNDERSIGNED, HEREBY CERTIFY THAT THIS PLAT IS CORRECT TO THE BEST OF MY KNOWLEDGE AND BELIEF AND SHOWS ALL THE INFORMATION REQUIRED BY LAW AND THE REGULATIONS ISSUED AND PRESCRIBED BY THE DEPARTMENT OF MINES.

(SIGNED) [Signature]
R.P.E. _____ L.L.S. 530

PLACE SEAL HERE

(+) DENOTES LOCATION OF WELL ON UNITED STATES TOPOGRAPHIC MAPS
FORM IV-6 (8-78)



STATE OF WEST VIRGINIA
DEPARTMENT OF MINES
OIL AND GAS DIVISION

DATE FEBRUARY 8, 19 80
OPERATOR'S WELL NO. K-307-1
API WELL NO. 47-017-2867
STATE COUNTY PERMIT

Permit No. 617-2601

WELL TYPE: OIL ___ GAS X LIQUID INJECTION ___ WASTE DISPOSAL ___
(IF "GAS,") PRODUCTION X STORAGE ___ DEEP ___ SHALLOW X
LOCATION: ELEVATION 1190' WATER SHED LITTLE TOMS FORK
DISTRICT NEW MILTON COUNTY DODDRIDGE
QUADRANGLE NEW MILTON 7.5' 1/4 15' NW
SURFACE OWNER ALBERT HINTERER ACREAGE 44.5
OIL & GAS ROYALTY OWNER ALBERT HINTERER LEASE ACREAGE 44.5
LEASE NO. K-307
PROPOSED WORK: DRILL X CONVERT ___ DRILL DEEPER ___ REDRILL ___ FRACTURE OR STIMULATE X PLUG OFF OLD FORMATION ___ PERFORATE NEW FORMATION ___ OTHER PHYSICAL CHANGE IN WELL (SPECIFY) _____

PLUG AND ABANDON ___ CLEAN OUT AND REPLUG ___
TARGET FORMATION ALEXANDER ESTIMATED DEPTH 5,150'
WELL OPERATOR J & J ENTERPRISES, INC. DESIGNATED AGENT HARRY BARNETT
ADDRESS P.O. BOX 48 BUCKHANNON, W. VA. 26201 ADDRESS P.O. BOX 48 BUCKHANNON, W. VA. 26201
DEC 19 1980

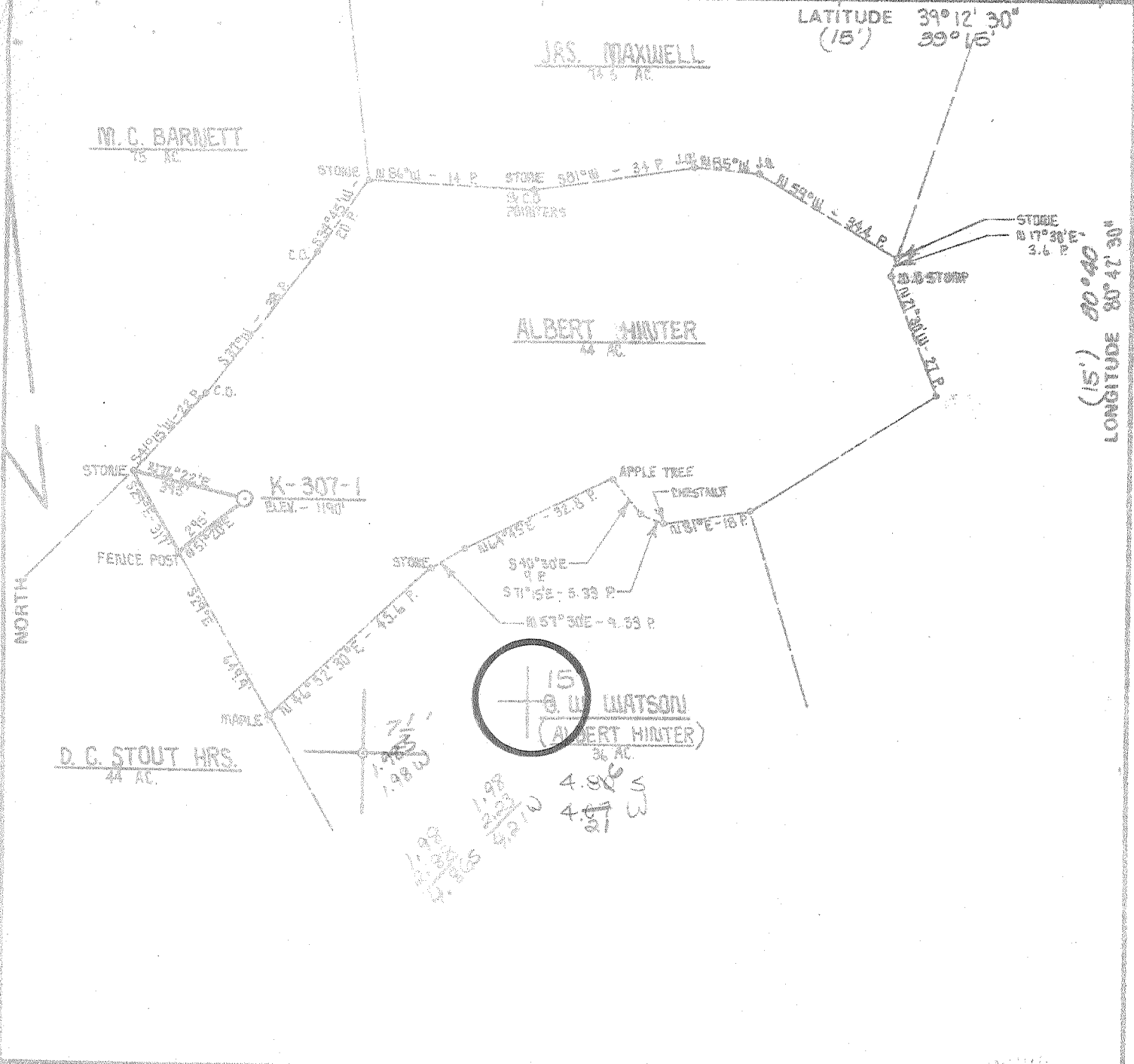

FILE NO. _____
 DRAWING NO. _____
 SCALE 1" = 500'
 MINIMUM DEGREE OF ACCURACY 1 PART IN 200
 PROVEN SOURCE OF ELEVATION INT. RT. 54 & RT. 54 1/2
ELEV. - 868'

I THE UNDERSIGNED, HEREBY CERTIFY THAT THIS PLAT IS CORRECT TO THE BEST OF MY KNOWLEDGE AND BELIEF AND SHOWS ALL THE INFORMATION REQUIRED BY LAW AND THE REGULATIONS ISSUED AND PRESCRIBED BY THE DEPARTMENT OF MINES.
 (SIGNED) Kevin L. Wheeler
 R.P.E. _____ L.L.S. 530



(+) DENOTES LOCATION OF WELL ON UNITED STATES TOPOGRAPHIC MAPS
 FORM IV-6 (8-78)



STATE OF WEST VIRGINIA
 DEPARTMENT OF MINES
 OIL AND GAS DIVISION

DATE FEBRUARY 8, 19 80
 OPERATOR'S WELL NO. K-307-1
 API WELL NO. 47 - 017 - 2601
 STATE COUNTY PERMIT
now: 017-2867

WELL TYPE: OIL ___ GAS X LIQUID INJECTION ___ WASTE DISPOSAL ___
 (IF "GAS,") PRODUCTION X STORAGE ___ DEEP ___ SHALLOW X
 LOCATION: ELEVATION 1190' WATER SHED LITTLE TONS FORK
 DISTRICT NEW MILTON COUNTY DODDRIDGE
 QUADRANGLE NEW MILTON T15, V4018 15 NW
 SURFACE OWNER ALBERT MINTER ACREAGE 44.5
 OIL & GAS ROYALTY OWNER ALBERT MINTER LEASE ACREAGE 44.5
 LEASE NO. K-307

PROPOSED WORK: DRILL X CONVERT ___ DRILL DEEPER ___ REDRILL ___ FRACTURE OR STIMULATE X PLUG OFF OLD FORMATION ___ PERFORATE NEW FORMATION ___ OTHER PHYSICAL CHANGE IN WELL (SPECIFY) _____

PLUG AND ABANDON ___ CLEAN OUT AND REPLUG ___
 TARGET FORMATION ALEXANDER ESTIMATED DEPTH 5,150'
 WELL OPERATOR J & L ENTERPRISES, INC. DESIGNATED AGENT HARRY BARNETT
 ADDRESS P.O. BOX 48 BUCKHANNON, W. VA. 26201 ADDRESS P.O. BOX 48 BUCKHANNON, W. VA. 26201

STATE OF WEST VIRGINIA
DEPARTMENT OF MINES, OIL AND GAS DIVISION

Date: January 7, 1981

FORM IV-35
(Obverse)

Operator's
Well No. J-113

[08-78,

WELL OPERATOR'S REPORT II
OF
DRILLING, FRACTURING AND/OR STIMULATING, OR PHYSICAL CHANGE

API Well No. 47 - 017 - 2867
State County Permit

WELL TYPE: Oil / Gas / Liquid Injection / Waste Disposal
(If "Gas", Production / Underground storage / Deep / Shallow)

LOCATION: Elevation: 1190 Watershed: Little Toms Fork
District: New Milton County: Doddridge Quadrangle: New Milton 7.5'

WELL OPERATOR J & J Enterprises, Inc. DESIGNATED AGENT H.L. Barnett
Address Box 48 Address Box 48
Buckhannon, WV 26201 Buckhannon, WV 26201

PERMITTED WORK: Drill / Convert / Drill deeper / Redrill / Fracture or stimulate
Plug off old formation / Perforate new formation
Other physical change in well (specify) _____

PERMIT ISSUED ON 11/7, 1980

OIL & GAS INSPECTOR FOR THIS WORK:

(IF APPLICABLE: PLUGGING OF DRY HOLE ON
CONTINUOUS PROGRESSION FROM DRILLING OR
REWORKING. VERBAL PERMISSION OBTAINED

Name Paul Garrett
Address 321 Beech St.
Clarksburg, WV 26301

GEOLOGICAL TARGET FORMATION: Alexander Depth 5330-5430 feet

Depth of completed well, 5616 feet Rotary / Cable Tools

Water strata depth: Fresh 1700 feet; salt 1665-1710 feet.

Coal seam depths: None Is coal being mined in the area? no

Work was commenced 11/7, 1980, and completed 11/12, 1980

CASING AND TUBING PROGRAM

CASING OR TUBING TYPE	SPECIFICATIONS				FOOTAGE INTERVALS		CEMENT FILL-UP OR SACKS (Cubic feet)	PACKERS	
	Size	Grade	Weight per ft	New	Used	For drilling		Left in well	Top
Conductor	113/4	H-40	42	x		34	34	0 sks.	Minds
Fresh water	8 5/8	ERW	23	x		1737.15	1737.15	425 sks.	
Coal	8 5/8	ERW	23	x		1737.15	1737.15	425 sks.	Sizes
Intermediate									
Production	4 1/2	J-55	10.5	x		5176	5176	640 sks.	Depth set
Tubing									
Liners									Perforations:
									2419 2474
									2814 2827
									4223 4227
									4662 5102
									3499 3599

RECEIVED
JAN - 8 1981

OPEN FLOW DATA

OIL & GAS DIVISION

Producing formation BENSON & 1st RILEY DEPT. OF MINES Pay zone depth 4662-5102 feet

Gas: Initial open flow, _____ Mcf/d Oil: Initial open flow, _____ Bbl/d

Combined Final open flow, 298 Mcf/d Final open flow, _____ Bbl/d

Time of open flow between initial and final tests, 96 hours

Static rock pressure, 900 psig (surface measurement) after 4 hours shut in

[if applicable due to multiple completion--]

4223 4227
3477 3599

Second producing formation Bradford, Warren, Gordon, & Weir Pay zone depth 2814 2827 feet

Gas: Initial open flow, _____ Mcf/d Oil: Initial open flow, _____ Bbl/d

Final open flow, _____ Mcf/d Final open flow, _____ Bbl/d

Time of open flow between initial and final tests, _____ hours

Static rock pressure, _____ psig (surface measurement) after _____ hours shut in

JAN 26 1981

[08-78]

DETAILS OF PERFORATED INTERVALS, FRACTURING OR STIMULATING, PHYSICAL CHANGE, ETC.

Benson & Riley: 4662-5102 (11 holes)
Fracturing: 150 sks. 80/100 sand:280 sks. 20/40 sand:500 Bbls. fluid

Bradford: 4223-4228
Fracturing: 500 gal. Acid:100 sks 80/100 sand:200 sks. 20/40 sand:350 Bbls.fluid:

Warren: 3477-3599 (14 holes)
Fracturing:500 gal. Acid:150 sks. 80/100 sand:280 sks. 20/40 sand:300 Bbls.fluid

Gordon & Weir: 2812-2827(7 holes) 2419-2474 (7 holes)
Fracturing: 1000 gal. Acid: 150 sks. 80/100 sand:280 sks. 20/40 sand: 500 Bbls. fluid.

WELL LOG

FORMATION	Color	Hard or Soft	Top Feet	Bottom Feet	Remarks Including indication of all fresh and salt water, coal, oil and gas
Red rock & shale			0	15	
Sand & shale			15	25	
Sand & shale			25	106	Damp @ 68'
Sand, shale & red rock			106	135	Damp @ 325'
Sand, shale & red rock			135	163	
Sand & shale			163	190	
Red rock & sand			190	205	
Red rock, sand & shale			205	305	
Red rock, sand & shale			305	390	
Red rock, sand & shale			390	625	Damp @ 620
Sand & shale			625	720	
Red rock & shale			720	790	1/2" stream @ 1700'
Sahle & red rock			790	820	Ck gas @ 2300 No show
Shale & red rock			820	930	Ck gas @ 2581 10/10-1/2" w/water
Shale & red rock			930	990	5,953 cu.ft.
Red rock & shale			990	1050	Ck gas @ 4872 No show
Red rock & shale			1050	1100	
Red rock, sand & shale			1100	1200	Ck gas @ 5122 No show
Sand & shale			1200	1575	
Salt sand			1575	1635	Ck gas @ 5461 4/10-1/2" w/water
Sand & shale			1635	1665	3,765 cu. ft.
Salt sand			1665	1710	
Sand, shale & red rock			1710	2035	
Little lime			2035	2045	
Sand & shale			2045	2140	
Big Lime			2140	2170	
Injun			2170	2265	
Sand & shale			2265	2419	
Gordon			2419	2474	
Sand & shale			2474	2812	
Weir			2812	2827	
Sand & shale			2827	3477	
Warren			3477	3599	
Sand & shale			3599	4223	
Bradford			4223	4228	
Sand & shale			4228	4662	
Benson			4662	5005	

(Attach separate sheets to complete as necessary)

J & J Enterprises, Inc.
Well Operator
By Peter Battles
Peter Battles
Its Geologist

NOTE: Regulation 2.02(i) provides as follows:

"The term 'log' or 'well log' shall mean a systematic, detailed geological record of all formations, including coal, encountered in the drilling of a well."

017-2867

FORMATION	Color	Hard or Soft	 Top Feet	Bottom Feet	Remarks Including indication of all fresh and salt water, coal, oil and gas
Sand & shale			5005	5099	
Riley ?			5099	5102	
Sand & shale			5102	5330	
Alexander			5330	5430	
Shale			5330	5430	
Shale			5430	5616 TD	

(Attach separate sheets to complete as necessary)

JAN 26 1981

[08-78]

OIL AND GAS WELL PERMIT APPLICATION

Operator's Well No. K-307-#1
API Well No. 47-017-2601
State County Permi
now: 017-2867

WELL TYPE: Oil / Gas X /
(If "Gas", Production X / Underground storage / Deep / Shallow X /)
LOCATION: Elevation: 1190 Watershed: Little Toms Fork
District: New Milton County: Doddridge Quadrangle: New Milton 7.5'

WELL OPERATOR J & J Enterprises, Inc.
Address P. O. Box 48
Buckhannon, W. Va. 26201

DESIGNATED AGENT H. L. Barnett
Address P. O. Box 48
Buckhannon, W. Va. 26201

OIL & GAS ROYALTY OWNER Albert Hinterer
Address Route 1, Box 77
New Milton, W. Va. 26411
Acreage 44.5

COAL OPERATOR None
Address

SURFACE OWNER Albert Hinterer
Address Route 1, Box 77
New Milton, W. Va. 26411
Acreage 44.5

COAL OWNER(S) WITH DECLARATION ON RECORD:
Name Albert & Ernest Hinterer
Address Route 1, Box 77
New Milton, W. Va. 26411
Name
Address

FIELD SALE (IF MADE) TO:
Name
Address

COAL LESSEE WITH DECLARATION ON RECORD:
Name None
Address

OIL & GAS INSPECTOR TO BE NOTIFIED
Name Paul Garrett
Address 321 Beech St.
Clarksburg, W. Va. 26301

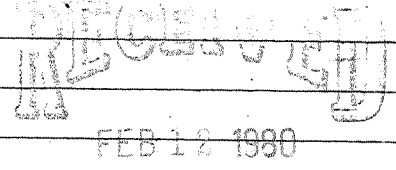

OIL & GAS DIVISION
DEPT. OF MINES

The undersigned well operator is entitled to operate for oil or gas purposes at the above location under a deed / lease X / other contract / dated September 11, 1978, to the undersigned well operator from Albert & Mamie Hinterer

[If said deed, lease, or other contract has been recorded:]
Recorded on October 23, 1978, in the office of the Clerk of the County Commission of Doddridge County, West Virginia, in OIL & GAS LEASE Book 105 at page 191. A permit is requested as follows:

PROPOSED WORK: Drill X / Drill deeper / Redrill / Fracture or stimulate X /
Plug old formation / Perforate new formation /
Other physical change in well (specify)

--Planned location of the work order on the reverse side hereof.

The above named well operator, coal owner(s), and coal lessee are hereby notified that any changes they wish to make or are required to make by Code § 22-4-3 must be filed with the Department of Mines within fifteen (15) days after the receipt of this Application by the Department.

Copies of this Permit Application and the enclosed plat and reclamation plan have been mailed by registered mail or delivered by hand to the above named coal operator, coal owner(s), and coal lessee on or before the day of the mailing or delivery of this Permit Application to the Department of Mines at Charleston, West Virginia.

PLEASE SUBMIT COPIES OF ALL
GEOPHYSICAL LOGS DIRECTLY TO:
WEST VIRGINIA OIL AND GAS
CONSERVATION COMMISSION
601 WASHINGTON STREET EAST
CHARLESTON, WV 25311
TELEPHONE: (304) 348-3092

J & J ENTERPRISES, INC.
Well Operator

By Peter Battles
PETER BATTLES
Its GEOLOGIST

[08-78]

PROPOSED WORK ORDER

THIS IS AN ESTIMATE ONLY:
ACTUAL INFORMATION MUST BE SUBMITTED ON FORM IV-35 UPON COMPLETION

DRILLING CONTRACTOR (IF KNOWN) S. W. Jack Drilling Company

Address P. O. Box 48
Buckhannon, W. Va. 26201

GEOLOGICAL TARGET FORMATION, Alexander

Estimated depth of completed well, 5580 feet Rotary / Cable tools /

Approximate water strata depths: Fresh, 80 feet; salt, 1400 feet.

Approximate coal seam depths: None Is coal being mined in the area? Yes / No /

CASING AND TUBING PROGRAM

CASING OR TUBING TYPE	SPECIFICATIONS				FOOTAGE INTERVALS		CEMENT FILL-UP OR SACKS (Cubic feet)	PACKERS	
	Size	Grade	Weight per ft	New	Used	For drilling		Left in well	Kinds
Conductor	11 3/4	H-40	42	X		30	30	0 sks.	None
Fresh water	8 5/8	ERW	23	X		1500	1500	280 sks.	
Coal	8 5/8	ERW	23	X		1500	1500	280 sks.	Sizes
Intermediate									
Production	4 1/2	J-55	10.5	X		5530	5530	320 sks.	Deaths set
Tubing									
Liners									Perforations:
									Top Bottom

NOTE: Regulation 7.02 of the Department of Mines provides that the original and four copies of Form IV-2 must be filed with the Department, accompanied by (i) a plat in the form prescribed by Regulation 11, (ii) a bond in one of the forms prescribed by Regulation 12, or in lieu thereof the other security allowed by Code § 22-4-2, (iii) Form IV-9, "Reclamation Plan", applicable to the reclamation required by Code § 22-4-12b and Regulation 23, (iv) unless previously paid on the same well, the fee required by Code § 22-4-12a, and (v) if applicable, the consent required by Code § 22-4-8a from the owner of any water well or dwelling within 200 feet of the proposed well.

A separate Form IV-2 shall not be required for fracturing or stimulating a well ~~THIS PERMIT MUST BE POSTED AT THE WELL SITE~~ if fracturing or stimulating is to be part of the work for which a permit is sought and is noted as such in connection therewith.

All provisions being in accordance with Chapter 22, of the W. Va. Code, the location is hereby approved for drilling. This permit shall expire if operations have not commenced by 10-13-80

Robert T. [Signature]
Deputy Director - Oil & Gas Division

... by the coal operator and by any coal owner or coal leasee who has recorded a declaration under Code § 22-4-20, if the permit is to be used within fifteen (15) days of receipt thereof:

W A I V E R

The undersigned coal operator / owner / lessee / of the coal under this well location has examined this proposed well location. If a mine map exists which covers the area of the well location, the well location has been added to the mine map. The undersigned has no objection to the work proposed to be done at this location, provided, the well operator has complied with all applicable requirements of the West Virginia Code and the governing regulations.

Date: , 19

By
Its

[08-78]

OIL AND GAS WELL PERMIT APPLICATION

Operator's Well No. J-113 API Well No. 47-017-2867 State County Permit

WELL TYPE: Oil / Gas x/ (If "Gas", Production x/ Underground storage / Deep / Shallow x/) LOCATION: Elevation: 1190 Watershed: Little Toms Fork District: New Milton County: Doddridge Quadrangle: New Milton 7.5'

WELL OPERATOR J & J Enterprises, Inc. Address P.O. Box 48 Buckhannon, WV 26201

DESIGNATED AGENT H.L. Barnett Address P.O. Box 48 Buckhannon, WV 26201

OIL & GAS LEASE & GAS LEASE OWNER Albert Hinterer Address Route 1, Box 77 New Milton, WV 26411

COAL OPERATOR None Address

ACREAGE 44.5 SURFACE OWNER Albert Hinterer Address Route 1, Box 77 New Milton, WV 26411 Acreage 44.5

COAL OWNER(S) WITH DECLARATION ON RECORD: Name Albert & Ernest Hinterer Address Route 1, Box 77 New Milton, WV 26411

FIELD SALE (IF MADE) TO: Name Unknown Address

COAL LESSEE WITH DECLARATION ON RECORD: Name None Address RECEIVED NOV -7 1980

OIL & GAS INSPECTOR TO BE NOTIFIED Name Paul Garrett Address 321 Beech St. Clarksburg, WV 26301

OIL & GAS DIVISION DEPT. OF MINES

The undersigned well operator is entitled to operate for oil or gas purposes at the above location under a deed / lease x/ other contract / dated Sept. 11, 1978; to the undersigned well operator from Albert & Mamie Hinterer

[If said deed, lease, or other contract has been recorded:] Recorded on Oct. 23, 1978, in the office of the Clerk of the County Commission of Doddridge County, West Virginia, in Oil & Gas lease Book 105 at page 191. A permit is requested as follows:

PROPOSED WORK: Drill x/ Drill deeper / Redrill / Fracture or stimulate x/ Plug off old formation / Perforate new formation / Other physical change in well (specify)

--planned as shown on the work order on the reverse side hereof.

The above named well operator, coal owner(s), and coal lessee are hereby notified that any action they wish to take or are required to make by Code § 22-4-3 must be filed with the Department of Mines within fifteen (15) days after the receipt of this Application by the Department.

Copies of this Permit Application and the enclosed plat and reclamation plan have been mailed by registered mail or delivered by hand to the above named coal operator, coal owner(s), and coal lessee or before the day of the mailing or delivery of this Permit Application to the Department of Mines at Charleston, West Virginia.

PLEASE SUBMIT COPIES OF ALL PHYSICAL LOGS DIRECTLY TO: WEST VIRGINIA OIL AND GAS CONSERVATION COMMISSION 100 WASHINGTON STREET EAST CHARLESTON, WV 25311 TELEPHONE: (304) 345-3092

BLANKET BOND

J & J Enterprises, Inc. Well Operator By Peter Battles Peter Battles

PROPOSED WORK ORDER

THIS IS AN ESTIMATE ONLY: ACTUAL INFORMATION MUST BE SUBMITTED ON FORM IV-35 UPON COMPLETION

DRILLING CONTRACTOR (IF KNOWN) S.W. Jack Drilling Company
Address P.O. Box 48
Buckhannon, WV 26201

GEOLOGICAL TARGET FORMATION, Alexander

Estimated depth of completed well, 5580 feet Rotary x / Cable tools /
Approximate water strata depths: Fresh, 80 feet; salt, 1400 feet.
Approximate coal seam depths: None Is coal being mined in the area? Yes / No x

CASING AND TUBING PROGRAM

Table with columns: CASING OR TUBING TYPE, SPECIFICATIONS (Size, Grade, Weight, New, Used), FOOTAGE INTERVALS (For drilling, Left in well), CEMENT FILL-UP OR SACKS (Cubic feet), PACKERS (Types, Sizes, Depths set, Perforations: Top, Bottom)

NOTE: Regulation 7.02 of the Department of Mines provides that the original and four copies of Form IV-2 must be filed with the Department, accompanied by (i) a plat in the form prescribed by Regulation 11, (ii) a bond in one of the forms prescribed by Regulation 12, or in lieu thereof the other security allowed by Code § 22-4-2, (iii) Form IV-9, "Reclamation Plan", applicable to the reclamation required by Code § 22-4-12b and Regulation 23, (iv) unless previously paid on the same well, the fee required by Code § 22-4-12a, and (v) if applicable, the consent required by Code § 22-4-8a from the owner of any water well or dwelling within 200 feet of the proposed well.

A separate Form IV-2 shall not be required for fracturing or stimulating a well where fracturing or stimulating is to be part of the work for which a permit is sought and is included in the permit application.

All provisions being in accordance with Chapter 22, of the W. Va. Code, the location is hereby approved for drilling. This permit shall expire if operations have not commenced by 7-7-81

[Signature]
Deputy Director - Oil & Gas Division

The applicant must be certified by the coal operator and by any coal owner or coal lessee who has recorded a declaration under Code § 22-4-20, if the permit is to be issued within fifteen (15) days of receipt thereof:

W A I V E R

The undersigned coal operator / owner / lessee / of the coal under this well location has examined this proposed well location. If a mine map exists which covers the area of the well location, the well location has been added to the mine map. The undersigned has no objection to the work proposed to be done at this location, provided, the well operator has complied with all applicable requirements of the West Virginia Code and the governing regulations.

By
Its