

Latitude 39° 15' 00"

3,900 SOUTH
3,920 WEST

TO P.

Longitude 80° 40' 00"

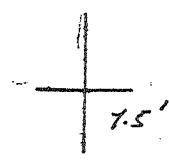

NICHOLSON

RANDOLPH

HICKORY

WOLFE

WARNER

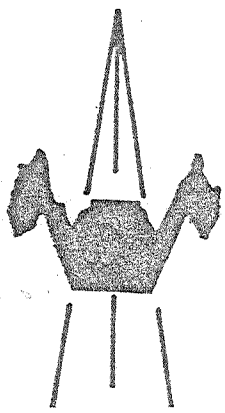
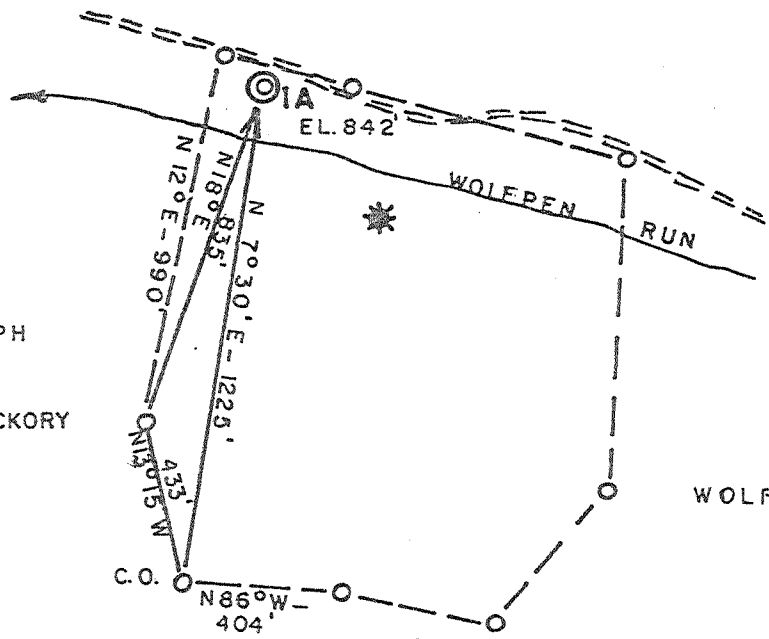

ACCURACY: 1 / 200

- New Location
- Drill Deeper
- Abandonment
- Fracture
- Redrill
- Other

Formation WEIR Oil
 Est. Depth 2100' Gas
 Other

Source of Elevation WELL NO. 1 (966')

I, the undersigned, hereby certify that this map is correct to the best of my knowledge and belief and shows all the information required by paragraph 6 of the rules and regulations of the oil and gas section of the mining laws of West Virginia.

Chet Waterman

Company UNITED OPERATING CO.
 Address CHARLESTON, WV
 Surface Owner S. L. MCCLAIN
 Mineral Owner " " "

Well No. 1A Acres 29
 Elevation 842'

Quadrangle VADIS Series 7.5
 County DODDRIDGE District NEW MILTON
 Date 12/5/80 Scale 1" = 500'

STATE OF WEST VIRGINIA
 DEPARTMENT OF MINES
 OIL AND GAS DIVISION
 CHARLESTON

WELL LOCATION MAP
47 - 017 - 2901-P
 STATE COUNTY PERMIT

+ Denotes location of well on United States Topographic Maps.
 Engineer CHET WATERMAN
 Engineer's Registration No. 3788 File No. 80-733

Weir 2250

MAY 2 A 1981

Latitude $39^{\circ} 15' 00''$



0.755
483W
0.73W
3.900 SOUTH
3.920 WEST



Longitude $80^{\circ} 40' 00''$

39 14 20
80 40 55

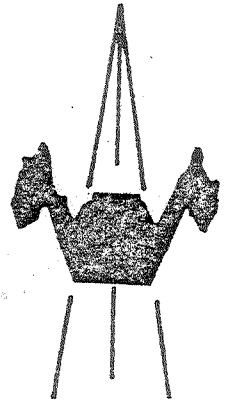
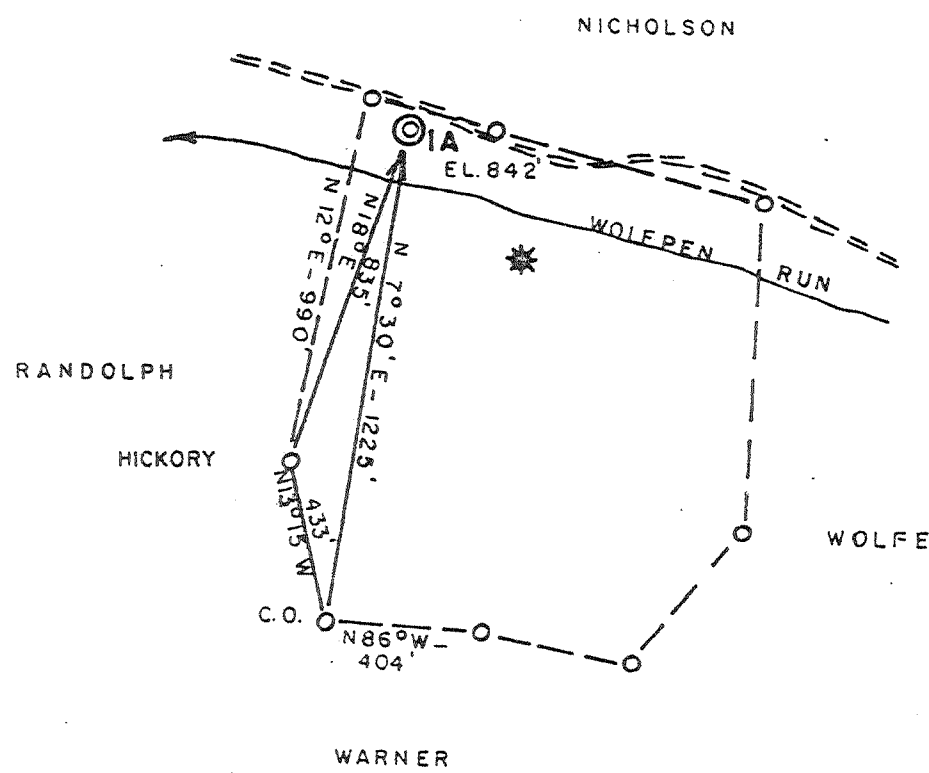

ACCURACY: 1 / 200

- New Location
- Drill Deeper
- Abandonment
- Fracture
- Redrill
- Other

Formation WEIR Oil
 Est. Depth 2100' Gas
 Other

Source of Elevation WELL NO. 1 (966')
 I, the undersigned, hereby certify that this map is correct to the best of my knowledge and belief and shows all the information required by paragraph 6 of the rules and regulations of the oil and gas section of the mining laws of West Virginia.

Chet Waterman

Company UNITED OPERATING CO.
 Address CHARLESTON, WV
 Surface Owner S. L. MCCLAIN
 Mineral Owner " " "

Well No. 1A Acres 29
 Elevation 842' NW

Quadrangle VADIS Series 7.5 ± 15
 County DODDRIDGE District NEW MILTON
 Date 12/5/80 Scale 1" = 500'

STATE OF WEST VIRGINIA
 DEPARTMENT OF MINES
 OIL AND GAS DIVISION
 CHARLESTON

WELL LOCATION MAP
47 - 017 - 2901
 STATE COUNTY PERMIT

+ Denotes location of well on United States Topographic Maps.
 Engineer CHET WATERMAN
 Engineer's Registration No. 3788 File No. 80-733

*6-0 New Milton North (144)
 Weir 2250*

JAN 12 1981



STATE OF WEST VIRGINIA
DEPARTMENT OF MINES

Oil and Gas Division

WELL RECORD

RECEIVED
APR 20 1981

Quadrangle Vadis 7.5'
Permit No. 47-017-2901

Rotary Oil _____
Cable _____ Gas
Refring _____ Comb. _____
Water Flood _____ Storage _____
Disposal _____ (Kind) _____

Company United Operating Company
Address 600 Commerce Sq., Charleston, W. Va.
Farm Stacy McClain Acres 29
Location (waters) Wolf Pen Run-Meathouse Fork
Well No. McClain 1-A Elev. 842
District New Milton County Doddridge
The surface of tract is owned in fee by _____
Stacy McClain
Address New Milton, W. Va.
Mineral rights are owned by Stacy McClain
Address New Milton, W. Va.
Drilling Commenced 1-5-81
Drilling Completed 1-9-81
Initial open flow DRY, DRY, DRY!! cu. ft. _____ bbls.
Final production _____ cu. ft. per day _____ bbls.
Well open _____ hrs. before test _____ RP.

Casing and Tubing	Used in Drilling	Left in Well	Cement fill up Cu. ft. (Sks.)
Size 20-16			
Cond. 13-10"			
9 5/8			
8 5/8	225	225	circulated
7			
5 1/2			
4 1/2			
3			
2			
Liners Used			

Well treatment details:

DRY, DRY, DRY

Attach copy of cementing record.

Coal was encountered at _____ Feet _____ Inches
Fresh water _____ Feet _____ Salt Water _____ Feet _____
Producing Sand _____ Depth _____

Formation	Color	Hard or Soft	Top Feet	Bottom Feet	Oil, Gas or Water	* Remarks
Sand-Shale	G.	H.	0	1150		
Gas sand	G.	H.	1150	1165		
Shale	G.	S	1165	1230		
1st Salt sand	G	H	1230	1255		
Shale	G	S	1255	1275		
2nd Salt Sand	G	H	1275	1350		
Shale	G	S	1350	1375		
3rd Salt Sand	G	H	1375	1430		
Sand-shale	G	H	1430	1810		
Pencil cave	G	S	1810	1830		
Lime	G	H	1830	1942		
Big Injun	G	H	1942	1980		

(over)

* Indicates Electric Log tops in the remarks section.

MAY 26 1981

Formation	Color	Hard or Soft	Top Feet	Bottom Feet	Oil, Gas or Water	Remarks
Shale	G	H	1980	2120		
Weir ✓	"	M	2120	2190		
Shale			2190	2238	T.D.	
						DRY...PLUG AND ABANDON

Date March 31 1981

APPROVED _____ **United Operating Company** General

By J. L. [Signature] President

[08-78]

OIL AND GAS WELL PERMIT APPLICATION

Operator's Well No. McClain #1-A

API Well No. 47-017-2901

WELL TYPE: Oil / Gas

(If "Gas", Production / Underground storage / Deep / Shallow

LOCATION: Elevation: 842 Watershed: Wolf Pen Run of Meathouse Fork

District: New Milton County: Doddridge Quadrangle: Vadis

WELL OPERATOR United Operating Company
Address 600 Commerce Square
Charleston, WV 25301

DESIGNATED AGENT Jack Trittippo/Lyle Coffman
Address 600 Commerce Sq./ Norris Road
Charleston, WV/ Glenville, WV

OIL & GAS ROYALTY OWNER Stacy McClain et al
Address New Milton, W. Va.

COAL OPERATOR NA

Address _____

Area No. 29

SURFACE OWNER Stacy McClain
Address New Milton

COAL OWNER(S) WITH DECLARATION TO BE FILED:

Name _____

Address _____

Area No. 29

Name _____

Address _____

FIELD SALE (IF APPLICABLE):

Name _____
Address _____

COAL LESSEE WITH DECLARATION TO BE FILED:

Name _____

Address _____

ALL GAS INSPECTOR TO BE NOTIFIED

Name _____
Address _____

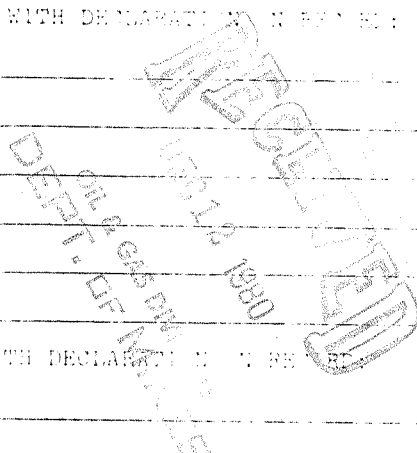

The undersigned well operator is entitled to operate for oil or gas pursuant to the location under a deed / lease / other contract / dated November 2, 1975.
Undersigned well operator from P&M Oil Company to Pigott Heirs/thence to United Operating Company
(If deed, lease, or other contract has been recorded):

Recorded on June 28, 1976; in the office of the Clerk of the County of Doddridge County, West Virginia, in Lease Book 101 at page 1.

PROPOSED WORK: Drill / Drill deeper / Redrill / Plug off old formation / Perforate new formation / Other physical change in well (specify) _____

--obtained as shown on the work order on the reverse side hereof.
The above named coal operator, coal owner(s), and coal lessee are hereby notified that any physical change which is required to make by Code § 2-2-4 must be filed with the Department of Mines within fifteen (15) days after the receipt of this Application by the Department.

Filed of this Permit Application and the enclosed plat and regulations on hereinafter mentioned well shall be followed by hand to the above named coal operator, coal owner(s), and coal lessee at the time of the willing or delivery of this Permit Application to the Department of Mines, Charleston, West Virginia.

PLEASE PRINT NAME OF ALL OWNERS OF PHYSICAL OR DIRECTLY OWNED INTEREST IN WELL
WEST VIRGINIA OIL AND GAS DEPARTMENT
100 WASHINGTON STREET EAST
CHARLESTON, WV 25301
TELEPHONE: 336-2200

BLANKET BOND

United Operating Company
Well Operator

BY J. L. Trittippo (J. L. Trittippo)
President

[08-78]

PROPOSED WORK ORDER

THIS IS AN ESTIMATE ONLY:
ACTUAL INFORMATION MUST BE SUBMITTED ON FORM IV-35 UPON COMPLETION

DRILLING CONTRACTOR (IF KNOWN) _____

Address _____

GEOLOGICAL TARGET FORMATION, Weir

Estimated depth of completed well, 2250 feet Rotary / Cable tools _____ /

Approximate water strata depths: Fresh, 75 feet; salt, _____ feet.

Approximate coal seam depths: _____ **Is coal being mined in the area? Yes _____ / No _____**

CASING AND TUBING PROGRAM

CASING OR TUBING TYPE	SPECIFICATIONS					FOOTAGE INTERVALS		CEMENT FILL-UP OR SACKS (Cubic feet)	PACKERS
	Size	Grade	Weight per ft	New	Used	For drilling	Left in well		
Conductor									Kinds
Fresh water									
Coal									Sizes
Intermediate	8-5/8	H	24	X		300	300	to surface	
Production	4 1/2	K or ERW	10.5	x		2250	2250	1,000 foot	Depths set
Tubing									
Liners									Perforations:
									Top Bottom

NOTE: Regulation 7.02 of the Department of Mines provides that the original and four copies of Form IV-2 must be filed with the Department, accompanied by (i) a plat in the form prescribed by Regulation 11, (ii) a bond in one of the forms prescribed by Regulation 12, or in lieu thereof the other security allowed by Code § 22-4-2, (iii) Form IV-9, "Reclamation Plan", applicable to the reclamation required by Code § 22-4-12b and Regulation 23, (iv) unless previously paid on the same well, the fee required by Code § 22-4-12a, and (v) if applicable, the consent required by Code § 22-4-8a from the owner of any water well or drilling within 200 feet of the proposed well.

A separate Form IV-2 shall not be required for fracturing or stimulating a well where fracturing or stimulating is to be part of the work for which a permit is sought and is noted as such on the Form IV-2 filed in connection therewith.

All provisions being in accordance with Chapter 22, of the W. Va. Code, the location is hereby approved for drilling. This permit shall expire if operations have not commenced by 8-15-81

J. J. Murray
Deputy Director - Oil & Gas Division

The following waiver must be completed by the coal operator and by any coal owner or coal lessee who has recorded a declaration under Code § 22-4-20, if the permit is to be issued within fifteen (15) days of receipt thereof:

W A I V E R

The undersigned coal operator _____ / owner _____ / lessee _____ / of the coal under this well location has examined this proposed well location. If a mine map exists which covers the area of the well location, the well location has been added to the mine map. The undersigned has no objection to the work proposed to be done at this location, provided, the well operator has complied with all applicable requirements of the West Virginia Code and the governing regulations.

Date: _____, 19 _____

By _____
Its _____
Sweeney

RECEIVED
APR 20 1981
OIL & GAS DIVISION
DEPT. OF MINES

STATE OF WEST VIRGINIA
DEPARTMENT OF MINES, OIL AND GAS DIVISION

AFFIDAVIT OF PLUGGING AND FILLING WELL

WELL TYPE: Oil Gas / Liquid Injection / Waste Disposal /
(If "Gas", Production / Underground storage / Deep / Shallow /

LOCATION: Elevation: 842 Watershed: Wolf Pen Run of Meathouse Fork
District: New Milton County: Doddridge Quadrangle: Varis 7.5'

WELL OPERATOR: United Operating Company
Address: 600 Commerce Square
Charleston, WV 25301

DESIGNATED AGENT: J. L. Trittipio
Address: 600 Commerce Square
Charleston, WV 25301

STATE OF WEST VIRGINIA,)
COUNTY OF Gilmer) SS:

J. M. Morton (Dowell) and Lyle T. Coffman (United)

being first duly sworn according to law, depose and say that they are experienced in the work of plugging and filling oil and gas wells; that they were employed by United Operating Company the well operator, and participated in the work of plugging and filling the above well; that the work was commenced on January 9, 1981, and completed on January 9, 1981, in the following manner:

PERMITTED WORK: Plug and abandon / Clean out and replug /

PLUGGING MATERIALS

Type of Cement	Other Materials	Depth	Thickness
Neat		2200' 2100'	90
Neat		1960 2050	90
Neat		210 300 90	90 90

Bridge Plugs Used--Type and Depth
Surface

VENT PIPE

MISCELLANEOUS MATERIALS

CASING LOST 225' 8-5/8" left in

TYPE OF RIG: hole

Owner: Well Op'r / Contractor /

Rig time: days plus 6 hours

COAL SEAMS (NAMES AND DEPTHS)

DESCRIPTION OF WELL MONUMENT

7" Monument to be set

State Inspector was present during plugging work.

J. M. Morton (SEAL)
Lyle T. Coffman (SEAL)
DD

Subscribed and sworn to before me this
3rd day of April, 1981.

My commission expires Dec 12, 1990.

William H. Luke
Notary Public