

LATITUDE 39° 15'

LONGITUDE 80° 50'

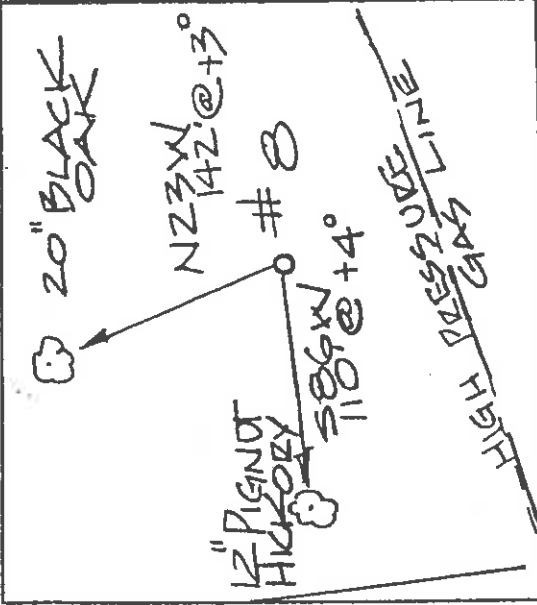

JOHN MAYHORN

SARAH HANSFORD



HARRY SMITH

47-017-2342

354.75'

1029' ELEV

47-017-2371

(+) DENOTES LOCATION OF WELL ON UNITED STATES TOPOGRAPHIC MAPS

FILE NO. _____
 DRAWING NO. _____
 SCALE 1" = 500'
 MINIMUM DEGREE OF ACCURACY 1:200
 PROVEN SOURCE OF ELEVATION 47-017-2371
 ELEV. 1029'

I, THE UNDERSIGNED, HEREBY CERTIFY THAT THIS PLAT IS CORRECT TO THE BEST OF MY KNOWLEDGE AND BELIEF AND SHOWS ALL THE INFORMATION FURNISHED BY THE REGULATIONS ISSUED BY THE DEPARTMENT OF MINES AND RECONSTRUCTION OF THE DEPARTMENT OF ENERGY AND MINES, WEST VIRGINIA. (SIGNED) *[Signature]*

R.P.E. I.S. 551

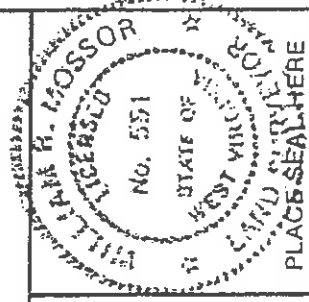

STATE OF WEST VIRGINIA
 DEPARTMENT OF ENERGY
 DIVISION OF OIL AND GAS



DATE 29 FEBRUARY 2000
 OPERATOR'S WELL NO. #8
 API WELL NO. 47-017-04540

WELL TYPE: OIL GAS LIQUID INJECTION WASTE DISPOSAL
 (IF "GAS") PRODUCTION STORAGE DEEP SHALLOW
 LOCATION: ELEVATION 1134' WATER SHED CABIN RUN COUNTY DORRIDGE
 DISTRICT CENTRAL QUADRANGLE OXFORD
 SURFACE OWNER DENNIS W. HART
 OIL & GAS ROYALTY OWNER RICHARD CUNNINGHAM, JR.
 LEASE NO. _____ ACREAGE 65

PROPOSED WORK: DRILL CONVERT DRILL DEEPER REDRILL FRACTURE OR STIMULATE PLUG OFF OLD FORMATION PERFORATE NEW FORMATION OTHER PHYSICAL CHANGE IN WELL (SPECIFY) _____

PLUG AND ABANDON CLEAN OUT AND REPLUG
 TARGET FORMATION WEIR ESTIMATED DEPTH 2600'
 WELL OPERATOR OHIO L & M CO, INC. DESIGNATED AGENT JEFF SAYGER
 ADDRESS P.O. BOX 80 ADDRESS 16 FOXHILL TERRACE
 RENO, OHIO 45773 PARKERSBURG, WV 26101

State of West Virginia
Division of Environmental Protection
Section of Oil and Gas

Well Operator's Report of Well Work

Farm name: Dennis Hart Operator Well No.: Cunningham #8

LOCATION: Elevation: 1134' G.L. Quadrangle: Oxford

District: Central County: Doddridge
Latitude: 5510 Feet South of 80 Deg. 50 Min. Sec.
Longitude 3140 Feet West of 34 Deg. 15 Min. Sec.

Company: Ohio L&M Co. Inc.

4150 Belden Village NW Suite	Casing & Tubing	Used in drilling	Left in well	Cement fill up Cu. Ft.
Address: 410	10-3/4"	40'	0'	N/A
Canton, OH 44718	7"	468	468	75 Sk.
Agent: Jeff Sayger	4-1/2"		2579	75 Sk.s.
Inspector: Mike Underwood				
Date Permit Issued: 3-16-00				
Date Well Work Commenced: 4-20-00				
Date Well Work Completed: 4-25-00				
Verbal Plugging:	1-1/2"		2475	N/A
Date Permission granted on:				
Rotary X Cable Rig				
Total Depth (feet): 2625'	<div style="border: 2px solid black; padding: 5px; width: fit-content; margin: 0 auto;"> RECEIVED Office of Oil & Gas Permitting AUG 21 2000 WV Division of Environmental Protection </div>			
Fresh Water Depth (ft.): None Found				
Salt Water Depth (ft.): Dusted to TD				
Is coal being mined in area (N/Y)?				
Coal Depths (ft.): None				

OPEN FLOW DATA

Producing formation Weir Pay zone depth (ft) 2385-2476
 Gas: Initial open flow -- MCF/d Oil: Initial open flow -- Bbl/d
 Final open flow 5 MCF/d Final open flow 1.0 Bbl/d
 Time of open flow between initial and final tests Hours
 Static rock Pressure 425 psig (surface pressure) after 24 Hours
 Second producing formation Big Injun Pay zone depth (ft)
 Gas: Initial open flow -- MCF/d Oil: Initial open flow -- Bbl/d
 Final open flow -- MCF/d Final open flow -- Bbl/d
 Time of open flow between initial and final tests Hours
 Static rock Pressure 150 psig (surface pressure) after 40 Hours
 *Not Productive

NOTE: ON BACK OF THIS FORM PUT THE FOLLOWING: 1). DETAILS OF PERFORATED INTERVALS, FRACTURING OR STIMULATING, PHYSICAL CHANGE, ETC. 2). THE WELL LOG WHICH IS A SYSTEMATIC DETAILED GEOLOGICAL RECORD OF ALL FORMATIONS, INCLUDING COAL ENCOUNTERED BY THE WELLBORE.

Signed: *Martin L. Miller*
 By: Martin L. Miller
 Date: Aug. 16, 2000

0000 4540

AUG 25 2000

WELL: Ohio L & M Co., Inc.#8 Cunningham.

COPY

LOCATION: Central District, Doddridge County, West Virginia.

PERMIT NUMBER: Doddridge-4540.

ELEVATION: 1134' Ground 1137'KB.

STATUS: Preparing to complete as an oil and gas producer.

CASING: 7" @ 468'.

TOTAL DEPTH: 2625' Driller 2627' Logger.

CONTRACTOR: Century Drilling Co..

TOOLS: Rotary.

SPUD DATE: 4/20/2000.

COMPLETED DRILLING: 4/25/2000.

FORMATION AT TOTAL DEPTH: Mississippian shale.

ELECTRICAL SURVEYS: Gamma Ray-Compensated Density-Epithermal Neutron-Caliper-Temperature-Induction by Allegheny Wireline Services, Inc.

SHOWS: Good to very good hydrocarbon fluorescence was noted in the Injun, Squaw and Weir. A more detailed description of the above mentioned fluorescence can be found on the attached Formation Evaluation Log.

FORMATION TOPS:

1st Salt Sand	1616'	-	479
2nd Salt Sand	1770'	-	633
3rd Salt Sand	1936'	-	799
Maxon sandstone	Absent		
Big Lime (Greenbrier)	2061'	-	924
Injun sandstone	2128'	-	991
Squaw sandstone	2180'	-	1043
Weir sandstone	2359'	-	1222

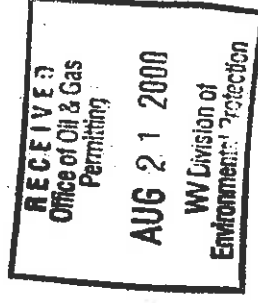

AUG 25 2000

COPY

CUNNINGHAM #8

Page 2

STRUCTURAL COMPARISON:

	Ohio L&M Co., Inc.	Ohio L&M Co., Inc.
	Cunningham #8	Cunningham #7
Big Lime	- 924	- 936
Weir sandstone	- 1222	- 1238

GEOLOGY:

Sample analysis indicated very good to excellent sandstone development in the Injun, Squaw and Weir. Good to very good hydrocarbon fluorescence was noted in the Injun, Squaw and Weir.

The log analysis showed 3 potential zones in this well. The calculations are as follows:

Zone	Net thickness	Average porosity	Water saturation
Injun sandstone	13'	11%	18%
Squaw sandstone	14'	13%	25%
Weir sandstone	92'	8%	24%

The Cunningham #8 should be a good to very good producer of oil and gas from the Weir sandstone. Prior to abandonment, the Injun and Squaw should be tested.

Respectfully submitted,



NATIONAL MINERALS CORPORATION

By: Douglas L. Core, President

April 26, 2000.

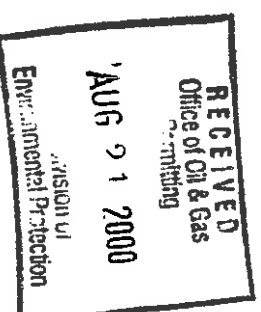

0000 4540