

LONG. 80° 40' 53.7" → 4220'

UTM CO-ORDS
X = 527475
Y = 4345184

W.O. N68W

LATITUDE 39° 17' 30"

379.5 W.O. EVANS
N63W 594'

KELLEY

S3E 775.5

STONE

N83W 297

EVANS

S56W

BEECH W.O.

N1-30E 825'

HICK

SURF. MARY LOU HOLLAND

HICK

N42E 363'

KELLEY

MAXWELL

78.125 AC. LEASE

N8E 441.38

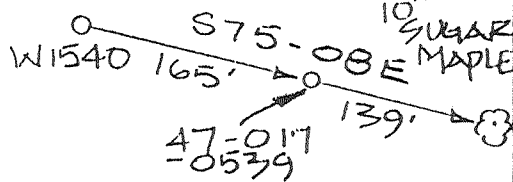

W-1540 ELEV 1187'

W.O. N38E 214.5'

S75-08E 165'

CO.

047-017-0539

N47E 676.5

45% 60

BEECH

S31-24E 547'

INTER. FNC ESTONE LINE

4597

2700

2.31
.79

STONE LINE

N10E 462

4587

1346

539

2220

W.O.

N42E 330'

4523

4598 629

N45E 379.5

RO KELLEY N23E 66'

CUCUMBER

(+) DENOTES LOCATION OF WELL ON UNITED STATES TOPOGRAPHIC MAPS

FILE NO. _____
DRAWING NO. _____
SCALE 1" = 500'
MINIMUM DEGREE OF ACCURACY 1:200
PROVEN SOURCE OF ELEVATION GPS SURVEY

I THE UNDERSIGNED, HEREBY CERTIFY THAT THIS PLAT IS CORRECT TO THE BEST OF MY KNOWLEDGE AND BELIEF AND SHOWS ALL THE INFORMATION REQUIRED BY LAW AND THE REGULATIONS ISSUED UNDER THE SUPERVISION OF THE DEPARTMENT OF ENERGY AND NATURAL RESOURCES.
(SIGNED) [Signature]
R.P.E. _____ P.S. 551



PLACE SEAL HERE

STATE OF WEST VIRGINIA
DEPARTMENT OF ENERGY
DIVISION OF OIL AND GAS



DATE 22 JUNE 20 01
OPERATOR'S WELL NO. W-1540
API WELL NO. _____

WELL TYPE: OIL _____ GAS LIQUID INJECTION _____ WASTE DISPOSAL _____
(IF "GAS,") PRODUCTION STORAGE _____ DEEP SHALLOW _____

LOCATION: ELEVATION 1187' WATER SHED SUGAR CAMP RUN
DISTRICT NEW MILTON COUNTY DODDRIDGE

QUADRANGLE SMITHBURG
SURFACE OWNER MARY LOU HOLLAND ACREAGE 78.125
OIL & GAS ROYALTY OWNER FRANKLIN R. MAXWELL HEIRS LEASE ACREAGE 78.125

PROPOSED WORK: DRILL CONVERT _____ DRILL DEEPER _____ REDRILL _____ FRACTURE OR STIMULATE _____ PLUG OFF OLD FORMATION _____ PERFORATE NEW FORMATION _____ OTHER PHYSICAL CHANGE IN WELL (SPECIFY) _____

PLUG AND ABANDON _____ CLEAN OUT AND REPLUG _____

TARGET FORMATION TRENTON - WASH ESTIMATED DEPTH BASEMENT

WELL OPERATOR TRANS-CAPITAL INVEST DESIGNATED AGENT GERALD LAUDERMAN
ADDRESS HC 68 BOX 14 ADDRESS HC 68 BOX 14A
SMITHVILLE, WV 26178 SMITHVILLE, WV 26178

AUG 03 2001

NORTH

LONGITUDE 80° 40'

12421

LAT. 39° 15' 26.9"

COUNTY NAME

PERMIT

0000

4629

FORM WW-8