

# SPURGEON LEASE 84.95 AC.

LONGITUDE 80° 47' 30"

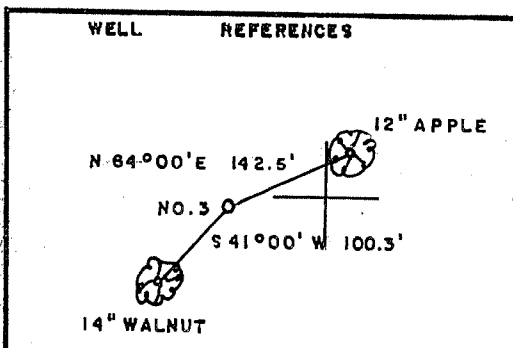
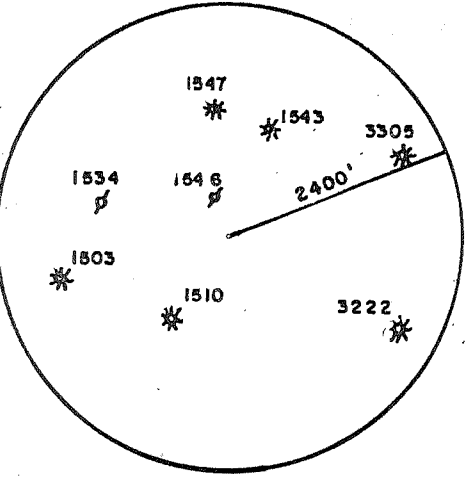
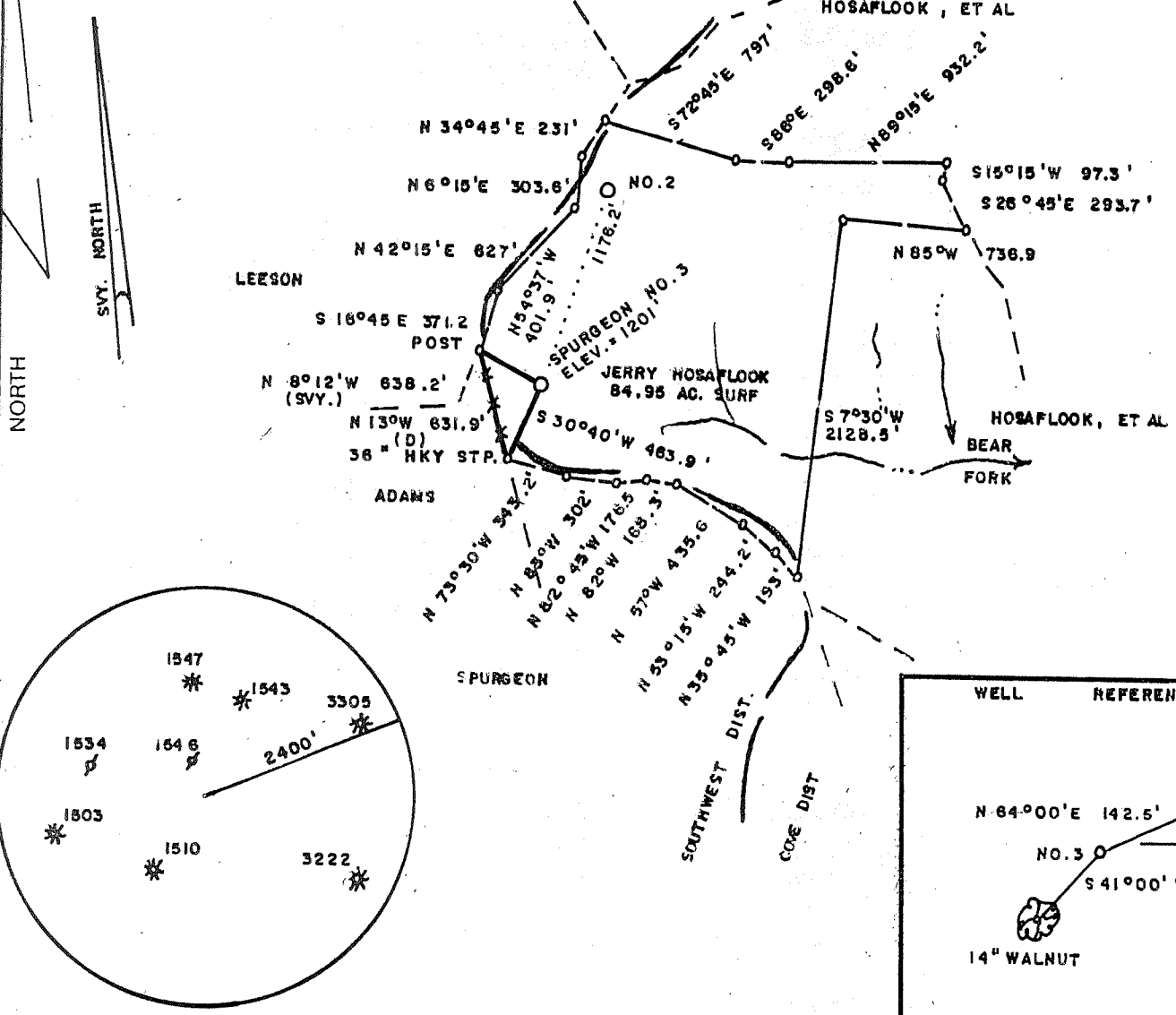

(+) DENOTES LOCATION OF WELL ON UNITED STATES TOPOGRAPHIC MAPS

FILE NO. \_\_\_\_\_  
 DRAWING NO. \_\_\_\_\_  
 SCALE 1" = 500'  
 MINIMUM DEGREE OF ACCURACY 1/200  
 PROVEN SOURCE OF ELEVATION BM - SOUTH OF LEASE  
ELEV. = 1142'

I THE UNDERSIGNED, HEREBY CERTIFY THAT THIS PLAT IS CORRECT TO THE BEST OF MY KNOWLEDGE AND BELIEF AND SHOWS ALL THE INFORMATION REQUIRED BY LAW AND THE REGULATIONS ISSUED AND PRESCRIBED BY THE DEPARTMENT OF ENERGY.  
 (SIGNED) Mark C. Echard  
 R.P.E. \_\_\_\_\_ L.L.S. 490

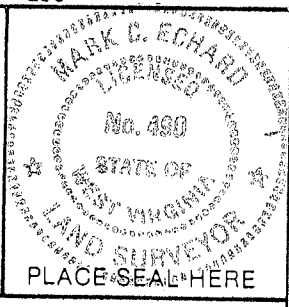

STATE OF WEST VIRGINIA  
 Division of Environmental Protection  
 OFFICE OF OIL AND GAS

DATE MARCH 10, 2005  
 OPERATOR'S WELL NO. SPURGEON NO. 3  
 API WELL NO. 47-017-04986  
 STATE WV COUNTY DODDRIDGE PERMIT 04986

WELL TYPE: OIL  GAS  LIQUID INJECTION  WASTE DISPOSAL   
 (IF "GAS,") PRODUCTION  STORAGE  DEEP  SHALLOW

LOCATION: ELEVATION 1201' WATERSHED BEAR FORK  
 DISTRICT COVE COUNTY DODDRIDGE  
 QUADRANGLE OXFORD 7.5'

SURFACE OWNER JERRY HOSAFLOOK ACREAGE 84.95  
 OIL & GAS ROYALTY OWNER FLUENCE HINTER LEASE ACREAGE 84.95  
 LEASE NO. \_\_\_\_\_

PROPOSED WORK: DRILL  CONVERT  DRILL DEEPER  REDRILL  FRACTURE OR STIMULATE  PLUG OFF OLD FORMATION  PERFORATE NEW FORMATION  OTHER PHYSICAL CHANGE IN WELL (SPECIFY) \_\_\_\_\_

PLUG AND ABANDON  CLEAN OUT AND REPLUG

TARGET FORMATION DEVONIAN ESTIMATED DEPTH 5990'  
 WELL OPERATOR JAY-BEE PRODUCTION CO. DESIGNATED AGENT RANDY BRODA  
 ADDRESS 1720 RT. 22 EAST ADDRESS ROUTE 1, BOX 5  
UNION, NJ 07083 CAIRO, WV 26337

COUNTY NAME DODD PERMIT 4986

Spaight Fork - Bull Run Creek (133) 6-6

APR 15 2005

State of West Virginia  
Department of Environmental Protection  
Office of Oil and Gas

*MP*

Well Operator's Report of Well Work

Farm name: B. Spurgeon Operator Well No.: 3

LOCATION: Elevation: 1201 Quadrangle: Oxford

District: Cove County: Doddridge  
Latitude: 13,700 Feet South of 39 Deg. 10 Min. 00 Sec.  
Longitude 1960 Feet West of 80 Deg. 47 Min. 30 Sec.

Company: Jay-Bee Oil & Gas Inc.

	Casing & Tubing	Used in drilling	Left in well	Cement fill up Cu. Ft.
Address: 1720 Rt. 22 East				
Union, N.J. 07083	9 5/8	130	130	Cts
Agent: Randy Broda				
Inspector: Steve Mossor	7	1760	1760	100 sks
Date Permit Issued: 4/12/05				
Date Well Work Commenced: 4/21/05	4 1/2	5303	5303	158 sks
Date Well Work Completed: 4/27/05				
Verbal Plugging:				
Date Permission granted on:				
Rotary x Cable Rig 30				
Total Depth (feet): 5490				
Fresh Water Depth (ft.): 75'				
Salt Water Depth (ft.): n/a				
Is coal being mined in area (N/Y)? n				
Coal Depths (ft.): n/a				

OPEN FLOW DATA

Producing formation Devonian Shale Pay zone depth (ft) See Well Record  
Gas: Initial open flow 20 MCF/d Oil: Initial open flow 0 Bbl/d  
Final open flow 60 MCF/d Final open flow SHOW Bbl/d  
Time of open flow between initial and final tests 96 Hours  
Static rock Pressure 1375 psig (surface pressure) after 72 Hours

Second producing formation \_\_\_\_\_ Pay zone depth (ft) \_\_\_\_\_  
Gas: Initial open flow \_\_\_\_\_ MCF/d Oil: Initial open flow \_\_\_\_\_ Bbl/d  
Final open flow \_\_\_\_\_ MCF/d Final open flow \_\_\_\_\_ Bbl/d  
Time of open flow between initial and final tests \_\_\_\_\_ Hours  
Static rock Pressure \_\_\_\_\_ psig (surface pressure) after \_\_\_\_\_ Hours

NOTE: ON BACK OF THIS FORM PUT THE FOLLOWING: 1). DETAILS OF PERFORATED INTERVALS, FRACTURING OR STIMULATING, PHYSICAL CHANGE, ETC. 2). THE WELL LOG WHICH IS A SYSTEMATIC DETAILED GEOLOGICAL RECORD OF ALL FORMATIONS, INCLUDING COAL ENCOUNTERED BY THE WELLBORE.

Signed: [Signature]  
By: Randy Broda  
Date: 8/1/05

NOV 04 2005

(IF "GAS,") PRODUCTION  STORAGE  DEEP  SHALLOW

LOCATION: ELEVATION 1201 WATER SHED BEAR FORK

DISTRICT COVE COUNTY DODDRIDGE

QUADRANGLE OXFORD 7.5'

SURFACE OWNER JERRY HOSAFLOOK

OIL & GAS ROYALTY OWNER FLUENCE HINTER ACREAGE 84.95

LEASE NO. \_\_\_\_\_ LEASE ACREAGE 84.95

PROPOSED WORK: DRILL  CONVERT  DRILL DEEPER  REDRILL  FRACTURE OR STIMULATE  PLUG OFF OLD FORMATION  PERFORATE NEW FORMATION  OTHER PHYSICAL CHANGE IN WELL (SPECIFY) \_\_\_\_\_

PLUG AND ABANDON  CLEAN OUT AND REPLUG

TARGET FORMATION DEVONIAN ESTIMATED DEPTH 5990'

WELL OPERATOR JAY-BEE PRODUCTION CO. DESIGNATED AGENT RANDY BRODA

ADDRESS 1720 RT. 22 EAST ADDRESS ROUTE 1, BOX 5  
UNION, NJ 07083 CAIRO, WV 26337

COUNTY NAME Dodd  
PERMIT 4986

*Spring Fork Blue Bone Cave 1201*

APR 15 2005

# WELL RECORD

B.SPURGEON 3  
PERMIT # 47-017-04986  
elevation 1201

## DETAILS OF PERFORATED INTERVALS:

4091 5107      4334 4822 300 SACKS FOAM  
4091 4573      WPA 4304 300 SACKS FOAM  
433 4091      WPA 4000 300 SACKS FOAM

FORMATION	COLOR	HARD/SOFT	TOP	BOTTOM	OIL.GAS.WATER	DEPTH	REMARKS
MISC.	RED ROCK & SHALES		0	1799		130	9 5/8
SAND			1799	1818			
SHALE			1818	1946		1760	7
LIME			1946	1958			
SAND			1958	1995			
LIME			1995	2054			
INJUN			2054	2134			
SHALE			2134	2249			
WIER			2249	2362			
SHALE			2362	2646			
GORDON			2646	2674			
SHALE			2674	3358			
WARREN			3358	3434			
SHALE			3434	3977			
BALLTOWN			3977	4161			
SHALE			4161	4484			
RILEY			4484	4532			
SHALE			4532	4803			
2nd RILEY			4803	4851			
SHALE			4851	4914			
BENSON			4914	4916			
SHALE			4916	5007			
ALEXANDER			5007	5046			
SHALE			5046	5164			
ELK			5164	5250			
SHALE			5250	5490 TD 437			4 1/2 SET @ 5303

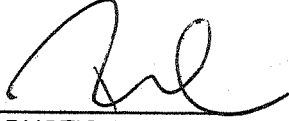
SIGNED:   
JAY-BEE PRODUCTION CO.  
BY IT'S: PRESIDENT  
DATE: 8/1/2005

NOV 04 2005