

NOTES

- TIE LINES SHOWN ARE REFERENCED TO STATE PLANE GRID NORTH (WV NORTH ZONE, NAD 27).
- ADJOINER INFORMATION FROM THE RECORDS OF THE DODDRIDGE COUNTY ASSESSOR'S OFFICE.
- LAT./LONG. AND TIE LINES ESTABLISHED BY DGPS (SUB-METER MAPPING GRADE.)
- LEASE BOUNDARY DESCRIPTION FROM PLAT PREPARED FOR PARTITION OF EDGAR DAVISSON ESTATE. (11/27/1917)

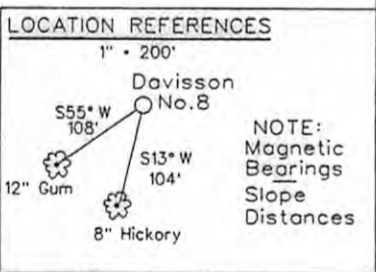

(H) DENOTES LOCATION OF WELL ON UNITED STATES TOPOGRAPHIC MAPS

FILE NO. 112-18  
 DRAWING NO. \_\_\_\_\_  
 SCALE 1" = 1000'  
 MINIMUM DEGREE OF ACCURACY Sub-Meter  
 PROVEN SOURCE OF ELEVATION DGPS Survey

I THE UNDERSIGNED, HEREBY CERTIFY THAT THIS PLAT IS CORRECT TO THE BEST OF MY KNOWLEDGE AND BELIEF AND SHOWS ALL THE INFORMATION REQUIRED BY LAW AND THE REGULATIONS ISSUED AND PRESCRIBED BY THE DEPARTMENT OF MINES.

(SIGNED) *Timothy P. Roush*  
 TIMOTHY P. ROUSH PS 793

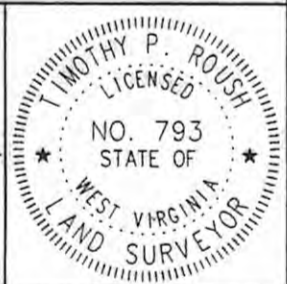

WEST VIRGINIA  
 Division of Environmental Protection  
 Office of Oil and Gas  
 601 57th Street  
 Charleston, West Virginia 25304



DATE March 6, 2005  
 FARM Edgar Davisson No.8  
 API WELL NO. 47-017-04990

WELL TYPE: OIL  GAS  LIQUID INJECTION \_\_\_\_\_ WASTE DISPOSAL \_\_\_\_\_  
 (IF "GAS") PRODUCTION  STORAGE \_\_\_\_\_ DEEP \_\_\_\_\_ SHALLOW

LOCATION: ELEVATION 1,159' WATERSHED Nutter Fork  
 DISTRICT West Union COUNTY Doddridge  
 QUADRANGLE Smithburg 7.5'

SURFACE OWNER Ramona & Clem Murphy ACREAGE 35.61 Ac.  
 OIL & GAS ROYALTY OWNER Lorelei Phillips et al. LEASE ACREAGE 230 Ac.  
 LEASE NO. \_\_\_\_\_

PROPOSED WORK: DRILL  CONVERT \_\_\_\_\_ DRILL DEEPER \_\_\_\_\_ REDRILL \_\_\_\_\_ FRACTURE OR STIMULATE  PLUG OFF OLD FORMATION \_\_\_\_\_ PERFORATE NEW FORMATION \_\_\_\_\_ OTHER PHYSICAL CHANGE IN WELL (SPECIFY) \_\_\_\_\_

PLUG AND ABANDON \_\_\_\_\_ CLEAN OUT AND REPLUG \_\_\_\_\_  
 TARGET FORMATION Big Injun, Gordon ESTIMATED DEPTH 2,950'  
 WELL OPERATOR G.B. Hefner & Assoc., Inc. DESIGNATED AGENT G. B. Hefner  
 ADDRESS P.O. Box 249 ADDRESS P.O. Box 249  
Bridgeport, WV 26330 Bridgeport, WV 26330 **08/09/2013**

**CANCELLED**