



---

**west virginia** department of environmental protection

---

Office of Oil and Gas  
601 57th Street SE  
Charleston, WV 25304  
(304) 926-0450  
(304) 926-0452 fax

Earl Ray Tomblin, Governor  
Randy C. Huffman, Cabinet Secretary  
www.dep.wv.gov

May 17, 2016

**FINAL INSPECTION REPORT**

**Horizontal Well Permit Cancelled**

EQT PRODUCTION COMPANY,

The FINAL INSPECTION REPORT for the CANCELLED permit, API Well Number: 47-1705809, issued to EQT PRODUCTION COMPANY, and listed below has been received in this office. The permit has been cancelled as of 5/2/2016.

James Martin  
Chief

Operator: EQT PRODUCTION COMPANY  
Operator's Well No: 512421  
Farm Name: COASTAL TIMBERLANDS INC.  
**API Well Number: 47-1705809**  
Date Issued: 03/26/2009

Date Cancelled: 05/02/2016

**Promoting a healthy environment.**

**06/10/2016**

# JACKSON LEESON LEASE 2,000 ACRES± WELL NO. WV 512421

WELL NO. WV 512421  
STATE PLANE COORDINATES  
(NORTH ZONE)

N. 232,573  
E. 1,628,697

LAT=(N) 39.13112  
LONG=(W) 80.80892

JEFFREY A. SPERRY  
72.86 ACRES±

COASTAL FOREST  
RESOURCES COMPANY  
145.19 ACRES±  
WELL NO. WV 512421  
STATE PLANE COORDINATES  
(NORTH ZONE)

N. 235,025  
E. 1,625,928

LAT=(N) 39.13775  
LONG=(W) 80.81881

HARVEY J.  
WILLIAMS, ET AL  
60 ACRES±

ARDEN E. &  
CAROL L. COGAR  
232 ACRES±

WELL NO. WV 512421  
BOTTOM HOLE

WILLIAM S.  
FISHER  
9.68 ACRES±

WILLIAM S.  
FISHER  
1.57 ACRES±

COASTAL FOREST  
RESOURCES COMPANY  
3.51 ACRES±

COASTAL FOREST  
RESOURCES COMPANY  
416.61 ACRES±

SHEILA D. CROCKETT  
42.92 ACRES±

RICHARD L. &  
SHERYL A. RAY  
235.5 ACRES±

MANSFIELD  
LEESON  
189.5 ACRES±

WELL NO. WV 512421

STONE, FOUND  
8 95°48' E  
258.18'

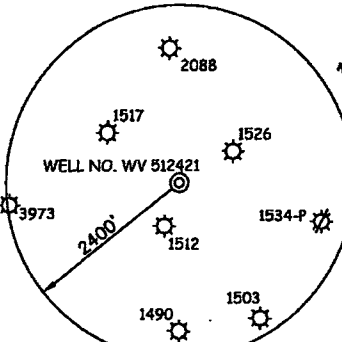

### NOTES ON SURVEY

1. TIES TO WELLS AND CORNERS ARE BASED ON GRID NORTH FOR THE WV STATE PLANE COORDINATE SYSTEM NORTH ZONE NAD '27.
2. TIES TO REFERENCES ARE BASED ON MAGNETIC NORTH 11/20/08.
3. LEASE BOUNDARY SHOWN HEREON TAKEN FROM DEED BOOK 92 PAGE 37.
4. SURFACE OWNER AND ADJOINER INFORMATION TAKEN FROM THE ASSESSOR AND COUNTY CLERK RECORDS OF DODDRIDGE COUNTY IN JULY, 2008.
5. WELL LAT./LONG. (NAD'27) ESTABLISHED BY DGPS(SUBMETER MAPPING GRADE).

### REFERENCES

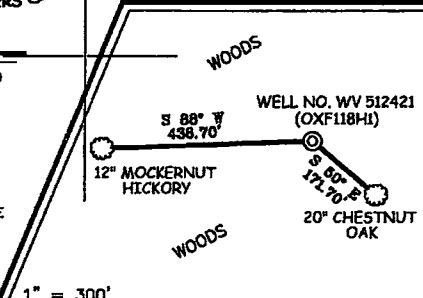

I THE UNDERSIGNED, HEREBY CERTIFY THAT THIS PLAT IS CORRECT TO THE BEST OF MY KNOWLEDGE AND BELIEF AND SHOWS ALL THE INFORMATION REQUIRED BY LAW AND THE REGULATIONS ISSUED AND PRESCRIBED BY THE DIVISION OF ENVIRONMENTAL PROTECTION.

P.S.  
677

*Gregory A. Smith*

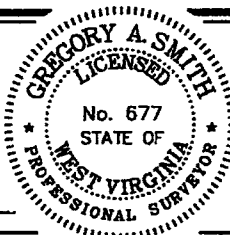

(+) DENOTES LOCATION OF WELL ON UNITED STATES TOPOGRAPHIC MAPS.

DATE DECEMBER 10, 20 08

OPERATORS WELL NO. WV 512421

API WELL NO. 47-017-05809H

STATE            COUNTY            PERMIT CANCELLED

MINIMUM DEGREE OF ACCURACY 1 / 200 FILE NO. 6113P512421 (270-41)

PROVEN SOURCE OF ELEVATION DGPS (SUBMETER MAPPING GRADE) SCALE 1" = 1,000'

STATE OF WEST VIRGINIA  
DIVISION OF ENVIRONMENTAL PROTECTION  
OFFICE OF OIL AND GAS



WELL TYPE: OIL            GAS X LIQUID INJECTION            WASTE DISPOSAL            IF "GAS" PRODUCTION X STORAGE            DEEP            SHALLOW X

LOCATION: ELEVATION 1,180' WATERSHED STRAIGHT FORK

DISTRICT SOUTHWEST COUNTY DODDRIDGE QUADRANGLE OXFORD 7.5'

SURFACE OWNER COASTAL FOREST RESOURCES COMPANY ACREAGE 416.61±

ROYALTY OWNER ADELE V. McDOUGAL, ET AL LEASE ACREAGE 2,000±

PROPOSED WORK: LEASE NO. 109481

DRILL X CONVERT            DRILL DEEPER            REDRILL            FRACTURE OR STIMULATE X PLUG OFF OLD           

FORMATION            PERFORATE NEW FORMATION            PLUG AND ABANDON            CLEAN OUT AND REPLUG            OTHER           

PHYSICAL CHANGE IN WELL (SPECIFY)            TARGET FORMATION MARCELLUS  
ESTIMATED DEPTH           

WELL OPERATOR EQUITABLE PRODUCTION COMPANY  
ADDRESS 1710 PENNSYLVANIA AVENUE  
CHARLESTON, WV 25302

DESIGNATED AGENT REX C. RAY  
ADDRESS 1710 PENNSYLVANIA AVENUE  
CHARLESTON, WV 25302

COUNTY NAME  
PERMIT

06/10/2016