

A- M. BERAM (9.57 AC±)
B- C.L. IRWIN (15.13 AC±)
C- C.L. IRWIN (8.05 AC±)

LATITUDE 39° 22' 30"

EQT PRODUCTION COMPANY WELL NO. WV 513165 CARR LEASE 351 AC±

WELL NO. WV 513165
STATE PLANE COORDINATES
NORTH ZONE (NAD'27)

N. 318,165.8
E. 1,661,523.6

LAT=(N) 39.367361
LONG=(W) 80.697230

UTM (NAD'83)
N. 4,357,597.4
E. 526,096.5

LANDING POINT
WELL NO. WV 513165
STATE PLANE COORDINATES
SOUTH ZONE (NAD'27)

N. 317,824.0
E. 1,660,117.6

LAT=(N) 39.366371
LONG=(W) 80.702186

UTM (NAD'83)
N. 4,357,486.1
E. 525,669.9

BOTTOM HOLE
WELL NO. WV 513165
STATE PLANE COORDINATES
NORTH ZONE (NAD'27)

N. 320,221.7
E. 1,658,105.7

LAT=(N) 39.372880
LONG=(W) 80.709416

UTM (NAD'83)
N. 4,358,206.3
E. 525,044.7

REFERENCES

- SMT27 WELLS
- H1- WV 513162
 - H2- WV 513163
 - H3- WV 513164
 - H4- WV 513165
 - H5- WV 513166
 - H6- WV 513167
 - H7- WV 514135
 - H8- WV 514136
 - H9- WV 514137
 - H10- WV 514138
 - H11- WV 514209
 - H12- WV 514210
 - H13- WV 514211

1" = 200' 47-017-04193

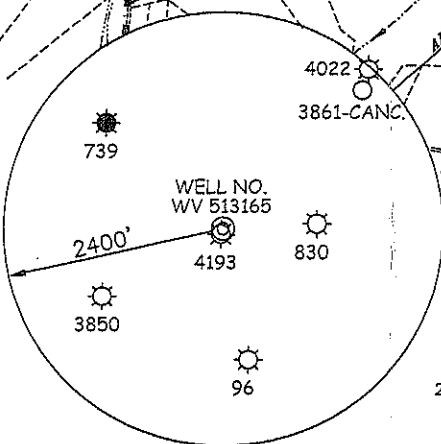

NOTES ON SURVEY

1. TIES TO WELLS, CORNERS & REFERENCES ARE BASED ON GRID NORTH FOR THE WV STATE PLANE COORDINATE SYSTEM NORTH ZONE NAD '27.
2. LEASE BOUNDARY SHOWN HEREON TAKEN FROM DEED BOOK 185 PAGE 459 & DEED BOOK 29 PAGE 255.
3. SURFACE OWNER AND ADJOINER INFORMATION TAKEN FROM THE ASSESSOR AND COUNTY CLERK RECORDS OF DODDRIDGE COUNTY IN JULY, 2010.
4. WELL LAT./LONG. (NAD'27 ESTABLISHED BY DGPS (SURVEY GRADE).



I THE UNDERSIGNED, HEREBY CERTIFY THAT THIS PLAT IS CORRECT TO THE BEST OF MY KNOWLEDGE AND BELIEF AND SHOWS ALL THE INFORMATION REQUIRED BY LAW AND THE REGULATIONS ISSUED AND PRESCRIBED BY THE DIVISION OF ENVIRONMENTAL PROTECTION.

P.S. 677

Gregory A. Smith

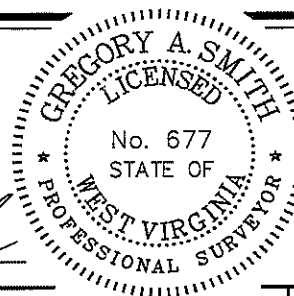

(+) DENOTES LOCATION OF WELL ON UNITED STATES TOPOGRAPHIC MAPS.

DATE OCTOBER 12, 20 11

OPERATORS WELL NO. WV 513165

API WELL NO. 47-017-06054H
STATE COUNTY PERMIT

MINIMUM DEGREE OF ACCURACY 1/200 FILE NO. 7584P513165RF (350-57)
PROVEN SOURCE OF ELEVATION DGPS (SURVEY GRADE TIE TO CORS NETWORK) SCALE 1" = 2000'

STATE OF WEST VIRGINIA
DIVISION OF ENVIRONMENTAL PROTECTION
OFFICE OF OIL AND GAS



WELL TYPE: OIL GAS LIQUID INJECTION WASTE DISPOSAL IF "GAS" PRODUCTION STORAGE DEEP SHALLOW

LOCATION: ELEVATION 1,198' (GROUND) / 1,179' (PROPOSED) WATERSHED BRUSH RUN

DISTRICT GRANT COUNTY DODDRIDGE QUADRANGLE SMITHBURG 7.5'

SURFACE OWNER BETH CROWDER & DAVID WENTZ ACREAGE 30±

ROYALTY OWNER PATTY J. & R. KEITH CRIHFIELD (351 AC±) / C.S. UNDERWOOD ET AL (75 AC±) / E.H. GARRETT ET AL (234 AC±)

PROPOSED WORK: LEASE NO. 104916 / 104930 / 105102

DRILL CONVERT DRILL DEEPER REDRILL FRACTURE OR STIMULATE PLUG OFF OLD

FORMATION PERFORATE NEW FORMATION PLUG AND ABANDON CLEAN OUT AND REPLUG OTHER

PHYSICAL CHANGE IN WELL (SPECIFY) _____ TARGET FORMATION GENESEO

ESTIMATED DEPTH _____

WELL OPERATOR EQT PRODUCTION COMPANY DESIGNATED AGENT REX C. RAY
ADDRESS 1710 PENNSYLVANIA AVENUE ADDRESS 1710 PENNSYLVANIA AVENUE
CHARLESTON, WV 25302 CHARLESTON, WV 25302

COUNTY NAME PERMIT

