

EQT PRODUCTION COMPANY S.E. GASTON LEASE 206 ACRES± WELL NO. WV 513174

LONGITUDE 80°47'30"

9.75'

**BOTTOM HOLE
WELL NO. 513174
STATE PLANE COORDINATES
NORTH ZONE (NAD'27)**

N. 256,160.1
E. 1,628,418.0

LAT=(N) 39.195866
LONG=(W) 80.811111

UTM (NAD'83)(METERS)
N. 4,338,538.8
E. 516,325.9

NOTES ON SURVEY

1. TIES TO WELLS, CORNERS AND REFERENCES ARE BASED ON GRID NORTH FOR THE WV STATE PLANE COORDINATE SYSTEM NORTH ZONE NAD '27.
2. LEASE BOUNDARY SHOWN HEREON TAKEN FROM DEED BOOK 253 PAGE 41, DEED BOOK 220 PAGE 452, DEED BOOK 200 PAGE 392, DEED BOOK 216 PAGE 266, DEED BOOK 196 PAGE 524, DEED BOOK 204 PAGE 448 AND OTHER DEEDS/PLATS OF RECORD.
3. SURFACE OWNER AND ADJOINER INFORMATION TAKEN FROM THE ASSESSOR AND COUNTY CLERK RECORDS OF DODDRIDGE COUNTY IN JULY, 2011.
4. WELL LAT./LONG. (NAD'27) ESTABLISHED BY DGPS(SURVEY GRADE TIES TO CORS NETWORK).

LEASE #117513

**WELL NO. 513174
STATE PLANE COORDINATES
NORTH ZONE (NAD'27)**

N. 250,896.0
E. 1,631,715.4

LAT=(N) 39.181546
LONG=(W) 80.799210

UTM (NAD'83)(METERS)
N. 4,336,951.9
E. 517,357.2

**LANDING POINT
WELL NO. 513174
STATE PLANE COORDINATES
NORTH ZONE (NAD'27)**

N. 251,144.0
E. 1,630,757.1

LAT=(N) 39.182188
LONG=(W) 80.802603

UTM (NAD'83)(METERS)
N. 4,337,022.6
E. 517,064.0

NORTH

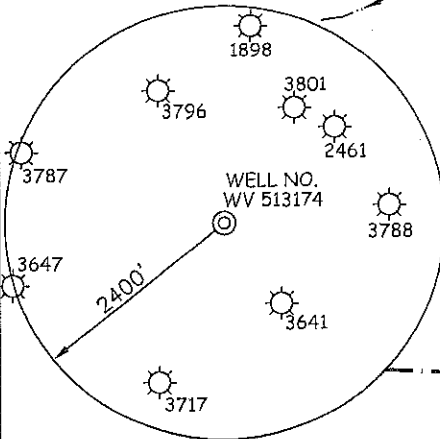

I THE UNDERSIGNED, HEREBY CERTIFY THAT THIS PLAT IS CORRECT TO THE BEST OF MY KNOWLEDGE AND BELIEF AND SHOWS ALL THE INFORMATION REQUIRED BY LAW AND THE REGULATIONS ISSUED AND PRESCRIBED BY THE DIVISION OF ENVIRONMENTAL PROTECTION.

P.S. 677

Gregory A. Smith

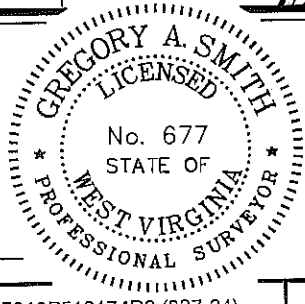

(+) DENOTES LOCATION OF WELL ON UNITED STATES TOPOGRAPHIC MAPS.

DATE APRIL 11, 2012

OPERATORS WELL NO. WV 513174

API WELL NO. 47-017-611446A
STATE COUNTY PERMIT

MINIMUM DEGREE OF ACCURACY 1/200
PROVEN SOURCE OF ELEVATION DGPS (SURVEY GRADE TIE TO CORS NETWORK)
FILE NO. 7310P513174R2 (327-24)
SCALE 1" = 1000'

STATE OF WEST VIRGINIA
DIVISION OF ENVIRONMENTAL PROTECTION
OFFICE OF OIL AND GAS



WELL TYPE: OIL ___ GAS LIQUID INJECTION ___ WASTE DISPOSAL ___ IF "GAS" PRODUCTION STORAGE ___ DEEP ___ SHALLOW

LOCATION: ELEVATION 1,237' (GROUND) 1,214' (PROPOSED) WATERSHED UPPER RUN OF MIDDLE FORK OF SOUTH FORK HUGHES RIVER

DISTRICT SOUTHWEST COUNTY DODDRIDGE QUADRANGLE OXFORD 7.5'

SURFACE OWNER ROBERT BRANNON ET AL ACREAGE 70±

ROYALTY OWNER MONA R. CUMBERLEDGE ET AL (206 AC.±) / WBM HEIRS PROPERTIES, LLC (1891.75 AC.±)

PROPOSED WORK: LEASE NO. 107453/117513

DRILL CONVERT ___ DRILL DEEPER ___ REDRILL ___ FRACTURE OR STIMULATE PLUG OFF OLD

FORMATION ___ PERFORATE NEW FORMATION ___ PLUG AND ABANDON ___ CLEAN OUT AND REPLUG ___ OTHER ___

PHYSICAL CHANGE IN WELL (SPECIFY) TARGET FORMATION MARCELLUS

ESTIMATED DEPTH

WELL OPERATOR EQT PRODUCTION COMPANY DESIGNATED AGENT REX C. RAY
ADDRESS 1710 PENNSYLVANIA AVENUE ADDRESS 1710 PENNSYLVANIA AVENUE
CHARLESTON, WV 25302 CHARLESTON, WV 25302

COUNTY NAME

PERMIT

124888

S.E. GASTON LEASE
WELL NO. WV 513174

NOTE: SEE ATTACHED REC PLAN FOR WELL NUMBER WV 512443 FOR INFO. FROM COUNTY ROUTE 19/11 ALONG COUNTY ROUTE 23/3 TO HERE.

CONNECTOR ROAD TO OXF 152 ACCESS ROAD TO BE CONSTRUCTED USING EXCESS MATERIAL FROM OXF 160 SITE

PROPOSED GAS WELL NO. WV 513174

SEE ATTACHED REC. PLAN FOR DRAINAGE DETAIL ALONG THIS ROAD TO STOCKPILE AREAS.

Detail Sketch for Proposed Well No. WV 513174

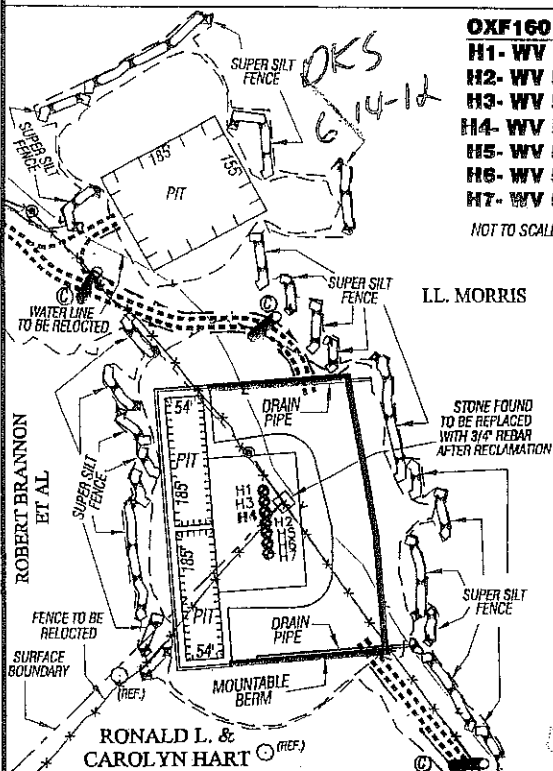

- OXF 160 WELLS**
- H1- WV 513171
 - H2- WV 513172
 - H3- WV 513173
 - H4- WV 513174
 - H5- WV 513702
 - H6- WV 513775
 - H7- WV 514099
- NOT TO SCALE

NOTE: SUPER SILT FENCE SEDIMENT CONTROL TO BE USED ALONG LOWER SIDE OF STOCKPILE AREAS AND CONNECTOR ROAD.

ALL ROADS SHOWN HEREON ARE EXISTING UNLESS OTHERWISE NOTED AND SHALL BE MAINTAINED IN ACCORDANCE WITH WV D.E.P. OIL AND GAS BMP MANUAL ENTRANCES AT COUNTY/STATE ROADS SHALL BE MAINTAINED IN ACCORDANCE WITH WV D.O.T. REGULATION. SEPARATE PERMITS MAY BE REQUIRED BY THE D.O.T.

SEDIMENT BASINS (TRAPS) AND APPROPRIATE EROSION CONTROL BARRIERS ARE TO BE CONSTRUCTED AT ALL CULVERT AND CROSS DRAIN INLETS AND OUTLETS AS REQUIRED IN THE WV D.E.P. OIL AND GAS BMP MANUAL. FIELD CONDITIONS (ROCK OUTCROPS AND BEDROCK) MAY PROHIBIT INLET TRAPS BEING INSTALLED. WHEN THESE CONDITIONS EXIST ADDITIONAL EROSION CONTROL MEASURES SHALL BE EVALUATED AND UTILIZED AS NEEDED.

EARTHWORK CONTRACTORS ARE RESPONSIBLE FOR NOTIFICATION TO THE OPERATOR AND INSPECTOR PRIOR TO ANY DEVIATION FROM THIS PLAN.

TEMPORARY SEED & MULCH ALL SLOPES AFTER CONSTRUCTION OF LOCATION.

CUT & STACK ALL MARKETABLE TIMBER.

STACKED BRUSH MAY BE USED FOR SEDIMENT CONTROL

APPLICATIONS FOR SEPARATE PLC PERMITS ON THE ACCESS ROAD STREAM CROSSINGS HAVE BEEN PREPARED (IF APPLIES)

- = EXISTING CULVERT
- = PROPOSED CULVERT 12" MIN. UNLESS OTHERWISE NOTED
- = PROPOSED STREAM CROSSING
- = 3/4" REBAR TO BE SET AFTER RECLAMATION
- = APPROXIMATE LIMITS OF DISTURBANCE

SCALE: 1" = 500'



SLS

SMITH LAND SURVEYING, INC.
P.O. BOX 150 GLENVILLE, WV. 26351
PH: (304) 462-5634 FAX: (304) 462-5656 E-MAIL: sls@slssurveys.com

DRAWN BY K.D.W.	FILE NO. 7310	DATE 06/8/12	CADD FILE: 23106RCW513174R3.DWG
--------------------	------------------	-----------------	------------------------------------

TOPO SECTION OF OXFORD 7.5' USGS TOPO QUADRANGLE