

| Bearing       | Distance |
|---------------|----------|
| L1 N 50°48' E | 1,339.7' |
| L2 N 45°07' E | 616.2'   |
| L3 N 02°53' E | 401.1'   |
| L4 N 16°48' W | 549.4'   |

**Notes:**  
 West Virginia Coordinate System of 1927, North Zone based upon Differential GPS Measurements.  
 Well No. Welling Unit 2H Top Hole coordinates are  
 N: 274,007.02' Latitude: 39°14'49.51"  
 E: 1,688,808.28' Longitude: 80°35'55.75"  
 Bottom Hole coordinates are  
 N: 265,251.93' Latitude: 39°13'23.40"  
 E: 1,692,281.79' Longitude: 80°35'10.26"  
**UTM Zone 17, NAD 1983**  
 Top Hole Coordinates Bottom Hole Coordinates  
 N: 4,344,283.018m N: 4,341,633.428m  
 E: 534,633.196m E: 535,735.893m  
 Plat orientation and corner and well references are based upon the grid north meridian.  
 Well location references are based upon the magnetic meridian.

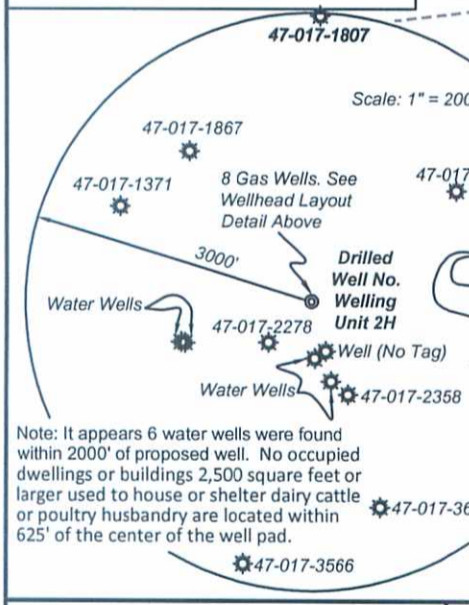

| Tag | LESSOR  | Acres    | Acres     |
|-----|---|----------|-----------|
| M   | Isaac Eddy, et ux Lease L012454 and James Romine Lease DV011162             | 260/596  | 0.71      |
| L   | Ora Virginia White Lease DAD61820/002                                       | 229/439  | 21.59     |
| K   | Charles W. Wellings Jr., et ux Lease 21312                                  | 263/326  | 83.75     |
| J   | Leo G. King, et ux, Memorandum of Oil and Gas Lease                         | 262/152  | 0.75      |
| I   | Pamela D. Clevenger, Memorandum of Oil & Gas Lease                          | 273/129  | 4.61      |
| H   | Timothy J. Goldsmith, et ux, Memorandum of Oil and Gas Lease                | 266/588  | 9.12      |
| G   | Glenville State College Foundation Lease                                    | 282/83   | 1.00      |
| F   | Eddy Cemetery Assoc. Public Burying Ground, Memorandum of Oil and Gas Lease | 279/257  | 20.0      |
| E   | Robert E. Currey, et ux, Memorandum of Oil and Gas Lease                    | WB40/199 | 1.16      |
| D   | Gregory M. Pigg, et ux, Memorandum of Oil and Gas Lease                     | 240/680  | 2.29      |
| C   | Charles W. Wellings Jr., et ux, Memorandum of Oil & Gas Lease               | 281/276  | 0.83      |
| B   | Charles W. Wellings Jr., et ux, Memorandum of Oil & Gas Lease               | 273/298  | 0.14      |
| A   | Margaret J. & William G. Prickett Lease 22045                               | 237/172  | 0.59      |
|     | LESSOR  |          |           |
| 32  | 8/25.5 Leo G. & Martha L. King  | 260/596  | 0.71      |
| 31  | 4/13.5 Rodney G. & Bonnie Kelly   | 229/439  | 21.59     |
| 30  | 7/13 Stephen W. & Barbara S. Dolly  | 263/326  | 83.75     |
| 29  | 8/32.2 Jimmy D. Clevenger   | 262/152  | 0.75      |
| 28  | 8/25.2 Timothy J. & Julie R. Goldsmith                                      | 273/129  | 4.61      |
| 27  | 7/14.9 Barbara L. & Charles W. Wellings Jr.                                 | 266/588  | 9.12      |
| 26  | 8/25.1 Thomas Edward & Mary Jo Hickman                                      | 282/83   | 1.00      |
| 25  | 7/14.1 Murray Hill Energy Inc.  | 279/257  | 20.0      |
| 24  | 8/25 Pamela Clevenger   | WB40/199 | 1.16      |
| 23  | 8/6.1 August J. & Rhonie L. Jordan  | 240/680  | 2.29      |
| 22  | 8/34 Gregory M. & Tessa M. Pigg   | 281/276  | 0.83      |
| 21  | 8/34.1 D. Duane & Leah L. Perkins   | 273/298  | 0.14      |
| 20  | 7/14.5 Melvin W. & Louise Morris  | 237/172  | 0.59      |
| 19  | 7/14.4 Phoonsombatt Smith   | 271/219  | 1.01      |
| 18  | 8/33 D. Duane & Leah Perkins  | 227/200  | 1.10      |
| 17  | 7/46 Charles W. Jr. & Barbara L. Wellings                                   | 203/229  | Lot #7    |
| 16  | 7/30 Robert Marshall & Vernie Mae Hilling                                   | 280/347  |           |
| 15  | 4/26 Rodney & Crystal Clark (Rosalie Clark LE)                              | 287/693  | 57.34     |
| 14  | 7/31 Timothy J. & Julie Goldsmith   | 273/126  | 3.76      |
| 13  | 7/14.3 Judy D. Martin (Tract 2)   | 204/518  | 1.27      |
| 12  | 4/9.2 Rodney L. & Crystal D. Clark  | 226/334  | 0.85      |
| 11  | 4/9.1 James M. & Cathy Sue Clark  | 179/777  | 1.50      |
| 10  | 7/14.3 Judy D. Martin (Tract 1)   | 204/518  | 10.39     |
| 9   | 7/14.6 Shawn K. & Penny J. Dahlheimer                                       | 249/217  | 1.54      |
| 8   | 7/51 Trustees of the Eddy Cemetery Assoc.                                   | 249/650  | 1.70      |
| 7   | 7/14.8 William & Lanita Stewart   | 281/311  | 1.00      |
| 6   | 7/50 Green Meadow Sewage Treat. Plant                                       | 220/449  | -         |
| 5   | 7/47 Judith K. Mohr & Rocky L. Romanello                                    | 254/459  | Lot #6    |
| 4   | 7/49 Howard & Muriel Van Buren  | 191/192  | Lot #4    |
| 3   | 7/48 Carrie J. & William J. Curran II                                       | 273/399  | Lot #5    |
| 2   | 7/14.1 Jason C. Ridenour  | 244/613  | 23.26     |
| 1   | 4/27.3 Ronnie & Betty Perkins   | 173/259  | 40.2      |
| Tag | TM/PAW  | OWNER    | BK/PG AC. |

Top Hole coordinates verified by survey grade GPS. As-drilled data and information was provided by Antero Resources Corporation. Allegheny Surveys, Inc. (ASI) is not certifying the data and information provided. ASI is not responsible for any errors or inaccuracies with the data and information that has been provided.

| Legend |                                   |
|--------|-----------------------------------|
| ⊙      | Proposed gas well                 |
| ⊕      | Found Monument (as noted)         |
| ---    | Creek or Drain                    |
| ---    | Existing Road                     |
| ---    | Surface boundary (approx.)        |
| ---    | Interior surface tracts (approx.) |

FILE NO: 235-30-G-12  
 DRAWING NO: 235-12 Drilled Welling 2H  
 SCALE: 1" = 1200'  
 MINIMUM DEGREE OF ACCURACY: Submeter  
 PROVEN SOURCE OF ELEVATION: WVDOT, Bridgeport, WV

**STATE OF WEST VIRGINIA**  
 DEPARTMENT OF ENVIRONMENTAL PROTECTION  
**OIL AND GAS DIVISION**

DATE: December 26 2014  
 OPERATOR'S WELL NO. Welling Unit 2H  
 API WELL NO  
 47 017 - 06183  
 STATE COUNTY PERMIT

WELL TYPE:  OIL  GAS  LIQUID INJECTION  WASTE DISPOSAL  
 (IF GAS) PRODUCTION:  STORAGE  DEEP  SHALLOW  
 LOCATION: ELEVATION: 971' WATERSHED: Greenbrier Creek QUADRANGLE: Big Isaac  
 DISTRICT: Greenbrier Richard E. & Wilma J. Marsden COUNTY: Boone  
 SURFACE OWNER: Wilma J. Marsden DAD37957/002; 22045 COUNTY: Boone  
 ROYALTY OWNER: M.T. Williams, et al; Chad W. Johnson; Okey Clark, et ux; Homer L. Ford LEASE NO: DAD61820/002; 003636 ACREAGE: 386 12.18; 92  
 PROPOSED WORK:  DRILL  CONVERT  DRILL DEEPER  FRACTURE OR STIMULATE  PLUG OFF OLD FORMATION ACREAGE: 350; 67; 100; 50; 221  
 PERFORATE NEW FORMATION  OTHER PHYSICAL CHANGE IN WELL (SPECIFY) As-Drilled  
 PLUG AND ABANDON  CLEAN OUT AND REPLUG TARGET FORMATION: Marcellus Shale DEPTH: 7,022' TVD  
 16,453' MD

WELL OPERATOR: Antero Resources Corporation DESIGNATED AGENT: Dianna Stamper - CT Corporation System  
 ADDRESS: 1615 Wynkoop Street ADDRESS: 5400 D Big Tyler Road  
 Denver, CO 80202 Charleston, WV 25313